

FAP ROUTE	SECTION	COUNTY	TOTAL SHEETS	SHEET NO.
05-00016-02-RP	MADISON	42	22	
STA. 15+50		TO STA. 23+10.97		
CONTRACT NO.: 97290				

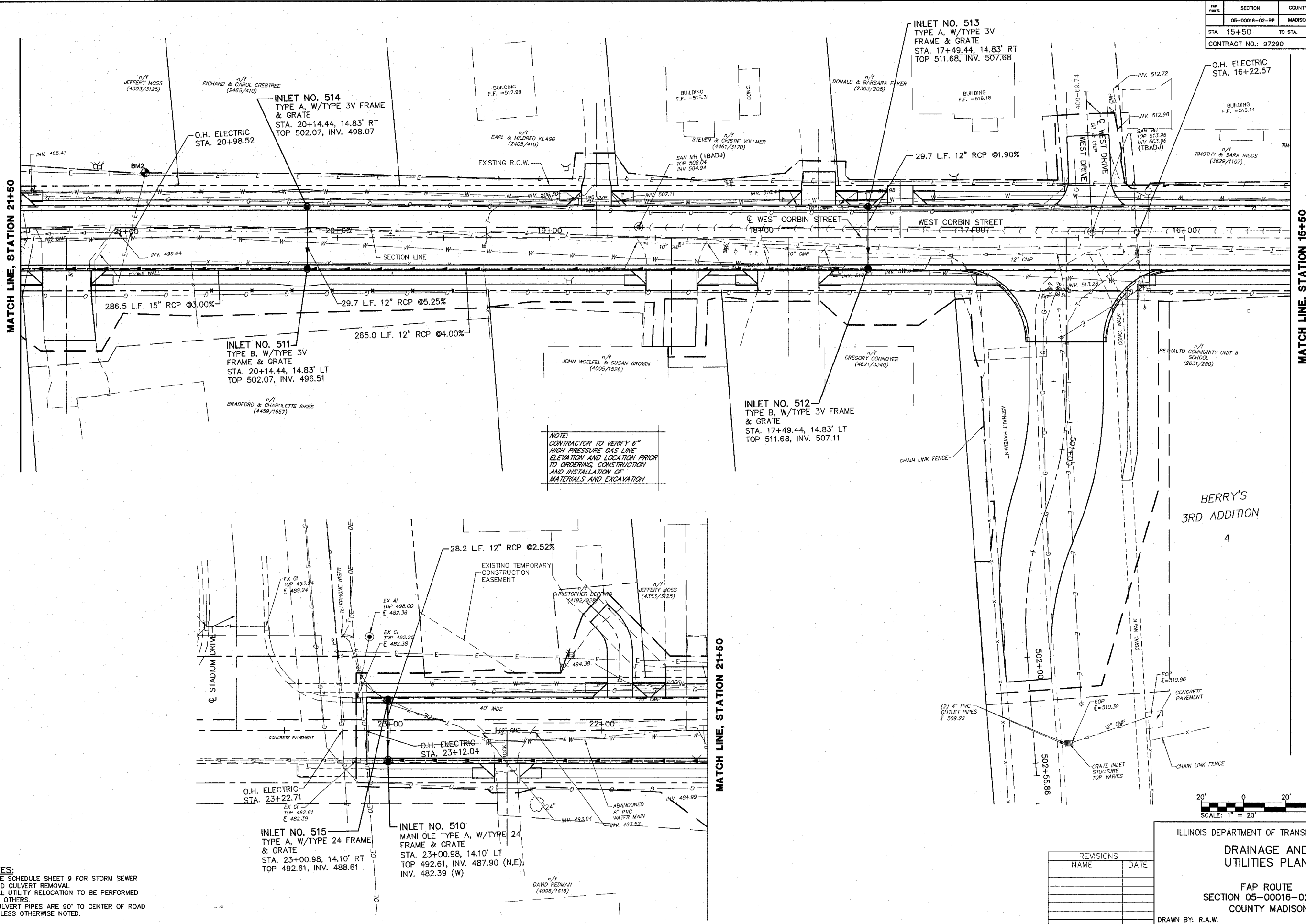

NOTE:
CONTRACTOR TO VERIFY 6" HIGH PRESSURE GAS LINE ELEVATION AND LOCATION PRIOR TO ORDERING CONSTRUCTION AND INSTALLATION OF MATERIALS AND EXCAVATION

- NOTES:**
1. SEE SCHEDULE SHEET 9 FOR STORM SEWER AND CULVERT REMOVAL
 2. ALL UTILITY RELOCATION TO BE PERFORMED BY OTHERS.
 3. CULVERT PIPES ARE 90' TO CENTER OF ROAD UNLESS OTHERWISE NOTED.

REVISIONS	
NAME	DATE

ILLINOIS DEPARTMENT OF TRANSPORTATION
DRAINAGE AND UTILITIES PLAN
 FAP ROUTE
 SECTION 05-00016-02-RP
 COUNTY MADISON
 DRAWN BY: R.A.W.

