

FAP ROUTE	SECTION	COUNTY	TOTAL SHEETS	SHEET NO.
05-00016-02-RP	MADISON	42	27	
STA. 9+74.44		TO STA. 23+10.97		
CONTRACT NO.: 97290				

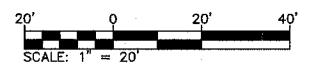
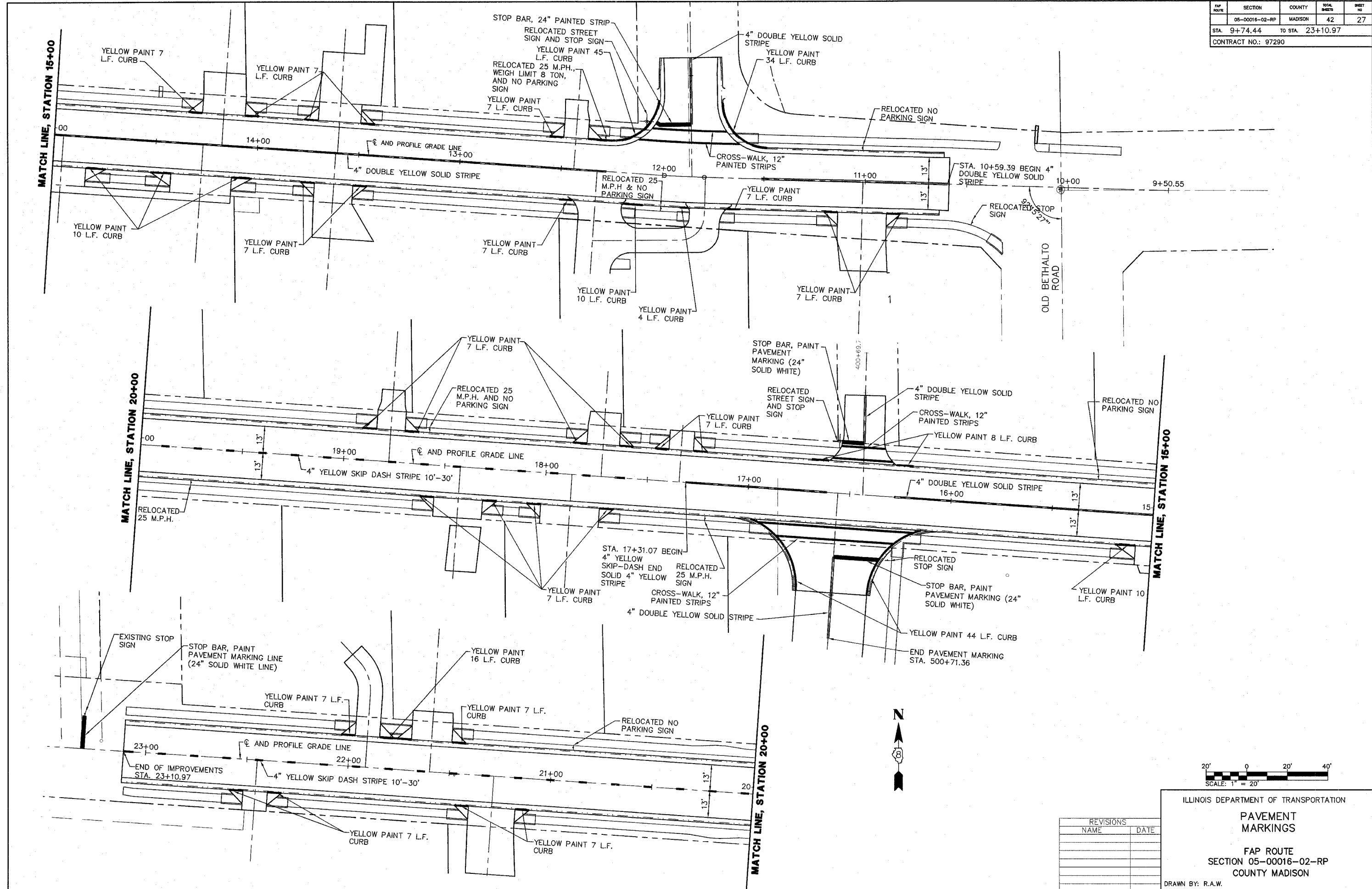

REVISIONS	
NAME	DATE

ILLINOIS DEPARTMENT OF TRANSPORTATION

PAVEMENT MARKINGS

FAP ROUTE
SECTION 05-00016-02-RP
COUNTY MADISON

DRAWN BY: R.A.W.