

F.A.U. RTE.	SECTION	COUNTY	TOTAL SHEETS	SHEET NO.
9089	04-00180-02-PV	MADISON	92	25
FED. ROAD DIST. NO.	ILLINOIS FED. AID PROJECT			
CONTRACT NO. 97299				

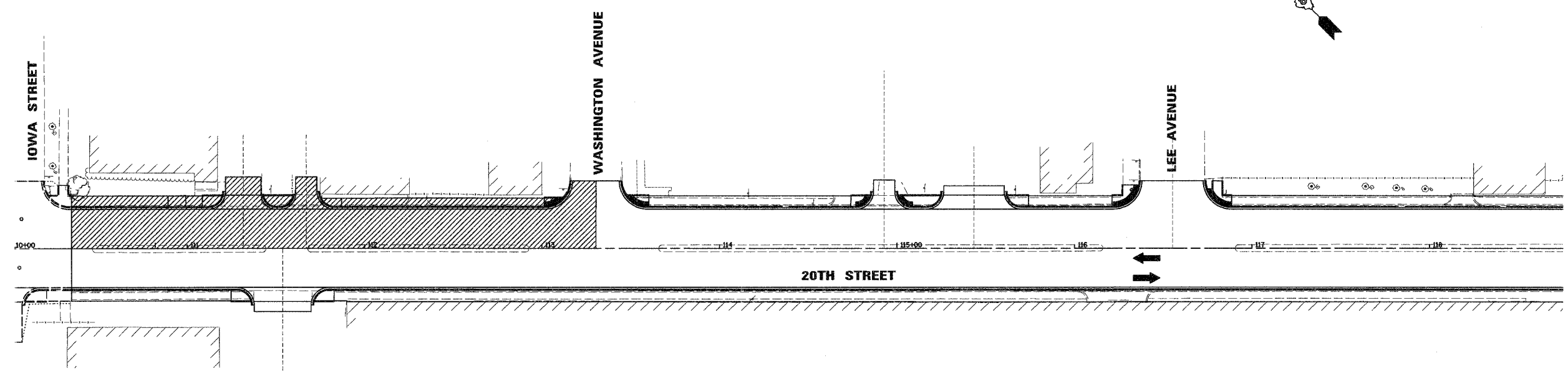

PHASE 4  COMPLETED DURING THIS STAGE

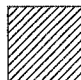
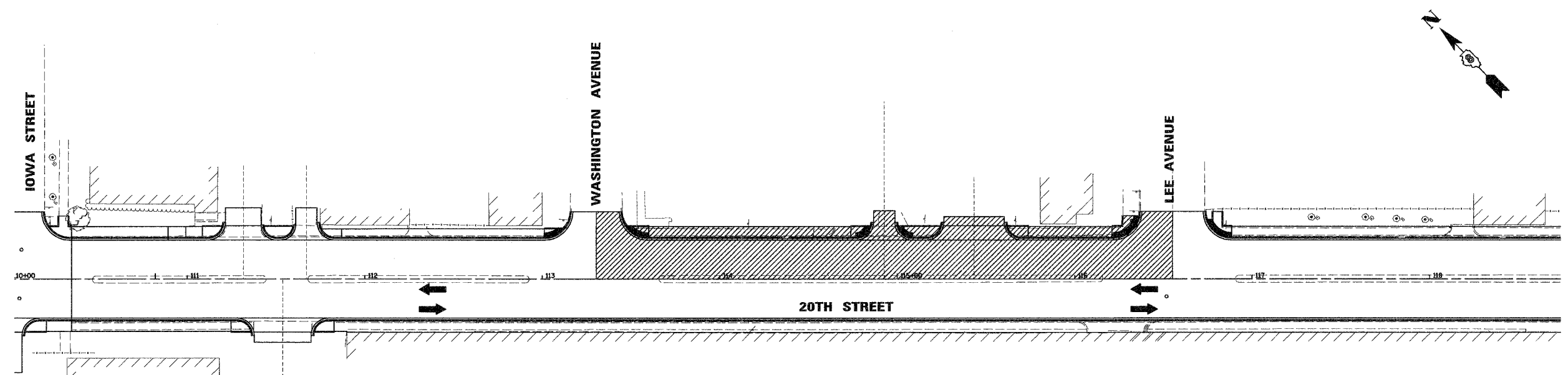
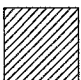

PHASE 5  COMPLETED DURING THIS STAGE

Jineau Associates, Inc. P.C.
CONSULTING ENGINEERS AND LAND SURVEYORS
2100 State Street, P.O. Box 1325
Granite City, Illinois 62040
Phone: (618) 652-1400 / (618) 652-0335
Fax: (618) 652-0541

STAGE 1 CONSTRUCTION
PHASE 4 & PHASE 5
20TH STREET (PHASES II, III & IV)
GRANITE CITY, ILLINOIS
SECTION NO. 04-00180-02-PV

REVISIONS			
NO.	DATE	BY	REMARKS

SCALE: 1" = 30'			
DSN. BY:	WRC	DATE:	12/26/06
DWN. BY:	WRC	DATE:	12/26/06
CHKD:	BFK	DATE:	12/26/06
DWG. NO.	E030204	DGN. NAME:	STAGE 2A
		OF 92 SHTS	

SHEET 25