

F.A.U. RTE.	SECTION	COUNTY	TOTAL SHEETS	SHEET NO.
9089	04-00180-02-PV	MADISON	92	35
FED. ROAD DIST. NO.	ILLINOIS	FED. AID PROJECT		
CONTRACT NO. 97299				

BY	DATE
FINAL SURVEYED	
SURVEY PLOTTED	
NOTE BOOK TEMPLATE	
AREAS CHECKED	
NO.	

MATCH LINE STA. 122+00.00

MATCH LINE STA. 127+60.00

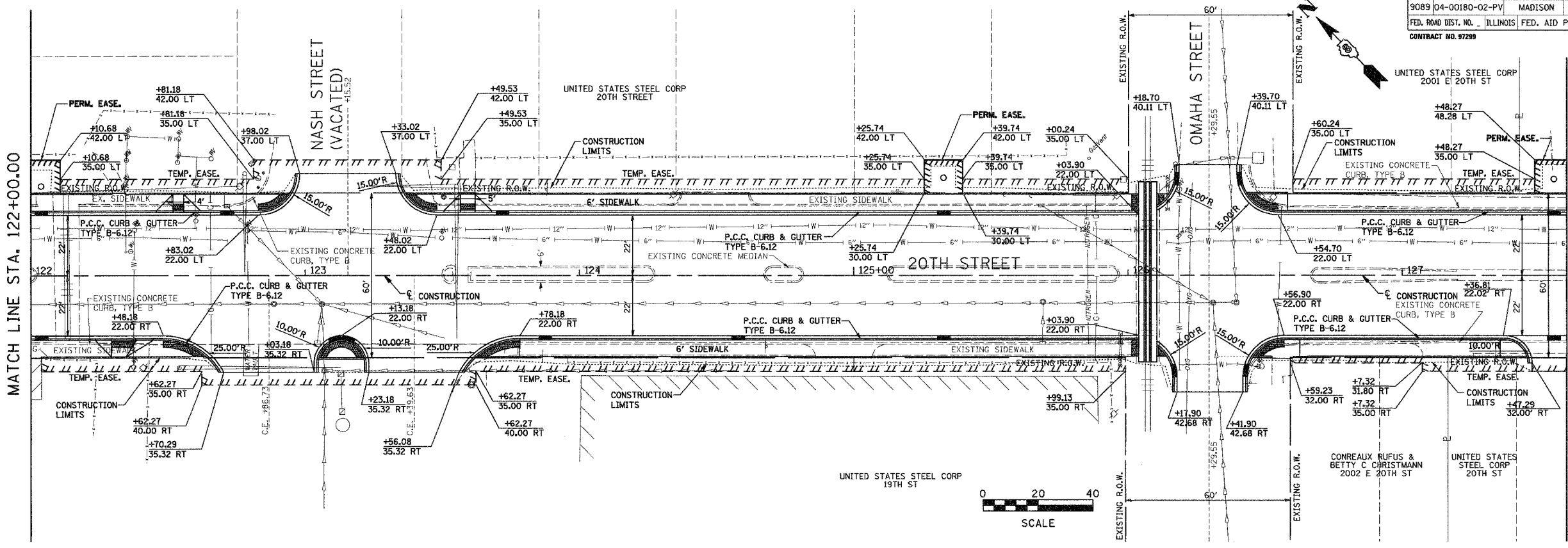

BY	DATE
ORIGINAL SURVEYED	
SURVEY PLOTTED	
NOTE BOOK TEMPLATE	
AREAS CHECKED	
NO.	

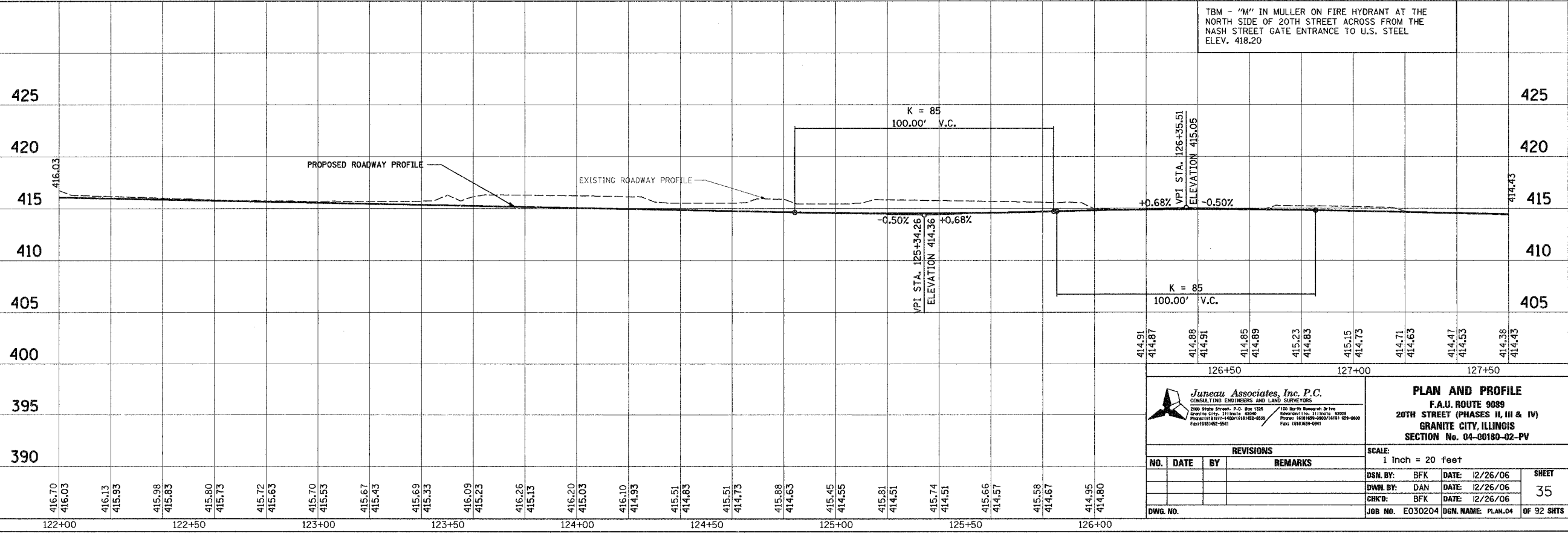

TBM - "M" IN MULLER ON FIRE HYDRANT AT THE NORTH SIDE OF 20TH STREET ACROSS FROM THE NASH STREET GATE ENTRANCE TO U.S. STEEL ELEV. 418.20

**Juneau Associates, Inc. P.C.**  
CONSULTING ENGINEERS AND LAND SURVEYORS  
200 State Street, P.O. Box 175  
Granite City, Illinois 62040  
Phone: (618) 952-9511 Fax: (618) 952-9511

**PLAN AND PROFILE**  
F.A.U. ROUTE 9089  
20TH STREET (PHASES II, III & IV)  
GRANITE CITY, ILLINOIS  
SECTION No. 04-00180-02-PV

SCALE: 1 Inch = 20 feet

NO. DATE BY REMARKS

DSN. BY: BFK DATE: 12/26/06 SHEET 35  
DWN. BY: DAN DATE: 12/26/06  
CHKD: BFK DATE: 12/26/06  
DWG. NO. JOB NO. E030204 DGN. NAME: PLAN.04 OF 92 SHTS