

F.A.U. RTE.	SECTION	COUNTY	TOTAL SHEETS	SHEET NO.
9089	04-00180-02-PV	MADISON	92	55
FED. ROAD DIST. NO.	ILLINOIS	FED. AID PROJECT		

CONTRACT NO. 97289

N QUADRANT					
STATIONING ALONG 20TH STREET	OFFSET TO E.O.P. FOOT	E.O.P. ELEVATION FOOT	STATIONING ALONG PARK AVENUE	OFFSET TO E.O.P. FOOT	DISTANCE ALONG RAD. FOOT
129+22.54	22.00 LT	413.23	N/A	N/A	0.000
129+31.81	25.21 LT	413.36	N/A	N/A	10.00
129+37.12	33.47 LT	413.49	N/A	N/A	20.00
129+37.54	36.85 LT	413.54	N/A	N/A	23.41

E QUADRANT					
STATIONING ALONG 20TH STREET	OFFSET TO E.O.P. FOOT	E.O.P. ELEVATION FOOT	STATIONING ALONG PARK AVENUE	OFFSET TO E.O.P. FOOT	DISTANCE ALONG RAD. FOOT
129+87.30	22.00 LT	412.90	N/A	N/A	0.000
129+78.02	25.21 LT	413.13	N/A	N/A	10.00
129+72.72	33.47 LT	413.37	N/A	N/A	20.00
129+72.30	37.00 LT	413.45	N/A	N/A	23.56

W QUADRANT					
STATIONING ALONG 20TH STREET	OFFSET TO E.O.P. FOOT	E.O.P. ELEVATION FOOT	STATIONING ALONG PARK AVENUE	OFFSET TO E.O.P. FOOT	DISTANCE ALONG RAD. FOOT
129+22.11	22.00 RT	413.23	N/A	N/A	0.000
129+31.47	25.03 RT	413.28	N/A	N/A	10.00
129+37.29	32.96 RT	413.34	N/A	N/A	20.00
129+38.10	38.00 RT	413.37	N/A	N/A	25.13

S QUADRANT					
STATIONING ALONG 20TH STREET	OFFSET TO E.O.P. FOOT	E.O.P. ELEVATION FOOT	STATIONING ALONG PARK AVENUE	OFFSET TO E.O.P. FOOT	DISTANCE ALONG RAD. FOOT
129+88.03	22.00 RT	412.90	N/A	N/A	0.000
129+78.67	25.03 RT	413.05	N/A	N/A	10.00
129+72.85	32.96 RT	413.19	N/A	N/A	20.00
129+72.03	38.00 RT	413.27	N/A	N/A	25.13

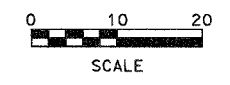
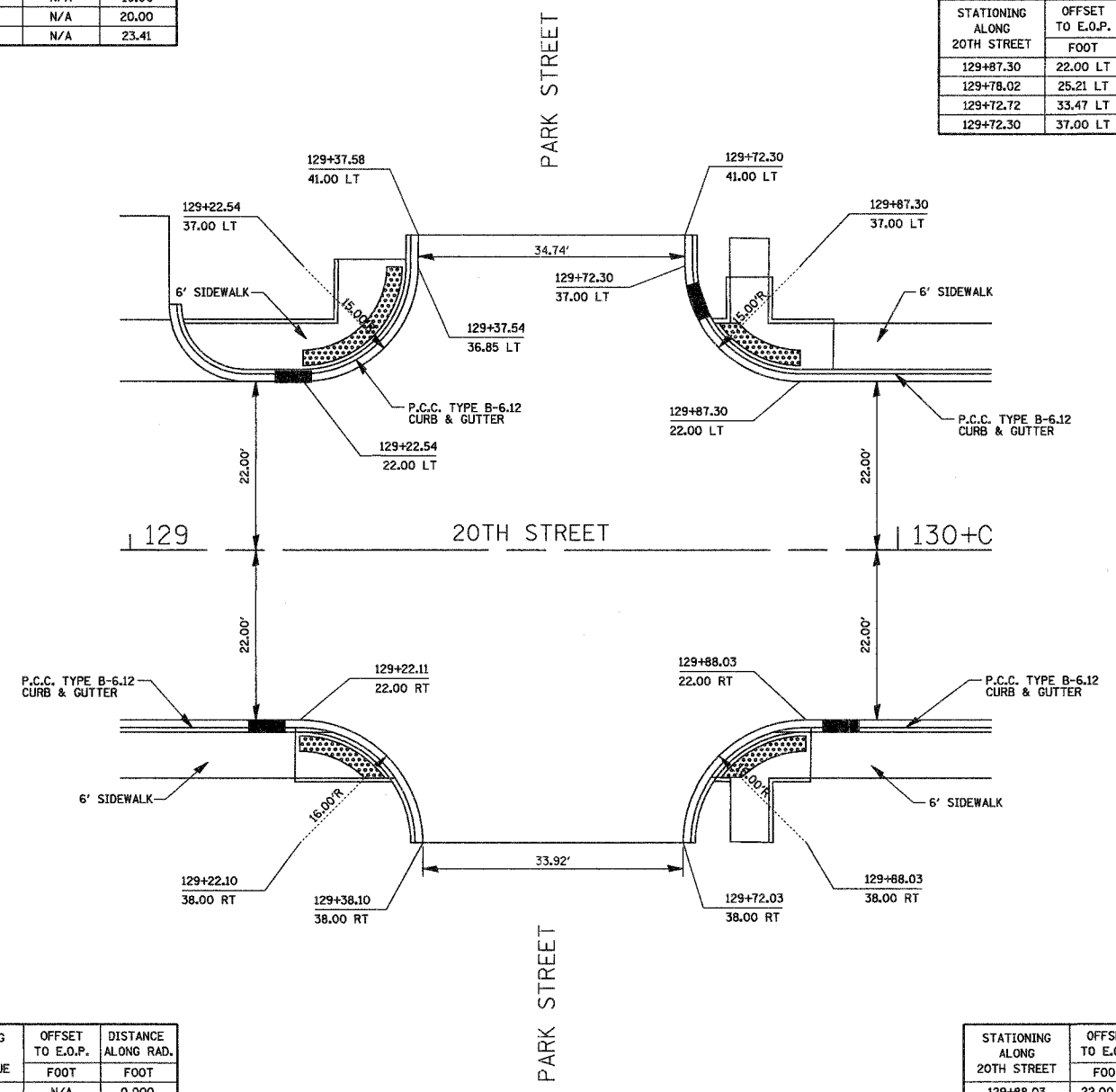

FINAL SURVEY PLOTTED	DATE
NOTE BOOK TEMPLATE	
AREAS CHECKED	
NO.	

ORIGINAL SURVEY PLOTTED	DATE
NOTE BOOK TEMPLATE	
AREAS CHECKED	
NO.	

Juneau Associates, Inc. P.C.
CONSULTING ENGINEERS AND LAND SURVEYORS
2108 State Street, P.O. Box 1115
Granite City, Illinois 62040
Phone: (618) 959-9271-9275
Fax: (618) 959-9241

GEOMETRICS
F.A.U. ROUTE 9089
20TH STREET (PHASES II, III & IV)
GRANITE CITY, ILLINOIS
SECTION No. 04-00180-02-PV

REVISIONS				SCALE: 1 Inch = 10 feet	
NO.	DATE	BY	REMARKS	DSN. BY: BFK	DATE: 12/26/06
				DWN. BY: JJB	DATE: 12/26/06
				CHKD: BFK	DATE: 12/26/06
DWG. NO.				JOB NO. E030204	DGN. NAME: GEO.06

SHEET **55** OF 92 SHTS