

F.A.U. SECTION COUNTY TOTAL SHEETS SHEET NO.
 9089 04-00180-02-PV MADISON 92 66
 FED. ROAD DIST. NO. 1 ILLINOIS FED. AID PROJECT
 CONTRACT NO. 97299

MATCH LINE STA. 133+20.00

MATCH LINE STA. 138+80.00

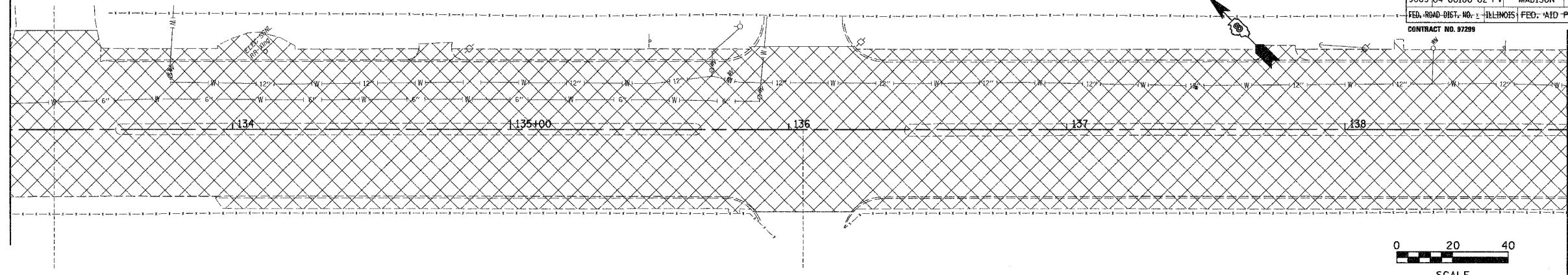

FINAL SURVEYED	BY	DATE
SURVEY PLOTTED		
NOTE BOOK TEMPLATE		
AREAS CHECKED		
NO.		

MATCH LINE STA. 138+80.00

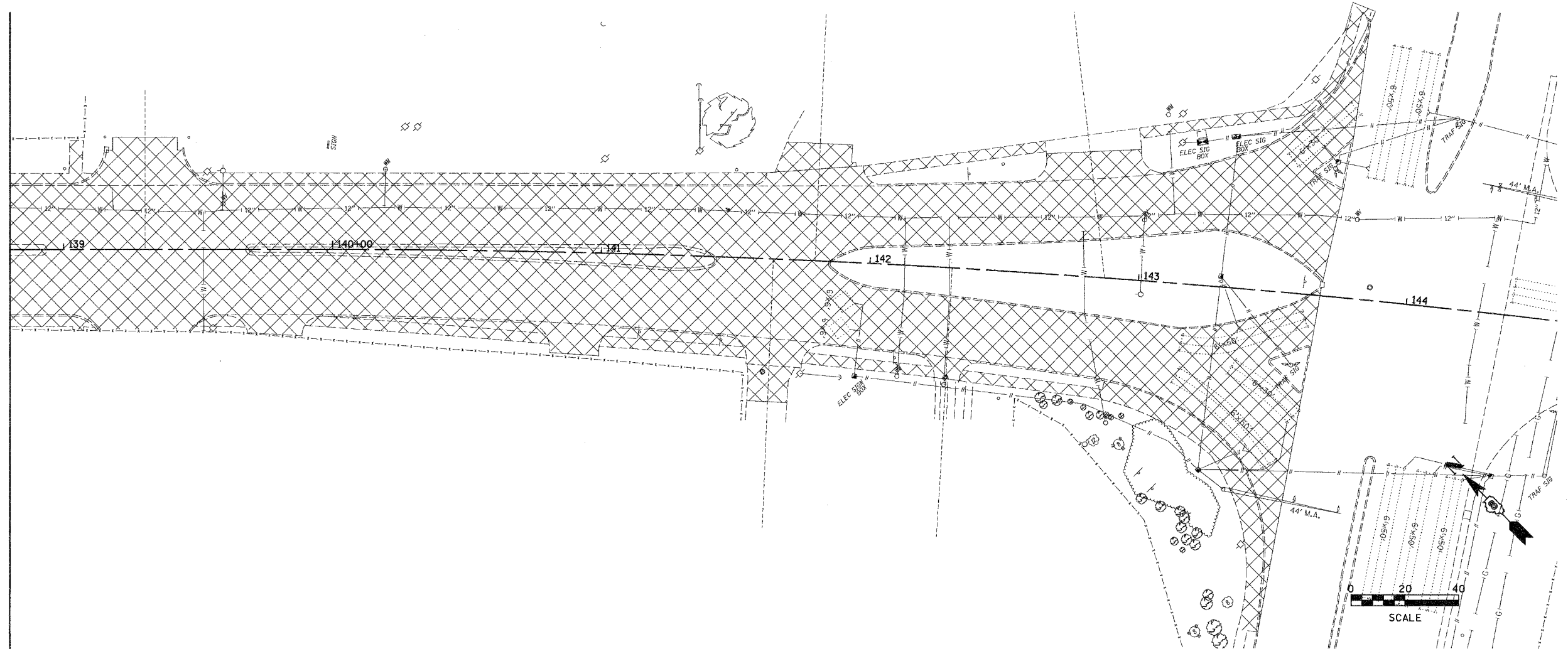

ORIGINAL SURVEYED	BY	DATE
SURVEY PLOTTED		
NOTE BOOK TEMPLATE		
AREAS CHECKED		
NO.		

LEGEND
 REMOVAL
 (TBR) - TO BE REMOVED
 (TBR&R) - TO BE REMOVED AND REPLACED
 (TBR&RBO) - TO BE REMOVED AND REPLACED BY OTHERS

Juneau Associates, Inc. P.C.
 CONSULTING ENGINEERS AND LAND SURVEYORS
 2150 State Street, P.O. Box 1325
 Granite City, Illinois 62040
 Phone: (618) 937-4400 / (618) 937-0305
 Fax: (618) 937-0501

REMOVAL
 F.A.U. ROUTE 9089
 20TH STREET (PHASES II, III & IV)
 GRANITE CITY, ILLINOIS
 SECTION No. 04-00180-02-PV

REVISIONS			
NO.	DATE	BY	REMARKS

SCALE: 1 Inch = 20 feet	SHEET 66
DSN. BY: BFK DATE: 12/26/06	
DWNL BY: DAN DATE: 12/26/06	
CHK'D: BFK DATE: 12/26/06	
DWG. NO. JOB NO. E030204 DGN. NAME: REM.04b	OF 92 SHTS