

F.A. RTE.	SECTION	COUNTY	TOTAL SHEETS	SHEET NO.
*	**	WILLIAMSON	917	125
STA. TO STA.				
FED. ROAD DIST. NO. ILLINOIS FED. AID PROJECT				

* I-57, & OLD IL 13 (FAU 9629)
 ** (X1-6-2)VB-2,(X1-6)HBK-2

STA. 1545+60 (C NB) SKEWED 42° RT. AH.
 EXIST. 36" RCCP EXTEND WITH
 PIPE CULVERTS, CLASS A, TYPE 2 36"
 LT. 12.0', DSFL = 455.47
 RT. 24.0', USFL = 457.04
 CONCRETE COLLAR 0.66 CU. YDS. EACH (SEE DETAIL SHEET)
 CAST-IN-PLACE REINFORCED CONCRETE END SECTIONS 36"
 PIPE CULVERT REMOVAL
 CONCRETE HEADWALL REMOVAL
 EXTENSION RT. MUST BE COMPLETED PRIOR TO I-57 STAGE 3 CONSTRUCTION
 EXTENSION LT. MUST BE COMPLETED PRIOR TO I-57 STAGE 3 CONSTRUCTION

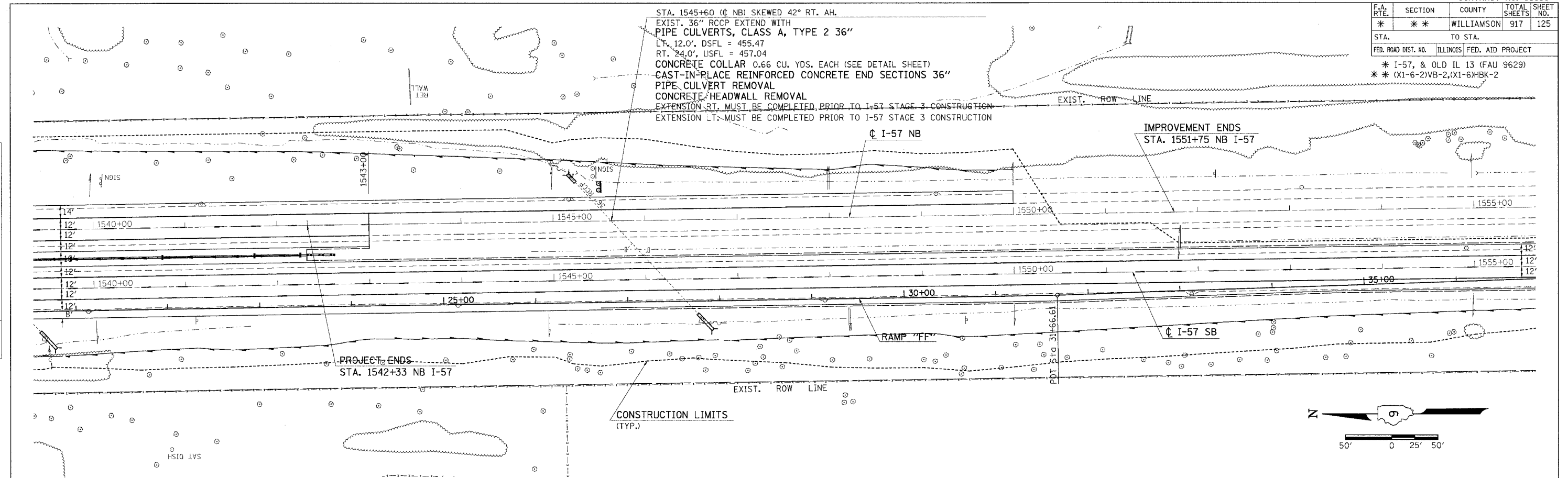

NORTHBOUND



SOUTHBOUND

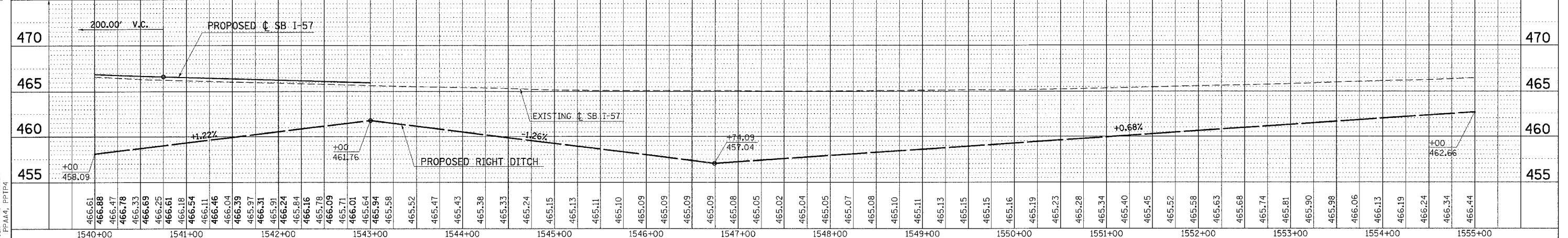

I-57 PLAN - PROFILE STA. 1540+00 TO STA. 1555+00

DATE	BY	REVISION

DATE	BY	REVISION

DATE = 12/7/2006
 FILE NAME = c:\projects\98950\13\1313\1313.dwg
 PLOT SCALE = 1/8" = 1'-0"
 USER NAME = hudson
 PPA04, PPT04