

F.A. RTE.	SECTION	COUNTY	TOTAL SHEETS	SHEET NO.
*	**	WILLIAMSON	917	159

STA. TO STA.
FED. ROAD DIST. NO. ILLINOIS FED. AID PROJECT

* I-57, & OLD IL 13 (FAU 9629)
** (X1-6-2)VB-2,(X1-6)HBK-2

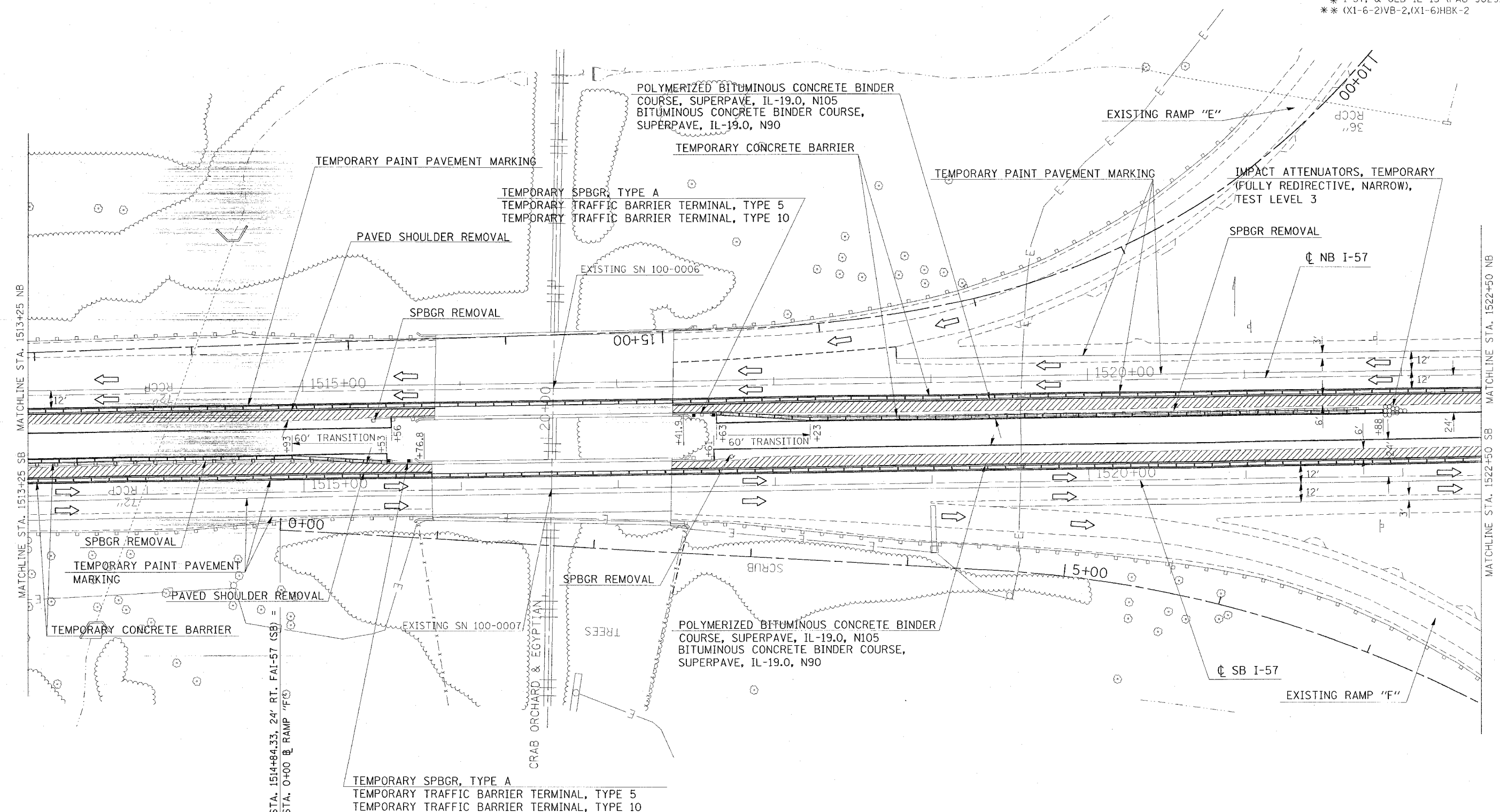

PLOT DATE = 11/30/2006
 FILE NAME = c:\p\projects\98950\1513+25\stage1a.dgn
 PLOT SCALE = 3/8" = 1' IN.
 USER NAME = hudson

STA. 1514+84.33, 24' RT. FAI-57 (SB)
 STA. 0+00 @ RAMP "F"

TEMPORARY SPBGR, TYPE A
 TEMPORARY TRAFFIC BARRIER TERMINAL, TYPE 5
 TEMPORARY TRAFFIC BARRIER TERMINAL, TYPE 10

REVISIONS	
NAME	DATE

ILLINOIS DEPARTMENT OF TRANSPORTATION

FAI-57
STAGE 1A
STA. 1513+25 TO STA. 1522+50
SHEET 5 OF 9

SCALE: VERT. APPROX. 30
DATE: _____ HORIZ. _____ DRAWN BY CNH
CHECKED BY _____