

F.A. RTE.	SECTION	COUNTY	TOTAL SHEETS	SHEET NO.
*	**	WILLIAMSON	917	256
STA. 1520+00.0000 TO STA. 1521+00.0000				
FED. ROAD DIST. NO. ILLINOIS FED. AID PROJECT				
* I-57, & OLD IL 13 (FAU) 9629				
** (X1-6-2)VB-2,(X1-6)HBK-2				

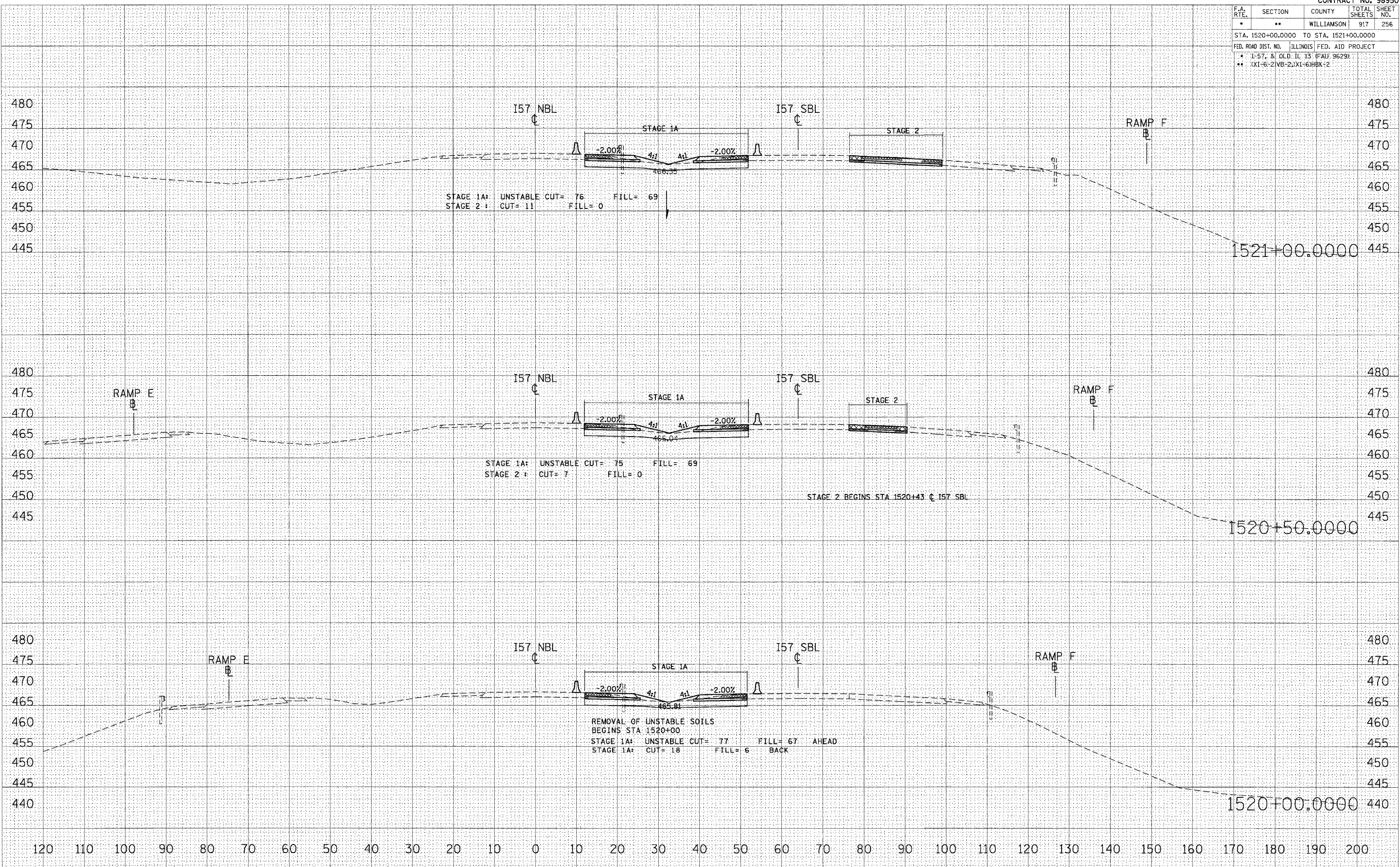

DATE: _____
 BY: _____
 SURVEYED: _____
 PLOTTED: _____
 CHECKED: _____
 NOTE BOOK: _____
 AREAS CHECKED: _____
 NO. _____

DATE: _____
 BY: _____
 SURVEYED: _____
 PLOTTED: _____
 CHECKED: _____
 NOTE BOOK: _____
 AREAS CHECKED: _____
 NO. _____

DATE: 10/25/2008
 FILE NAME: c:\users\mcsa\appdata\local3\zaz157\hshp\hshp.dwg
 PLOT SCALE: 1/8"=1'-0"
 USER NAME: lavenubn

STA 1520+00.0000 TO STA 1521+00.0000 I57 NBL STAGES 1, 1A, 2, & 3