

F.A. RTE.	SECTION	COUNTY	TOTAL SHEETS	SHEET NO.
*	**	WILLIAMSON	917	434

STA. TO STA.
 ILLINOIS FED. AID PROJECT
 * I-57, & OLD IL 13 (FAU 9629)
 ** (X1-6-2)VB-2,(X1-6)HBK-2

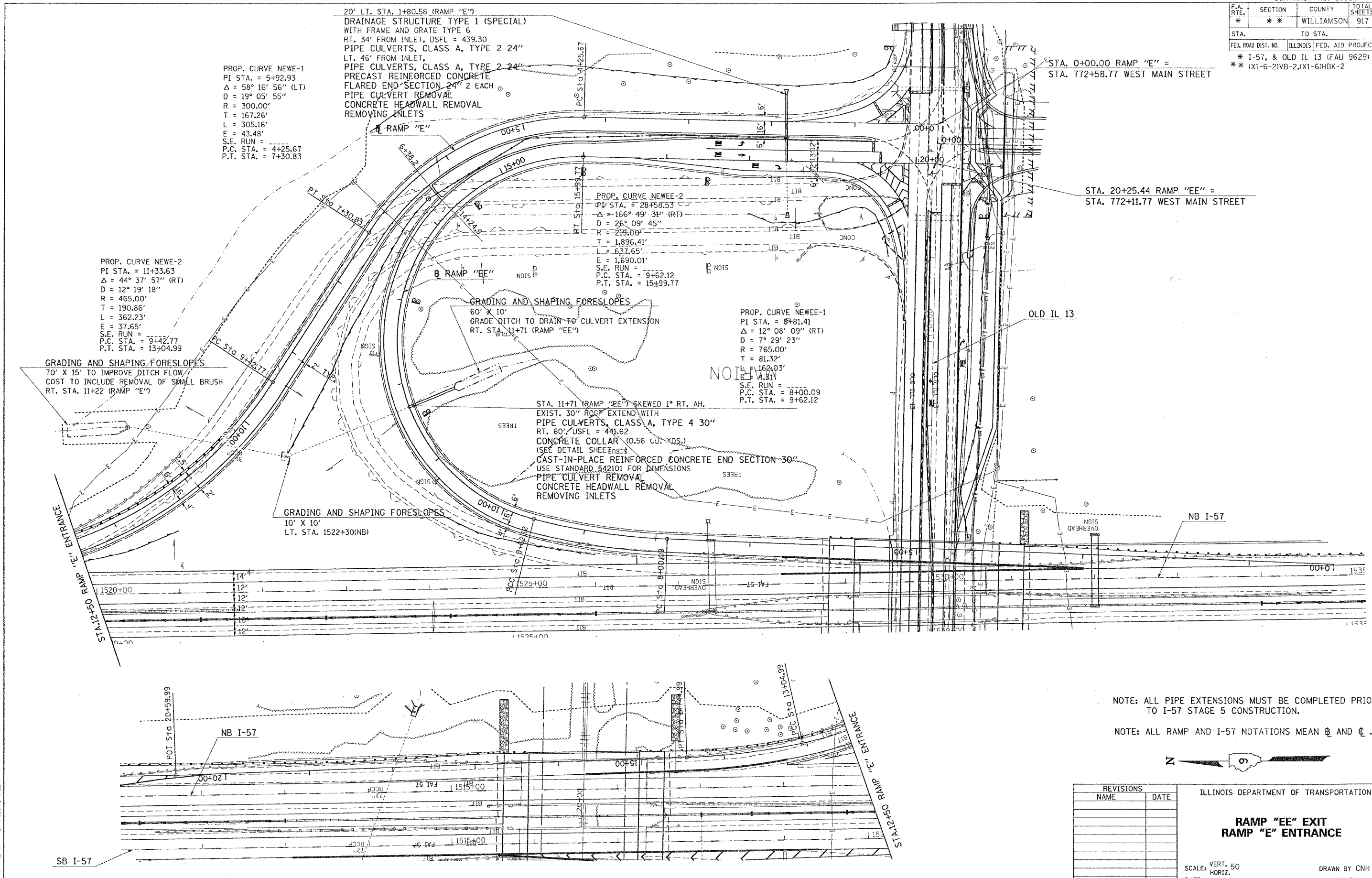

PROP. CURVE NEW-E-1
 PI STA. = 5+92.93
 $\Delta = 58^\circ 16' 56''$ (LT)
 R = 300.00'
 T = 167.26'
 L = 305.16'
 E = 43.48'
 S.E. RUN =
 P.C. STA. = 4+25.67
 P.T. STA. = 7+30.83

PROP. CURVE NEW-E-2
 PI STA. = 11+33.63
 $\Delta = 44^\circ 37' 57''$ (RT)
 R = 465.00'
 T = 190.86'
 L = 362.23'
 E = 37.65'
 S.E. RUN =
 P.C. STA. = 9+42.77
 P.T. STA. = 13+04.99

PROP. CURVE NEW-E-2
 PI STA. = 28+58.53
 $\Delta = 166^\circ 49' 31''$ (RT)
 R = 219.00'
 T = 1,896.41'
 L = 637.65'
 E = 1,690.01'
 S.E. RUN =
 P.C. STA. = 9+62.12
 P.T. STA. = 15+99.77

PROP. CURVE NEW-E-1
 PI STA. = 8+81.41
 $\Delta = 12^\circ 08' 09''$ (RT)
 R = 765.00'
 T = 81.32'
 L = 162.03'
 E = 4.81'
 S.E. RUN =
 P.C. STA. = 8+00.09
 P.T. STA. = 9+62.12

STA. 11+71 (RAMP "EE") SKEWED 1° RT. AH.
 EXIST. 30" RCP EXTEND WITH
 PIPE CULVERTS, CLASS A, TYPE 4 30"
 RT. 60' USFL = 441.62
 CONCRETE COLLAR (0.56 CU. YDS.)
 (SEE DETAIL SHEET)
 CAST-IN-PLACE REINFORCED CONCRETE END SECTION 30"
 USE STANDARD 542101 FOR DIMENSIONS
 PIPE CULVERT REMOVAL
 CONCRETE HEADWALL REMOVAL
 REMOVING INLETS

GRADING AND SHAPING FORESLOPES
 70' X 15' TO IMPROVE DITCH FLOW
 COST TO INCLUDE REMOVAL OF SMALL BRUSH
 RT. STA. 11+22 (RAMP "E")

GRADING AND SHAPING FORESLOPES
 10' X 10'
 LT. STA. 1522+30(NB)

NOTE: ALL PIPE EXTENSIONS MUST BE COMPLETED PRIOR TO I-57 STAGE 5 CONSTRUCTION.
 NOTE: ALL RAMP AND I-57 NOTATIONS MEAN B AND C .



REVISIONS	
NAME	DATE

ILLINOIS DEPARTMENT OF TRANSPORTATION
**RAMP "EE" EXIT
 RAMP "E" ENTRANCE**

SCALE: VERT. 50
 HORIZ. DATE
 DRAWN BY CNH
 CHECKED BY

PLD DATE = 10/11/2006
 PLOT SCALE = 50/2000
 USER NAME = hudson
 TOPORNAME = ARAMPE, AAGEENT, TREENT