

F.A. RTE.	SECTION	COUNTY	TOTAL SHEETS	SHEET NO.
*	**	WILLIAMSON	917	450
STA. 7+00.0000		TO STA. 7+50.0000		
FED. ROAD DIST. NO.		ILLINOIS FED. AID PROJECT		
* I-57, & OLD IL 13 (FAU 9629)		** (X1-6-2)VB-2,(X1-6)HBK-2		

DATE: \_\_\_\_\_ BY: \_\_\_\_\_  
 SURVEYED: \_\_\_\_\_ PLOTTED: \_\_\_\_\_  
 FINAL SURVEY: \_\_\_\_\_ NOTE BOOK: \_\_\_\_\_  
 NO. \_\_\_\_\_ AREAS CHECKED: \_\_\_\_\_

DATE: \_\_\_\_\_ BY: \_\_\_\_\_  
 ORIGINAL SURVEY: \_\_\_\_\_ PLOTTED: \_\_\_\_\_  
 FINAL SURVEY: \_\_\_\_\_ NOTE BOOK: \_\_\_\_\_  
 NO. \_\_\_\_\_ AREAS CHECKED: \_\_\_\_\_

PLOT DATE = 10/26/2005  
 FILE NAME = s:\p02202\p02202.dwg  
 PLOT SCALE = 1/8" = 100'  
 USER NAME = toventarba

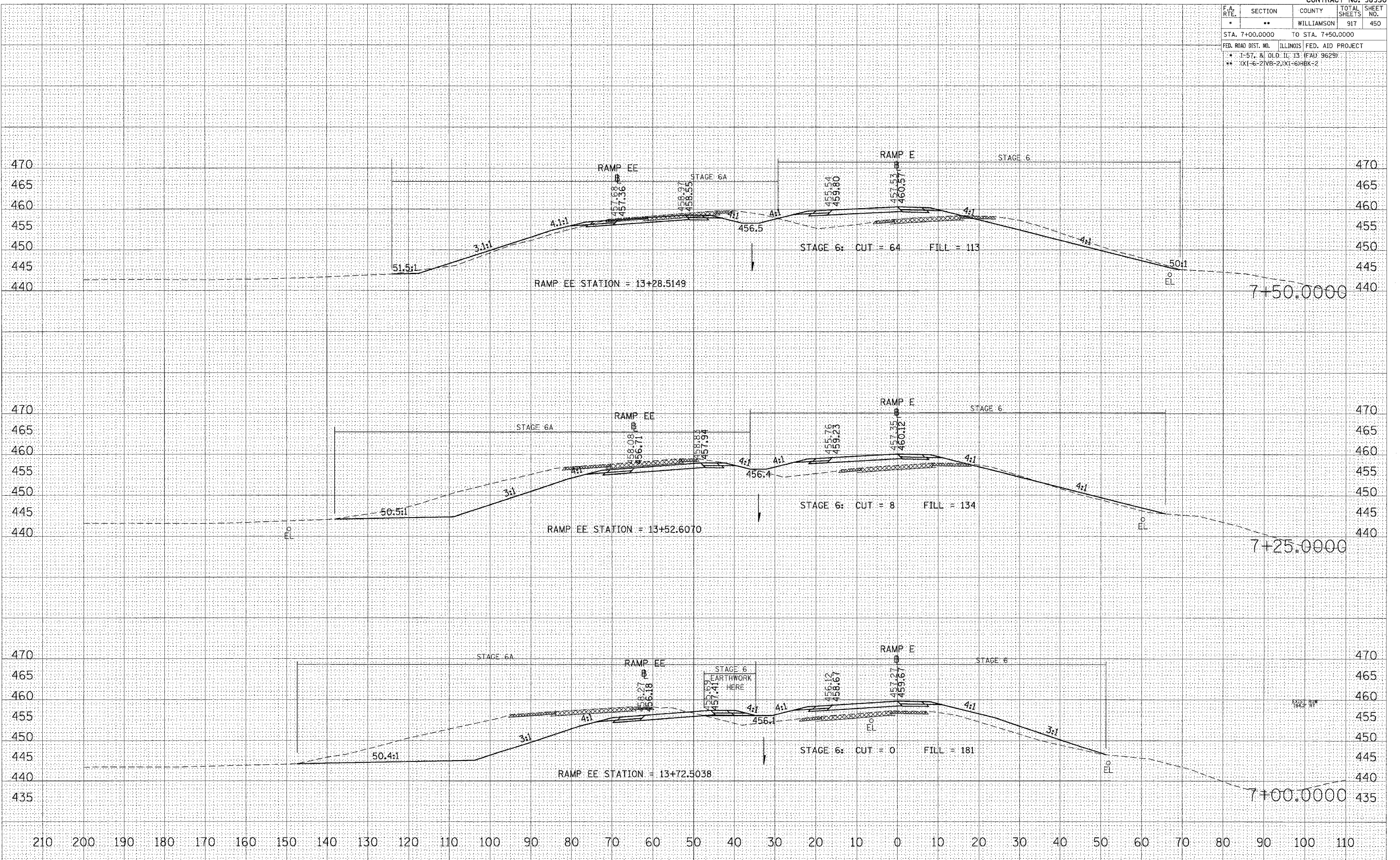

STA 7+00.0000 TO STA 7+50.0000 RAMP E