

F.A. RTE.	SECTION	COUNTY	TOTAL SHEETS	SHEET NO.
*	**	WILLIAMSON	917	566
STA. 1531+00.0000 TO STA. 1532+00.0000				
FED. ROAD DIST. NO. ILLINOIS FED. AID PROJECT				
* 1-57, & OLD. IL. 13 (FAU 9629)				
** 0X1-6-21VB-2, 0X1-61HBK-2				

FINAL SHEET	DATE
SURVEYED	BY
PLOTTED	
TEMPLATE	
NOTE BOOK	
AREAS CHECKED	
NO.	

ORIGINAL SHEET	DATE
SURVEYED	BY
PLOTTED	
TEMPLATE	
NOTE BOOK	
AREAS CHECKED	
NO.	

PLOT DATE = 12/12/2006
 PLOT SCALE = 1/4" = 100'-0"
 USER NAME = jef@schull

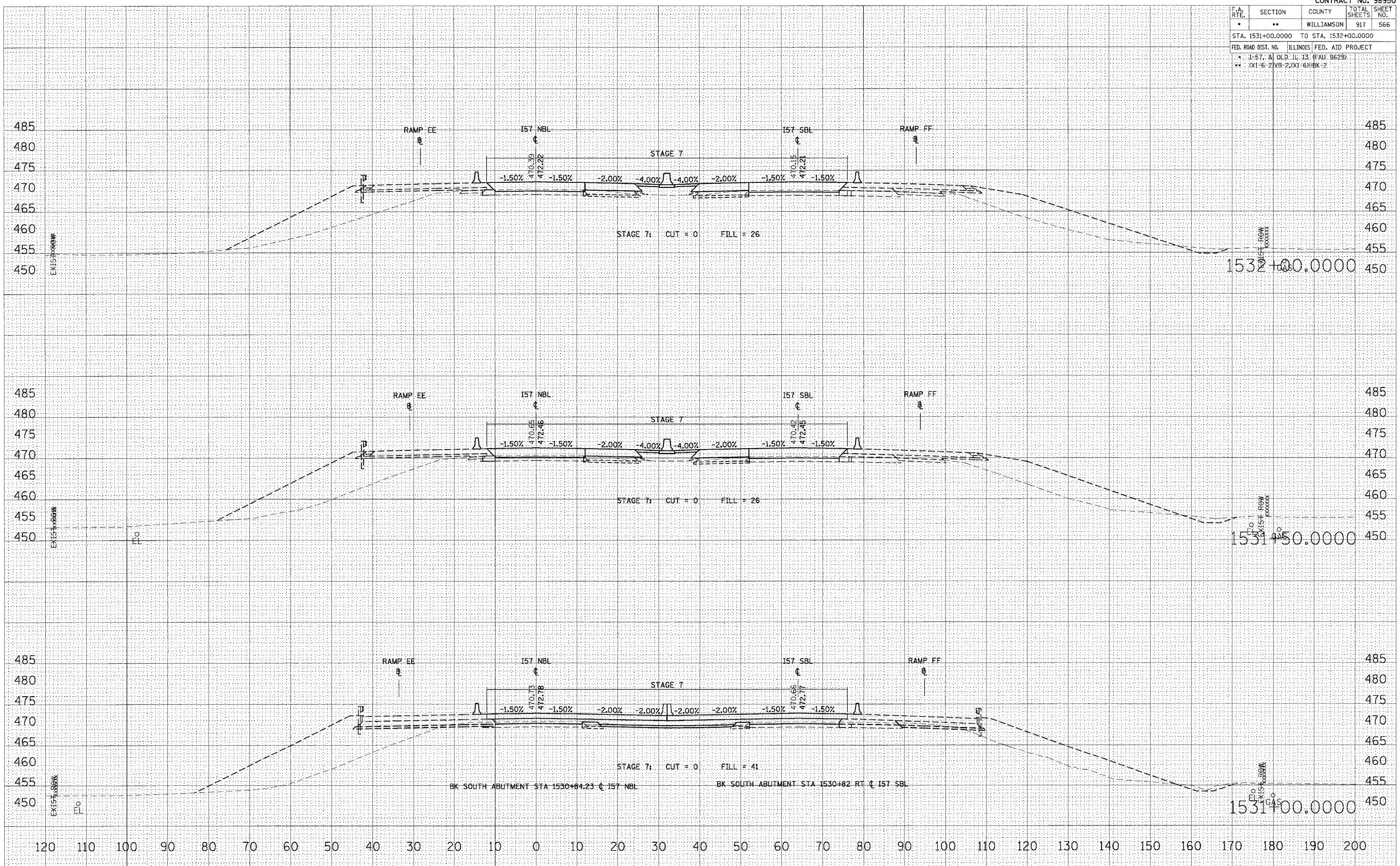

STA 1531+00.0000 TO STA 1532+00.0000 I57 NBL STAGE 7, 7A, 7B & 7C