

F.A. RTE.	SECTION	COUNTY	TOTAL SHEETS	SHEET NO.
*	**	WILLIAMSON	917	658

STA.	TO STA.
FED. ROAD DIST. NO.	ILLINOIS FED. AID PROJECT

* I-57, & OLD IL 13 (FAU 9629)
** (X1-6-2)VB-2,(X1-6)HBK-2



STAGE 5 NOTES

1. PLACE TEMPORARY CONCRETE BARRIER.
2. SHIFT EB TRAFFIC TO THE NORTH.
3. CONSTRUCT PIER.
4. ERECT CENTER STEEL. CANTILEVER CENTER BEAM OVER OPEN TRAFFIC.
5. FLAG TRAFFIC TO ONE LANE AND OPEN 2 LANES AT NIGHT.
6. ERECT SOUTH STEEL.
7. PLACE PROTECTIVE SHIELD AND BUILD DECK.

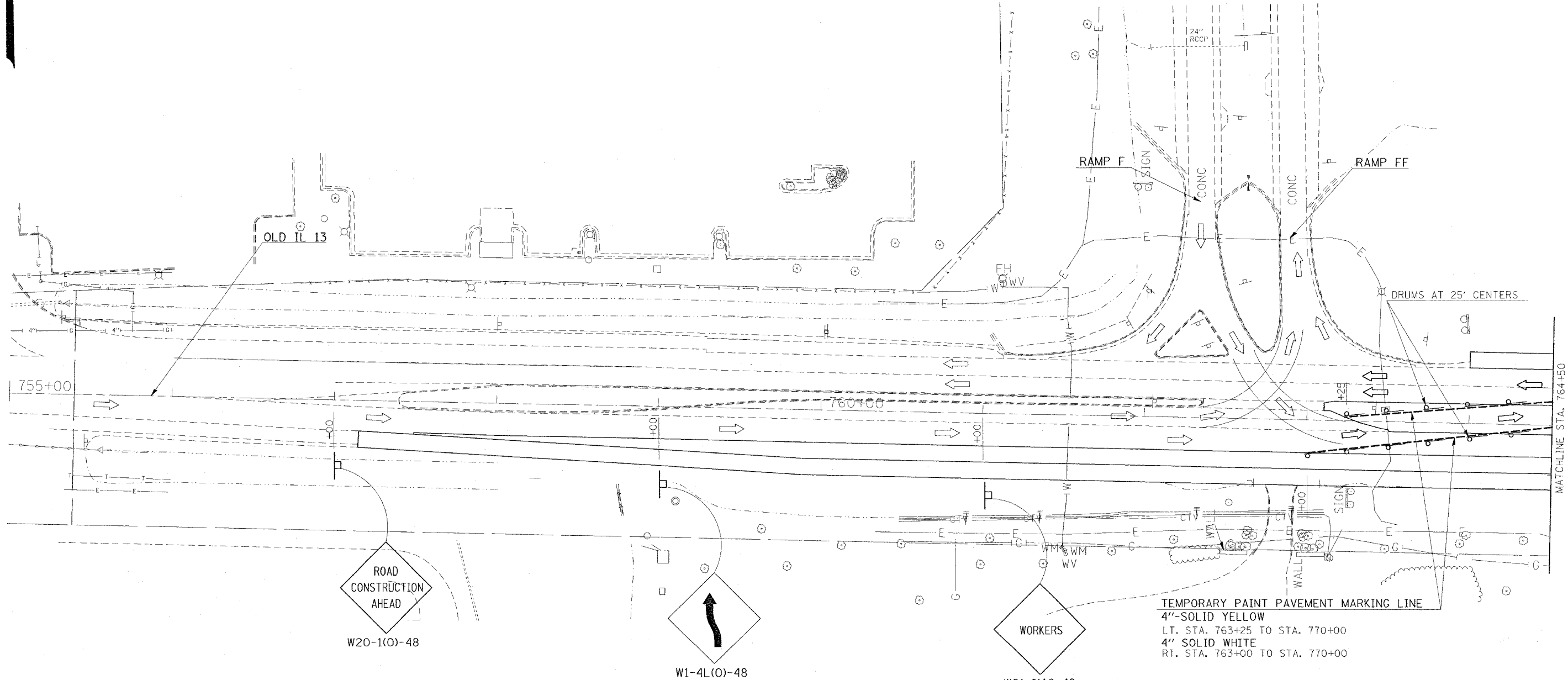

REVISIONS	
NAME	DATE

ILLINOIS DEPARTMENT OF TRANSPORTATION
OLD IL 13
STAGE 5
STA. 755+00 TO STA. 764+50
SHEET 1 OF 2

SCALE: VERT. APPROX. 30
DATE: DRAWN BY CNH
 CHECKED BY LA

PLOT DATE = 12/16/2008
FILE NAME = c:\projects\pr02002\old13\old13stage5.dgn
PLOT SCALE = 30.0000' / 1\"/>
USER NAME = headon