

F.A.P. RTE.	SECTION	COUNTY	TOTAL SHEETS	SHEET NO.
877	101 RS-1	WHITE GALLATIN	22	1

STATE OF ILLINOIS
DEPARTMENT OF TRANSPORTATION
DIVISION OF HIGHWAYS

**PROPOSED
HIGHWAY PLANS**

F.A.P. 877 (ROUTE IL 141)
SECTION 101 RS-1
PROJECT: MA-DB77(012)
~~WHITE GALLATIN~~ COUNTIES
C-99-029-06

FOR INDEX OF SHEETS, SEE SHEET NO. 3
FOR SUMMARY OF QUANTITIES, SEE SHEET NO. 4

IL 141 (FAP 877)
TRAFFIC DATA

	(2005)	(2026)
PC=	1,900	2,345
SU=	275	340
MU=	225	275
ADT=	2,400	2,960

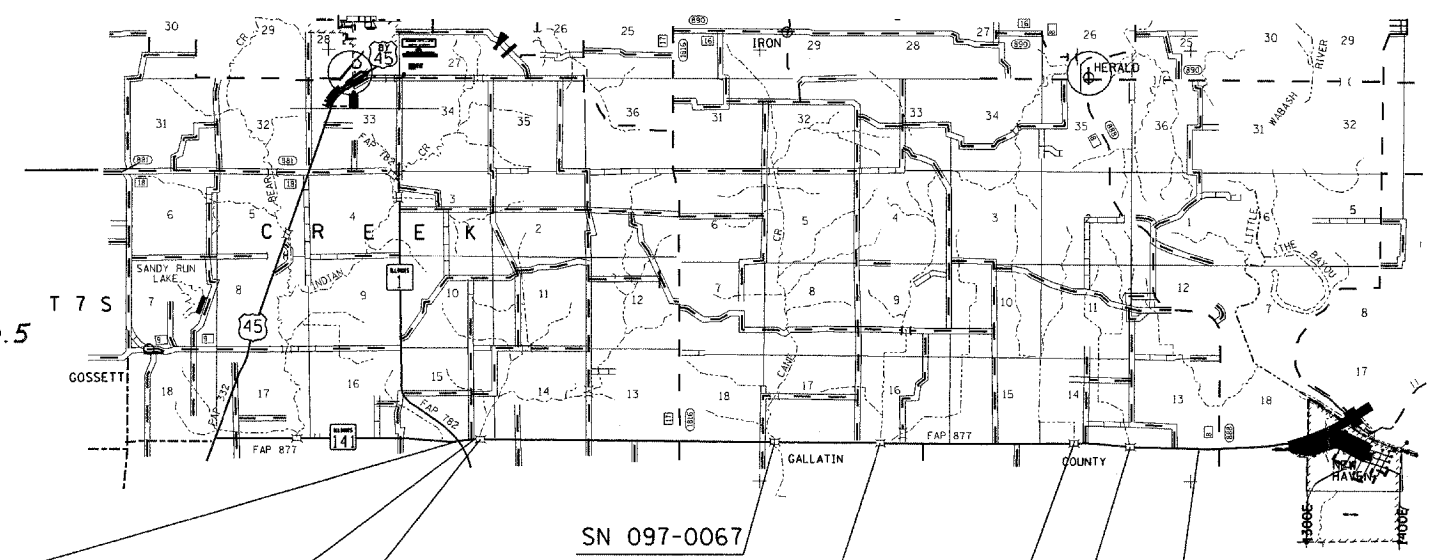
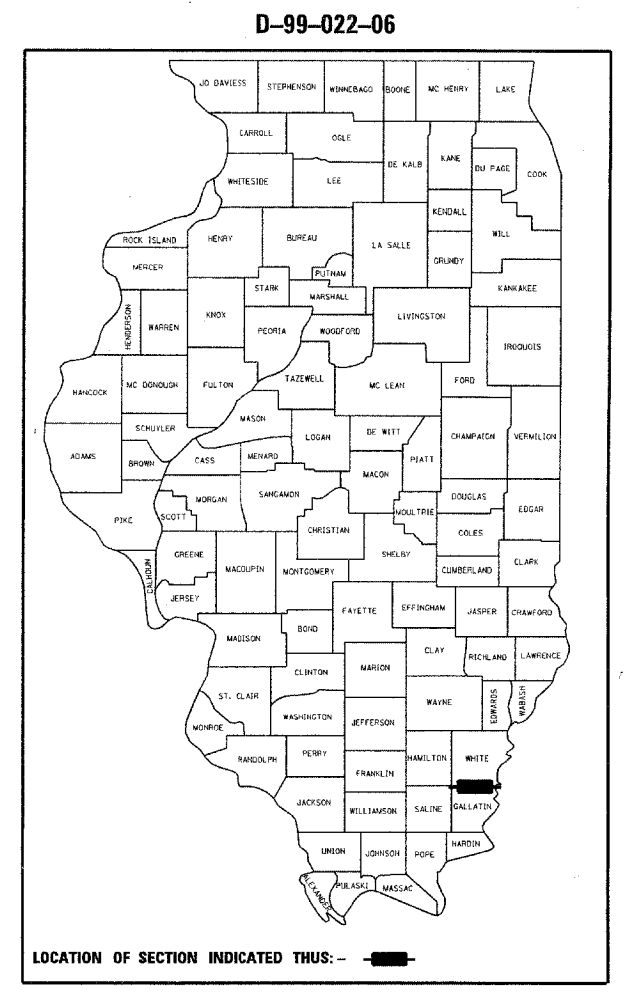

OMISSIONS
SN 097-0036 - STA. 7+10.5 TO STA. 7+53.5
SN 097-0067 - STA. 177+67.5 TO STA. 178+77.5
SN 097-0037 - STA. 239+64 TO STA. 240+06

PROPOSED IMPROVEMENT BEGINS
STA. 145+93 (INTERSECTION OF IL 1/141)

EQUATION STATION
STA. 154+48.58 BK = STA. 6+40.19 AH

PROPOSED IMPROVEMENT ENDS
STA. 425+38 (HERALD RD)

TOWNSHIPS: OMAHA, ASBURY, NEW HAVEN, INDIAN CREEK, HERALDS PRAIRIE, AND EMMA

STATE OF ILLINOIS
DEPARTMENT OF TRANSPORTATION
DIVISION OF HIGHWAYS

SUBMITTED Jan 10 2007
Mark Lami
DEPUTY DIRECTOR OF HIGHWAYS, REGION ENGINEER

March 23, 2007
Eric E. Harms
REGIONAL ENGINEER OF DESIGN AND ENVIRONMENT

March 23, 2007
Mitomp Sees, P.E.
DIRECTOR OF HIGHWAYS, CHIEF ENGINEER

PRINTED BY THE AUTHORITY
OF THE STATE OF ILLINOIS

J.U.L.I.E.
JOINT UTILITY LOCATION INFORMATION FOR EXCAVATION
1-800-892-0123

CONTRACT NO. 98964

NET LENGTH OF PROJECT: 42,558.39 FEET (8.06 MILES)
GROSS LENGTH OF PROJECT: 42,753.39 FEET (8.10 MILES)

PROJECT ENGINEER: CHARLES STEIN
DESIGNER: MELISSA COLE

Rev.