

F.A.E. RTE.	SECTION	COUNTY	TOTAL SHEETS	SHEET NO.
331	2	WILLIAMSON	8	1

D9_PAVEMENT_PRESERVATION_FY07

STATE OF ILLINOIS
DEPARTMENT OF TRANSPORTATION
DIVISION OF HIGHWAYS

**PROPOSED
HIGHWAY PLANS**

FAP ROUTE 331 (IL 13)
SECTION D9 PAVEMENT PRESERVATION FY07

WILLIAMSON COUNTY
C-99-013-07

D-99-006-07

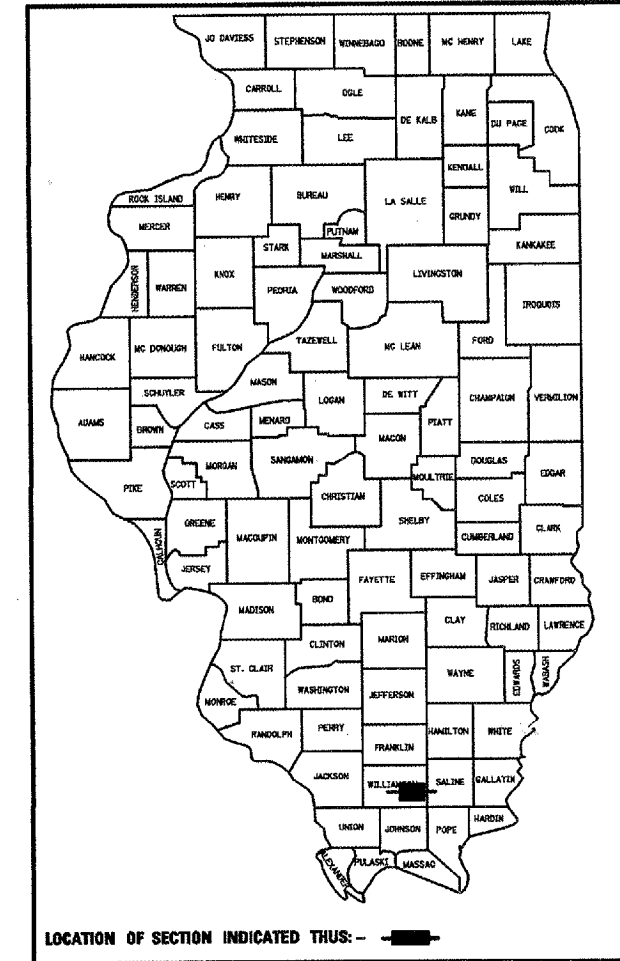

FOR INDEX OF SHEETS, SEE SHEET NO. 3

ADT (2003) 7900
PV = 7600
MU = 400
SU = 300
TRUCK % = 8.4%

PROP. PROJECT - IL 13 (EBL) STA. 341+00 TO STA. 510+00
IN WILLIAMSON COUNTY (EASTBOUND LANES ONLY)

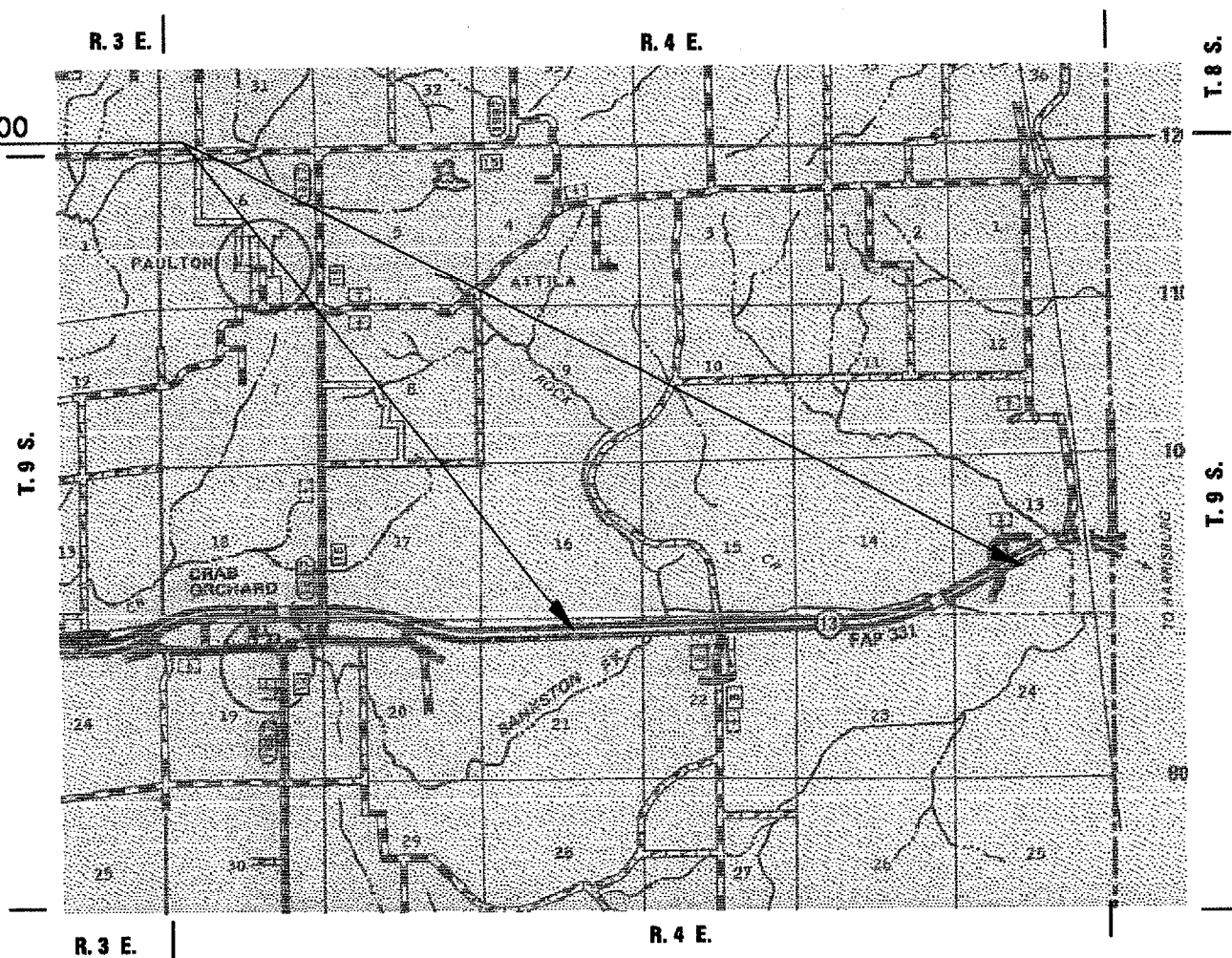

TOWNSHIP: CRAB ORCHARD

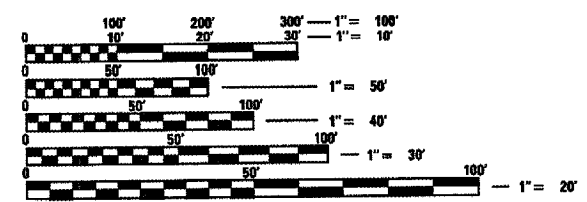

FULL SIZE PLANS HAVE BEEN PREPARED USING STANDARD ENGINEERING SCALES. REDUCED SIZED PLANS WILL NOT CONFORM TO STANDARD SCALES. IN MAKING MEASUREMENTS ON REDUCED PLANS, THE ABOVE SCALES MAY BE USED.

J.U.L.I.E.
JOINT UTILITY LOCATION INFORMATION FOR EXCAVATION
1-800-892-0123

CONTRACT NO. 98995

LENGTH OF PROJECT: 16,691 FT. = 3.161 MILES

STATE OF ILLINOIS
DEPARTMENT OF TRANSPORTATION
DIVISION OF HIGHWAYS

SUBMITTED Jan 10, 20 07
Mar C. Rami
DEPUTY DIRECTOR OF HIGHWAYS, REGION ENGINEER

March 23, 20 07
Eric E. Harms
INTERIM ENGINEER OF DESIGN AND ENVIRONMENT

March 23, 20 07
Milton R. See, P.E.
DIRECTOR OF HIGHWAYS, CHIEF ENGINEER

**PRINTED BY THE AUTHORITY
OF THE STATE OF ILLINOIS**