

F.A.E. RTE.	SECTION	COUNTY	TOTAL SHEETS	SHEET NO.
331	2	WILLIAMSON	8	1

D9_PAVEMENT_PRESERVATION_FY07

STATE OF ILLINOIS
DEPARTMENT OF TRANSPORTATION
DIVISION OF HIGHWAYS

**PROPOSED
HIGHWAY PLANS**

FAP ROUTE 331 (IL 13)
SECTION D9 PAVEMENT PRESERVATION FY07

WILLIAMSON COUNTY
C-99-013-07

D-99-006-07



FOR INDEX OF SHEETS, SEE SHEET NO. 3

ADT (2003) 7900
PV = 7600
MU = 400
SU = 300
TRUCK % = 8.4%

PROP. PROJECT - IL 13 (EBL) STA. 341+00 TO STA. 510+00
IN WILLIAMSON COUNTY (EASTBOUND LANES ONLY)

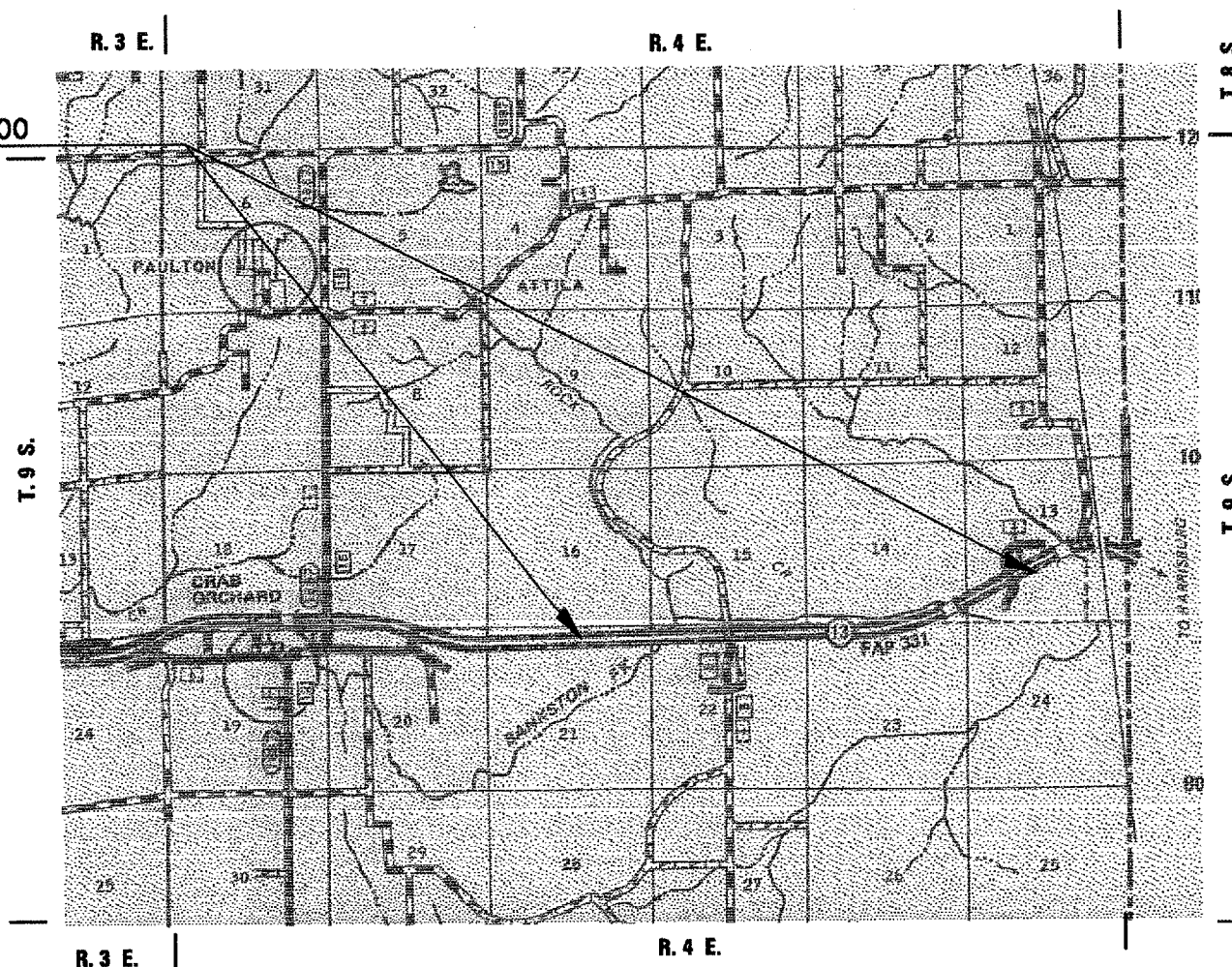

TOWNSHIP: CRAB ORCHARD

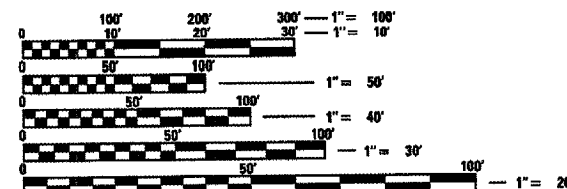

FULL SIZE PLANS HAVE BEEN PREPARED USING STANDARD ENGINEERING SCALES. REDUCED SIZED PLANS WILL NOT CONFORM TO STANDARD SCALES. IN MAKING MEASUREMENTS ON REDUCED PLANS, THE ABOVE SCALES MAY BE USED.

J.U.L.I.E.
JOINT UTILITY LOCATION INFORMATION FOR EXCAVATION
1-800-892-0123

CONTRACT NO. 98995

LENGTH OF PROJECT: 16,691 FT. = 3.161 MILES

STATE OF ILLINOIS
DEPARTMENT OF TRANSPORTATION
DIVISION OF HIGHWAYS

SUBMITTED Jan 10, 20 07
Mar C. Rami
DEPUTY DIRECTOR OF HIGHWAYS, REGION ENGINEER

March 23, 20 07
Eric E. Harms
INTERIM ENGINEER OF DESIGN AND ENVIRONMENT

March 23, 20 07
Robert R. See, P.E.
DIRECTOR OF HIGHWAYS, CHIEF ENGINEER

**PRINTED BY THE AUTHORITY
OF THE STATE OF ILLINOIS**

FAP RTE	SECTION	COUNTY	TOTAL SHEETS	SHEET NO.
331	•	WILLIAMSON	8	2
STA.		TO STA.		
FED. ROAD DIST. NO.		ALIGNED	FED. AID PROJECT	

*09 PAVEMENT PRESERVATION FY 07

Prepared By:	<i>Joe Blankenship</i> DISTRICT STUDIES & PLANS ENGINEER
Examined By:	<i>James Travis Eney</i> DISTRICT LAND ACQUISITION ENGINEER
Examined By:	<i>Cornie Nelson</i> DISTRICT PROGRAM DEVELOPMENT ENGINEER
Examined By:	<i>Kevin Grammer</i> DISTRICT OPERATIONS ENGINEER
Examined By:	<i>Joseph Lynn</i> DISTRICT CONSTRUCTION ENGINEER
Examined By:	<i>Bruce DeBlaz</i> DISTRICT MATERIALS ENGINEER
Examined By:	<i>John Smother</i> DISTRICT PROJECT IMPLEMENTATION ENGINEER
Examined By:	<i>Ann L. Dayton</i> ASSISTANT REGIONAL ENGINEER
Approved By:	<i>Way Chamis</i> DEPUTY DIRECTOR OF HIGHWAYS, REGION ENGINEER
	DATE <i>Jan 10</i> 2007

SIGNATURE BLOCK

F.A.P. RTE.	SECTION	COUNTY	TOTAL SHEETS	SHEET NO.
331	2	WILLIAMSON	8	3
STA. _____		TO STA. _____		
FED. ROAD DIST. NO. _____		ILLINOIS FED. AID PROJECT		
*09_PAVEMENT_PRESERVATION_EY0Z				

INDEX OF SHEETS

SHEET NO.	DESCRIPTION
1	COVER SHEET
2	SIGNATURE BLOCK
3	INDEX OF SHEETS; HIGHWAY STANDARDS; STRUCTURE RATINGS; GENERAL NOTES
4 - 5	TYPICAL SECTIONS
6	SUMMARY OF QUANTITIES
7	RESURFACING SCHEDULE, PAVEMENT MARKING SCHEDULE
8	LOCATION MAP - FAP 331 (IL. 13) EASTBOUND LANES NEAR WILLIAMSON/SALINE COUNTY LINE

HIGHWAY STANDARDS

- 701400-02
- 701406-04
- 701426-02
- 702001-06

STRUCTURE RATINGS

STRUCTURE NO.	INV. RATING	OPER. RATING	SUFF. RATING
FAP 331 (IL. 13) EASTBOUND LANES			
100-0071	22.8	36.7	96.5

GENERAL NOTES

THE THICKNESS OF BITUMINOUS MIXTURE SHOWN ON THE PLANS IS THE NOMINAL THICKNESS. DEVIATIONS FROM THE NOMINAL THICKNESS WILL BE PERMITTED WHEN SUCH DEVIATIONS OCCUR DUE TO IRREGULARITIES IN THE EXISTING SURFACE OR BASE ON WHICH THE BITUMINOUS MIXTURE IS PLACED.

FACTORS USED FOR ESTIMATING PLAN QUANTITIES ARE AS FOLLOWS AND SHALL NOT BE USED FOR THE BASIS OF FINAL QUANTITIES EXCEPT FOR QC/QA OF BITUMINOUS MIXTURES:

ALL BITUMINOUS CONCRETE.....2.016 TONS/CU.YD.
 ALL AGGREGATE.....2.05 TONS/CU.YD.

BITUMINOUS MATERIALS (PRIME COAT)
 ON PAVEMENT.....0.09 GAL/SQ YD
 ON AGG. SURF.....0.32GAL/SQ. YD.

AGGREGATE (PRIME COAT).....0.0015 TONS/SQ. YD.

THE QUANTITY OF SHORT TERM PAVEMENT MARKING SHOWN IN THE PLANS WAS BASED ON ONE APPLICATION EACH FOR THE PRIME COAT AND SURFACE TREATMENT.

PRIOR TO PLACEMENT OF THE FINAL PAVEMENT MARKINGS THE RESIDENT ENGINEER SHOULD CONTACT THE BUREAU OF OPERATIONS AND ARRANGE FOR INSPECTION AND APPROVAL OF THE PAVEMENT MARKING LAYOUT.

THE CONTRACTOR SHALL PRESERVE EXISTING STAMPED STATIONING.

THE CONTRACTOR SHALL DEVISE AND SUBMIT A JOINT PLAN THAT MEETS THE APPROVAL OF THE ENGINEER. THE SEAMS SHOULD BE STAGGERED SO THAT THEY DON'T BUILD UP A HUMP OR CRACK OPEN. THE CONTRACTOR SHOULD FOLLOW THE EXISTING HOT-MIX LAYOUT AS CLOSELY AS POSSIBLE. EACH INDIVIDUAL LANE SHOULD BE DONE EDGE TO EDGE IN ONE PASS. SHOULDERS SHALL BE DONE SEPARATELY.

UNLESS OTHERWISE DIRECTED BY THE ENGINEER, BITUMINOUS RESURFACING SHALL BE PLACED IN A SEQUENCE THAT WILL MINIMIZE THE TIME THE CENTER-LINE EDGE IS EXPOSED TO TRAFFIC.

THE AGGREGATE TO BE USED IN THE MICRO-SURFACING SHALL BE TYPE III APPLIED AT 18 LB/SQ YD PER PASS.

BITUMINOUS MATERIAL (PRIME COAT) SHALL BE APPLIED PRIOR TO PLACING MICRO-SURFACING AT A RATE OF 0.05 - 0.10 GAL/SQ. YD.

F.A.P. RTE.	SECTION	COUNTY	TOTAL SHEETS	SHEET NO.
331	2.	WILLIAMSON	8	4
STA. _____		TO STA. _____		
FED. ROAD DIST. NO. _____		ILLINOIS FED. AID PROJECT _____		

*09 PAVEMENT PRESERVATION FY07

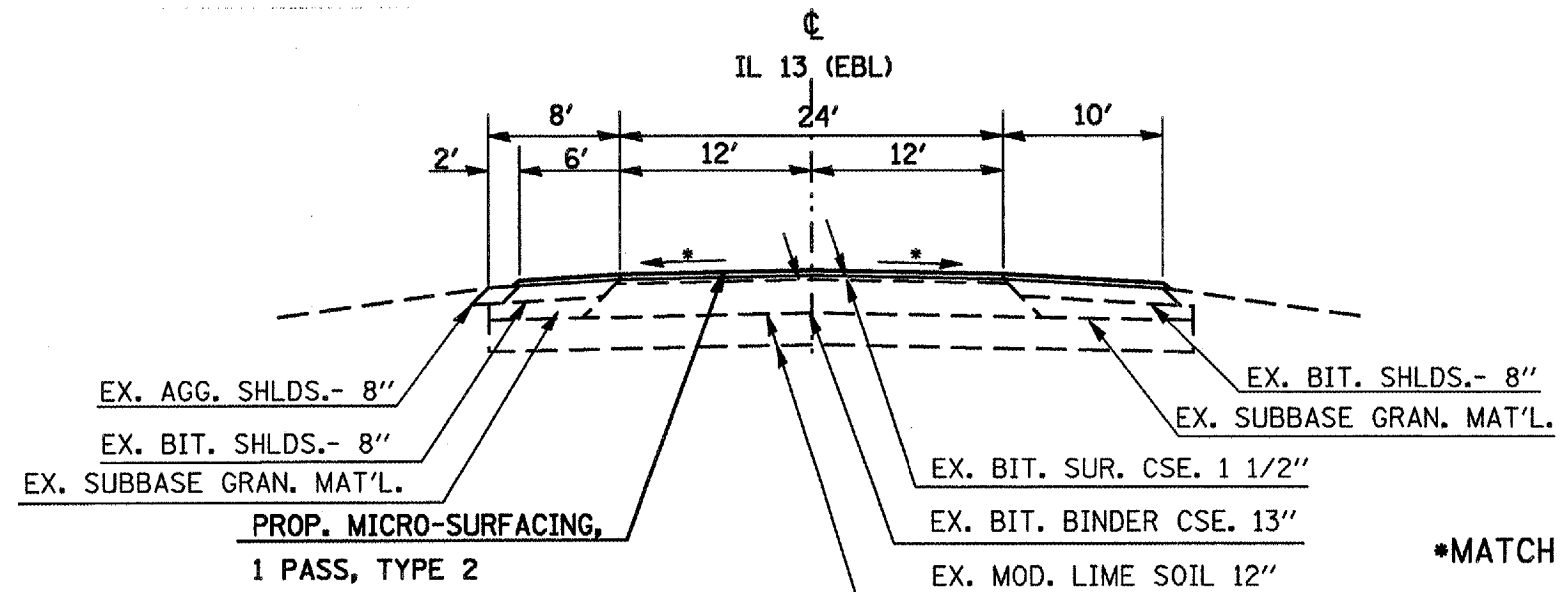

*MATCH EXISTING SLOPE.

TO BE USED:
 STA. 341+00 TO STA. 396+50
 STA. 402+00 TO STA. 477+36**
 STA. 479+45** TO STA. 493+50
 STA. 495+05 TO STA. 510+00

** EXISTING S.N. 100-0071 OMITTED BETWEEN STA. 477+36 TO STA. 479+45.

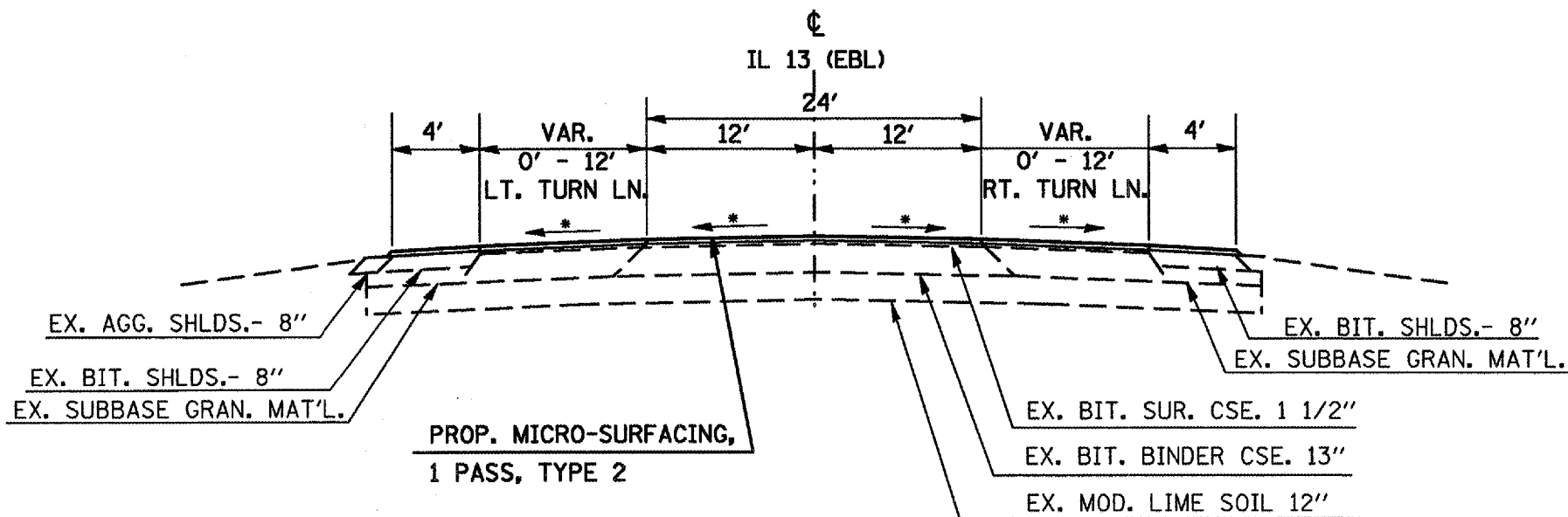

TO BE USED:
 STA. STA. 396+50 TO STA. 402+00

PLOT DATE = 1/15/2007
 FILE NAME = c:\pav\mca\28995\28995.dwg
 PLOT SCALE = 1/8" = 1'-0"
 USER NAME = mcorrad

CONTRACT NO.			
F.A.P. RTE.	SECTION	COUNTY	TOTAL SHEETS
331		WILLIAMSON	8
STA. _____		TO STA. _____	
FED. ROAD DIST. NO. _____		ILLINOIS FED. AID PROJECT	

#D9 PAVEMENT PRESERVATION FY07

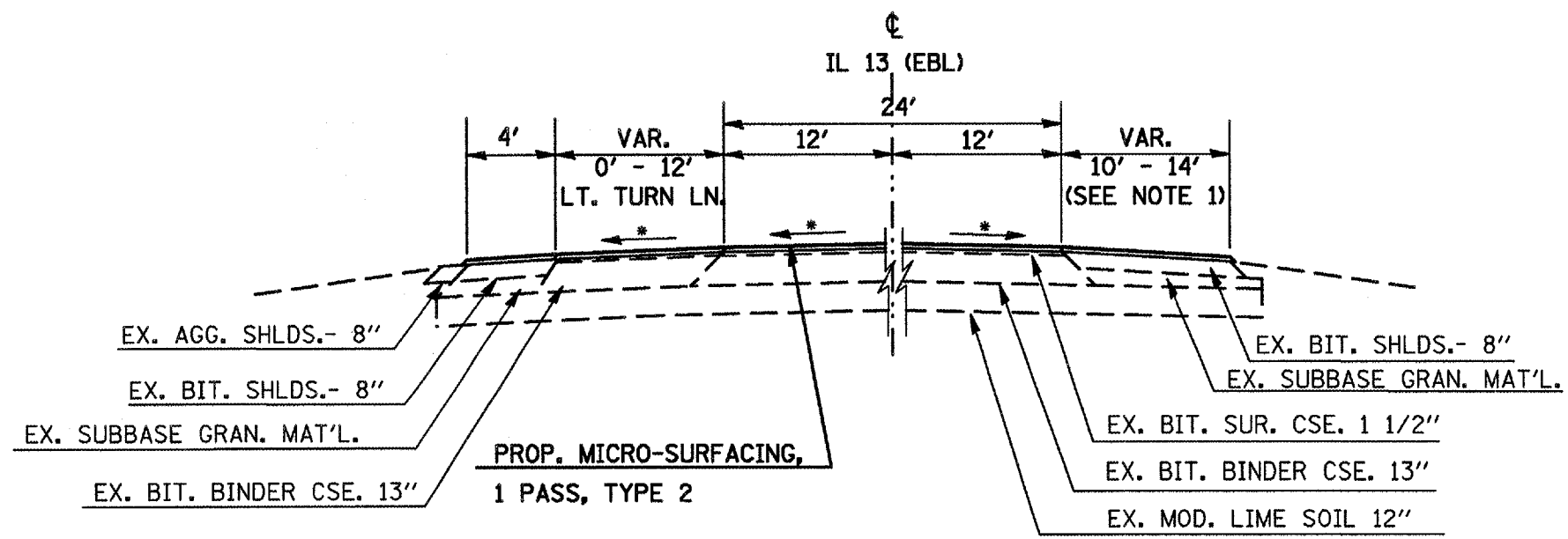

TO BE USED:
 LT. STA. 493+50
 TO LT. STA. 499+05

TO BE USED:
 RT. STA. 423+80
 TO RT. STA. 440+00

NOTE 1: EXISTING BITUMINOUS SHOULDERS AT LEFT AND EXISTING PORTABLE SCALE TURNOUT LANE AT RIGHT TO BE RESURFACED WITH MICRO-SURFACING, 1 PASS, TYPE 2.

*MATCH EXISTING SLOPE

PLT DATE = 1/16/2007
 FILE NAME = c:\pav\hwy\331\331-07-01.dwg
 PLT SCALE = 1/8"=1'-0"
 USER NAME = mcorcoran

F.A.P. RTE.	SECTION	COUNTY	TOTAL SHEETS	SHEET NO.
331	*	WILLIAMSON	8	7
STA.		TO STA.		
FED. ROAD DIST. NO.		ILLINOIS FED. AID PROJECT		
*09_PAVEMENT_PRESERVATION_EY07				

RESURFACING SCHEDULE

LOCATION - STATION TO STATION	LENGTH	ROADWAY WIDTH	ROADWAY AREA	SHOULDER WIDTH	MICRO-SURF., 1 PASS, TY. 2	BIT. MATLS. (PR. CT.)	FIBER-ASPHALT	NOTES	
	FOR INFORMATIONAL PURPOSE ONLY								
	(FT)	(FT)	(SQ YD)	(FT)	(SQ YD)	(GAL)	(POUND)		
IL 13 - STA. 341+00 TO STA. 510+00									
341+00 TO 477+36	13636.0	24.0	36363		36363	3273	22,268	MAINLINE	
STR. NO. 100-0071 OMIT STA. 477+36 TO STA. 479+45									
479+45 TO 510+00	3055.0	24.0	8147		8147	733	4,438	MAINLINE	
LT 396+50 TO 402+00	550.0	12.0	733		600	54		LT TURN LN	
LT 493+50 TO 499+05	555.0	12.0	740		606	55		LT TURN LN	
RT 396+50 TO 402+00	550.0	12.0	733		600	54		RT TURN LN	
LT 340+00 TO 510+00	16606.0		11007	6.0	10,941	985	6,602	LT SHLD	
RT 340+00 TO 510+00	16556.0		18600	10.0	18,489	1664	6,582	RT SHLD	
					75,746	6818	39,890		

* Right shoulder width varies 10' to 14' from Sta. 423+80 to Sta. 437+50 for portable scales area.

PAVEMENT MARKING SCHEDULE

STATION TO STATION	THPL PAVEMENT MARKING				TEMPORARY		NOTES
	4 INCH WHITE	4 INCH YELLOW	4 INCH SKIP-DASH YELLOW	LETTERS & SYMBOLS	4 INCH	LETTERS & SYMBOLS	
	FOOT	FOOT	FOOT	SQ FT	FOOT	SQ FT	
IL 13 - STA. 341+00 TO STA. 510+00							
341+00.0 TO 477+36.0	13,586.0	13,436.0	3,409.0		30,431.0		Edge line
OMIT STRUCTURE STR. NO. 100-0071 - STA. 477+36 TO STA. 479+45							
479+45.0 TO 510+00.0	2,970.0	2,970.0	764.0		6,704.0		Edge line
LT 398+50.0 TO 400+50.0	200.0				200.0		L+ Turn Ln
LT 398+50.0				20.8		20.8	Only
LT 398+78.0				15.6		15.6	L+ Turn Arrow
LT 495+75.0 TO 497+75.0	200.0				200.0		L+ Turn Ln
LT 495+75.0				20.8		20.8	Only
LT 496+03.0				15.6		15.6	L+ Turn Arrow
RT 398+50.0 TO 400+50.0	200.0				200.0		R+ Turn Ln
RT 398+50.0				20.8		20.8	Only
RT 398+78.0				15.6		15.6	R+ Turn Arrow
SUB-TOTALS	17,156.0	16,406.0	4,173.0	109.2	37,735.0	109.2	
TOTALS		37,735.0		109.2	37,735.0	109.2	

PLOT DATE = 1/23/2007
 FILE NAME = c:\pavement\98995\98995.dwg
 PLOT NAME = 09PAV07 / IN
 USER NAME = jharriss

F.A.P. RTE.	SECTION	COUNTY	TOTAL SHEETS	SHEET NO.
331	5	WILLIAMSON	8	8
STA. _____		TO STA. _____		
FED. ROAD DIST. NO. _____		ILLINOIS FED. AID PROJECT _____		

09_PAVEMENT_PRESERVATION_FY07

LOCATION 3 MAP IL 13 AT WILLIAMSON/SALINE CO. LINE

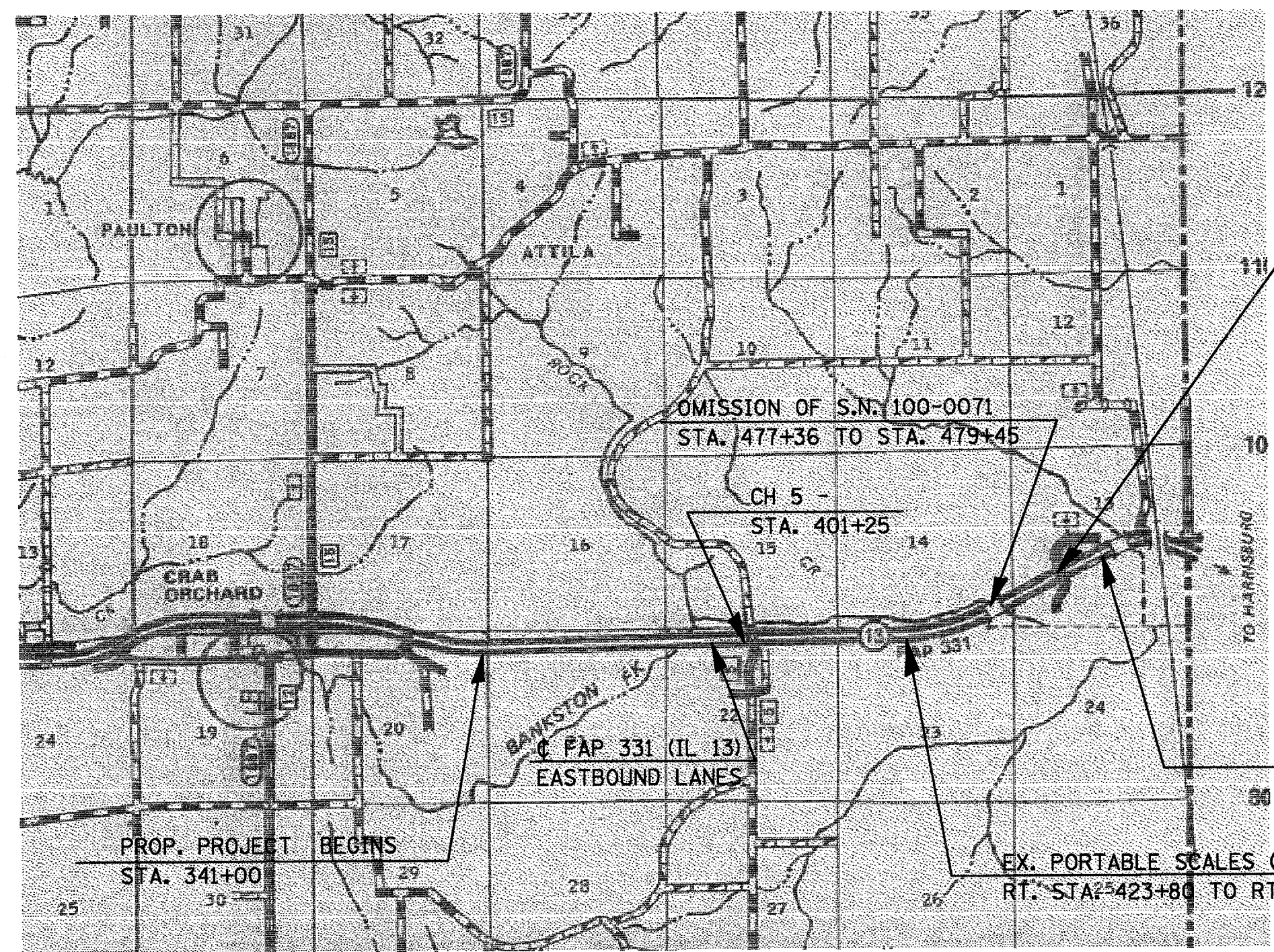

ACCESS RD.-
STA. 498+34.73

PROP. PROJECT ENDS
STA. 510+00

EX. PORTABLE SCALES (14' BIT. SHLD)
RT. STA. 423+80 TO RT. STA. 440+00

PROP. PROJECT BEGINS
STA. 341+00

FAP 331 (IL 13)
EASTBOUND LANES

OMISSION OF S.N. 100-0071
STA. 477+36 TO STA. 479+45

CH 5 -
STA. 401+25

PLOT DATE: 1/4/2007
 FILE NAME: \\nrc\maps\98995\98995_080807.mxd
 PLOT SCALE: 854.176 / IN.
 USER NAME: mason@illinois.gov