

ROUTE	SECTION	COUNTY	TOT. SHTS.	SHT.
FAS 789	95-00158-00-BR	JEFFERSON	12	2
JEFFERSON COUNTY				

KENNETH MICHAEL  
NE 1/4 NE 1/4 SEC. 7, T.1 S., R.4 E., 3rd P.M.

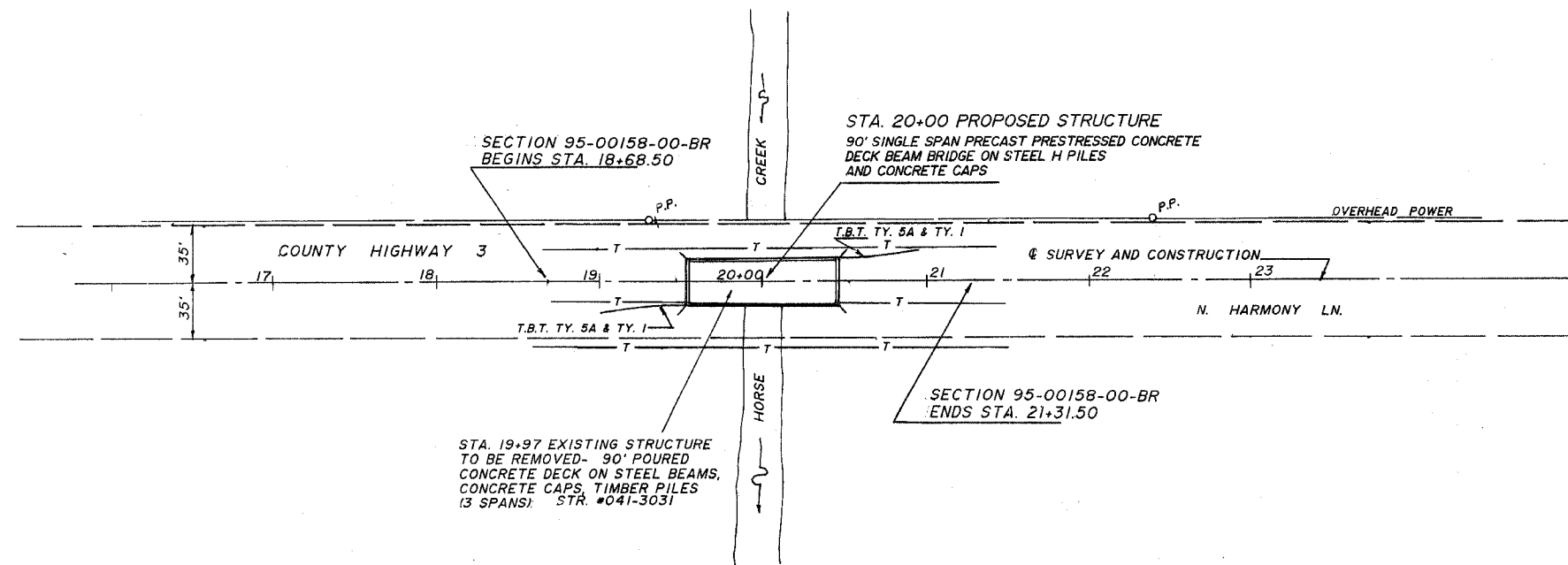

WILLIAM SHAFER  
NW 1/4 NW 1/4 SEC. 8, T.1 S., R.4 E., 3rd P.M.

B.M.- SPIKE IN TRIPLE 15" MAPLE S.E. OF BRIDGE ELEV. 465.72

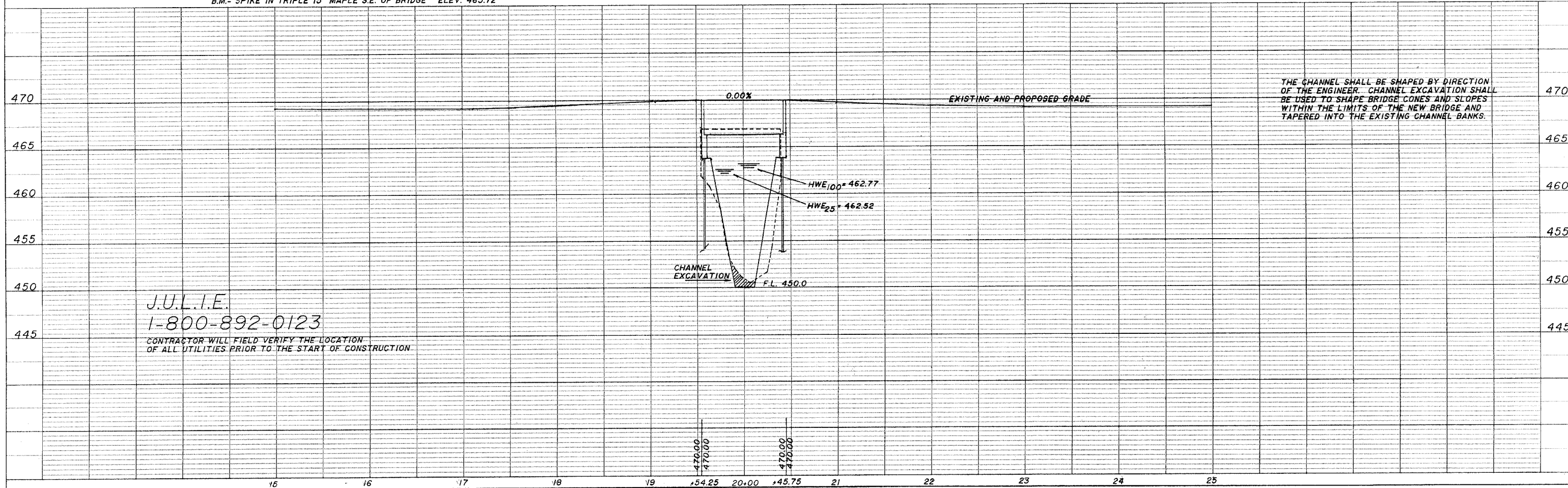

THE CHANNEL SHALL BE SHAPED BY DIRECTION OF THE ENGINEER. CHANNEL EXCAVATION SHALL BE USED TO SHAPE BRIDGE CONES AND SLOPES WITHIN THE LIMITS OF THE NEW BRIDGE AND TAPERED INTO THE EXISTING CHANNEL BANKS.

J.U.L.I.E.  
1-800-892-0123  
CONTRACTOR WILL FIELD VERIFY THE LOCATION OF ALL UTILITIES PRIOR TO THE START OF CONSTRUCTION

DATE  
BY  
SURVEYED  
PLOTTED  
CHECKED  
NOTE BOOK NO.

DATE  
BY  
SURVEYED  
PLOTTED  
CHECKED  
NOTE BOOK NO.