

ROUTE	SECTION	COUNTY	TOTAL SHEETS	SHEET NO.
FAS 946	05-00074-00-RS	ALEXANDER	15	4
PROJECT NO. RS-946 (106)			CONTRACT NO. 99287	

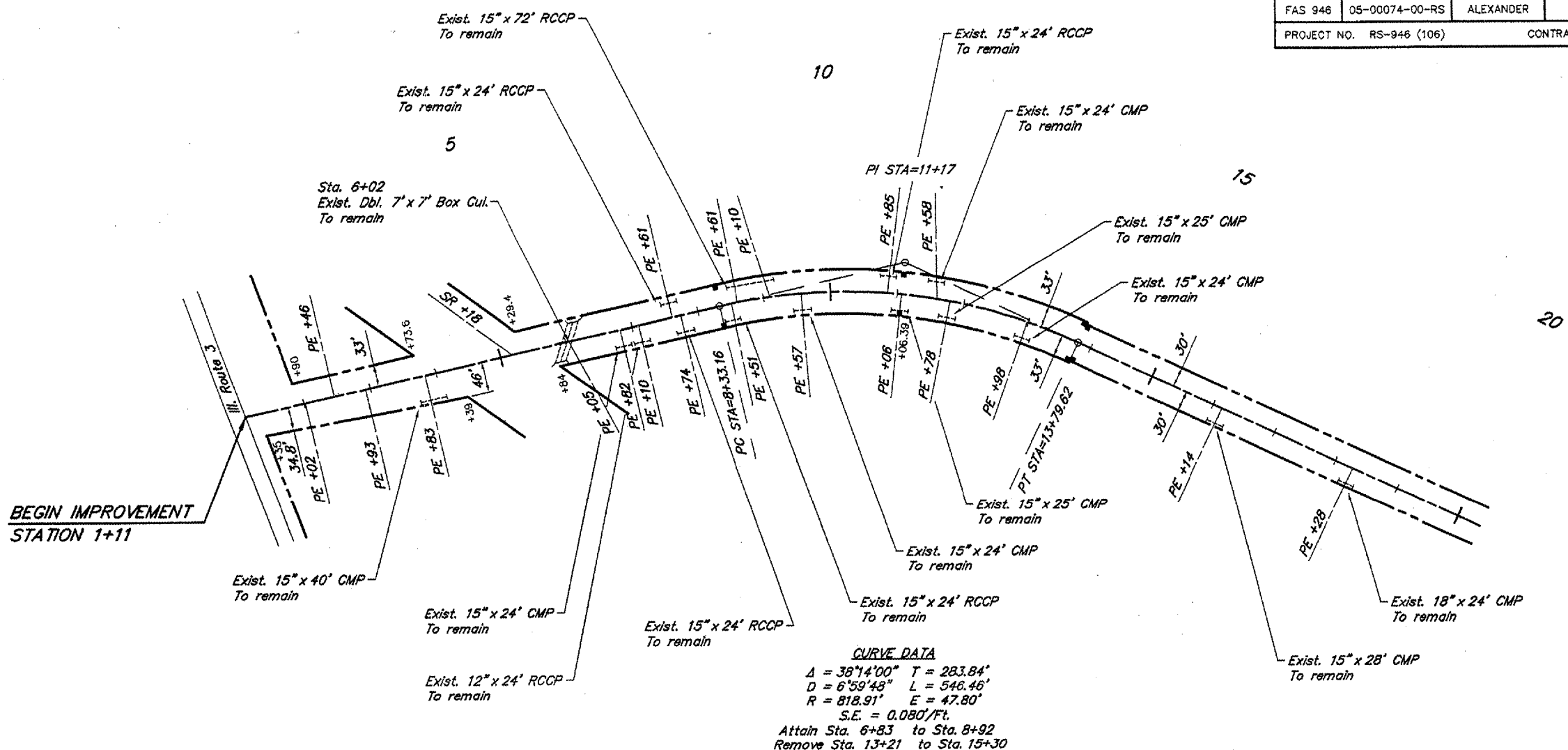

CURVE DATA
 $\Delta = 38^{\circ}14'00''$ $T = 283.84'$
 $D = 6^{\circ}59'48''$ $L = 546.46'$
 $R = 818.91'$ $E = 47.80'$
 $S.E. = 0.080'/ft.$
 Attain Sta. 6+83 to Sta. 8+92
 Remove Sta. 13+21 to Sta. 15+30

SCALES:
 1" = 200' HOR
 1" = 20' VER

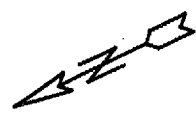
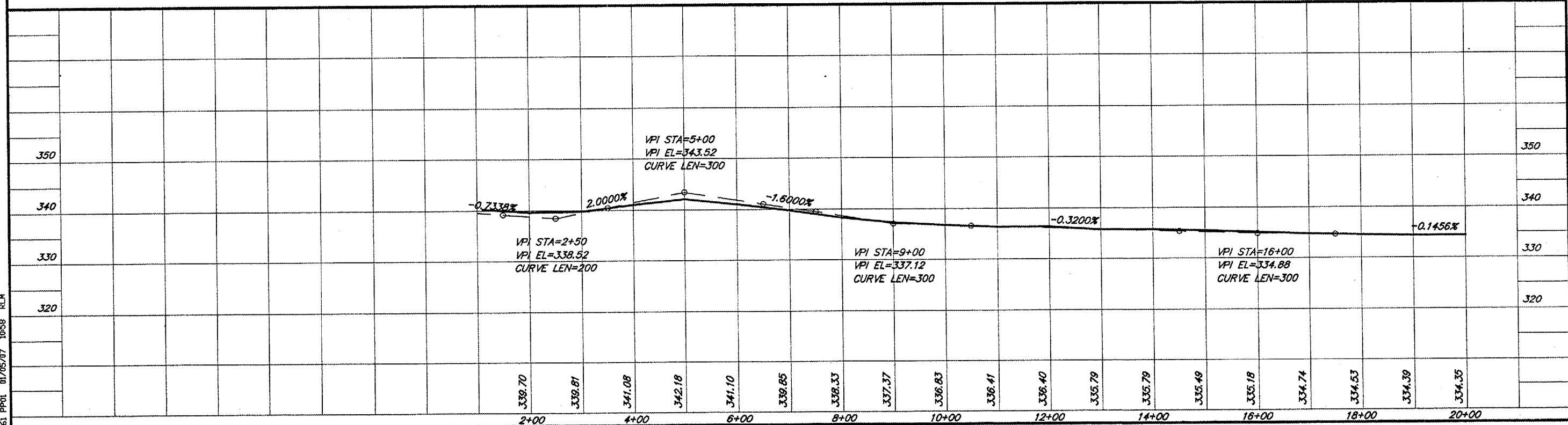

661 PPO1 01/05/07 1058 RLM