

ROUTE	SECTION	COUNTY	TOTAL SHEETS	SHEET NO.
FAS 946	05-00074-00-RS	ALEXANDER	15	9
PROJECT NO. RS-946 (106)			CONTRACT NO. 99287	

CURVE DATA
 $\Delta = 22^{\circ}04'00''$ $T = 257.87'$
 $D = 4^{\circ}19'56''$ $L = 509.35'$
 $R = 1322.52'$ $E = 24.91'$
 $S.E. = 0.067'/ft.$
 Attain Sta. 130+81 to Sta. 132+61
 Remove Sta. 136+73 to Sta. 138+53

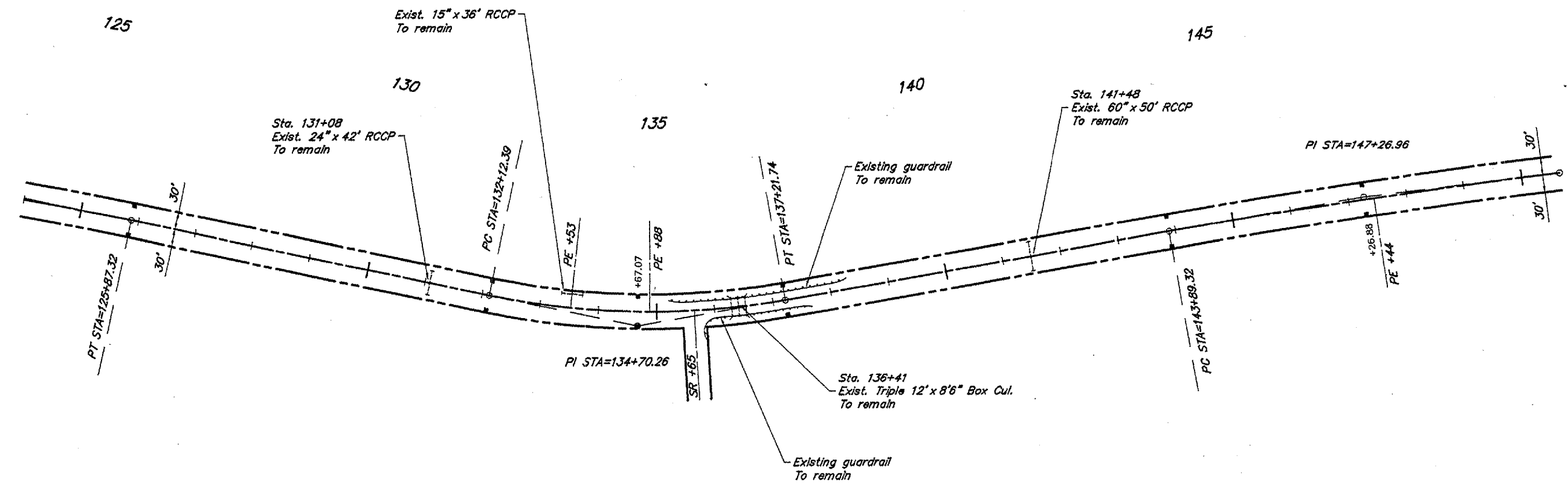
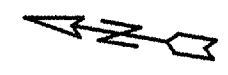

SCALES:
 1" = 200' HOR
 1" = 20' VER

CURVE DATA
 $\Delta = 3^{\circ}09'00''$ $T = 337.64'$
 $D = 0^{\circ}28'00''$ $L = 675.11'$
 $R = 12279.67'$ $E = 4.64'$
 Normal Crown

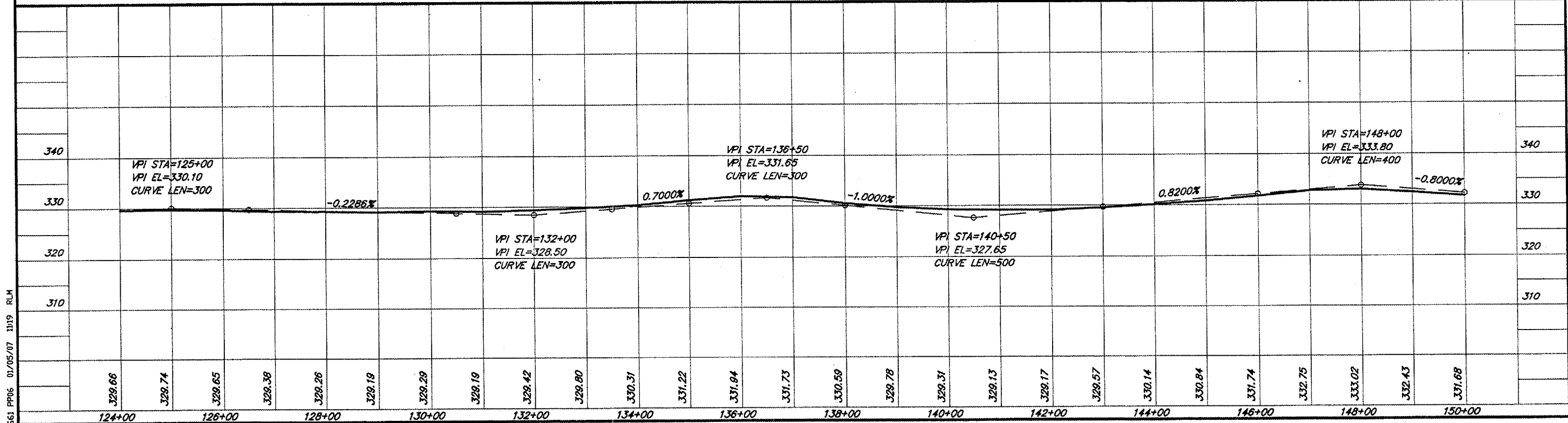

661 PF06 01/05/07 1019 RLM