

STATE OF ILLINOIS  
DEPARTMENT OF TRANSPORTATION  
PLANS FOR PROPOSED

SURFACE TRANSPORTATION PROGRAM

FAS ROUTE 946 (MILLER CITY ROAD)  
SECTION 05-00074-00-RS  
PROJECT # ACRS-946 (106)  
JOB NO. C-99-532-05

ROUTE	SECTION	COUNTY	TOTAL SHEETS	SHEET NO.
FAS 946	05-00074-00-RS	ALEXANDER	15	1
PROJECT NO. RS-946 (106)			CONTRACT NO. 99287	

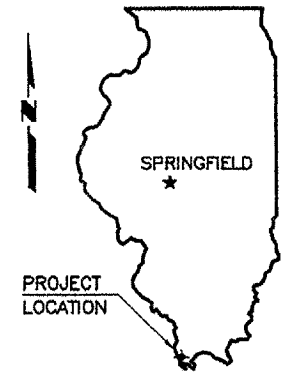

SUMMARY OF QUANTITIES

CODE NO.	PAY ITEM	UNIT	TOTAL
40200800*	AGGREGATE SURFACE COURSE, TYPE B	TON	80
40600100	BITUMINOUS MATERIALS (PRIME COAT)	GALLON	6,180
40600635	LEVELING BINDER (MACHINE METHOD), N70	TON	4,770
40603315	HOT-MIX ASPHALT SURFACE COURSE, MIX "C", N70	TON	4,340
48101200	AGGREGATE SHOULDERS, TYPE B	TON	2,230
67100100*	MOBILIZATION	L SUM	1
70300100	SHORT-TERM PAVEMENT MARKING	FOOT	4,732
70300220	TEMPORARY PAVEMENT MARKING - LINE 4"	FOOT	63,110
72000100	SIGN PANEL - TYPE 1	SQ FT	89.2
72800100	TELESCOPING STEEL SIGN SUPPORT	FOOT	448
▲ 78001110	PAINT PAVEMENT MARKING - LINE 4"	FOOT	63,110
▲ 78100100	RAISED REFLECTIVE PAVEMENT MARKER	EACH	298
▲ 78100105	RAISED REFLECTIVE PAVEMENT MARKER (BRIDGE)	EACH	1

\* SEE SPECIAL PROVISIONS  
▲ SPECIALTY ITEMS

ALEXANDER COUNTY

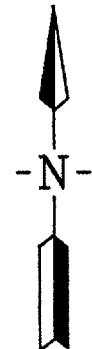
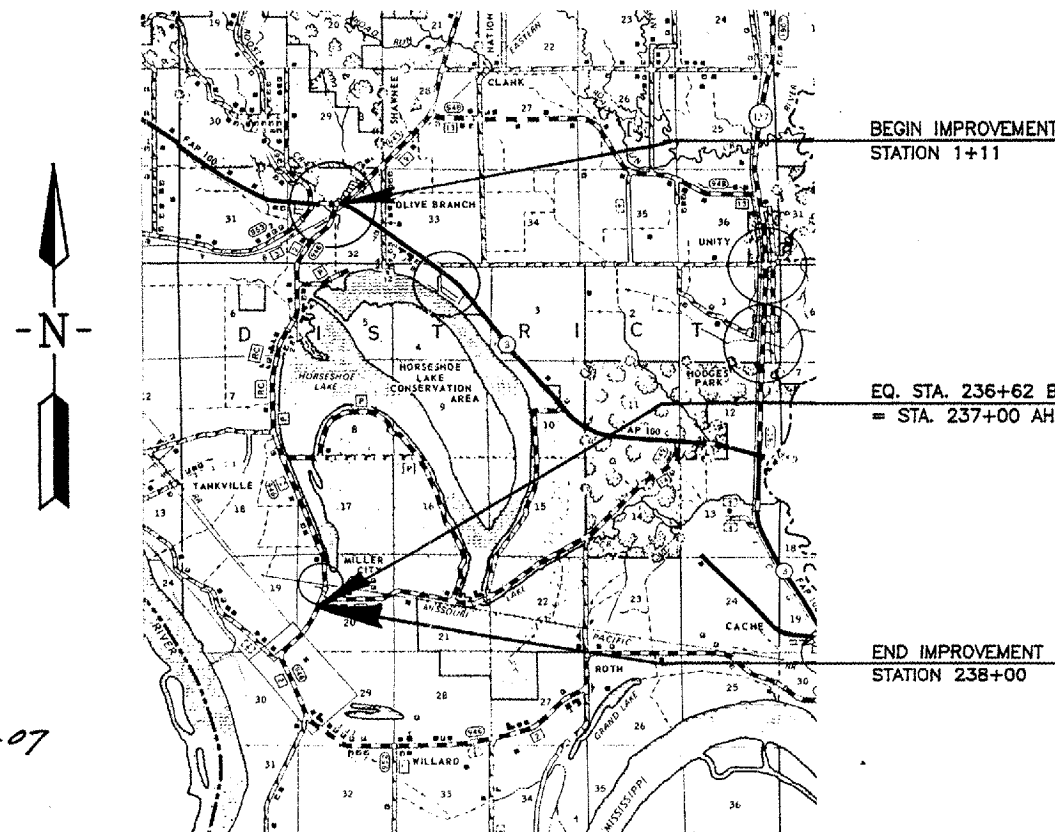

BEGIN IMPROVEMENT  
STATION 1+11

EQ. STA. 236+62 BACK  
= STA. 237+00 AHEAD

END IMPROVEMENT  
STATION 238+00

LOCATION MAP

SCALE: 1" = 2 MILES

NET LENGTH OF IMPROVEMENT = 23,651.00 FT. = 4.4794 MILES

INDEX OF SHEETS

1. COVER SHEET
  2. TYPICAL SECTIONS
  3. RESURFACING SCHEDULE
  - 4.-13. PLAN & PROFILE
  14. TYPICAL ENTRANCE & SIDE ROAD DETAILS
  15. MISCELLANEOUS DETAILS
- STANDARDS
- |           |                                    |
|-----------|------------------------------------|
| 701001-01 | TRAFFIC CONTROL                    |
| 701006-02 | TRAFFIC CONTROL                    |
| 701011-01 | TRAFFIC CONTROL                    |
| 701301-02 | TRAFFIC CONTROL                    |
| 701306-01 | TRAFFIC CONTROL                    |
| 701311-02 | TRAFFIC CONTROL                    |
| 702001-06 | TRAFFIC CONTROL DEVICES            |
| 720001    | SIGN PANEL MOUNTING DETAILS        |
| 720006-01 | SIGN PANEL ERECTION DETAILS        |
| 780001-01 | TYPICAL PAVEMENT MARKINGS          |
| 781001-02 | RAISED REFLECTIVE PAVEMENT MARKERS |
| BLR 24-1  | MAILBOX TURNOUTS                   |

CLASSIFICATION : COLLECTOR  
ADT : 750  
DESIGN SPEED : 50 MPH

ILLINOIS DEPARTMENT OF TRANSPORTATION	
Approved	JANUARY 26, 2007 <i>[Signature]</i> Alexander County, Engineer
Passed	FEB. 6, 2007 <i>[Signature]</i> District 9 Engineer of Local Roads and Streets
Releasing for Bid Based on Limited Review	<i>[Signature]</i> 2-6-07 Deputy Director of Highways, Region 5 Engineer

CONTRACT NO. 99287

E. MILLER ENGINEERING, INC.  
CONSULTING ENGINEERS  
HARRISBURG, ILLINOIS

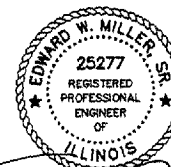

Edward W. Miller  
PROFESSIONAL ENGINEER  
#062-025277  
EXPIRES NOV. 30, 2007

01-12-07

ROUTE	SECTION	COUNTY	TOTAL SHEETS	SHEET NO.
FAS 946	05-00074-00-RS	ALEXANDER	15	2
PROJECT NO. RS-946 (106)			CONTRACT NO. 99287	

**GENERAL NOTES**

Grade corrections for crown or superelevations shall be constructed with leveling binder prior to the first full lift.

The existing surface shall be primed the full width of the roadway.

Factors used for quantity calculations are as follows:

Hot-Mix Asphalt	112.0	Tons/Sq. Yd./Inch
Aggregate	2.025	Tons/Cu. Yd.
Bit. Matls. (Prime Coat)	0.10	Gals./Sq. Yd.

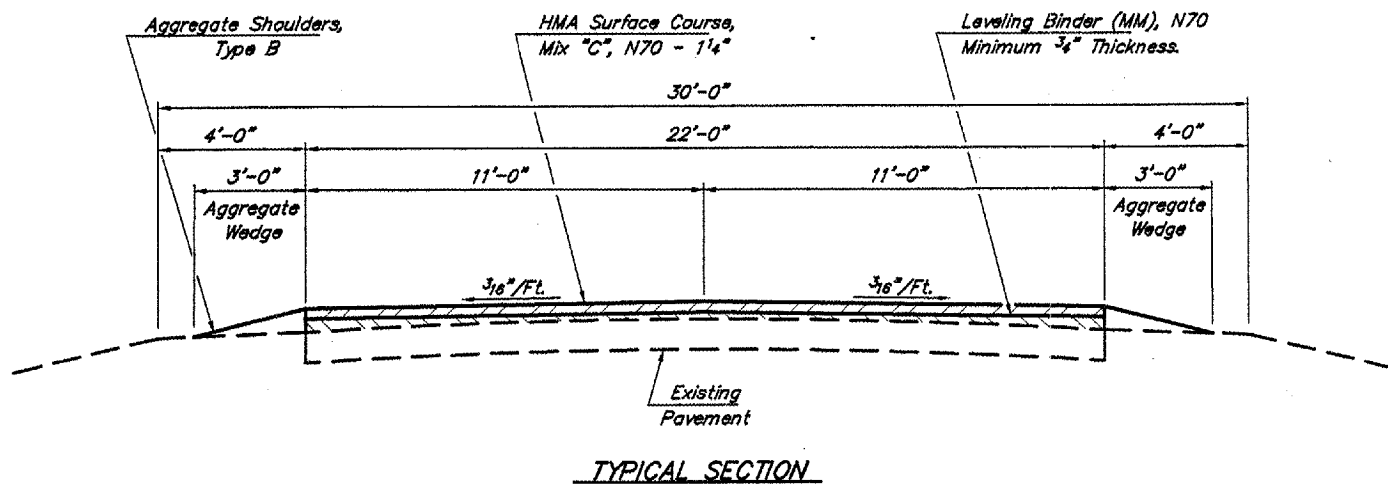

**TYPICAL SECTION**

**STRUCTURAL DESIGN DATA**

Class III Roadway  
 Design Period - 8 Years  
 PC 720 IBR 3.9  
 SU 15 TF 0.0243  
 MU 15 DT 2.187

**MATERIAL COEFFICIENT**

Exist. Crushed Stone Base	- 0.10
Exist. Oil & Chip Surface	- 0.15
Existing Class I Surface	- 0.25
Leveling Binder (MM)	- 0.33
HMA Surface Course	- 0.40

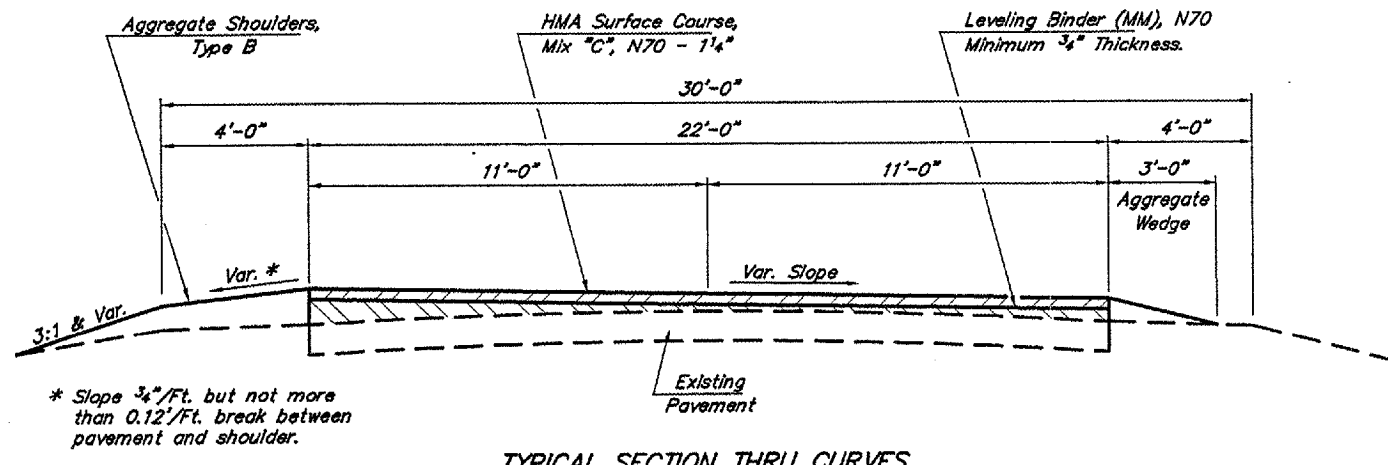

**TYPICAL SECTION THRU CURVES**

NOTE: Section shown for right curve. Reverse for left curve.

**HOT-MIX ASPHALT MIXTURE REQUIREMENTS**

Mixture Use:	Leveling Binder (Machine Method), N70
PG:	PG64-22
RAP% (Max):	10
Design Air Voids:	4% 70 Gyraton Superpave Design
Mixture Composition: (Gradation Mixture)	IL-9.5mm
Friction Aggregate:	None

Mixture Use:	HMA Surface Course, Mix 'C', N70
PG:	PG64-22
RAP% (Max):	10
Design Air Voids:	4% 70 Gyraton Superpave Design
Mixture Composition: (Gradation Mixture)	IL-9.5mm or IL-12.5mm
Friction Aggregate:	C Surface

**TYPICAL SECTIONS**  
 FAS ROUTE 946  
 SECTION 05-00074-00-RS  
 PROJECT NO. RS-946 (106)  
 ALEXANDER COUNTY

ROUTE	SECTION	COUNTY	TOTAL SHEETS	SHEET NO.
FAS 946	05-00074-00-RS	ALEXANDER	15	3
PROJECT NO. RS-946 (106)			CONTRACT NO. 99287	

**RESURFACING SCHEDULE - SOUTHBOUND (RIGHT) LANE**

Location Station to Station	Length	Bituminous Materials (Prime Coat)	Leveling Binder Mach. Method	Hot-Mix Asphalt Surface Cse.
	Feet	Gallons	Tons	Tons
<b>SOUTHBOUND (RIGHT) LANE</b>				
1+11 to 6+83	572.00	72.0	79.7	50.6
6+83 to 15+30	847.00	106.6	114.3	75.0
15+30 to 21+54	624.00	78.6	61.4	55.2
21+54 to 29+02	748.00	94.2	68.7	66.2
29+02 to 35+95	693.00	87.2	62.0	61.3
35+95 to 44+48	853.00	107.4	63.0	75.4
44+48 to 65+08	2060.00	259.3	182.2	182.3
65+08 to 73+01	793.00	101.6	55.5	72.5
73+01 to 76+08	307.00	39.7	18.9	28.7
76+08 to 82+47	639.00	80.5	51.7	56.5
82+47 to 90+05	758.00	95.4	63.9	67.1
90+05 to 100+52	1047.00	131.8	102.8	92.6
100+52 to 107+28	676.00	85.1	65.2	59.8
107+28 to 109+23	195.00	24.6	14.9	17.3
109+23 to 115+79	656.00	82.5	51.9	58.0
115+79 to 130+81	1502.00	189.1	311.0	132.9
130+81 to 138+53	772.00	97.2	115.7	68.4
138+53 to 154+82	1629.00	205.1	162.8	144.1
154+82 to 161+18	636.00	80.1	52.1	56.3
161+18 to 202+36	4118.00	518.4	312.7	364.3
202+36 to 210+82	846.00	106.5	61.0	74.9
210+82 to 214+92	410.00	51.6	27.5	36.3
214+92 to 219+63	471.00	59.3	30.7	41.6
219+63 to 226+92	729.00	91.7	51.4	64.5
226+92 to 232+71	579.00	72.9	47.0	51.3
232+71 to 238+00	491.00	61.8	30.8	43.4
<b>Totals for SouthBound (Right) Lane</b>		<b>2980.2</b>	<b>2258.8</b>	<b>2096.5</b>

**RESURFACING SCHEDULE - NORTHBOUND (LEFT) LANE**

Location Station to Station	Length	Bituminous Materials (Prime Coat)	Leveling Binder Mach. Method	Hot-Mix Asphalt Surface Cse.
	Feet	Gallons	Tons	Tons
<b>NORTHBOUND (LEFT) LANE</b>				
1+11 to 6+83	572.00	72.0	86.2	50.6
6+83 to 15+30	847.00	106.6	88.2	75.0
15+30 to 21+54	624.00	78.6	52.1	55.2
21+54 to 29+02	748.00	94.2	65.2	66.2
29+02 to 35+95	693.00	87.2	96.2	61.3
35+95 to 44+48	853.00	107.4	63.4	75.4
44+48 to 65+08	2060.00	259.3	166.2	182.3
65+08 to 73+01	793.00	101.6	61.0	72.5
73+01 to 76+08	307.00	39.7	21.5	28.7
76+08 to 82+47	639.00	80.5	73.6	56.5
82+47 to 90+05	758.00	95.4	79.9	67.1
90+05 to 100+52	1047.00	131.8	147.8	92.6
100+52 to 107+28	676.00	85.1	74.4	59.8
107+28 to 109+23	195.00	24.6	18.5	17.3
109+23 to 115+79	656.00	82.5	52.0	58.0
115+79 to 130+81	1502.00	189.1	201.3	132.9
130+81 to 138+53	772.00	97.2	74.0	68.4
138+53 to 154+82	1629.00	205.1	145.4	144.1
154+82 to 161+18	636.00	80.1	67.7	56.3
161+18 to 202+36	4118.00	518.4	389.0	364.3
202+36 to 210+82	846.00	106.5	66.5	74.9
210+82 to 214+92	410.00	51.6	39.9	36.3
214+92 to 219+63	471.00	59.3	46.5	41.6
219+63 to 226+92	729.00	91.7	67.8	64.5
226+92 to 232+71	579.00	72.9	75.8	51.3
232+71 to 238+00	491.00	61.8	55.5	43.4
<b>Totals for NorthBound (Left) Lane</b>		<b>2980.2</b>	<b>2381.6</b>	<b>2096.5</b>

NOTE: Quantities shown do not include materials for entrances, side roads, and mailbox turnouts.

RESURFACING SCHEDULE  
 FAS ROUTE 946  
 SECTION 05-00074-00-RS  
 PROJECT NO. RS-946 (106)  
 ALEXANDER COUNTY

ROUTE	SECTION	COUNTY	TOTAL SHEETS	SHEET NO.
FAS 946	05-00074-00-RS	ALEXANDER	15	4
PROJECT NO. RS-946 (106)			CONTRACT NO. 99287	

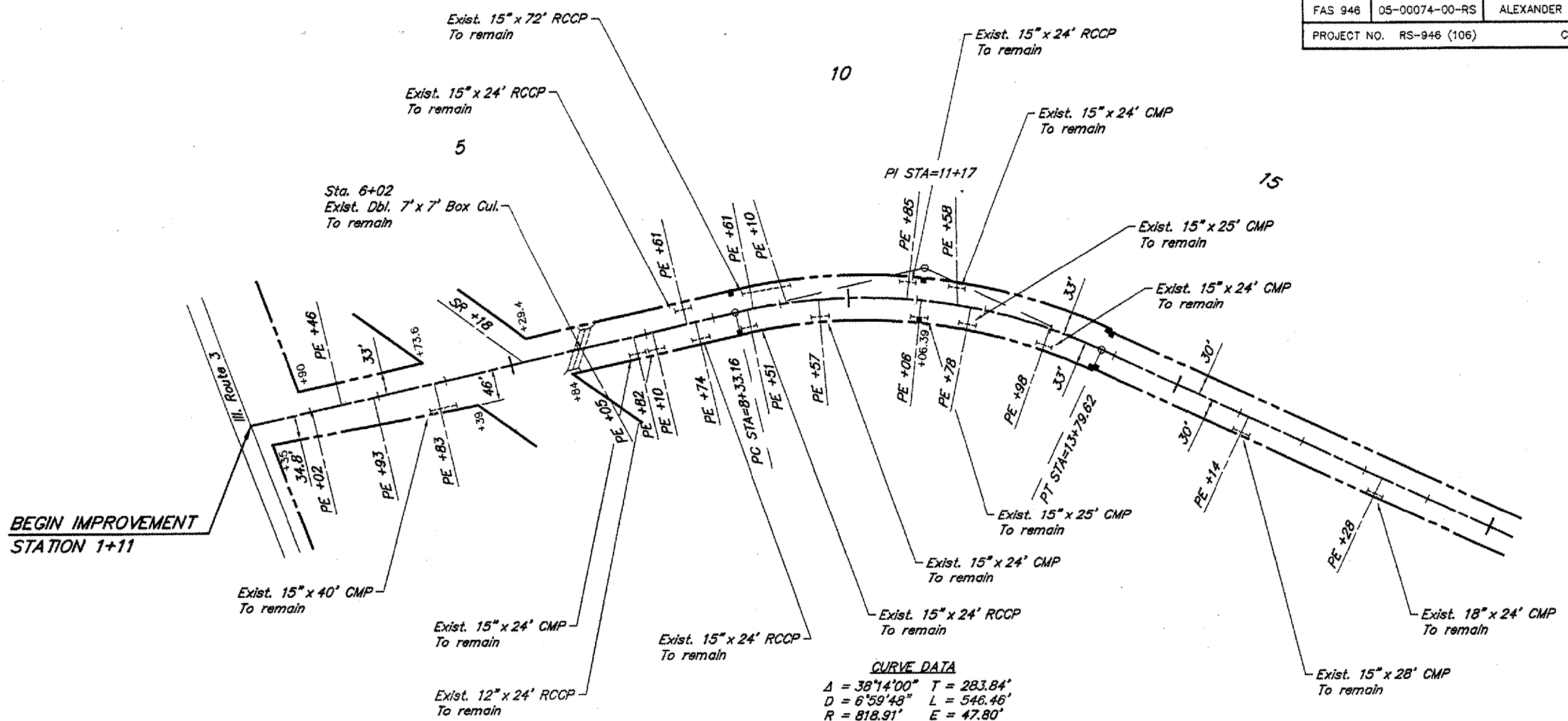
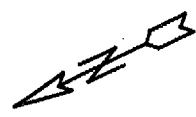

**CURVE DATA**  
 $\Delta = 38^{\circ}14'00''$   $T = 283.84'$   
 $D = 6^{\circ}59'48''$   $L = 546.46'$   
 $R = 818.91'$   $E = 47.80'$   
 $S.E. = 0.080'/ft.$   
 Attain Sta. 6+83 to Sta. 8+92  
 Remove Sta. 13+21 to Sta. 15+30

SCALES:  
 1" = 200' HOR  
 1" = 20' VER

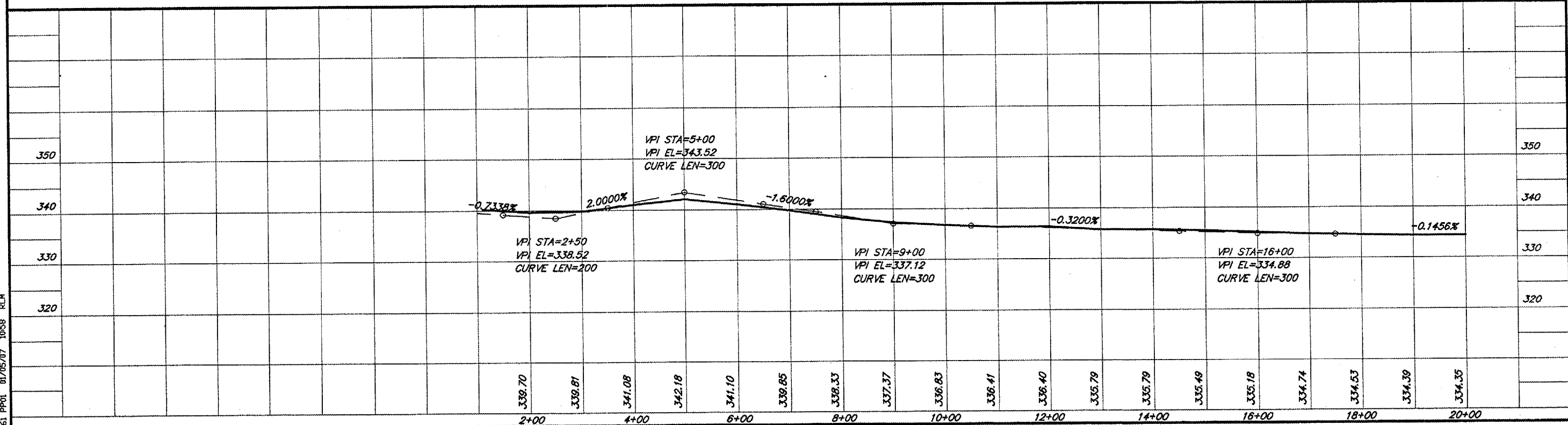

661 PPO1 01/05/07 1058 RLM

ROUTE	SECTION	CGUNTY	TOTAL SHEETS	SHEET NO.
FAS 946	05-00074-00-RS	ALEXANDER	15	5
PROJECT NO. RS-946 (106)			CONTRACT NO. 99287	

**CURVE DATA**  
 $\Delta = 19^{\circ}00'00''$   $T = 252.36'$   
 $D = 3^{\circ}47'58''$   $L = 500.08'$   
 $R = 1508.04'$   $E = 20.97'$   
 $S.E. = 0.062'/ft.$   
 Attain Sta. 21+54 to Sta. 23+23  
 Remove Sta. 27+33 to Sta. 29+02

**CURVE DATA**  
 $\Delta = 28^{\circ}05'00''$   $T = 292.47'$   
 $D = 5^{\circ}04'54''$   $L = 572.32'$   
 $R = 1127.51'$   $E = 37.31'$   
 $S.E. = 0.073'/ft.$   
 Attain Sta. 35+95 to Sta. 37+89  
 Remove Sta. 42+54 to Sta. 44+48

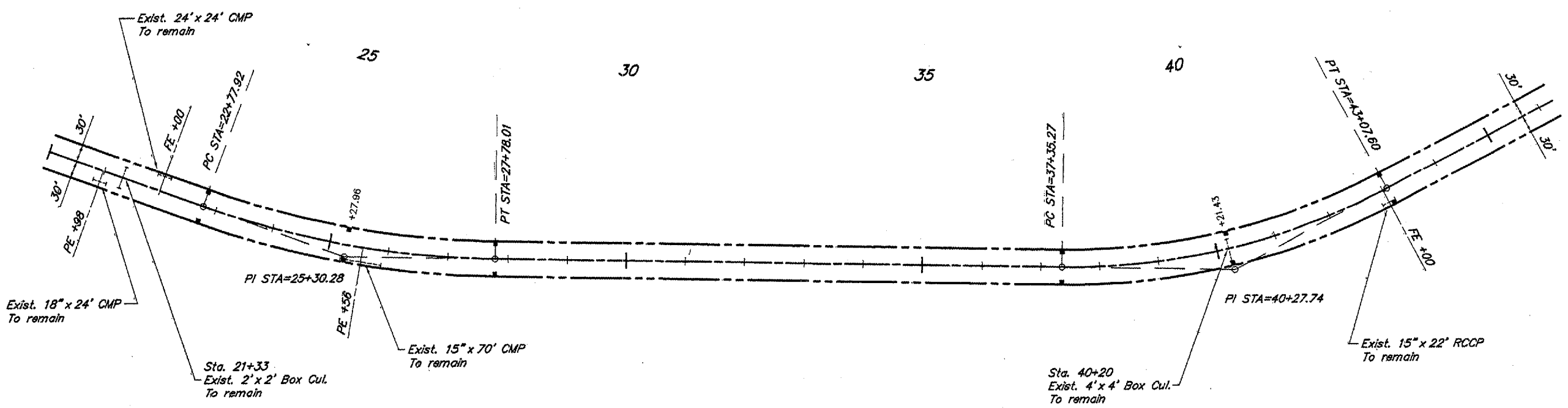
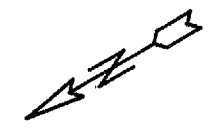

SCALES:  
 1" = 200' HOR  
 1" = 20' VER

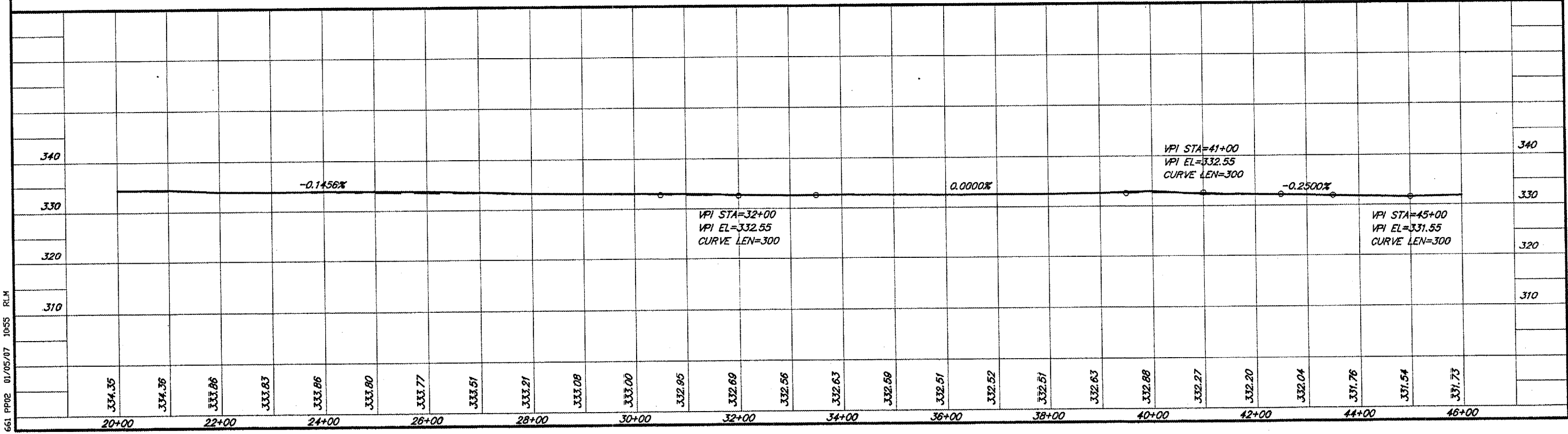

661 PPO2 01/05/07 10:55 RLM

ROUTE	SECTION	COUNTY	TOTAL SHEETS	SHEET NO.
FAS 946	05-00074-00-RS	ALEXANDER	15	6
PROJECT NO. RS-946 (106)			CONTRACT NO. 99287	

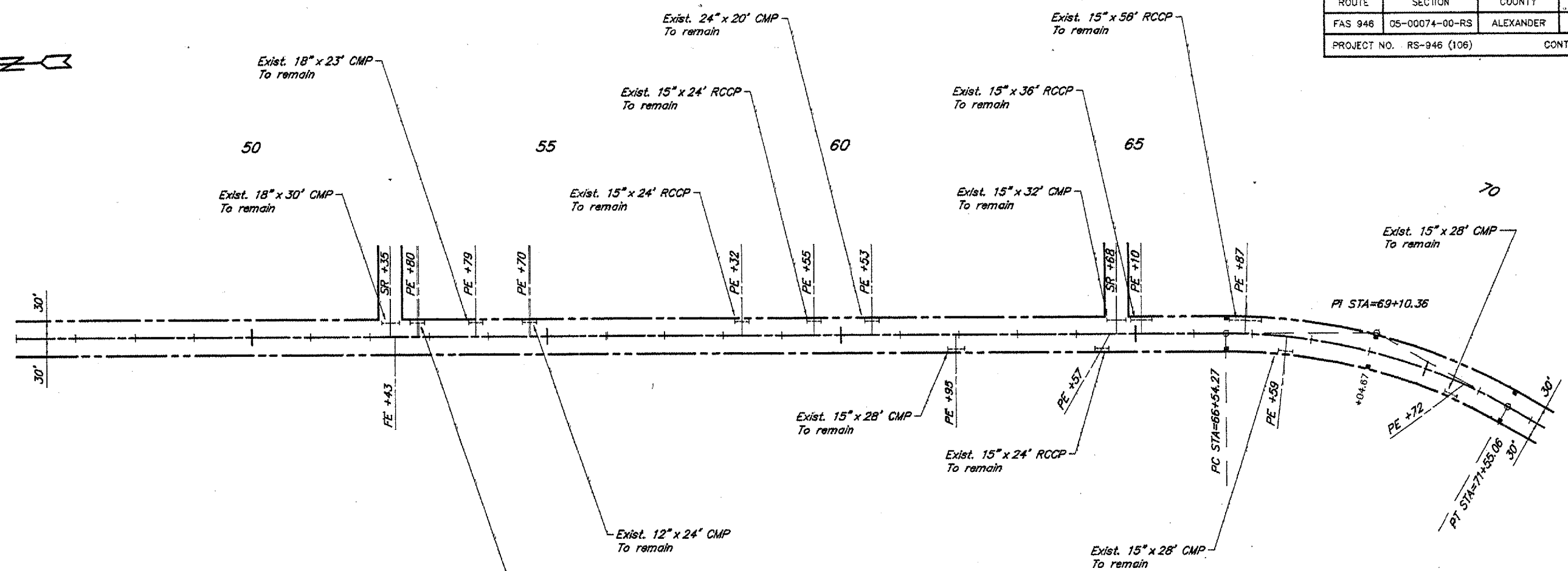
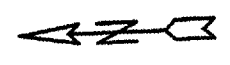

**CURVE DATA**  
 $\Delta = 29^{\circ}32'00''$   $T = 256.09'$   
 $D = 5^{\circ}53'50''$   $L = 500.79'$   
 $R = 971.55'$   $E = 33.18'$   
 $S.E. = 0.077'/ft.$   
 Attain Sta. 65+08 to Sta. 67+10  
 Remove Sta. 70+99 to Sta. 73+01

SCALES:  
 1" = 200' HOR  
 1" = 20' VER

651 PPO3 01/05/07 10:53 RLM

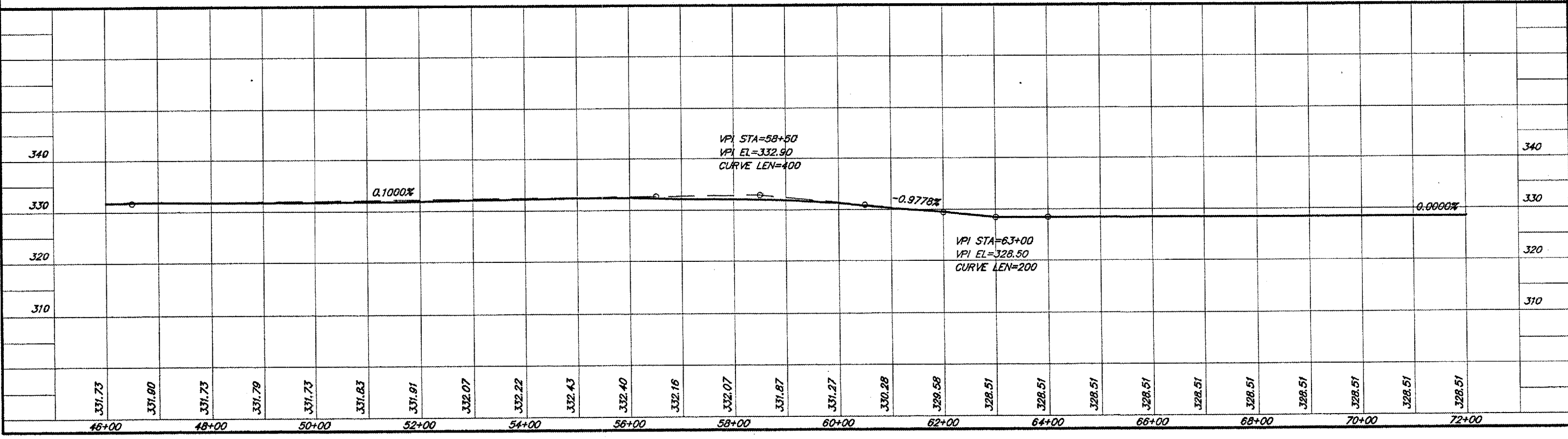

ROUTE	SECTION	COUNTY	TOTAL SHEETS	SHEET NO.
FAS 946	05-00074-00-RS	ALEXANDER	15	7
PROJECT NO. RS-946 (106)			CONTRACT NO. 99287	

**CURVE DATA**  
 $\Delta = 23^{\circ}24'00''$   $T = 254.33'$   
 $D = 4^{\circ}39'55''$   $L = 501.57'$   
 $R = 1228.11'$   $E = 26.06'$   
 $S.E. = 0.070'/ft.$   
 Attain Sta. 82+47 to Sta. 84+34  
 Remove Sta. 88+18 to Sta. 90+05

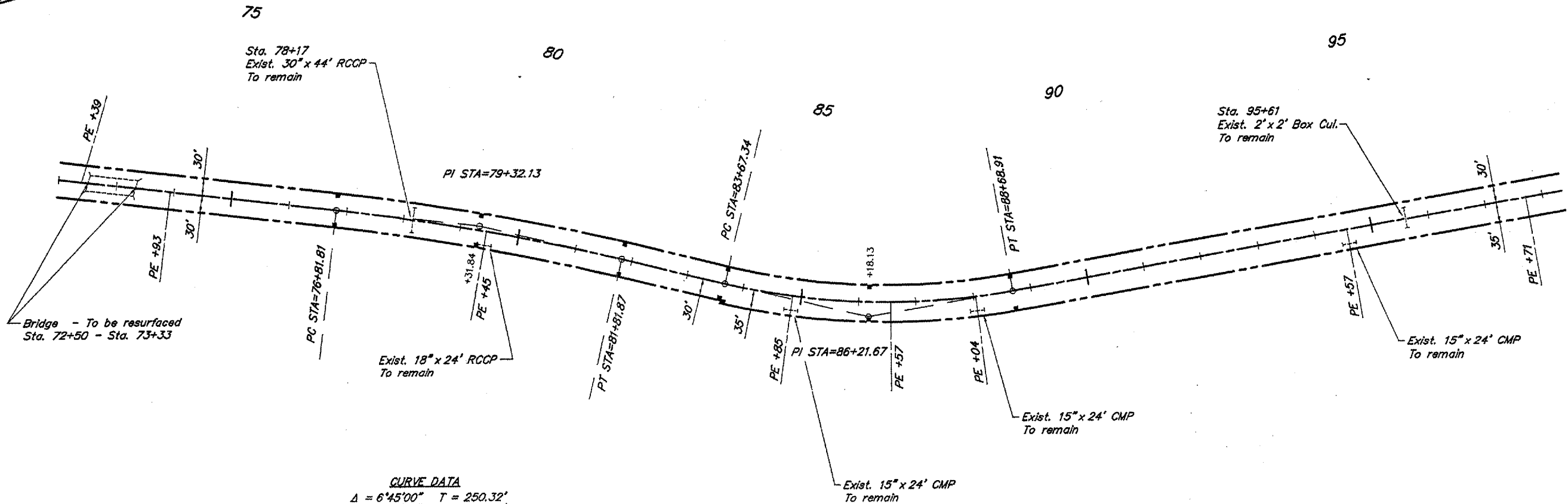
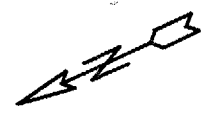

**CURVE DATA**  
 $\Delta = 6^{\circ}45'00''$   $T = 250.32'$   
 $D = 1^{\circ}20'59''$   $L = 500.06'$   
 $R = 4244.65'$   $E = 7.37'$   
 $S.E. = 0.028'/ft.$   
 Attain Sta. 76+08 to Sta. 77+02  
 Remove Sta. 81+53 to Sta. 82+47

SCALES:  
 1" = 200' HOR  
 1" = 20' VER

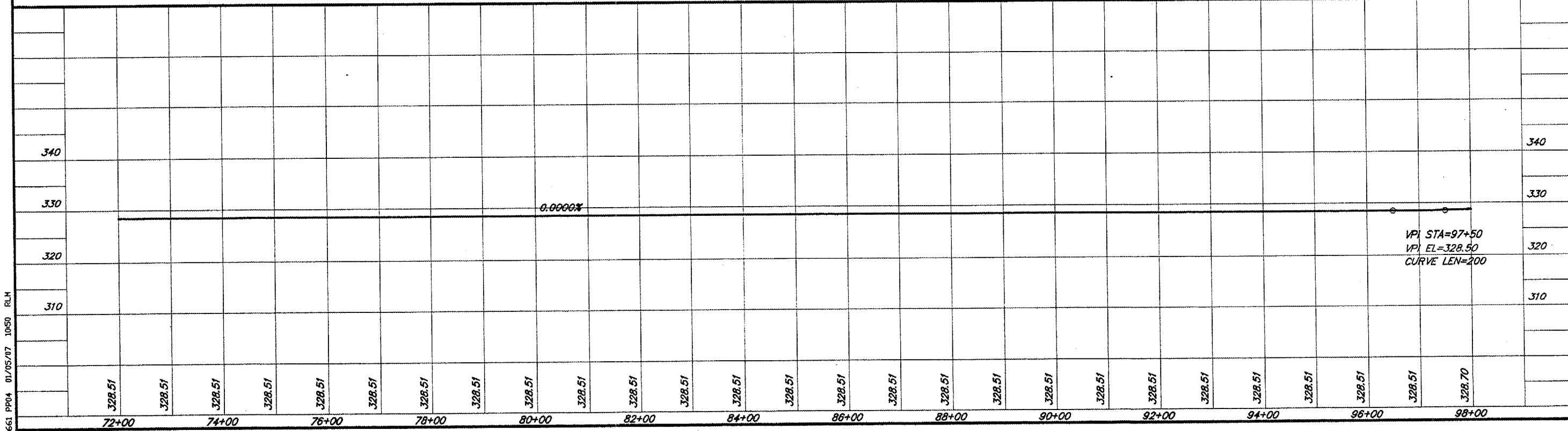

661 PP04 01/05/07 10:50 RLM

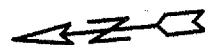

**CURVE DATA**  
 $\Delta = 9^{\circ}09'00''$   $T = 252.39'$   
 $D = 1^{\circ}49'00''$   $L = 503.71'$   
 $R = 3154.13'$   $E = 10.08'$   
 $S.E. = 0.036'/ft.$   
 Attain Sta. 100+52 to Sta. 101+64  
 Remove Sta. 106+15 to Sta. 107+28

**CURVE DATA**  
 $\Delta = 6^{\circ}53'00''$   $T = 252.14'$   
 $D = 1^{\circ}22'00''$   $L = 503.67'$   
 $R = 4192.50'$   $E = 7.58'$   
 $S.E. = 0.029'/ft.$   
 Attain Sta. 109+23 to Sta. 110+20  
 Remove Sta. 114+82 to Sta. 115+79

ROUTE	SECTION	COUNTY	TOTAL SHEETS	SHEET NO.
FAS 946	05-00074-00-RS	ALEXANDER	15	8
PROJECT NO. RS-946 (106)			CONTRACT NO. 99287	

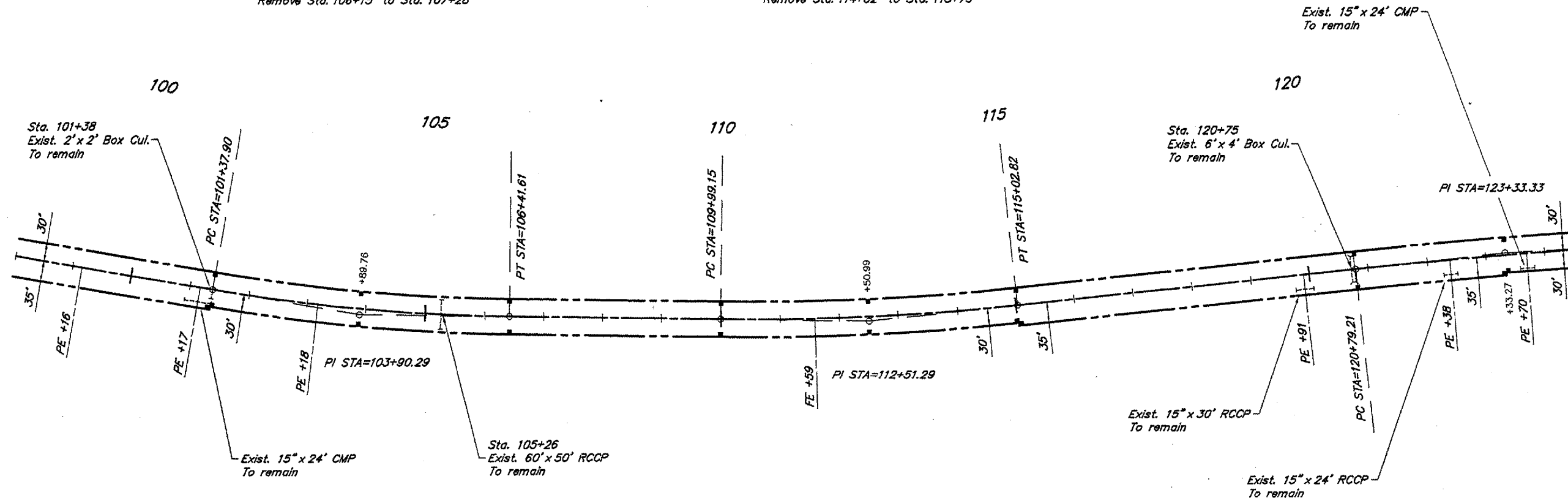

SCALES:  
 1" = 200' HOR  
 1" = 20' VER

**CURVE DATA**  
 $\Delta = 3^{\circ}08'00''$   $T = 254.12'$   
 $D = 0^{\circ}37'00''$   $L = 508.11'$   
 $R = 9291.21'$   $E = 3.47'$   
 Normal Crown

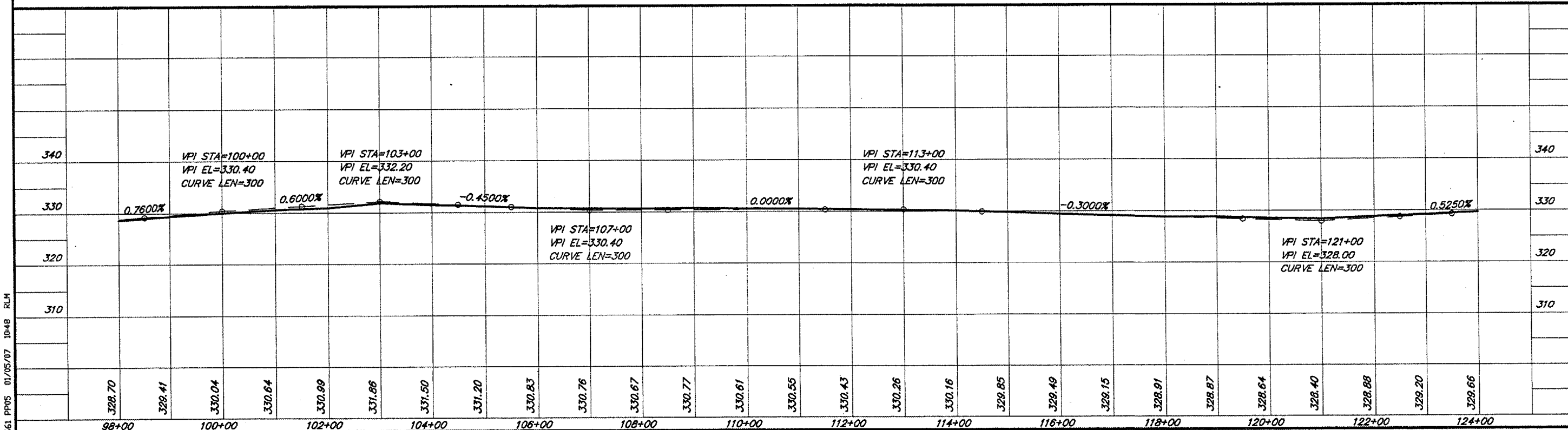



ROUTE	SECTION	COUNTY	TOTAL SHEETS	SHEET NO.
FAS 946	05-00074-00-RS	ALEXANDER	15	9
PROJECT NO. RS-946 (106)			CONTRACT NO. 99287	

**CURVE DATA**  
 $\Delta = 22^{\circ}04'00''$   $T = 257.87'$   
 $D = 4^{\circ}19'56''$   $L = 509.35'$   
 $R = 1322.52'$   $E = 24.91'$   
 $S.E. = 0.067'/ft.$   
 Attain Sta. 130+81 to Sta. 132+61  
 Remove Sta. 136+73 to Sta. 138+53

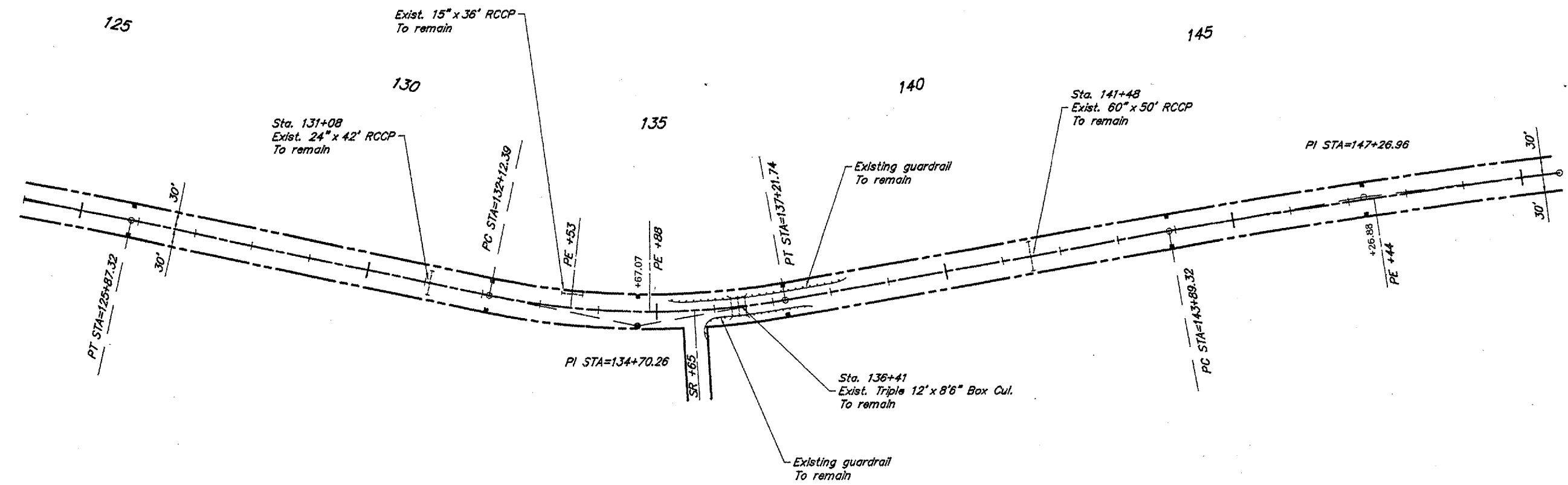
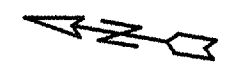

SCALES:  
 1" = 200' HOR  
 1" = 20' VER

**CURVE DATA**  
 $\Delta = 3^{\circ}09'00''$   $T = 337.64'$   
 $D = 0^{\circ}28'00''$   $L = 675.11'$   
 $R = 12279.67'$   $E = 4.64'$   
 Normal Crown

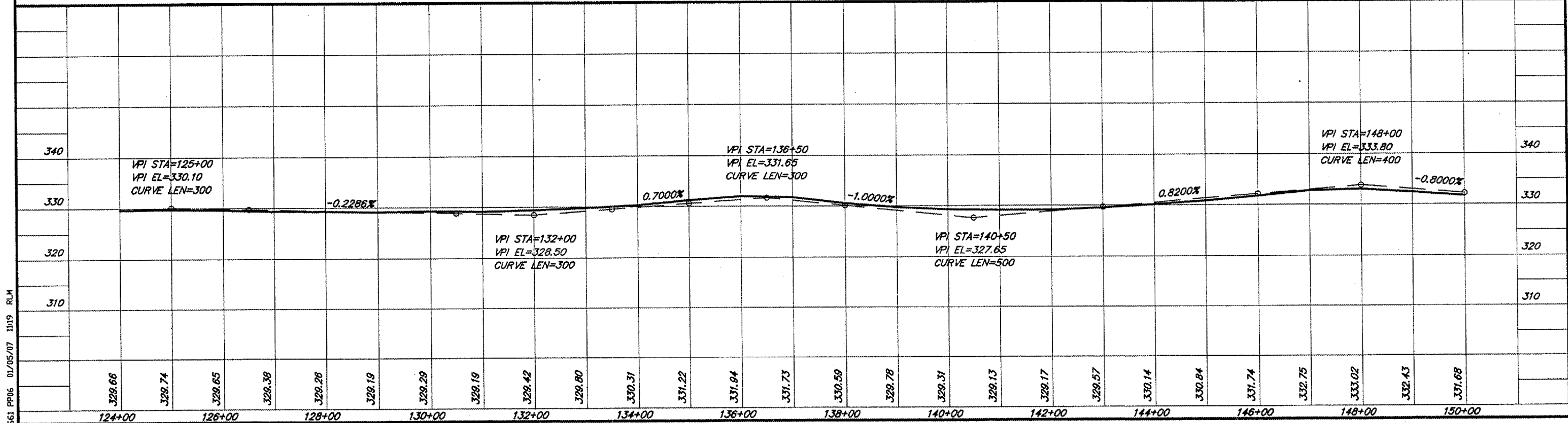

661 PF06 01/05/07 1019 RLM

ROUTE	SECTION	COUNTY	TOTAL SHEETS	SHEET NO.
FAS 946	05-00074-00-RS	ALEXANDER	15	10
PROJECT NO. RS-946 (106)			CONTRACT NO. 99287	

**CURVE DATA**  
 $\Delta = 5^{\circ}10'00''$   $T = 258.52'$   
 $D = 1^{\circ}00'00''$   $L = 516.69'$   
 $R = 5729.83'$   $E = 5.83'$   
 $S.E. = 0.018'/ft.$   
 Attain Sta. 154+82 to Sta. 155+54  
 Remove Sta. 160+45 to Sta. 161+18

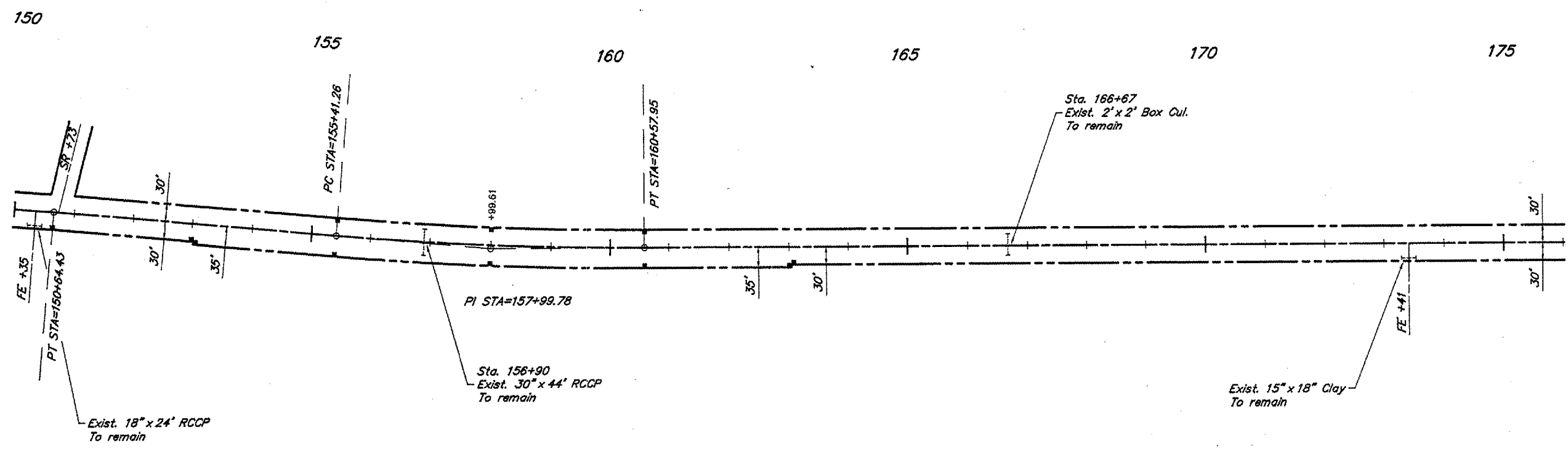
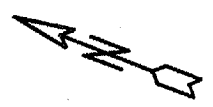

SCALES:  
 1" = 200' HOR  
 1" = 20' VER

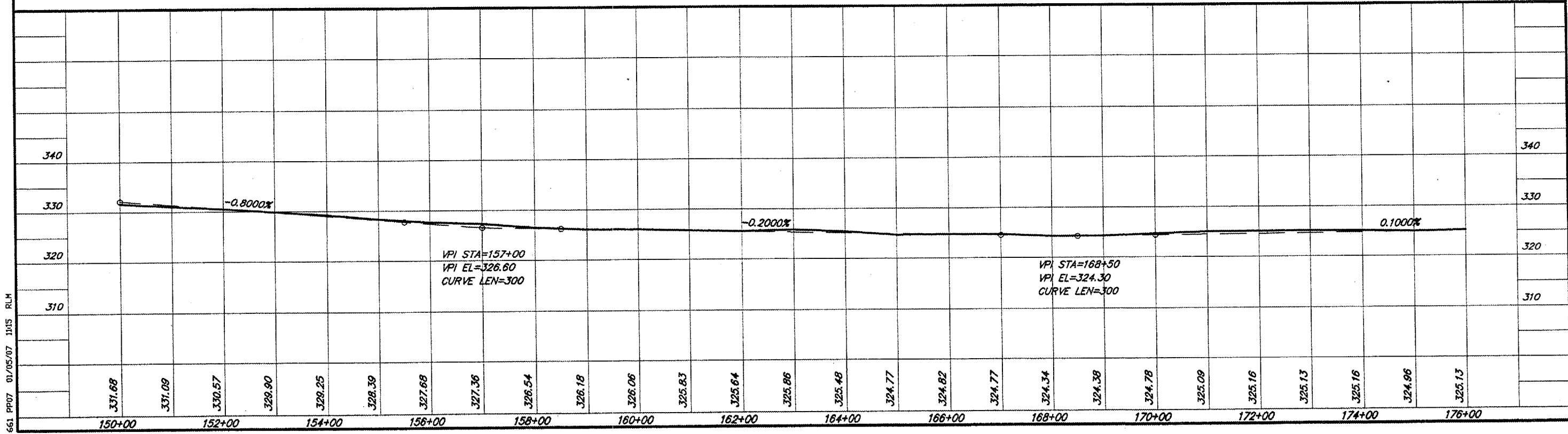

661.PP07 01/05/07 1145 RLM

ROUTE	SECTION	COUNTY	TOTAL SHEETS	SHEET NO.
FAS 946	05-00074-00-RS	ALEXANDER	15	11
PROJECT NO. RS-946 (106)			CONTRACT NO. 99287	

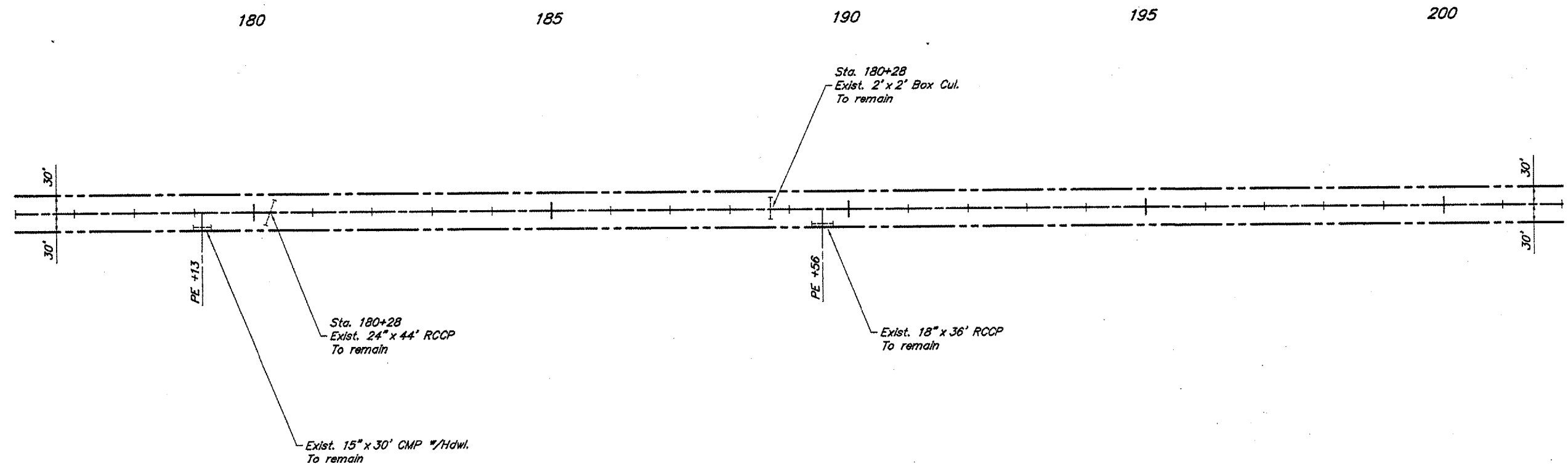
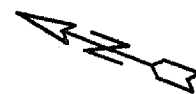

SCALES:  
 1" = 200' HOR  
 1" = 20' VER

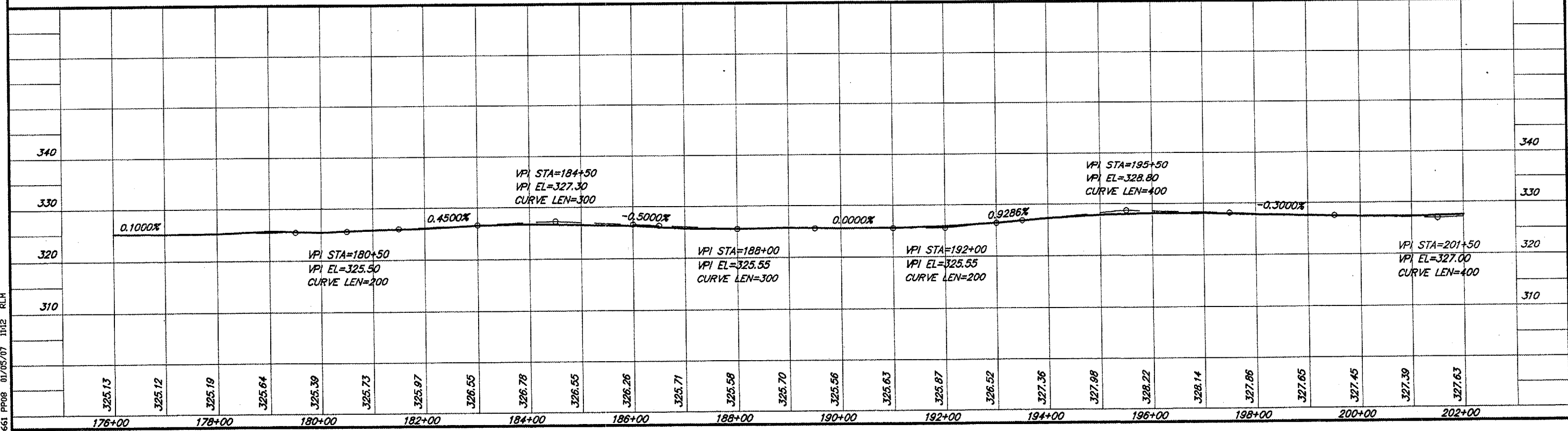

651 PPO8 01/05/07 IM2 RLM

ROUTE	SECTION	COUNTY	TOTAL SHEETS	SHEET NO.
FAS 946	05-00074-00-RS	ALEXANDER	15	12
PROJECT NO. RS-946 (106)			CONTRACT NO. 99287	

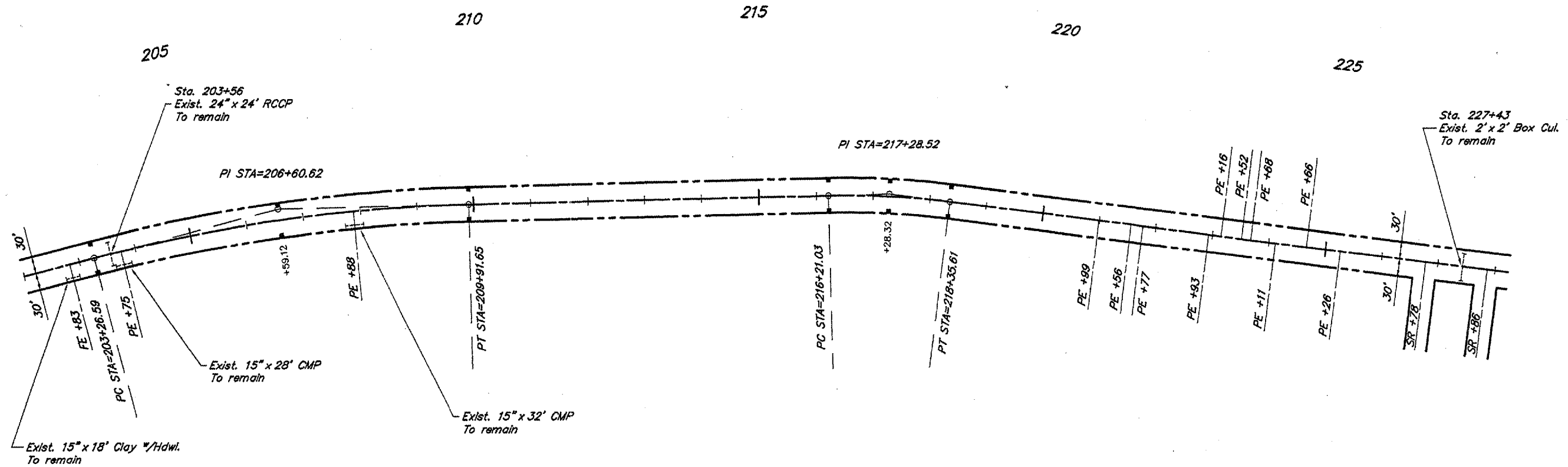
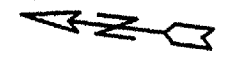

**CURVE DATA**  
 $\Delta = 13^{\circ}18'00''$   $T = 334.03'$   
 $D = 1^{\circ}59'59''$   $L = 665.06'$   
 $R = 2865.04'$   $E = 19.41'$   
 $S.E. = 0.039'/ft.$   
 Attain Sta. 202+36 to Sta. 203+55  
 Remove Sta. 209+63 to Sta. 210+82

**CURVE DATA**  
 $\Delta = 8^{\circ}35'00''$   $T = 107.49'$   
 $D = 4^{\circ}00'00''$   $L = 214.58'$   
 $R = 1432.39'$   $E = 4.03'$   
 $S.E. = 0.064'/ft.$   
 Attain Sta. 214+94 to Sta. 216+68  
 Remove Sta. 217+89 to Sta. 219+63

SCALES:  
 1" = 200' HOR  
 1" = 20' VER

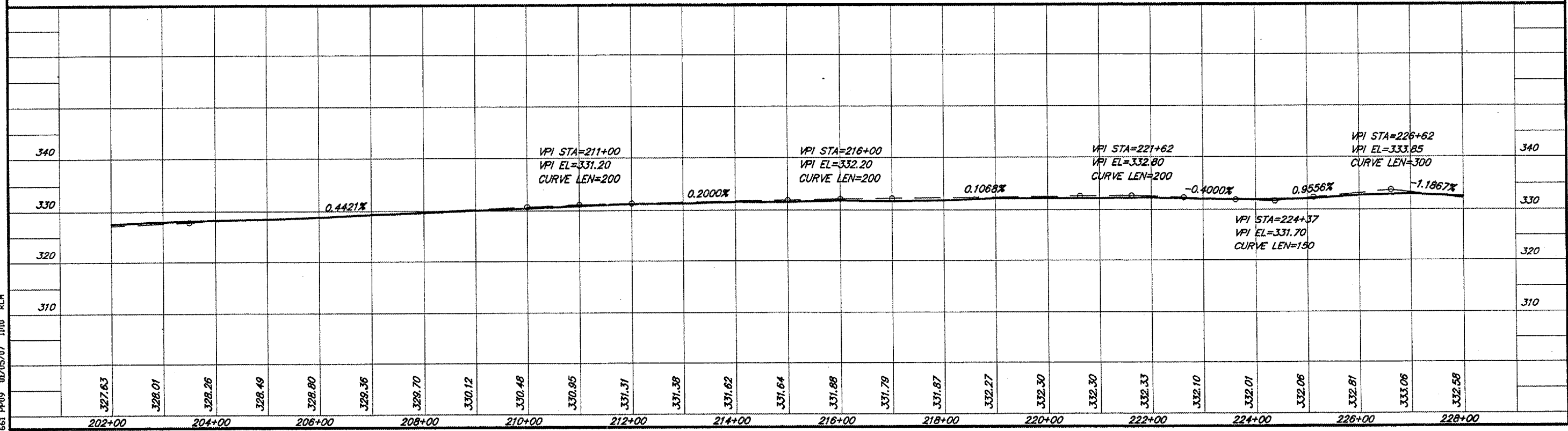

661 PP09 01/05/07 1110 RLM

ROUTE	SECTION	COUNTY	TOTAL SHEETS	SHEET NO.
FAS 946	05-00074-00-RS	ALEXANDER	15	13
PROJECT NO. RS-946 (106)			CONTRACT NO. 99287	

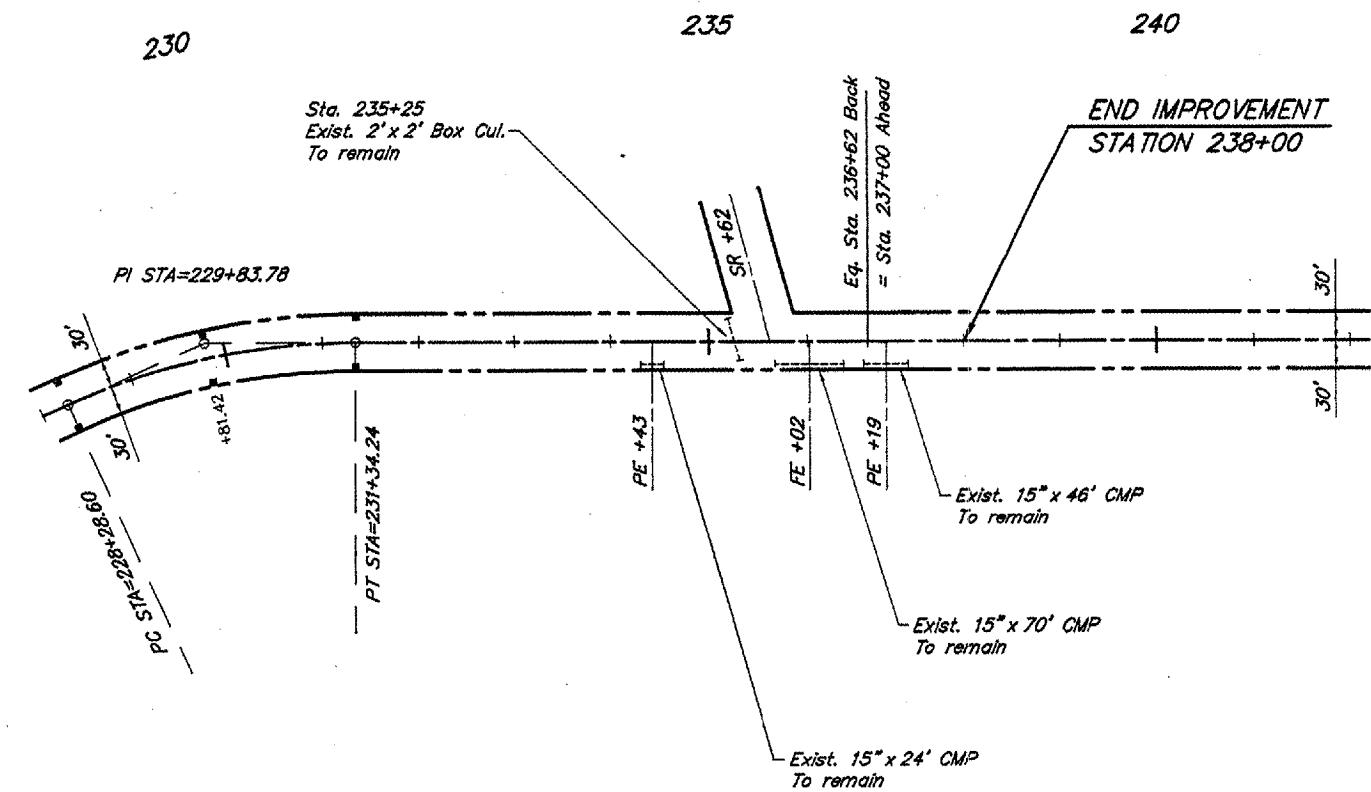
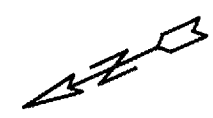

**CURVE DATA**

$\Delta = 24^{\circ}27'00''$   $T = 155.18'$   
 $D = 7^{\circ}59'59''$   $L = 305.63'$   
 $R = 716.22'$   $E = 16.62'$   
 $S.E. = 0.078'/ft.$   
 Attain Sta. 226+92 to Sta. 228+81  
 Remove Sta. 230+82 to Sta. 232+71

SCALES:  
 1" = 200' HOR  
 1" = 20' VER

661 PFD 01/05/07 11:07 RLM

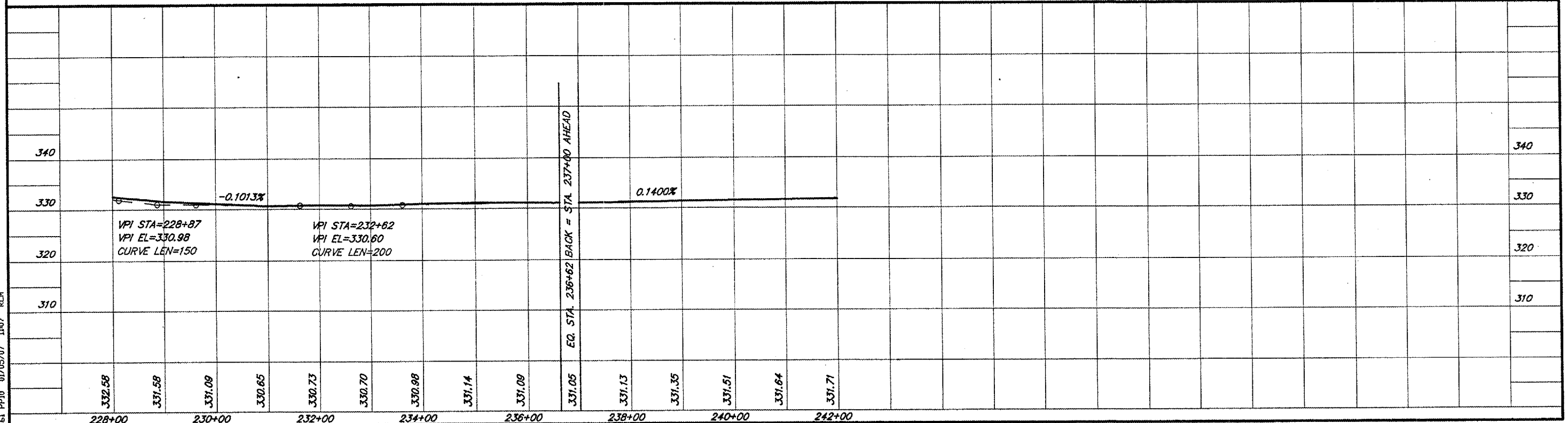

ROUTE	SECTION	COUNTY	TOTAL SHEETS	SHEET NO.
FAS 946	05-00074-00-RS	ALEXANDER	15	14
PROJECT NO. RS-946 (106)			CONTRACT NO. 99287	

Angle of Intersection	Side Road		Private Entrance	
	Acute L.	Obtuse L.	Acute L.	Obtuse L.
90° - 80°	25'	25'	15'	15'
79° - 70°	25'	40'	15'	25'
69° - 60°	25'	60'	15'	35'
59° - 50°	20'	75'	10'	40'
49° - 40°	20'	100'	10'	60'
39° - 30°	15'	150'	10'	100'

**NOTES**

Thickness of binder (if applicable) and surface course shall be equal to the mainline resurfacing.

Where hot-mix asphalt is to be placed, the existing surface shall be primed.

The actual number, and locations, of entrances and side roads shall be determined in the field by the Engineer.

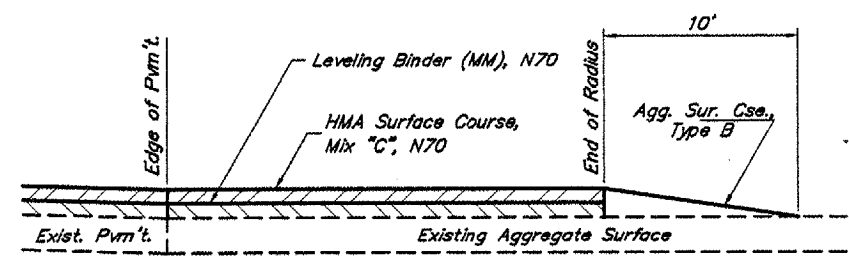

**SECTION A-A SIDE ROAD - AGGREGATE**  
(Est. No. = 4)

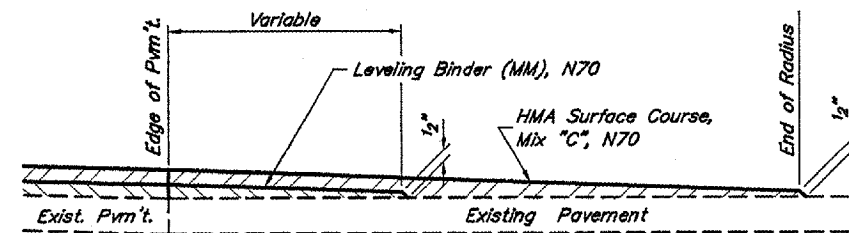

**SECTION B-B SIDE ROAD - ASPHALT**  
(Est. No. = 4)

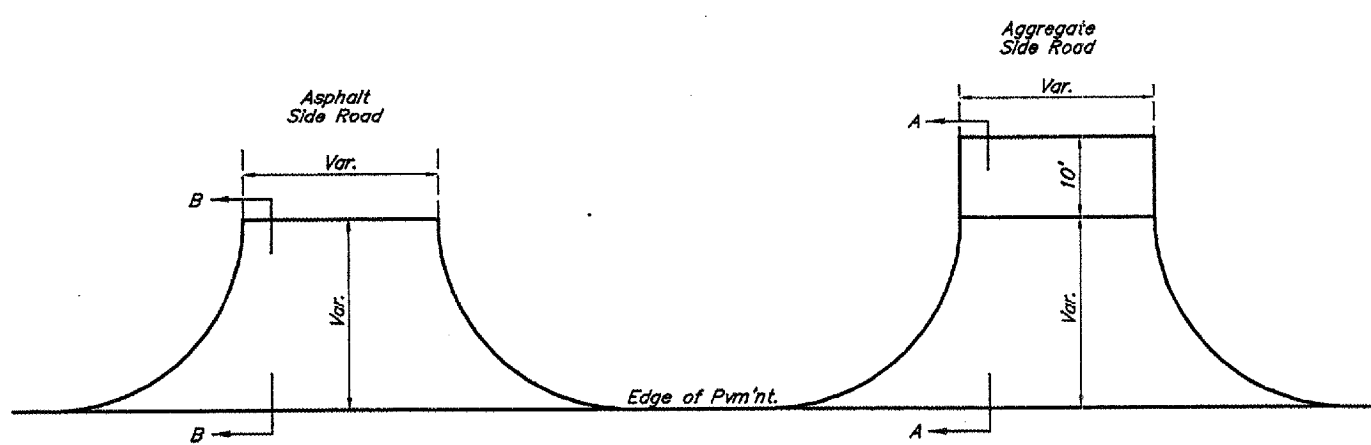

**TYPICAL SIDE ROAD DETAILS**

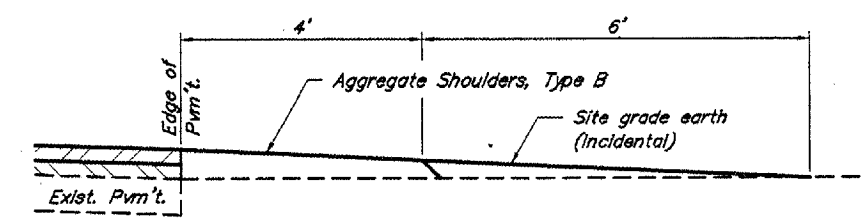

**SECTION A-A FIELD ENTRANCE**  
(Est. No. = 7)

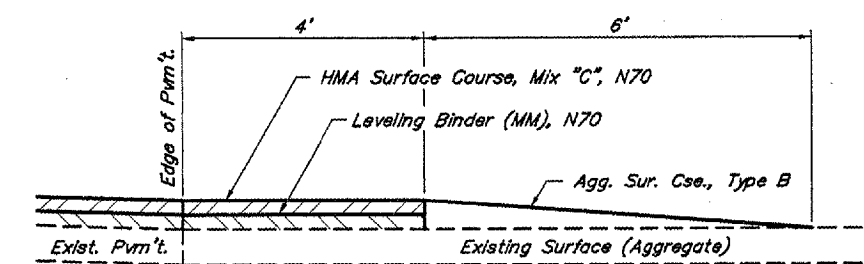

**SECTION A-A PRIVATE ENTRANCE - AGGREGATE**  
(Est. No. = 56)

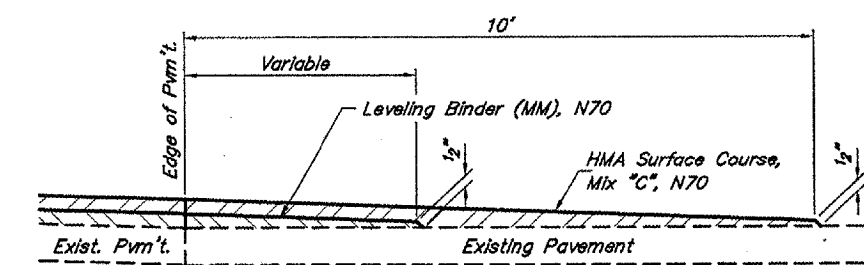

**SECTION A-A PRIVATE ENTRANCE - ASPHALT**  
(Est. No. = 7)

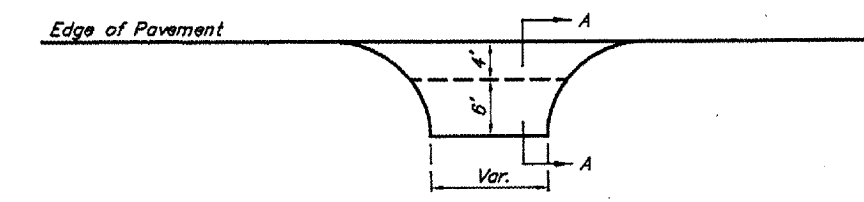

**TYPICAL ENTRANCE DETAILS**

TYPICAL SIDE ROAD AND ENTRANCE DETAILS  
FAS ROUTE 946  
SECTION 05-00074-00-RS  
PROJECT NO. RS-946 (106)  
ALEXANDER COUNTY

ROUTE	SECTION	COUNTY	TOTAL SHEETS	SHEET NO.
FAS 946	05-00074-00-RS	ALEXANDER	15	15
PROJECT NO. RS-946 (106)			CONTRACT NO. 99287	

SCHEDULE OF PAVEMENT MARKING LINE 4" (LIN. FT.)			
Location	Centerline (Yellow Dashed)	Edge Line (White Solid)	No Passing (Yellow Solid)
Sta. 1+11 to Sta. 238+00	5,670	46,760	10,680

See schedule below for limits of "No Passing Zones".  
See Standard 78001 for typical pavement markings.

SCHEDULE OF "NO PASSING ZONES"			
SOUTH BOUND LANE		NORTH BOUND LANE	
Location	Length	Location	Length
Sta. 1+60 to Sta. 11+00	940'	Sta. 1+60 to Sta. 19+00 <sup>1</sup>	1,740'
Sta. 18+50 <sup>1</sup> to Sta. 24+00	550'	Sta. 26+50 to Sta. 32+00 <sup>1</sup>	550'
Sta. 32+25 <sup>1</sup> to Sta. 40+25	800'	Sta. 40+25 to Sta. 48+25 <sup>1</sup>	800'
Sta. 61+25 <sup>1</sup> to Sta. 68+75	750'	Sta. 69+25 to Sta. 76+25 <sup>1</sup>	750'
Sta. 79+00 <sup>1</sup> to Sta. 85+25	625'	Sta. 87+00 to Sta. 93+25 <sup>1</sup>	625'
Sta. 127+50 <sup>1</sup> to Sta. 133+75	625'	Sta. 135+50 to Sta. 141+75 <sup>1</sup>	625'
Sta. 223+00 <sup>1</sup> to Sta. 229+50	650'	Sta. 231+00 to Sta. 237+50 <sup>1</sup>	650'
<b>TOTALS</b>	<b>4,940'</b>		<b>5,740'</b>

<sup>1</sup> Denotes location of "No Passing Zone" signs to be erected in accordance with Sign Schedule & Mounting Detail.

SCHEDULE OF SIGNS				
Location	Name	Signs		Post Length
		No.	Sq. Ft.	
Sta. 225+70 Rt.	CURVE	W1-2R	6.25	16.0
	ADVISORY SPEED	W13-1(45)	2.25	
Sta. 233+85 Lt.	CURVE	W1-2L	6.25	16.0
	ADVISORY SPEED	W13-1(45)	2.25	
Various (13)*	NO PASSING	W14-3	72.15	416.0
<b>TOTALS</b>			<b>89.15</b>	<b>448.0</b>

\* See Schedule of "No Passing Zones" for sign locations. Each location will have one sign of 5.55 Sq. Ft. and two posts with a combined length of 32.0 Ft. Quantities shown are totals.

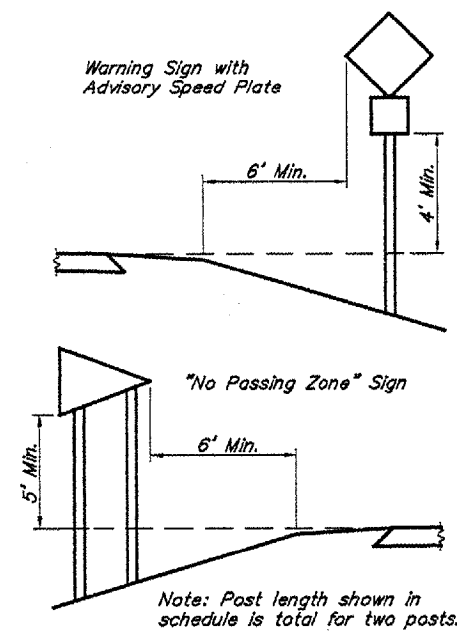

SIGN SCHEDULE & MOUNTING DETAIL

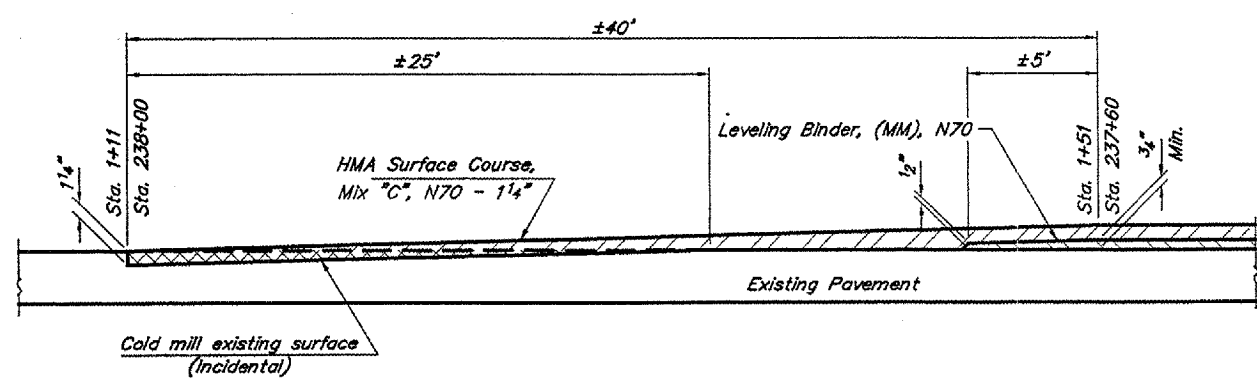

BEGINNING & ENDING BUTT JOINT

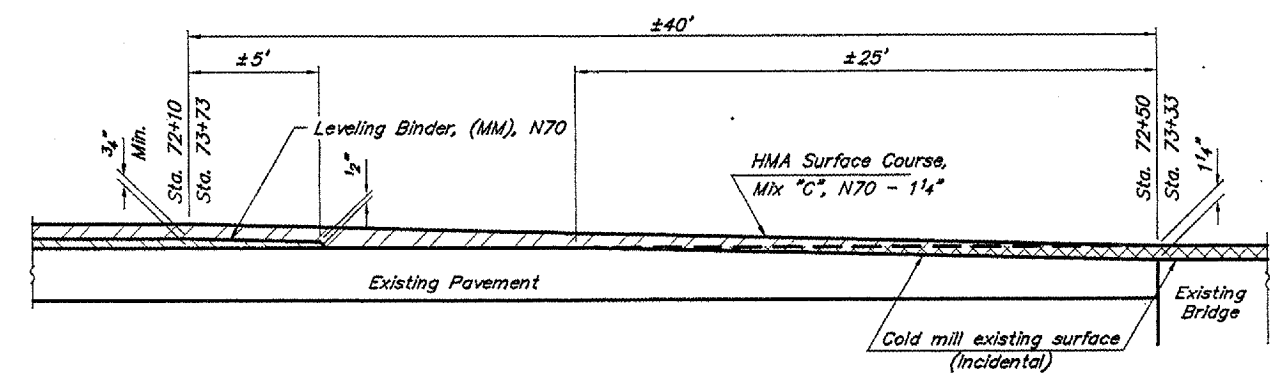

BRIDGE PAVING DETAIL

MISCELLANEOUS DETAILS  
FAS ROUTE 946  
SECTION 05-00074-00-RS  
PROJECT NO. RS-946 (106)  
ALEXANDER COUNTY