

CHURCH ST FROM WEBB TO RATCLIFF ST

TYPICAL CROSS SECTION EXISTING

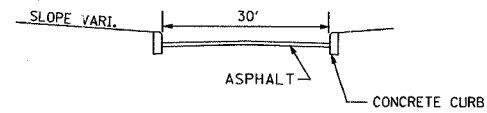

TYPICAL CROSS SECTION PROPOSED

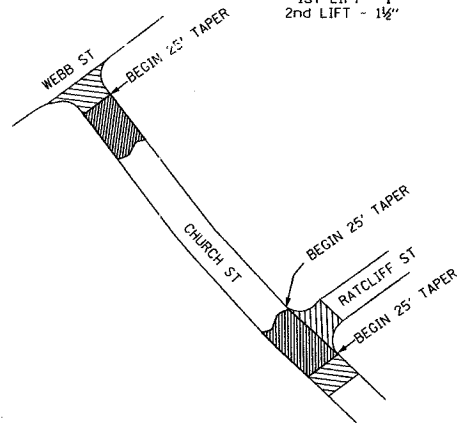
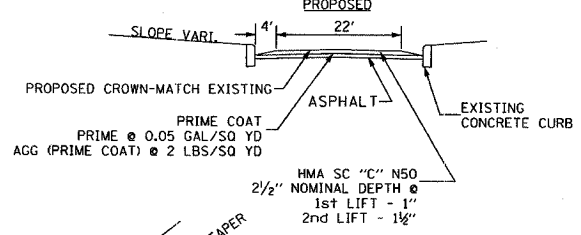

SO. CHURCH FROM N. PARK TO END

TYPICAL CROSS SECTION EXISTING

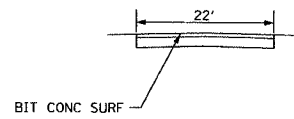

TYPICAL CROSS SECTION PROPOSED

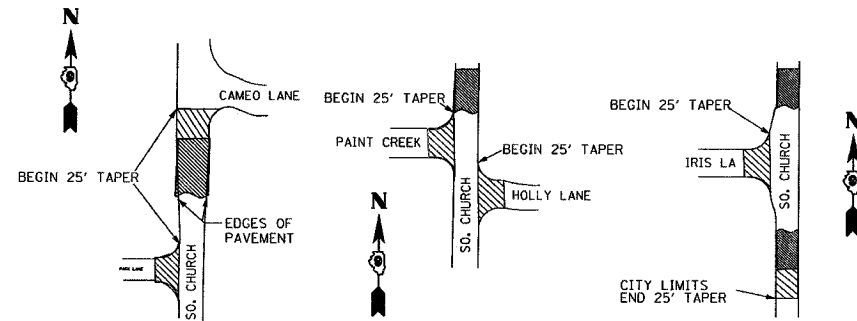
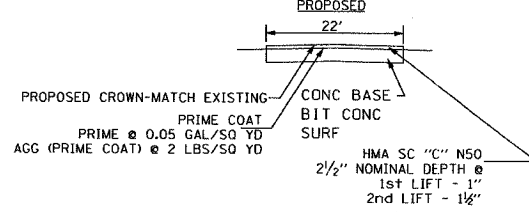

PLUM FROM MAIN ST TO CHURCH PARKING LOT

TYPICAL CROSS SECTION EXISTING

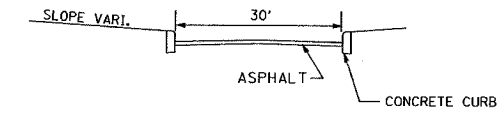

TYPICAL CROSS SECTION PROPOSED

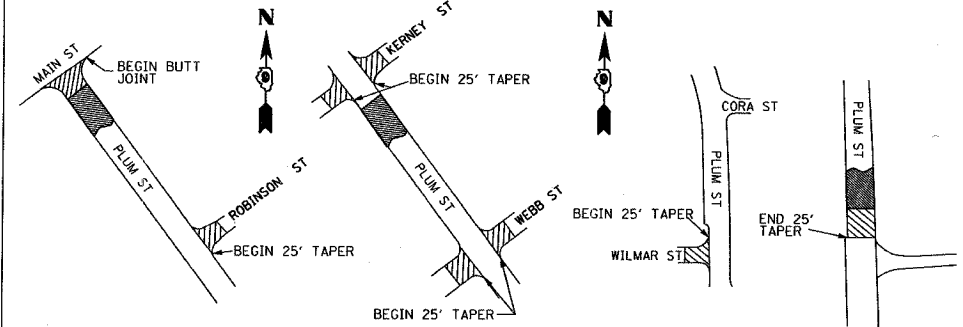
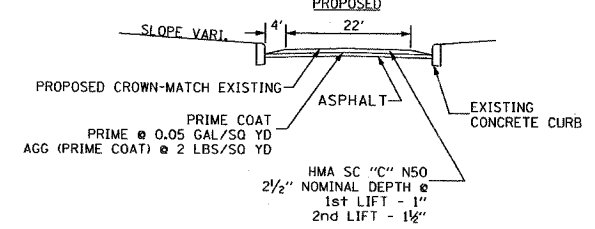

SECTION	COUNTY	TOTAL SHEETS	SHEET NO.
06-00086-00-RS	WHITE	3	3
CITY OF CARM	VARIOUS CITY STREETS		
FED. RD. DIST. NO. 9	LEC JOB NO. H061017CA		

323 W. 3RD ST.  
P.O. BOX 160  
MT. CARMEL, IL  
62863  
PHONE:  
(618)-262-8651  
FAX:  
(618)-263-3327

405 W. STATE ST.  
SUITE 1  
PRINCETON, IN  
47670  
PHONE:  
(812)-386-7611  
FAX:  
(812)-385-2812



PROFESSIONAL DESIGN FIRM  
LAND SURVEY &  
PROFESSIONAL ENGINEERING CORPORATION



AARON M. MEFFORD  
NAME  
*Aaron Mefford*  
SIGNATURE  
2-7-07  
DATE  
11-30-07  
EXPIRES

COLLEGE FROM MAIN TO SO. END CULVERT

TYPICAL CROSS SECTION EXISTING

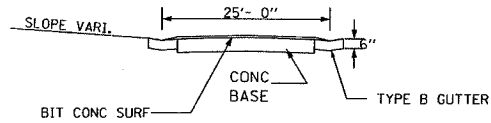

TYPICAL CROSS SECTION PROPOSED

