

ROUTE	SECTION	COUNTY	TOT. SHTS.	SHT.
FAS 836	05-00188-00-RS	JEFFERSON	2	1
JEFFERSON COUNTY				

CONTRACT 99291

STATE OF ILLINOIS DEPARTMENT OF TRANSPORTATION

INDEX OF SHEETS

- COVER SHEET, LOCATION MAP, SCHEDULE OF QUANTITIES
- GENERAL NOTES, TYPICAL EXISTING AND PROPOSED CROSS-SECTIONS, HOT-MIX ASPHALT BREAKDOWN, STRIPING, DETAILS OF SIDE ROADS, PRIVATE ENTRANCES AND MAILBOX TURNOUTS

MILLING AREA DETAIL

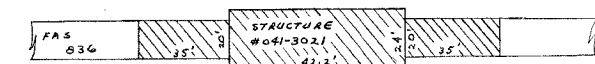

MILLING AREA

PLAN VIEW

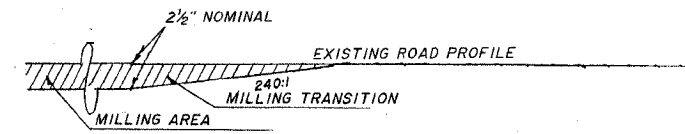

PROFILE

PLANS FOR PROPOSED FEDERAL AID SECONDARY PROJECT

F.A.S. 836 C.H.35 JEFFERSON CO. SECTION 05-00188-00-RS PROJECT#ACRS-836 (113)

JOB #C-99-574-06

STANDARDS

- 0000001-04
- 442201-02
- 630001-07
- 630101-07
- 701006-02
- 701306-01
- 701311-02
- 701336-04
- 702001-06
- 780001-01
- B.L.R. 21-6
- B.L.R. 22-4

SCHEDULE OF QUANTITIES			
Quantity	Unit	Item	Code Number
1215	FOOT	SHORT-TERM PAVEMENT MARKING REMOVAL	XK021140
1	EACH	SOLAR-POWERED FLASHING BEACON ASSEMBLY (COMPLETE)	EX005938
2.68	SQ. YD.	COLD MILLING	20010700
750	FEET	RUMBLE STRIP	20055400
155	TON	AGGREGATE SURFACE COURSE, TYPE B	40200800
2790	GALLON	BLU-MIX MATERIALS (PRIME COAT)	40600100
1630	TON	LEVELING BINDER (MACHINE METHOD) R50	40600625
2977	TON	HOT-MIX ASPHALT SURFACE COURSE, MIX "C", H5C	44201797
106	SQ. YD.	CLASS D PATCHES, TYPE III, 9 INCH	44201759
401	SQ. YD.	CLASS D PATCHES, TYPE IV, 9 INCH	44300300
26998	SQ. YD.	AREA REFLECTIVE CRACK CONTROL TREATMENT, SYSTEM A	48101200
790	TON	AGGREGATE SHOULDERS, TYPE B	63000000
288	FOOT	STEEL PLATE BEAM GUARDRAIL, TYPE A	63000025
75	FOOT	STEEL PLATE BEAM GUARDRAIL, TYPE B	63100167
25	FOOT	TRAFFIC BARRIER TERMINAL TYPE 1, SPECIAL (TANGENT)	67100100
1	L. SUM	MOBILIZATION	70100460
1	L. SUM	TRAFFIC CONTROL AND PROTECTION, STANDARD T01306	70100600
1	L. SUM	TRAFFIC CONTROL AND PROTECTION, STANDARD T01336	70300100
2430	FOOT	SHORT-TERM PAVEMENT MARKING	78000200
38901	FOOT	THERMOPLASTIC PAVEMENT MARKING	78201000
4	EACH	TERMINAL MARKER-DIRECT APPLIED	

* SPECIALTY ITEMS

GUARDRAIL SCHEDULE	
STEEL PLATE BEAM GUARDRAIL TYPE A	
STA. 55+75 TO STA. 57+50 LT.	
STA. 57+00 TO STA. 58+12.5 RT.	
STEEL PLATE BEAM GUARDRAIL TYPE B	
STA. 94+93.75 TO STA. 95+18.75 LT.	
STA. 95+31.25 TO STA. 95+43.75 LT.	
STA. 95+06.25 TO STA. 95+18.75 RT.	
STA. 95+31.25 TO STA. 95+56.25 RT.	
STEEL PLATE BEAM GUARDRAIL ATTACHED TO STRUCTURES	
STA. 95+18.75 TO 95+31.25 LT.	
STA. 95+18.75 TO 95+31.25 RT.	
TRAFFIC BARRIER TERMINAL TYPE 1, SPECIAL (TANGENT)	
STA. 57+50 TO STA. 58+00 LT.	
STA. 58+50 TO STA. 57+00 RT.	
STA. 95+43.75 TO STA. 95+93.75 LT.	
STA. 94+56.25 TO STA. 95+06.25 RT.	

FUNCTIONAL CLASSIFICATION=LOCAL ROAD
DESIGN SPEED=50 MPH
ADT=600

J.U.L.I.E.
JOINT UTILITY LOCATING
INFORMATION FOR EXCAVATION
1-800-892-0123
WWW.ILLINOIS1CALL.COM

TOTAL SECTION LENGTH=12,149'=2.301 MI.
OMISSION=0.00'
NET LENGTH=12,149'=2.301 MI.

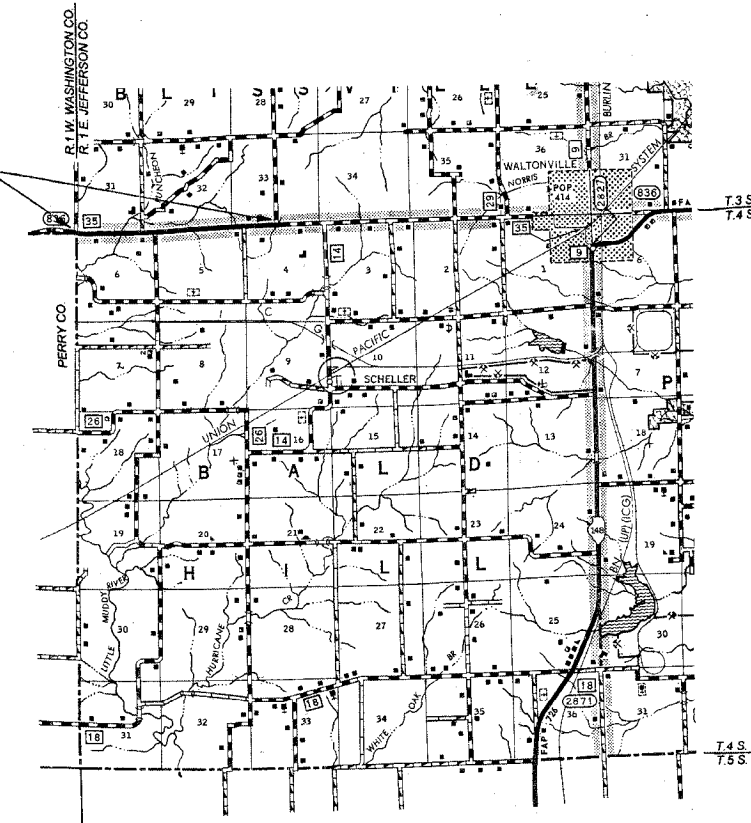

APPROVED JANUARY 15, 2007

John S. Schwaibe
COUNTY ENGINEER
JEFFERSON COUNTY HIGHWAY DEPT
750 OLD FAIRFIELD RD.
MT. VERNON, IL 62864
PH (618)244-8031
LICENSE EXP. 11-30-07

PASSED JANUARY 24, 2007

Dennis W. Hillier
DISTRICT NINE ENGINEER OF
LOCAL ROADS AND STREETS

Releasing for bid based on limited review Jan 25, 2007

May O'Amis
DEPUTY DIRECTOR OF HIGHWAYS
REGION FIVE ENGINEER

STATE OF ILLINOIS
DEPARTMENT OF TRANSPORTATION

T.4 S. JEFFERSON CO.
T.5 S. FRANKLIN CO.