

SEE SHEET 90 FOR PAVEMENT  
JOINTING ON MCLEAN BOULEVARD

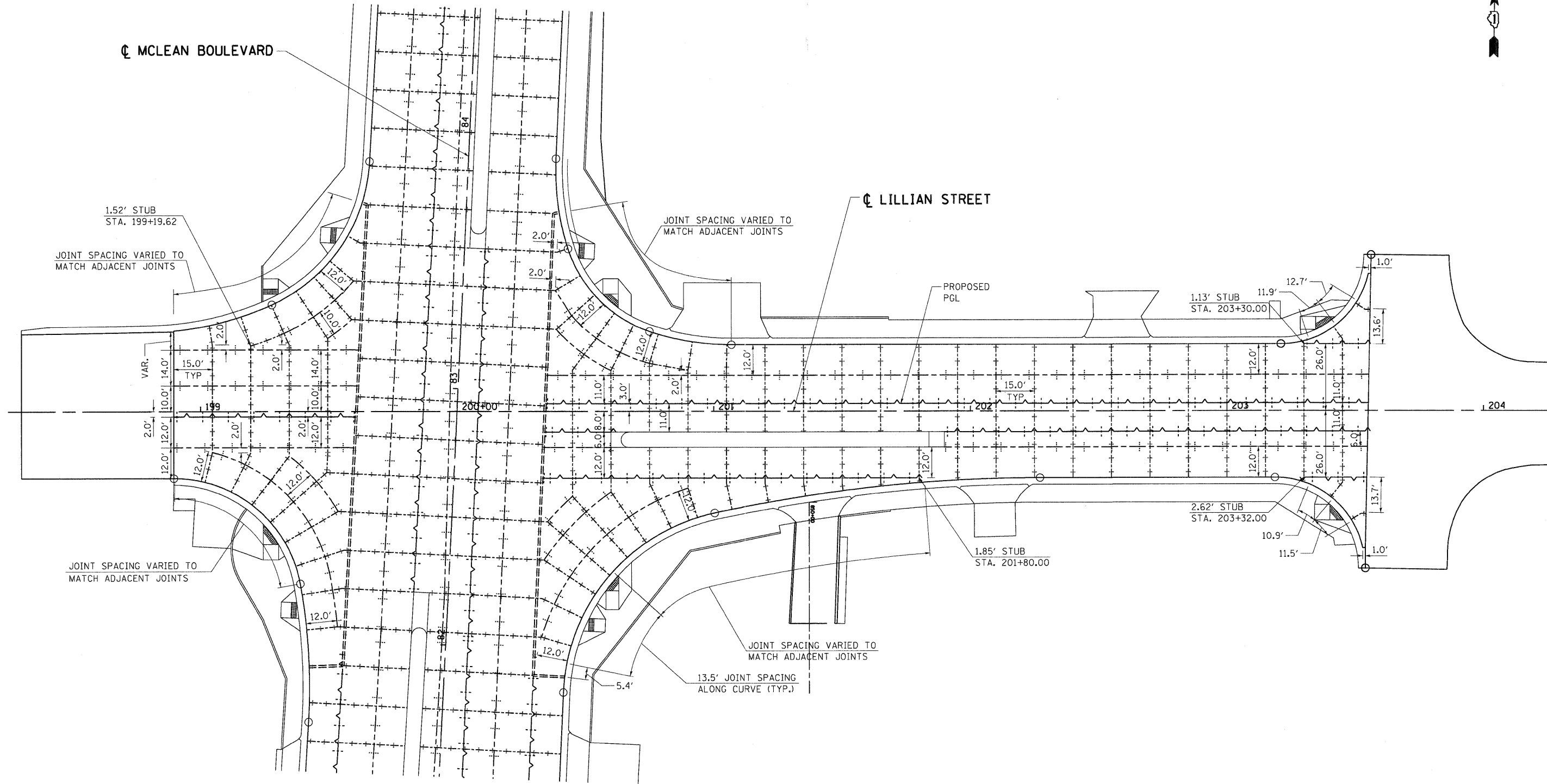

SEE SHEET 90 FOR PAVEMENT  
JOINTING ON MCLEAN BOULEVARD

**PAVEMENT JOINT LEGEND**

	LONGITUDINAL KEYED JOINT WITHOUT TIE BARS		SAWED TRANSVERSE CONTRACTION JOINT W/IN PCC SHLD
	LONGITUDINAL CONSTRUCTION JOINT WITH TIE BARS		TRANSVERSE EXPANSION JOINT
	SAWED TRANSVERSE CONTRACTION JOINT		PAVEMENT SEPARATION JOINT
	SAWED LONGITUDINAL JOINT		

**NOTES**

1. SEE HIGHWAY STD 420001, 420306 & 420206 AND DISTRICT 1 DETAILS BD49 & BD52 FOR PAVEMENT JOINT DETAILS.
2. LONGITUDINAL CONSTRUCTION JOINTS W/ TIE BARS SHALL BE PLACED BETWEEN PCC PAVEMENT AND PCC SHOULDER, NOT SHOWN FOR CLARITY.
3. MAINLINE AND RAMP CRCP PAVEMENT REINFORCEMENT & JOINTS ARE NOT SHOWN FOR CLARITY. SEE STANDARDS 420206, 420306, AND 421201.
4. GORE NOSE LOCATIONS SHALL BE ALIGNED WITH MAINLINE SHOULDER TRANSVERSE JOINT.
5. ADDITIONAL SAWED TRANSVERSE CONTRACTION JOINTS MAY BE REQUIRED IN THE FIELD. EXACT LOCATIONS TO BE VERIFIED IN THE FIELD AND APPROVED BY THE ENGINEER.
6. CONCRETE STUBS SHALL HAVE A 1' MINIMUM WIDTH.

**STATE OF ILLINOIS**  
**DEPARTMENT OF TRANSPORTATION**  
FAP ROUTE 345 / US ROUTE 20

**PAVEMENT JOINTING PLAN**  
**LILLIAN STREET**

FILE NAME =	USER NAME = #USER#	DESIGNED - JP	REVISED -	STATE OF ILLINOIS DEPARTMENT OF TRANSPORTATION FAP ROUTE 345 / US ROUTE 20	PAVEMENT JOINTING PLAN LILLIAN STREET	F.A.P. RTE.	SECTION	COUNTY	TOTAL SHEETS	SHEET NO.
#FILE#	PLOT SCALE = #SCALE#	DRAWN - MH	REVISED -			345	BR-R	KANE	794	91
	PLOT DATE = #DATE#	CHECKED - DDH	REVISED -						CONTRACT NO. 60H45	
		DATE - 12/16/11	REVISED -	SCALE: 1"=20'	SHEET NO. OF	STA. 198+30.19 TO STA. 204+25.00	FED. ROAD DIST. NO.	ILLINOIS FED. AID PROJECT		

\\D:\60H45-BORDER\01.DGN, \\D:\60H45-LEGEND\01.DGN, \\D:\60H45-DESIGN\01.DGN, \\D:\60H45-DESIGN\02.DGN, \\D:\60H45-DESIGN\03.DGN, \\D:\60H45-DESIGN\04.DGN, \\D:\60H45-DESIGN\05.DGN, \\D:\60H45-DESIGN\06.DGN, \\D:\60H45-DESIGN\07.DGN, \\D:\60H45-DESIGN\08.DGN, \\D:\60H45-DESIGN\09.DGN, \\D:\60H45-DESIGN\10.DGN, \\D:\60H45-DESIGN\11.DGN, \\D:\60H45-DESIGN\12.DGN, \\D:\60H45-DESIGN\13.DGN, \\D:\60H45-DESIGN\14.DGN, \\D:\60H45-DESIGN\15.DGN, \\D:\60H45-DESIGN\16.DGN, \\D:\60H45-DESIGN\17.DGN, \\D:\60H45-DESIGN\18.DGN, \\D:\60H45-DESIGN\19.DGN, \\D:\60H45-DESIGN\20.DGN, \\D:\60H45-DESIGN\21.DGN, \\D:\60H45-DESIGN\22.DGN, \\D:\60H45-DESIGN\23.DGN, \\D:\60H45-DESIGN\24.DGN, \\D:\60H45-DESIGN\25.DGN, \\D:\60H45-DESIGN\26.DGN, \\D:\60H45-DESIGN\27.DGN, \\D:\60H45-DESIGN\28.DGN, \\D:\60H45-DESIGN\29.DGN, \\D:\60H45-DESIGN\30.DGN, \\D:\60H45-DESIGN\31.DGN, \\D:\60H45-DESIGN\32.DGN, \\D:\60H45-DESIGN\33.DGN, \\D:\60H45-DESIGN\34.DGN, \\D:\60H45-DESIGN\35.DGN, \\D:\60H45-DESIGN\36.DGN, \\D:\60H45-DESIGN\37.DGN, \\D:\60H45-DESIGN\38.DGN, \\D:\60H45-DESIGN\39.DGN, \\D:\60H45-DESIGN\40.DGN, \\D:\60H45-DESIGN\41.DGN, \\D:\60H45-DESIGN\42.DGN, \\D:\60H45-DESIGN\43.DGN, \\D:\60H45-DESIGN\44.DGN, \\D:\60H45-DESIGN\45.DGN, \\D:\60H45-DESIGN\46.DGN, \\D:\60H45-DESIGN\47.DGN, \\D:\60H45-DESIGN\48.DGN, \\D:\60H45-DESIGN\49.DGN, \\D:\60H45-DESIGN\50.DGN, \\D:\60H45-DESIGN\51.DGN, \\D:\60H45-DESIGN\52.DGN, \\D:\60H45-DESIGN\53.DGN, \\D:\60H45-DESIGN\54.DGN, \\D:\60H45-DESIGN\55.DGN, \\D:\60H45-DESIGN\56.DGN, \\D:\60H45-DESIGN\57.DGN, \\D:\60H45-DESIGN\58.DGN, \\D:\60H45-DESIGN\59.DGN, \\D:\60H45-DESIGN\60.DGN, \\D:\60H45-DESIGN\61.DGN, \\D:\60H45-DESIGN\62.DGN, \\D:\60H45-DESIGN\63.DGN, \\D:\60H45-DESIGN\64.DGN, \\D:\60H45-DESIGN\65.DGN, \\D:\60H45-DESIGN\66.DGN, \\D:\60H45-DESIGN\67.DGN, \\D:\60H45-DESIGN\68.DGN, \\D:\60H45-DESIGN\69.DGN, \\D:\60H45-DESIGN\70.DGN, \\D:\60H45-DESIGN\71.DGN, \\D:\60H45-DESIGN\72.DGN, \\D:\60H45-DESIGN\73.DGN, \\D:\60H45-DESIGN\74.DGN, \\D:\60H45-DESIGN\75.DGN, \\D:\60H45-DESIGN\76.DGN, \\D:\60H45-DESIGN\77.DGN, \\D:\60H45-DESIGN\78.DGN, \\D:\60H45-DESIGN\79.DGN, \\D:\60H45-DESIGN\80.DGN, \\D:\60H45-DESIGN\81.DGN, \\D:\60H45-DESIGN\82.DGN, \\D:\60H45-DESIGN\83.DGN, \\D:\60H45-DESIGN\84.DGN, \\D:\60H45-DESIGN\85.DGN, \\D:\60H45-DESIGN\86.DGN, \\D:\60H45-DESIGN\87.DGN, \\D:\60H45-DESIGN\88.DGN, \\D:\60H45-DESIGN\89.DGN, \\D:\60H45-DESIGN\90.DGN, \\D:\60H45-DESIGN\91.DGN, \\D:\60H45-DESIGN\92.DGN, \\D:\60H45-DESIGN\93.DGN, \\D:\60H45-DESIGN\94.DGN, \\D:\60H45-DESIGN\95.DGN, \\D:\60H45-DESIGN\96.DGN, \\D:\60H45-DESIGN\97.DGN, \\D:\60H45-DESIGN\98.DGN, \\D:\60H45-DESIGN\99.DGN, \\D:\60H45-DESIGN\100.DGN