

NOTES:

- TEMPORARY PAVEMENT ON MCLEAN BOULEVARD, LILLIAN STREET AND ASSOCIATED SIDE STREETS SHALL BE ACCORDING TO THE PAVEMENT STRUCTURE AND MIX DESIGN REQUIREMENTS SHOWN ON THE TYPICAL SECTIONS SHEET 38

LEGEND

- TEMPORARY CONCRETE BARRIER
- VERTICAL PANELS WITH FLASHING LIGHT
- DRUM OR BARRICADE WITH FLASHING LIGHT
- DIRECTION OF TRAFFIC
- TEMPORARY PAVEMENT (SEE NOTE 2)
- (A) TEMP PAVEMENT MARKING LINE 4" WHITE
- (B) TEMP PAVEMENT MARKING LINE 4" YELLOW
- (C) TEMP PAVEMENT MARKING LINE 4" WHITE (10' DASH- 30' SKIP)
- (D) TEMP PAVEMENT MARKING LINE 4" DOUBLE YELLOW
- (E) TEMP PAVEMENT MARKING LINE 6" WHITE

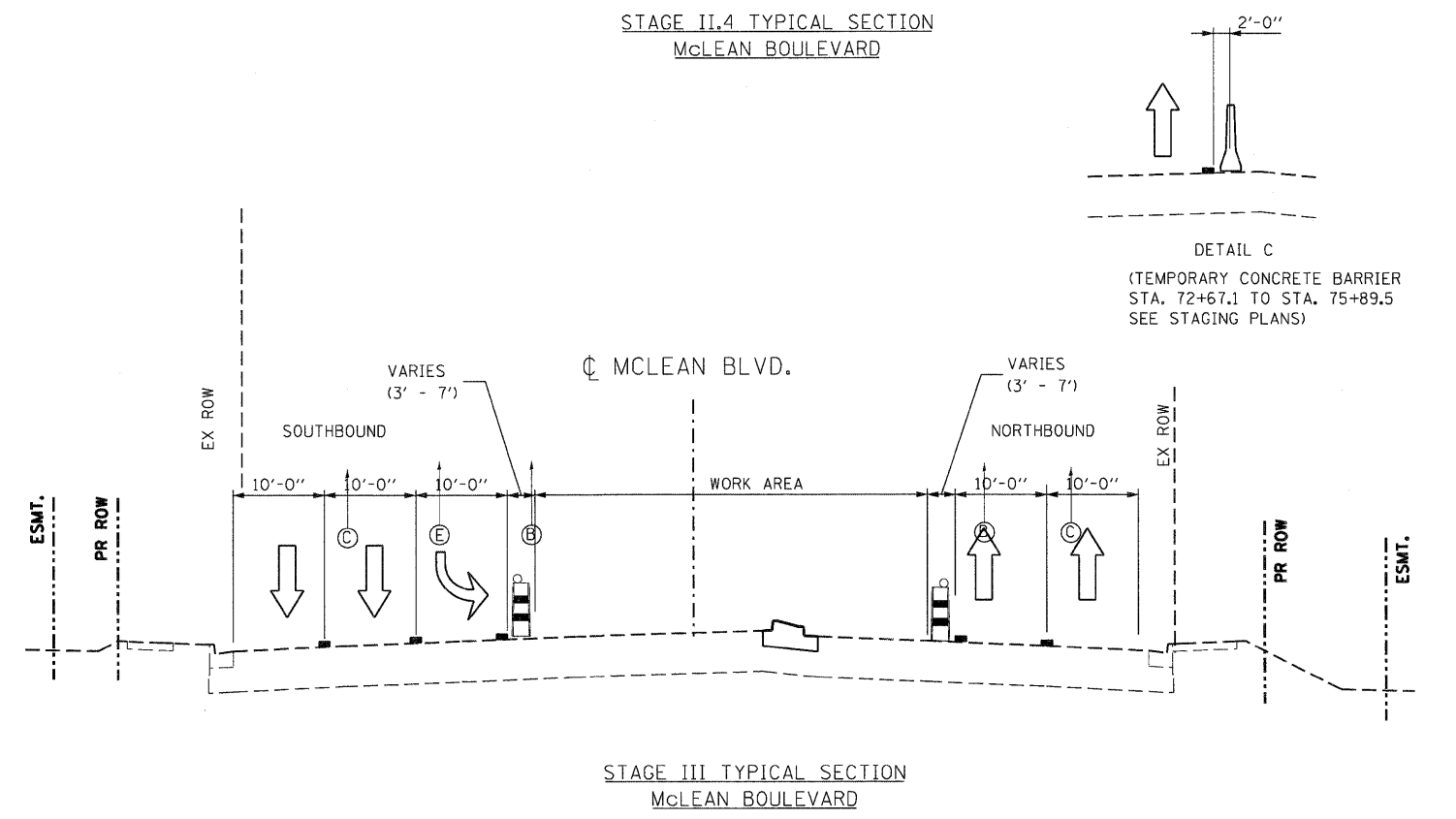

\D:\60445-XSCS\STG.DGN...D:\60445-80RDER01.DGN...D:\60445-LECEVND.DGN
 12-12-2011, 12:53:08
 BA\ZELKJ \NFS-8044\VM\VALT.D-TRANS_07\2202-21379-001\CIVIL\CAD\60445\SHEET\0160445-SHT-STAGING01604.DGN

FILE NAME = #FILE#	USER NAME = #USER#	DESIGNED - MM	REVISED -	STATE OF ILLINOIS DEPARTMENT OF TRANSPORTATION FAP ROUTE 345 / US ROUTE 20	STAGING AND TRAFFIC CONTROL McLEAN BOULEVARD TYPICAL SECTIONS STAGE II			F.A.P RTE. 345	SECTION 8R-R	COUNTY KANE	TOTAL SHEETS 794	SHEET NO. 133
PLOT SCALE = #SCALE#	PLOT DATE = #DATE#	DRAWN - KKS	REVISED -		SCALE: 1"=10'	SHEET NO. OF	STA. TO STA.	CONTRACT NO. 60H45				
CHECKED - PB	DATE - 12/16/11	REVISOR -	REVISIONS -		FED. ROAD DIST. NO. ILLINOIS FED. AID PROJECT							