

LEGEND

- WORK AREA
- IMPACT ATTENUATOR
- TEMPORARY CONCRETE BARRIER
- TYPE II BARRICADES OR DRUMS WITH STEADY BURN MONODIRECTIONAL LIGHT (AT SPECIFIED SPACING)
- DIRECTION OF TRAFFIC FLOW
- SIGN
- VERTICAL PANELS WITH STEADY BURNING LIGHTS (AT SPECIFIED SPACING)
- ARROW BOARD
- TYPE III BARRICADE
- TEMPORARY PAVEMENT, CURRENT STAGE
- TEMPORARY PAVEMENT, PREVIOUS STAGES



NOTES:

- 1) TEMPORARY CONCRETE BARRIER AND ASSOCIATED IMPACT ATTENUATORS PLACED IN CONTRACT 60K90.
- 2) FOR LOCATION OF "ROAD CONSTRUCTION AHEAD" AND "END CONSTRUCTION" SIGNS, REFER TO LOCATION SHOWN DURING STAGE 1A ON SHEET 139

NOTES:

1. UPPER DRAWING NOT TO SCALE.

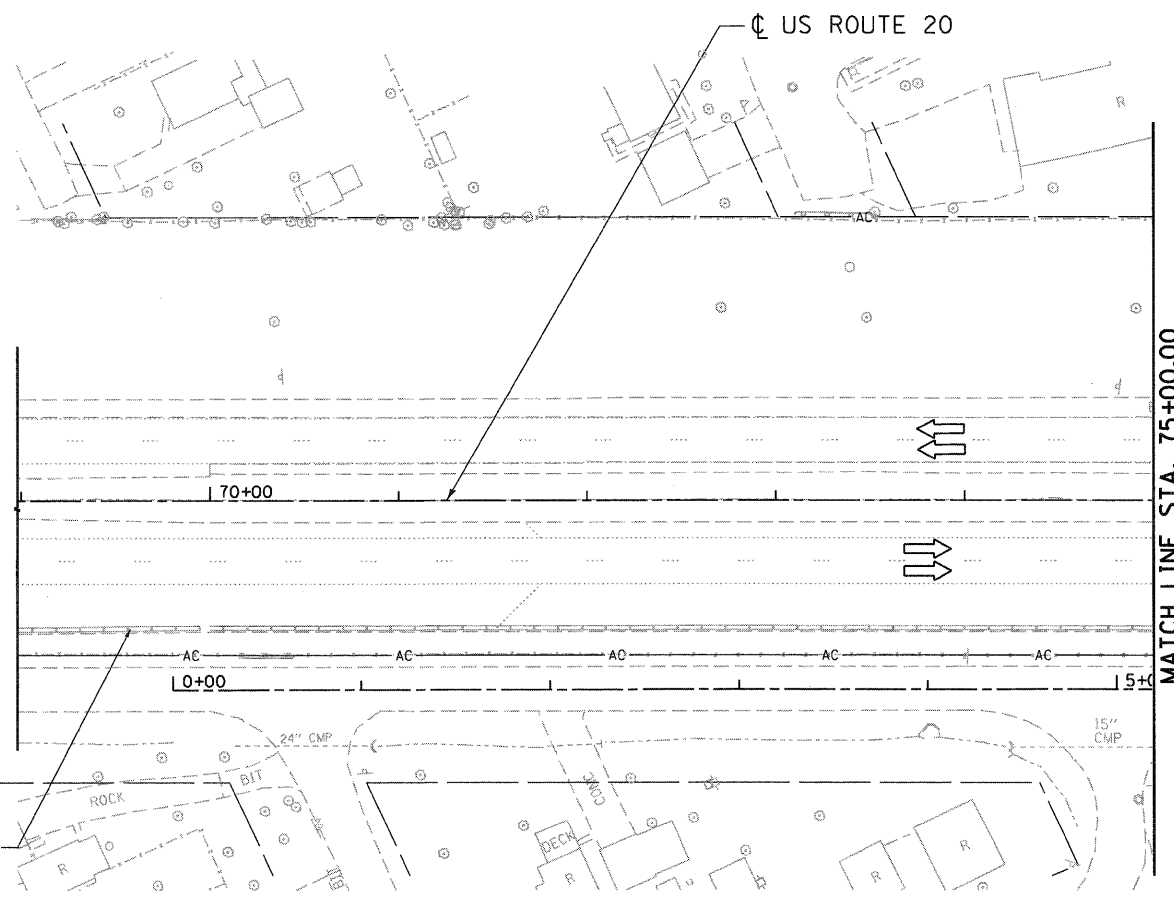
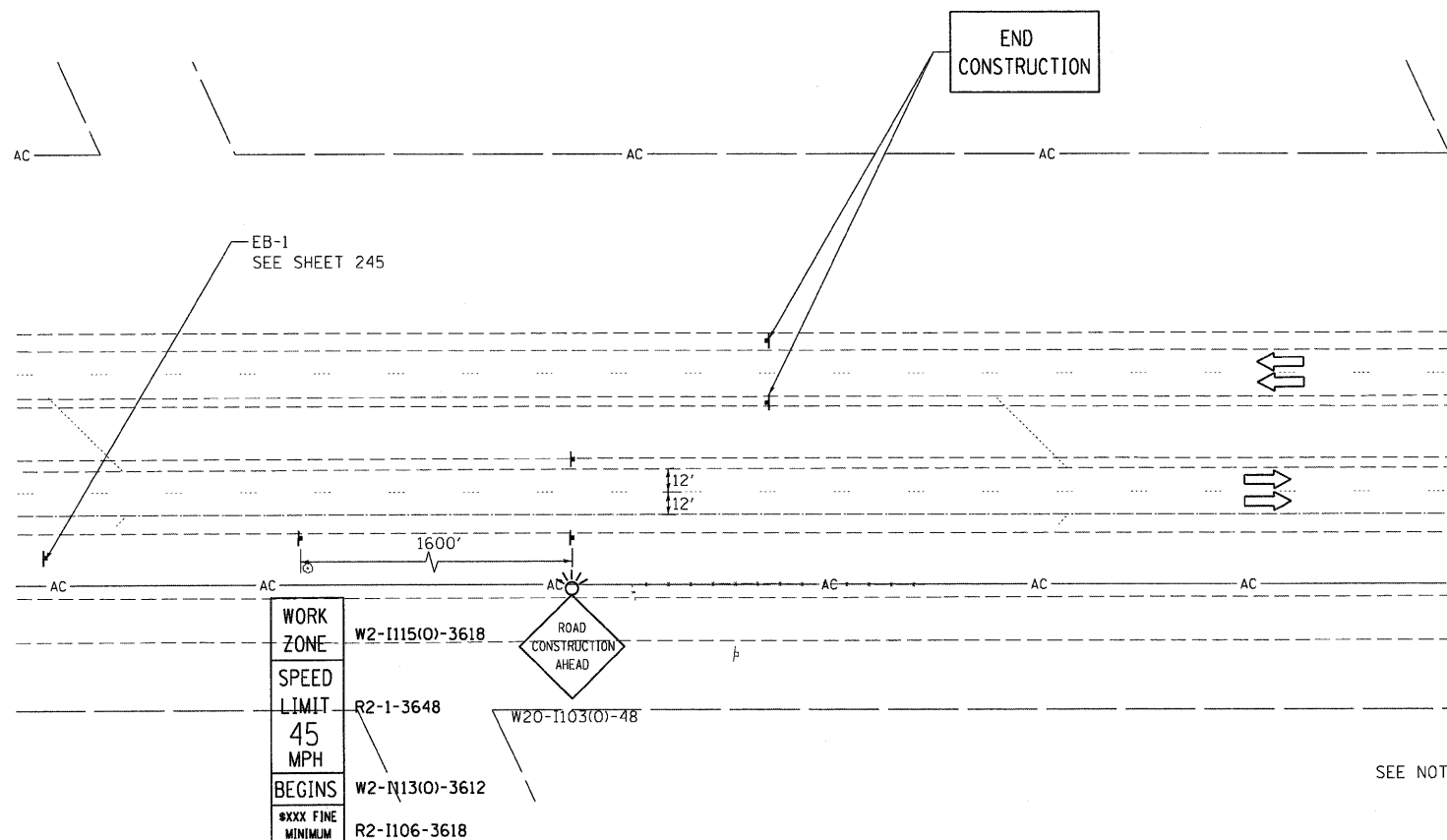
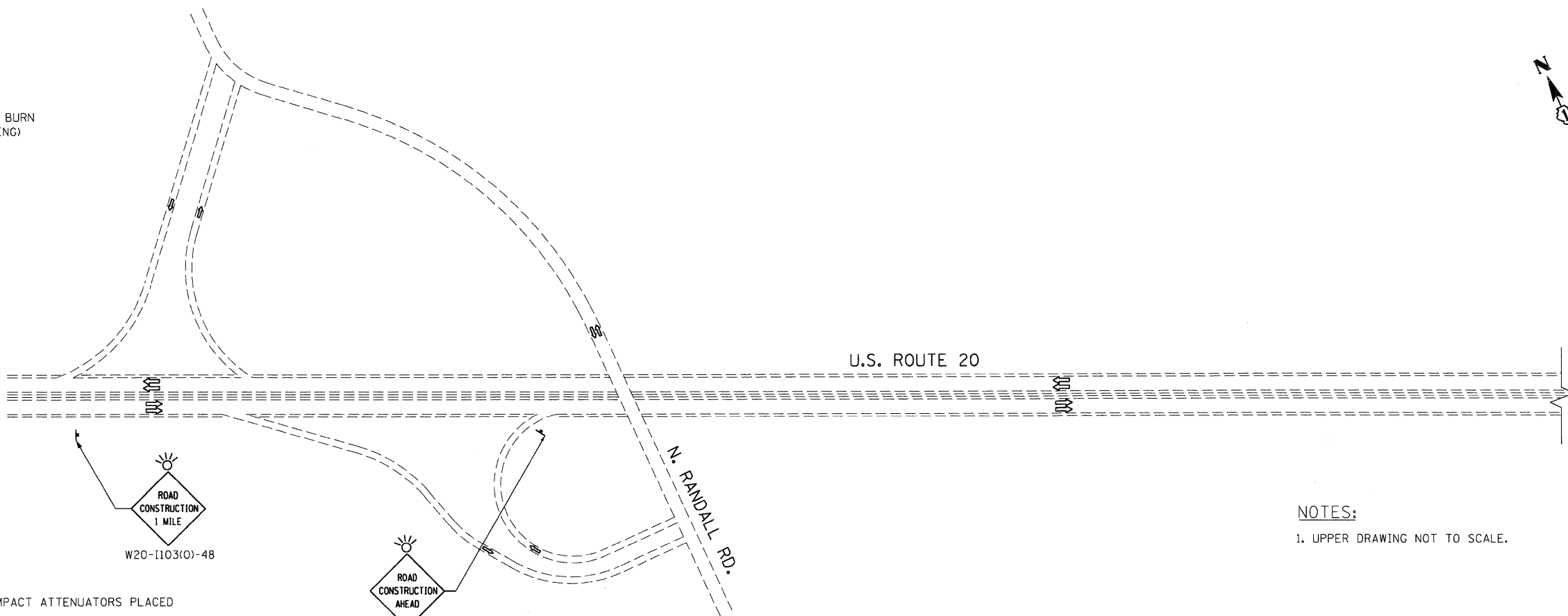

..\D168H45-BORDER02.DGN, ..\D168H45-LEGEND.DGN, ..\D168H45-STAGING01.DGN, ..\D168H45-STAGING02.DGN, ..\D168H45-STAGING03.DGN, ..\D168H45-STAGING04.DGN, ..\D168H45-STAGING05.DGN, ..\D168H45-STAGING06.DGN, ..\D168H45-STAGING07.DGN, ..\D168H45-STAGING08.DGN, ..\D168H45-STAGING09.DGN, ..\D168H45-STAGING10.DGN, ..\D168H45-STAGING11.DGN, ..\D168H45-STAGING12.DGN, ..\D168H45-STAGING13.DGN, ..\D168H45-STAGING14.DGN, ..\D168H45-STAGING15.DGN, ..\D168H45-STAGING16.DGN, ..\D168H45-STAGING17.DGN, ..\D168H45-STAGING18.DGN, ..\D168H45-STAGING19.DGN, ..\D168H45-STAGING20.DGN, ..\D168H45-STAGING21.DGN, ..\D168H45-STAGING22.DGN, ..\D168H45-STAGING23.DGN, ..\D168H45-STAGING24.DGN, ..\D168H45-STAGING25.DGN, ..\D168H45-STAGING26.DGN, ..\D168H45-STAGING27.DGN, ..\D168H45-STAGING28.DGN, ..\D168H45-STAGING29.DGN, ..\D168H45-STAGING30.DGN, ..\D168H45-STAGING31.DGN, ..\D168H45-STAGING32.DGN, ..\D168H45-STAGING33.DGN, ..\D168H45-STAGING34.DGN, ..\D168H45-STAGING35.DGN, ..\D168H45-STAGING36.DGN, ..\D168H45-STAGING37.DGN, ..\D168H45-STAGING38.DGN, ..\D168H45-STAGING39.DGN, ..\D168H45-STAGING40.DGN, ..\D168H45-STAGING41.DGN, ..\D168H45-STAGING42.DGN, ..\D168H45-STAGING43.DGN, ..\D168H45-STAGING44.DGN, ..\D168H45-STAGING45.DGN, ..\D168H45-STAGING46.DGN, ..\D168H45-STAGING47.DGN, ..\D168H45-STAGING48.DGN, ..\D168H45-STAGING49.DGN, ..\D168H45-STAGING50.DGN, ..\D168H45-STAGING51.DGN, ..\D168H45-STAGING52.DGN, ..\D168H45-STAGING53.DGN, ..\D168H45-STAGING54.DGN, ..\D168H45-STAGING55.DGN, ..\D168H45-STAGING56.DGN, ..\D168H45-STAGING57.DGN, ..\D168H45-STAGING58.DGN, ..\D168H45-STAGING59.DGN, ..\D168H45-STAGING60.DGN, ..\D168H45-STAGING61.DGN, ..\D168H45-STAGING62.DGN, ..\D168H45-STAGING63.DGN, ..\D168H45-STAGING64.DGN, ..\D168H45-STAGING65.DGN, ..\D168H45-STAGING66.DGN, ..\D168H45-STAGING67.DGN, ..\D168H45-STAGING68.DGN, ..\D168H45-STAGING69.DGN, ..\D168H45-STAGING70.DGN, ..\D168H45-STAGING71.DGN, ..\D168H45-STAGING72.DGN, ..\D168H45-STAGING73.DGN, ..\D168H45-STAGING74.DGN, ..\D168H45-STAGING75.DGN, ..\D168H45-STAGING76.DGN, ..\D168H45-STAGING77.DGN, ..\D168H45-STAGING78.DGN, ..\D168H45-STAGING79.DGN, ..\D168H45-STAGING80.DGN, ..\D168H45-STAGING81.DGN, ..\D168H45-STAGING82.DGN, ..\D168H45-STAGING83.DGN, ..\D168H45-STAGING84.DGN, ..\D168H45-STAGING85.DGN, ..\D168H45-STAGING86.DGN, ..\D168H45-STAGING87.DGN, ..\D168H45-STAGING88.DGN, ..\D168H45-STAGING89.DGN, ..\D168H45-STAGING90.DGN, ..\D168H45-STAGING91.DGN, ..\D168H45-STAGING92.DGN, ..\D168H45-STAGING93.DGN, ..\D168H45-STAGING94.DGN, ..\D168H45-STAGING95.DGN, ..\D168H45-STAGING96.DGN, ..\D168H45-STAGING97.DGN, ..\D168H45-STAGING98.DGN, ..\D168H45-STAGING99.DGN, ..\D168H45-STAGING100.DGN

FILE NAME =	USER NAME = *USER*	DESIGNED - MM	REVISED -	STATE OF ILLINOIS DEPARTMENT OF TRANSPORTATION FAP ROUTE 345 / US ROUTE 20			STAGING AND TRAFFIC CONTROL PRE-STAGE U.S. ROUTE 20			F.A.P. RTE.	SECTION	COUNTY	TOTAL SHEETS	SHEET NO.
FILEL		DRAWN - KKS	REVISED -							345	8R-R	KANE	794	135
TENG	TENG & ASSOCIATES, INC. ENGINEERS/ARCHITECTS/PLANNERS CHICAGO, ILLINOIS	CHECKED - PB	REVISED -	SCALE: 1"=50'			SHEET NO.	OF	STA. 61+00.00	TO STA. 75+00.00	CONTRACT NO. 60H45			
		DATE - 12/16/11	REVISED -	FED. ROAD DIST. NO.			ILLINOIS FED. AID PROJECT							