

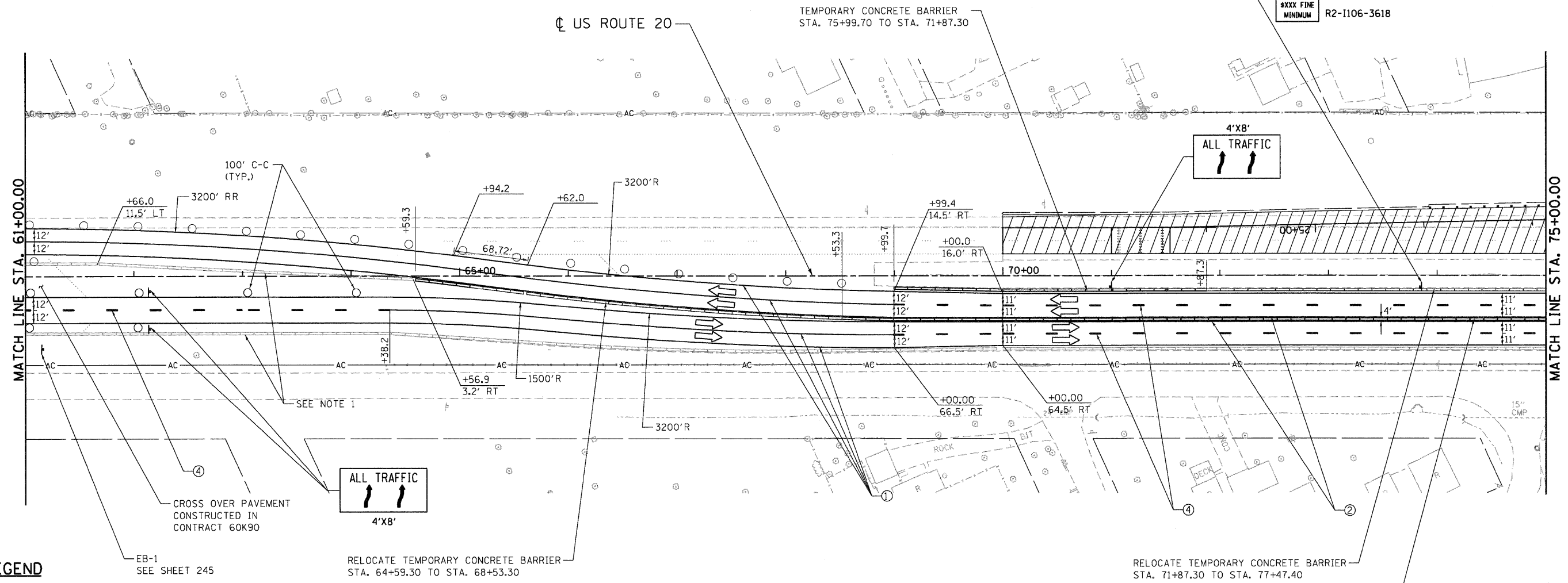

**NOTE:**

1. TEMPORARY CONCRETE BARRIER AND ASSOCIATED IMPACT ATTENUATORS PLACED IN PREVIOUS STAGES OR CONTRACT 60K90.

WORK ZONE	W2-1115(0)-3618
SPEED LIMIT	R2-1-3648
45 MPH	
8XXX FINE MINIMUM	R2-1106-3618



**LEGEND**

- WORK AREA
- IMPACT ATTENUATOR
- TEMPORARY CONCRETE BARRIER
- TYPE II BARRICADES OR DRUMS WITH STEADY BURN MONODIRECTIONAL LIGHT (AT SPECIFIED SPACING)
- DIRECTION OF TRAFFIC FLOW
- SIGN
- VERTICAL PANELS WITH STEADY BURNING LIGHTS (AT SPECIFIED SPACING)
- ARROW BOARD
- TYPE III BARRICADE
- TEMPORARY PAVEMENT, CURRENT STAGE
- TEMPORARY PAVEMENT, PREVIOUS STAGES

**PAVEMENT MARKING LEGEND-US 20 STAGING**

- ① WET REF TEM TAPE T3 4 (SOLID, WHITE)
- ② WET REF TEM TAPE T3 4 (SOLID, YELLOW)
- ③ WET REF TEM TAPE T3 4 (2' DASH - 6' SKIP, WHITE)
- ④ WET REF TEM TAPE T3 4 (10' DASH - 30' SKIP, WHITE)
- ⑤ WET REF TEM TAPE T3 6 (SOLID, WHITE)
- ⑥ WET REF TEM TAPE T3 8 (SOLID, WHITE)
- ⑦ WET REF TEM TAPE T3 8 (2' DASH - 6' SKIP, WHITE)
- ⑧ WET REF TEM TAPE T3 12 (SOLID, WHITE)
- ⑨ WET REF TEM TAPE T3 12 (SOLID, YELLOW)
- ⑩ WET REF TEM TAPE T3 24 (SOLID, WHITE)
- ⑪ WET REF TEM TAPE T3 LETTERS AND SYMBOLS

.\D160H45-BORDER.DGN, .\D160H45-LEGEND.DGN, .\DIMASTER-ROWERS.DGN, .\D160H45-STAGING.DGN, .\D160H45-TOP.DGN, .\D160H45-DRAIN.DGN, .\D160H45-LEGEND.DGN  
 12-12-2011, 12:53:59  
 .\F9-804\A\VAL\LD-TRANS-07-2282-21379-001\CIVIL\A07\60H45 SHEET\160H45-BHT-STAGING.DGN  
 BAJZKJKJ

FILE NAME = #FILEL#	USER NAME = #USER#	DESIGNED - MM	REVISED -	<b>STATE OF ILLINOIS DEPARTMENT OF TRANSPORTATION</b> FAP ROUTE 345 / US ROUTE 20		<b>STAGING AND TRAFFIC CONTROL STAGE IA U.S. ROUTE 20</b>		F.A.P. RTE. 345	SECTION 8R-R	COUNTY KANE	TOTAL SHEETS 794	SHEET NO. 140
PLOT SCALE = #SCALE#		CHECKED - PB	REVISED -					CONTRACT NO. 60H45				
PLOT DATE = #DATE#		DATE - 12/16/11	REVISED -					SCALE: 1"=50'				
								SHEET NO. OF STA. 61+00.00 TO STA. 75+00.00				
								FED. ROAD DIST. NO. [ILLINOIS] FED. AID PROJECT				