

**LEGEND**

- WORK AREA
- IMPACT ATTENUATOR
- TEMPORARY CONCRETE BARRIER
- TYPE II BARRICADES OR DRUMS WITH STEADY BURN MONODIRECTIONAL LIGHT (AT SPECIFIED SPACING)
- DIRECTION OF TRAFFIC FLOW
- SIGN
- VERTICAL PANELS WITH STEADY BURNING LIGHTS (AT SPECIFIED SPACING)
- ARROW BOARD
- TYPE III BARRICADE
- TEMPORARY PAVEMENT, CURRENT STAGE
- TEMPORARY PAVEMENT, PREVIOUS STAGES

**PAVEMENT MARKING LEGEND-US 20 STAGING**

- ① WET REF TEM TAPE T3 4 (SOLID, WHITE)
- ② WET REF TEM TAPE T3 4 (SOLID, YELLOW)
- ③ WET REF TEM TAPE T3 4 (2' DASH - 6' SKIP, WHITE)
- ④ WET REF TEM TAPE T3 4 (10' DASH - 30' SKIP, WHITE)
- ⑤ WET REF TEM TAPE T3 6 (SOLID, WHITE)
- ⑥ WET REF TEM TAPE T3 8 (SOLID, WHITE)
- ⑦ WET REF TEM TAPE T3 8 (2' DASH - 6' SKIP, WHITE)
- ⑧ WET REF TEM TAPE T3 12 (SOLID, WHITE)
- ⑨ WET REF TEM TAPE T3 12 (SOLID, YELLOW)
- ⑩ WET REF TEM TAPE T3 24 (SOLID, WHITE)
- ⑪ WET REF TEM TAPE T3 LETTERS AND SYMBOLS

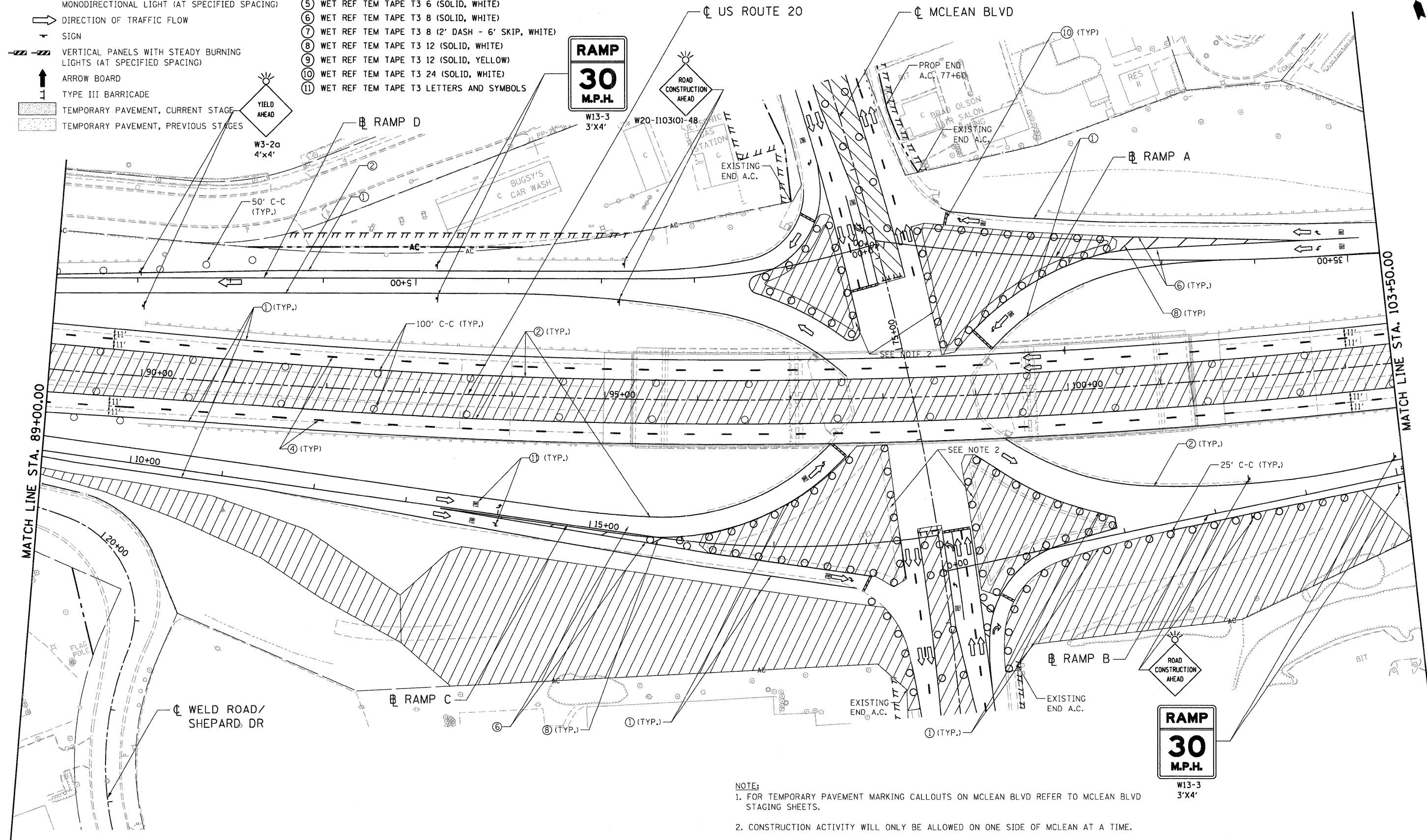

**NOTE:**  
 1. FOR TEMPORARY PAVEMENT MARKING CALLOUTS ON MCLEAN BLVD REFER TO MCLEAN BLVD STAGING SHEETS.  
 2. CONSTRUCTION ACTIVITY WILL ONLY BE ALLOWED ON ONE SIDE OF MCLEAN AT A TIME.

FILE NAME = ... \DIBH45-LEGEND.DGN, ... \DIBH45-STAGING-3.DGN, ... \DIBH45-TOPO-3.DGN, ... \DIBH45-LEGEND.DGN, ... \DIBH45-LEGEND.DGN  
 USER NAME = #USER#  
 DESIGNED - MM  
 DRAWN - KKS  
 CHECKED - PB  
 DATE - 12/16/11  
 REVISED -  
 REVISED -  
 REVISED -  
 REVISED -  
 PLOT SCALE = #SCALE#  
 PLOT DATE = #DATE#  
**TENG** TENG & ASSOCIATES, INC.  
 ENGINEERS/ARCHITECTS/PLANNERS  
 CHICAGO, ILLINOIS  
 STATE OF ILLINOIS  
 DEPARTMENT OF TRANSPORTATION  
 FAP ROUTE 345 / US ROUTE 20  
 STAGING AND TRAFFIC CONTROL  
 STAGE III  
 U.S. ROUTE 20  
 F.A.P. RTE. 345  
 SECTION 8R-R  
 COUNTY KANE  
 TOTAL SHEETS 794  
 SHEET NO. 199  
 CONTRACT NO. 60H45  
 SCALE: 1"=50'  
 SHEET NO. OF STA. 89+00.00 TO STA. 103+50.00  
 FED. ROAD DIST. NO. [ILLINOIS] FED. AID PROJECT