

THE PROPOSED TRAFFIC SIGNALS SHALL BE CONSTRUCTED AND PUT IN OPERATION PRIOR TO STARTING ANY CONSTRUCTION WORK IN STAGE III.

THE END OF THE TRACER CABLE SHALL BE CONTINUOUS AND EXTEND INTO THE CONTROLLER CABINET.

THE END OF THE TRACER CABLE SHALL BE CONTINUOUS AND EXTEND INTO THE CONTROLLER CABINET.

PROP. INTERSECTION AND SAMPLING (SYSTEM) DETECTORS

PROP. INTERSECTION AND SAMPLING (SYSTEM) DETECTORS

PROP. INTERSECTION AND SAMPLING (SYSTEM) AND QUEUING DETECTORS

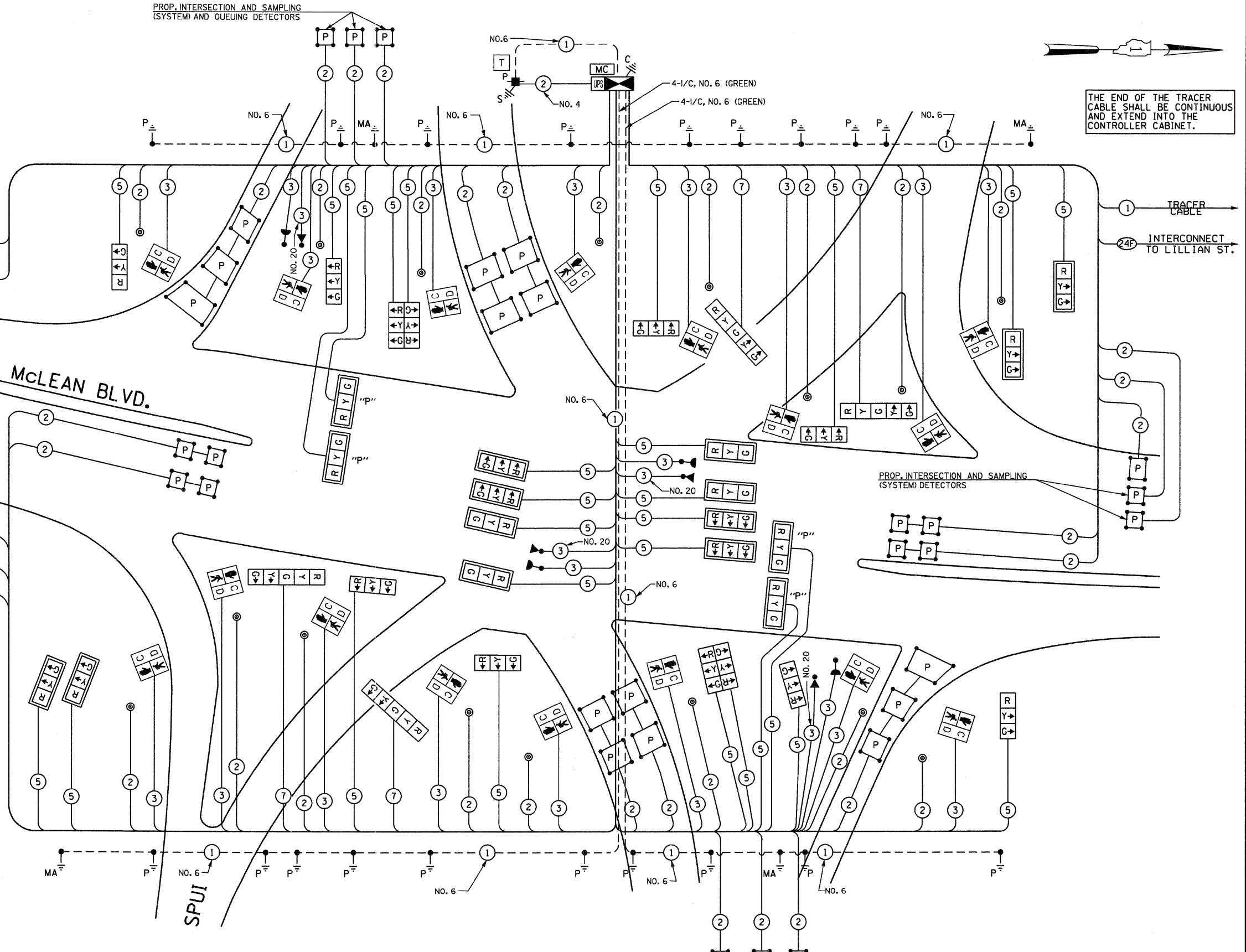

CABLE PLAN
(NOT TO SCALE)

THE TRAFFIC SIGNAL CONTROL EQUIPMENT FOR THIS PROJECT SHALL BE "EAGLE" TO MATCH THE EXISTING ADJACENT SYSTEM.

I.D.O.T. TRAFFIC SIGNAL INSTALLATION ELECTRICAL SERVICE REQUIREMENTS						TOTAL WATTAGE
TYPE	NO LAMPS	WATTAGE		OPERATION		
SIGNAL (RED)	32	135	17	0.50		272
(YELLOW)	32	135	25	0.25		200
(GREEN)	32	135	15	0.25		120
ARROW	8	135	12	0.10		9.6
PED. SIGNAL	16	90	25	1.00		400
CONTROLLER	1	100	100	1.00		100
ILLUM. SIGN				0.05		
FLASHER				0.50		
ENERGY COSTS TO:					TOTAL =	1101.6

CITY OF ELGIN
 150 DEXTER COURT
 ELGIN, ILLINOIS 60120-5570
 ENERGY SUPPLY CONTACT: ELLIE SARALLO
 PHONE: (630) 424 5124
 COMPANY: COMMONWEALTH EDISON

FILE NAME =	USER NAME = #USER#	DESIGNED - PKG	REVISED -
#FILE#		DRAWN - MAA, EA	REVISED -
	PLOT SCALE = #SCALE#	CHECKED - PKG	REVISED -
	PLOT DATE = #DATE#	DATE - 02/10/2012	REVISED -

STATE OF ILLINOIS
DEPARTMENT OF TRANSPORTATION

CABLE PLAN			
McLEAN BOULEVARD AT U.S. RTE. 20 SPU			
SCALE: N.T.S.	SHEET NO.	OF SHEETS	STA. TO STA.

F.A.P. RTE. 345	SECTION 8R-R	COUNTY KANE	TOTAL SHEETS 794	SHEET NO. 419
CONTRACT NO. 60H45				FED. ROAD DIST. NO. - [ILLINOIS] FED. AID PROJECT