

**LEGEND (CITY OF ELGIN)**

- EXISTING LIGHTING UNIT TO REMAIN IN PLACE
- EXISTING LIGHTING UNIT TO BE REMOVED AND RELOCATED (ORIGINAL LOCATION)
- RELOCATED EXISTING LIGHTING UNIT (PROPOSED LOCATION)
- UNDERGROUND CONDUITS SIZE AS NOTED
- PROPOSED UNIT DUCT, 4-1/C\*4, 1/C\*4 GND, 1 1/2" DIA. UNIT DUCT
- EXISTING LIGHTING CONTROLLER
- ELECTRIC GROUND ROD
- POLE NUMBER
- LUMINAIRE CIRCUIT IDENTIFIER
- P3-CKT B STA. 86+45 43.5' RT SET BACK 8.6 FT
- SET BACK FROM PROPOSED BACK OF CURB

**NOTES:**

1. THE EXISTING LIGHT POLE, MAST ARM, AND LUMINAIRE SHALL BE REMOVED FROM THE EXISTING FOUNDATION AND REINSTALLED ON THE NEW FOUNDATION AT THE PROPOSED LOCATION SHOWN ON THE PLANS. IT IS THE CONTRACTOR'S RESPONSIBILITY TO VERIFY AND MATCH THE EXISTING FOUNDATION BEFORE CONSTRUCTING A NEW FOUNDATION AT THE PROPOSED LOCATION.
2. ALL EXISTING LIGHTING UNITS MARKED WITH "RR" SHALL BE REMOVED AND PROPERLY STORED TO BE REINSTALLED ON THE NEW FOUNDATION MARKED WITH "RL". THE COST OF TRANSPORTING AND STORING THE LIGHTING UNIT SHALL BE INCLUDED IN THE CONTRACT UNIT PRICE FOR "RELOCATE EXISTING LIGHTING UNIT". ANY DAMAGE SUSTAINED TO THE LIGHTING UNIT DURING REMOVAL, TRANSPORT, STORAGE, OR INSTALLATION OPERATIONS SHALL BE REPAIRED OR REPLACED IN KIND.
3. RESTORATION OF WORK AREA - RESTORATION OF LIGHTING WORK AREA SHALL BE INCIDENTAL TO THE RELATED PAY ITEM SUCH AS FOUNDATION, CONDUITS, HANDHOLE, ETC. AND NO EXTRA COMPENSATION SHALL BE ALLOWED. ALL ROADWAY SURFACES SUCH AS SHOULDERS, MEDIANS, SIDEWALKS, PAVEMENT, ETC. SHALL BE REPLACED IN KIND. ALL DAMAGE TO MOWED LAWNS SHALL BE REPLACED WITH AN APPROVED SOD AND ALL DAMAGE TO UNMOWED FIELD, SHALL BE SODDED OR SEEDED IN ACCORDANCE WITH STANDARD SPECIFICATIONS 252 AND 250 RESPECTIVELY.

| CIRCUIT ID | 250W LUMINAIRES   |                           | 400W LUMINAIRES   |                           | TOTAL CIRCUIT LOAD (WATT) |
|------------|-------------------|---------------------------|-------------------|---------------------------|---------------------------|
|            | NO. OF LUMINAIRES | LOAD PER LUMINAIRE (WATT) | NO. OF LUMINAIRES | LOAD PER LUMINAIRE (WATT) |                           |
| A          | 9                 | 288                       | -                 | 456                       | 2592                      |
| B          | 8                 | 288                       | -                 | 456                       | 2304                      |
| C          | 6                 | 288                       | 2                 | 456                       | 2640                      |
| D          | 7                 | 288                       | 2                 | 456                       | 2928                      |
| TOTAL      | 30                | -                         | 4                 | -                         | 10464                     |

**EXISTING CITY OF ELGIN LIGHTING CONTROLLER LOAD AFTER RELOCATED POLES ARE INSTALLED**

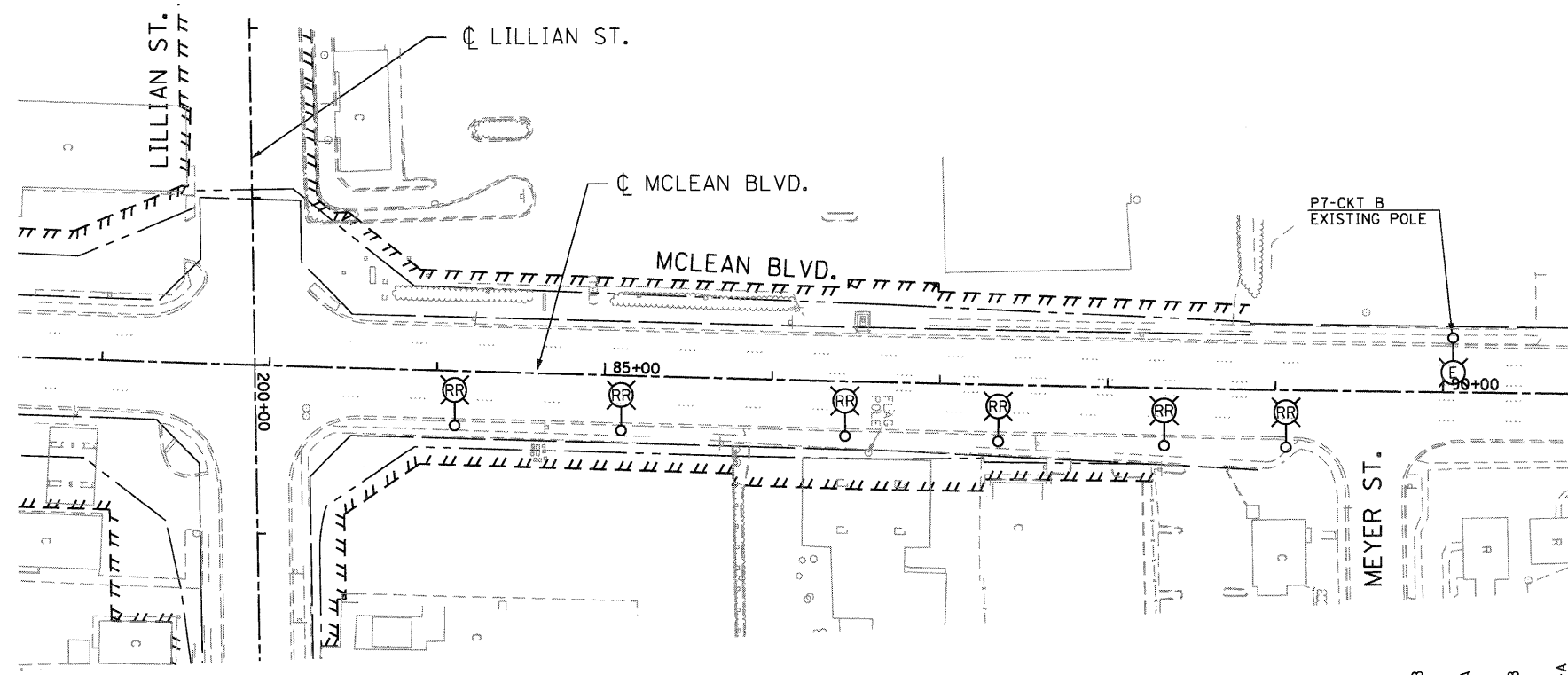

**EXISTING LIGHT POLES TO BE REMOVED AND RELOCATED (ORIGINAL LOCATIONS)**

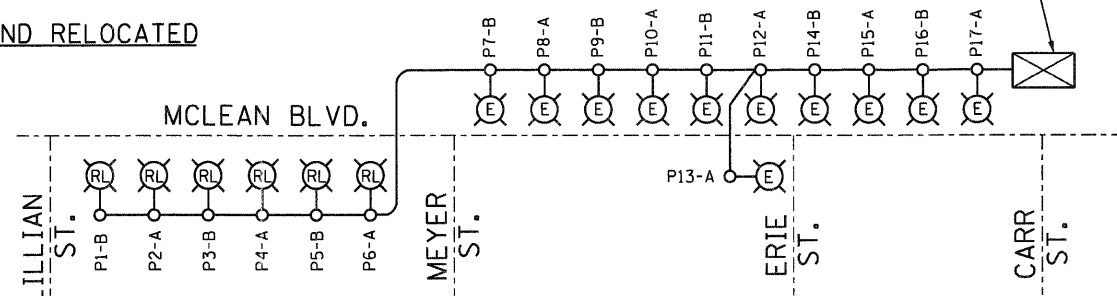

**SINGLE LINE DIAGRAM (CIRCUIT A & B ONLY) FOR MCLEAN BLVD. NOT TO SCALE**

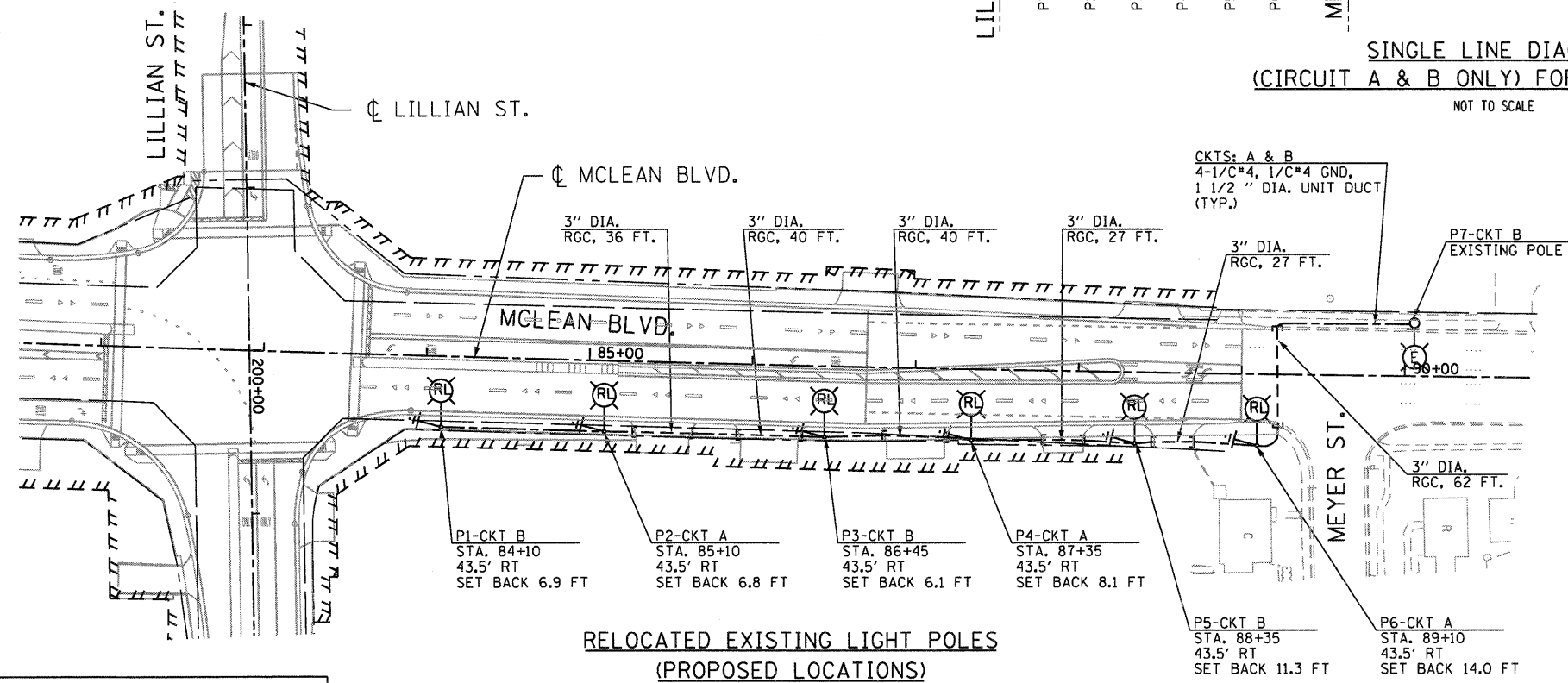

**RELOCATED EXISTING LIGHT POLES (PROPOSED LOCATIONS)**

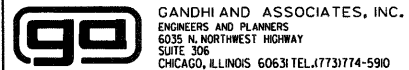

FILE NAME =  
#FILE#

USER NAME = .GAI.

PLOT SCALE = 1"=50'

PLOT DATE = 12/8/2011

DESIGNED - PKG  
DRAWN - MAA, SHM  
CHECKED - PKG  
DATE - 12/16/11

REVISED -  
REVISED -  
REVISED -  
REVISED -

**STATE OF ILLINOIS  
DEPARTMENT OF TRANSPORTATION**

**CITY OF ELGIN LIGHTING PLAN**

SCALE: 1"= 50' SHEET NO. OF SHEETS STA. TO STA.

| F.A.P. RTE.   | SECTION | COUNTY | TOTAL SHEETS | SHEET NO. |
|---|---------|--------|--------------|-----------|
| 345   | 8R-R    | KANE   | 794          | 450       |
| CONTRACT NO. 60H45                                  |         |        |              |           |
| FED. ROAD DIST. NO. 1   ILLINOIS   FED. AID PROJECT |         |        |              |           |