

**WB NORTH EDGE OF SHOULDER**

LOCATION	STATION	OFFSET	THEORETICAL GRADE ELEVATIONS
B1	101+36.21	-49.00	851.34
B2	101+46.28	-49.00	851.16
B3	101+56.36	-49.00	850.98
B4	101+66.44	-49.00	850.79

**STAGE CONSTRUCTION LINE**

LOCATION	STATION	OFFSET	THEORETICAL GRADE ELEVATIONS
B1	101+36.17	6.44	852.10
B2	101+46.16	6.44	851.93
B3	101+56.15	6.44	851.75
B4	101+66.14	6.44	851.57

**WB NORTH EDGE OF PAVEMENT**

LOCATION	STATION	OFFSET	THEORETICAL GRADE ELEVATIONS
B1	101+36.20	-37.00	851.65
B2	101+46.26	-37.00	851.47
B3	101+56.32	-37.00	851.29
B4	101+66.37	-37.00	851.11

**EB PGL / NORTH EDGE OF PAVEMENT**

LOCATION	STATION	OFFSET	THEORETICAL GRADE ELEVATIONS
B1	101+36.17	13.00	852.27
B2	101+46.15	13.00	852.10
B3	101+56.13	13.00	851.92
B4	101+66.11	13.00	851.74

**WB PGL / SOUTH EDGE OF PAVEMENT**

LOCATION	STATION	OFFSET	THEORETICAL GRADE ELEVATIONS
B1	101+36.19	-13.00	852.27
B2	101+46.21	-13.00	852.10
B3	101+56.23	-13.00	851.92
B4	101+66.25	-13.00	851.73

**EB SOUTH EDGE OF PAVEMENT**

LOCATION	STATION	OFFSET	THEORETICAL GRADE ELEVATIONS
B1	101+36.15	37.00	852.90
B2	101+46.10	37.00	852.73
B3	101+56.04	37.00	852.55
B4	101+65.98	37.00	852.36

**WB SOUTH EDGE OF SHOULDER**

LOCATION	STATION	OFFSET	THEORETICAL GRADE ELEVATIONS
B1	101+36.18	-1.33	851.97
B2	101+46.18	-1.33	851.80
B3	101+56.18	-1.33	851.62
B4	101+66.18	-1.33	851.43

**EB SOUTH EDGE OF SHOULDER**

LOCATION	STATION	OFFSET	THEORETICAL GRADE ELEVATIONS
B1	101+36.15	49.00	853.21
B2	101+46.07	49.00	853.04
B3	101+56.00	49.00	852.86
B4	101+65.92	49.00	852.68

**EB NORTH EDGE OF SHOULDER**

LOCATION	STATION	OFFSET	THEORETICAL GRADE ELEVATIONS
B1	101+36.18	1.33	851.97
B2	101+46.17	1.33	851.80
B3	101+56.17	1.33	851.62
B4	101+66.17	1.33	851.43

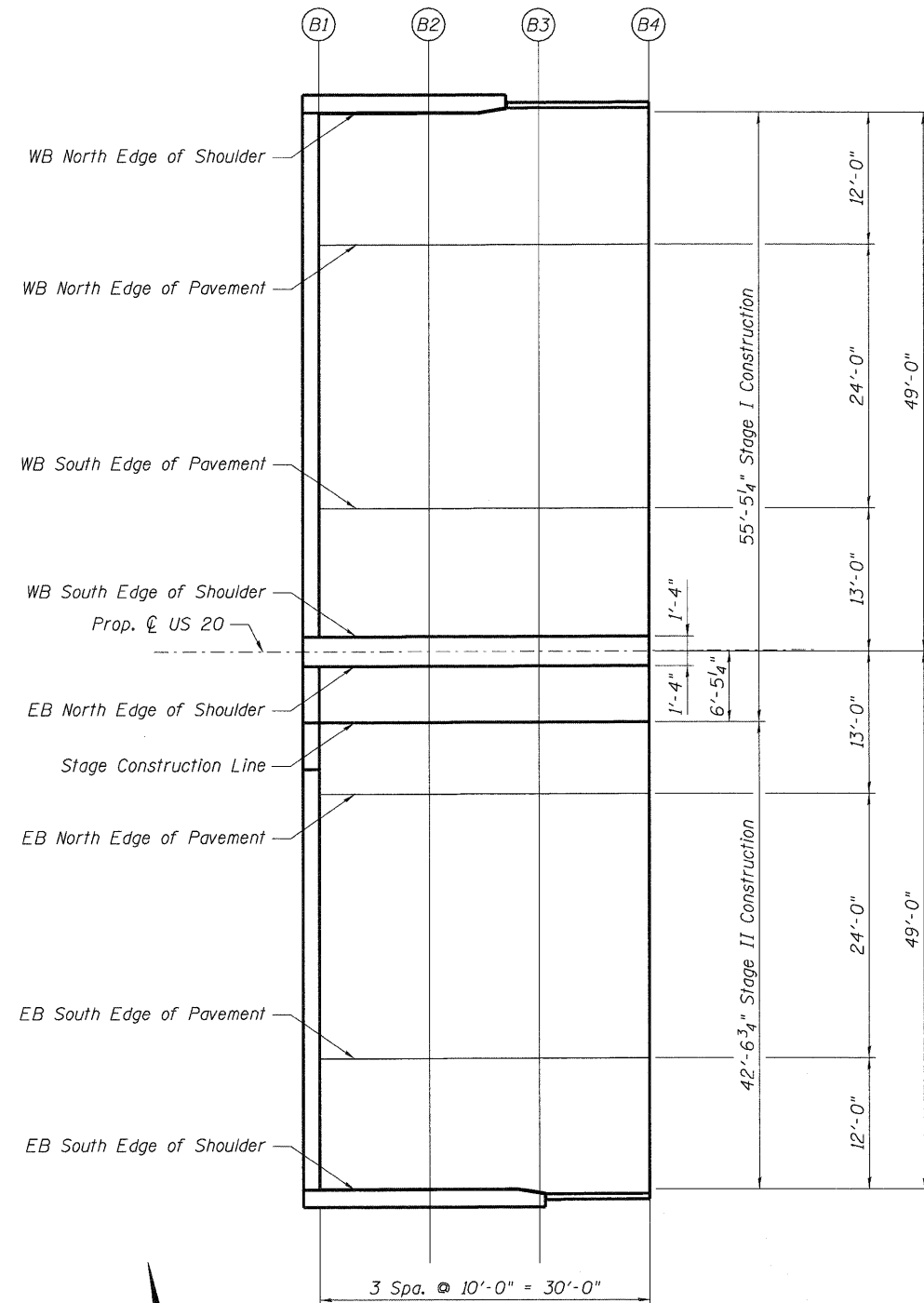

**EAST APPROACH PLAN**

\P\60877-60H45-002-TOSELEV.DGN, \D\MASTER-ALIGNMENT.DGN, \L\LS\JM-60H45-001-BORDER.DGN, \S\FILEL\$  
 \P\60877-60H45-002-TOSELEV.DGN, \D\MASTER-ALIGNMENT.DGN, \L\LS\JM-60H45-001-BORDER.DGN, \S\FILEL\$  
 \P\60877-60H45-002-TOSELEV.DGN, \D\MASTER-ALIGNMENT.DGN, \L\LS\JM-60H45-001-BORDER.DGN, \S\FILEL\$  
 \P\60877-60H45-002-TOSELEV.DGN, \D\MASTER-ALIGNMENT.DGN, \L\LS\JM-60H45-001-BORDER.DGN, \S\FILEL\$