

290 280 270 260 250 240 230 220 210 200 190 180 170 160 150 140 130 120 110 100 90 80 70 60 50 40 30 20 10 0 10

|              |               |      |
|--------------|---------------|------|
| FINAL SURVEY | SURVEYED      | DATE |
| NOTE BOOK    | PLOTTED       |      |
| NO.          | TEMPLATE      |      |
|              | AREAS CHECKED |      |

|                 |               |      |
|-----------------|---------------|------|
| ORIGINAL SURVEY | SURVEYED      | DATE |
| NOTE BOOK       | PLOTTED       |      |
| NO.             | TEMPLATE      |      |
|                 | AREAS CHECKED |      |

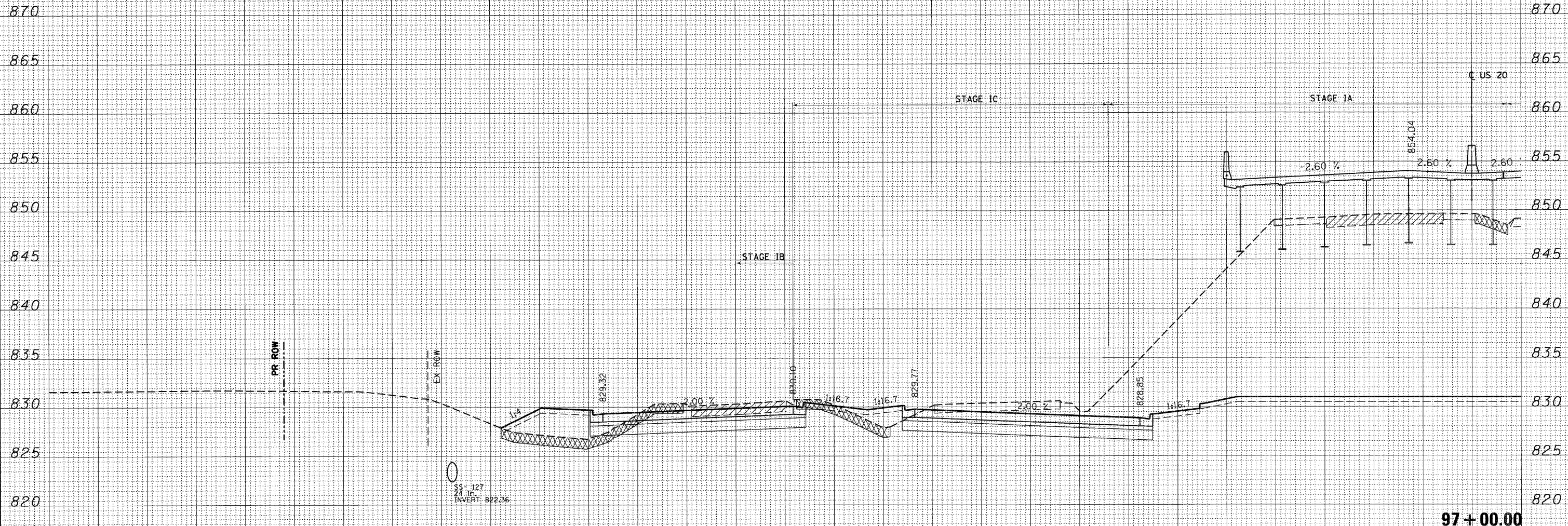

97+00.00

| END AREAS (SQ. FT)              | STAGE IA | STAGE IB | STAGE IC | STAGE IIA | STAGE IIB | STAGE III | STAGE IV |
|---------------------------------|----------|----------|----------|-----------|-----------|-----------|----------|
| EARTH EXCAVATION =              | 1234.79  | 57.94    | 112.62   | 1667.24   | 77.40     | 268.62    | 0.00     |
| EMBANKMENT =                    | 0.00     | 53.98    | 20.76    | 0.00      | 65.30     | 0.00      | 0.00     |
| UNS MATL (TOPSOIL EXCAVATION) = | 6.54     | 37.12    | 18.99    | 0.22      | 84.66     | 0.00      | 0.00     |
| PGE SUBGRADE =                  | 0.00     | 0.00     | 0.00     | 0.00      | 0.00      | 0.00      | 0.00     |

**LEGEND:**

- UNSUITABLE MATERIAL
- EXISTING PAVEMENT REMOVAL
- PGE SUBGRADE

290 280 270 260 250 240 230 220 210 200 190 180 170 160 150 140 130 120 110 100 90 80 70 60 50 40 30 20 10 0 10

|                      |                    |
|----------------------|--------------------|
| FILE NAME =          | USER NAME = #USER# |
| #FILE#               |                    |
| PLOT SCALE = #SCALE# | CHECKED - DDH      |
| PLOT DATE = #DATE#   | DATE - 12/16/11    |

|                 |           |
|-----------------|-----------|
| DESIGNED - MRK  | REVISED - |
| DRAWN - MRK     | REVISED - |
| CHECKED - DDH   | REVISED - |
| DATE - 12/16/11 | REVISED - |

|                 |           |
|-----------------|-----------|
| DESIGNED - MRK  | REVISED - |
| DRAWN - MRK     | REVISED - |
| CHECKED - DDH   | REVISED - |
| DATE - 12/16/11 | REVISED - |

**STATE OF ILLINOIS  
DEPARTMENT OF TRANSPORTATION**

**U.S. ROUTE 20 CROSS SECTIONS**

SCALE: HORIZ. 1"=10'      VERT. 1"=5'      STA. 97+00.00 TO STA. 97+00.00

|                    |                 |                |                           |                  |
|--------------------|-----------------|----------------|---------------------------|------------------|
| F.A. RTE.<br>345   | SECTION<br>BR-R | COUNTY<br>KANE | TOTAL SHEETS<br>794       | SHEET NO.<br>672 |
| CONTRACT NO. 60H45 |                 |                | ILLINOIS FED. AID PROJECT |                  |