

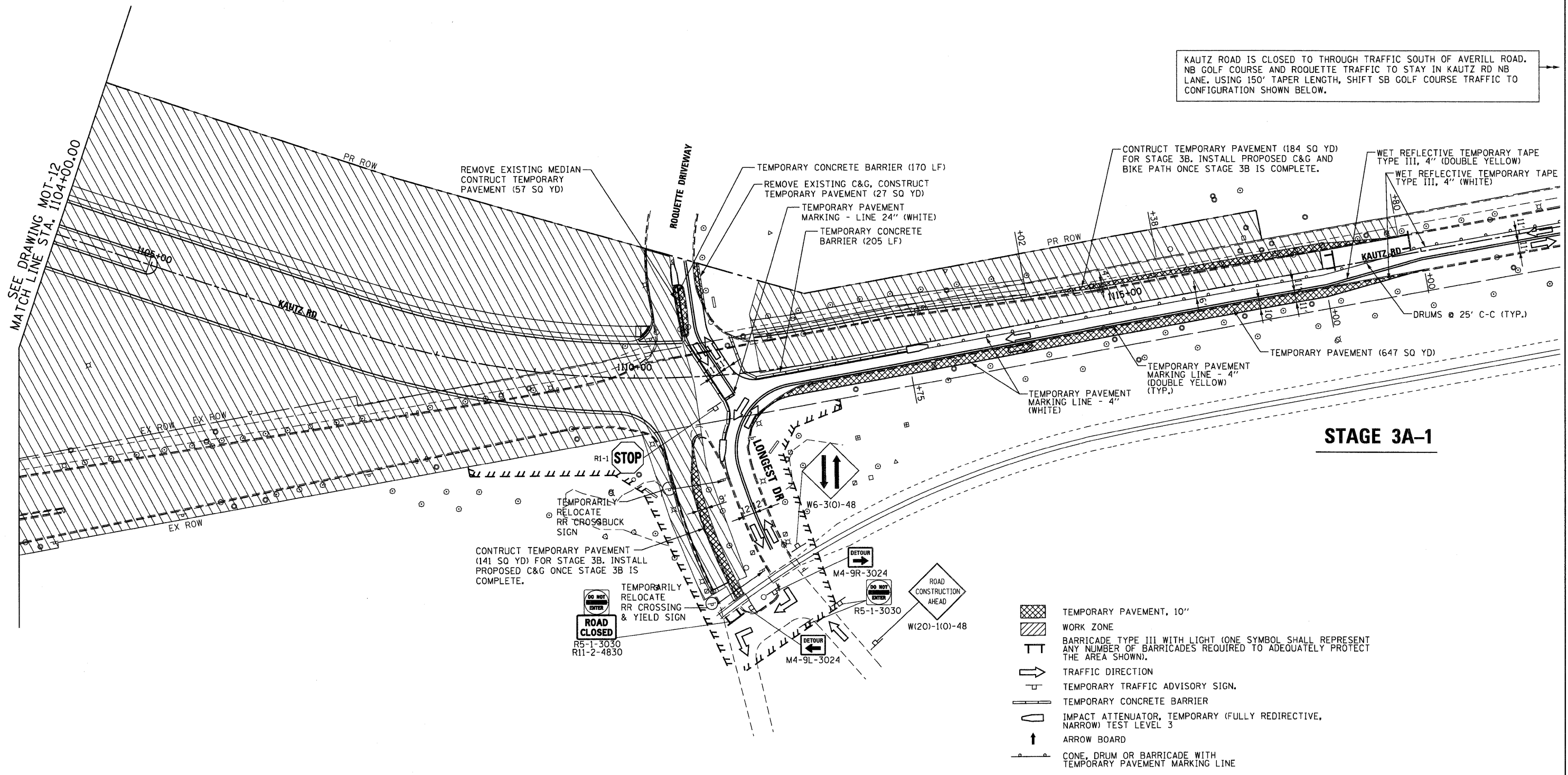

KAUTZ ROAD IS CLOSED TO THROUGH TRAFFIC SOUTH OF AVERILL ROAD. NB GOLF COURSE AND ROUQUETTE TRAFFIC TO STAY IN KAUTZ RD NB LANE. USING 150' TAPER LENGTH, SHIFT SB GOLF COURSE TRAFFIC TO CONFIGURATION SHOWN BELOW.



STAGE 3A-1

- TEMPORARY PAVEMENT, 10"
- WORK ZONE
- BARRICADE TYPE III WITH LIGHT (ONE SYMBOL SHALL REPRESENT ANY NUMBER OF BARRICADES REQUIRED TO ADEQUATELY PROTECT THE AREA SHOWN).
- TRAFFIC DIRECTION
- TEMPORARY TRAFFIC ADVISORY SIGN.
- TEMPORARY CONCRETE BARRIER
- IMPACT ATTENUATOR, TEMPORARY (FULLY REDIRECTIVE, NARROW) TEST LEVEL 3
- ARROW BOARD
- CONE, DRUM OR BARRICADE WITH TEMPORARY PAVEMENT MARKING LINE

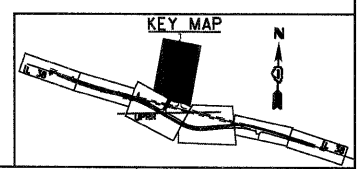

McDonough Associates Inc.
 Engineers / Architects
 130 East Randolph Street Chicago, Illinois 60601

FILE NAME = D168122-SHT-STAGINC15.dgn	USER NAME = YKlm	DESIGNED - KBN	REVISED -
		DRAWN - KBN	REVISED -
		CHECKED - EJC	REVISED -
		DATE - 10/14/11	REVISED -

STATE OF ILLINOIS
DEPARTMENT OF TRANSPORTATION

MAINTENANCE OF TRAFFIC
STAGE 3

SCALE: 1"=50' SHEET NO. 15 OF 17 SHEETS STA. 1104+00 TO STA. END

F.A.P. RTE.	SECTION	COUNTY	TOTAL SHEETS	SHEET NO.
347	LY (HB & VB)	DUPAGE/KANE	421	56
MOT-15		CONTRACT NO. 60122		
FED. ROAD DIST. NO. 1 ILLINOIS FED. AID PROJECT				