

NOTES:

1. "SEDIMENT TRAP" SHALL BE SIZED FOR 1/2 ACRE STORAGE. SEE DETAIL SHEET ED-1 FOR DETAILS.
2. PERIMETER EROSION BARRIER HAS BEEN OFFSET FOR CLARITY.

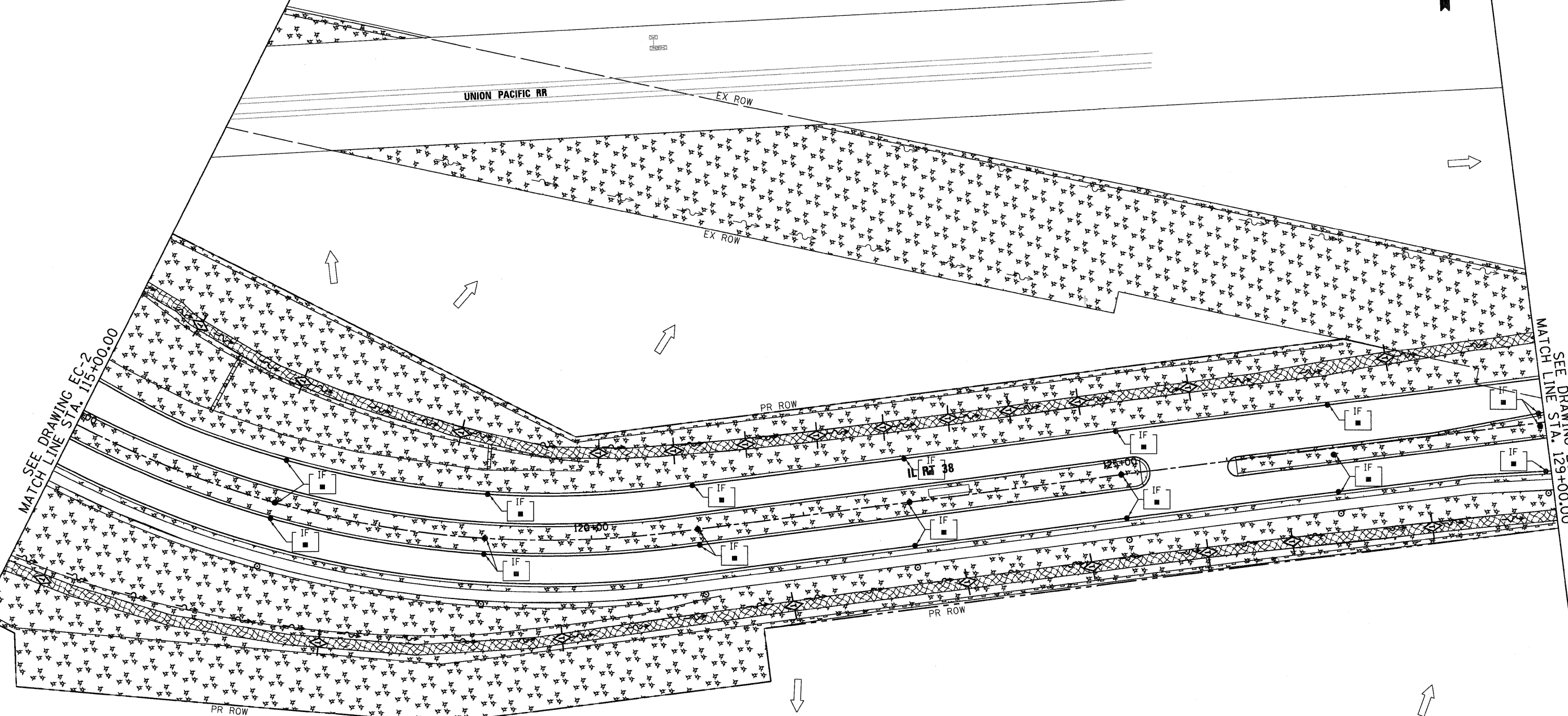

EROSION CONTROL LEGEND

- INLET AND PIPE PROTECTION
- TEMPORARY DITCH CHECK
- PERIMETER EROSION BARRIER
- TEMPORARY EROSION CONTROL SEEDING AND MULCH METHOD 2
- TEMPORARY EROSION CONTROL SEEDING AND EROSION CONTROL BLANKET
- INLET FILTER
- EROSION CONTROL TEMPORARY PIPE SLOPE DRAIN
- SEDIMENT TRAP
- DITCH FLOW
- SWALE
- DRAINAGE SUMMIT

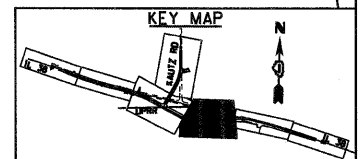

**McDonough Associates Inc.**  
 Engineers/Architects  
 130 East Randolph Street Chicago, Illinois 60601

FILE NAME = D:\60122-SHT-ER0513.dgn	USER NAME = YKjm	DESIGNED - JCL	REVISED -
		DRAWN - JCL	REVISED -
		CHECKED - EUG	REVISED -
		DATE - 10/14/11	REVISED -

**STATE OF ILLINOIS**  
**DEPARTMENT OF TRANSPORTATION**

<b>EROSION AND SEDIMENT CONTROL PLAN</b>			
SCALE: 1"=50'	SHEET NO. 3 OF 5 SHEETS	STA. 115+00 TO STA. 129+00	

F.A.P. RTE. 347	SECTION LY (HB & VB)	COUNTY DUPAGE/KANE	TOTAL SHEETS 421	SHEET NO. 63
<b>EC-3</b> CONTRACT NO. 60122 <small>FED. ROAD DIST. NO. 1 [ILLINOIS] FED. AID PROJECT</small>				