

GENERAL NOTES

1. ALL WETLANDS LOCATED WITHIN AND IMMEDIATELY ADJACENT TO THE CONSTRUCTION LIMITS SHALL HAVE THEIR BOUNDARIES CLEARLY DEMARCATED IN THE FIELD BY CONSTRUCTION FENCING. ADDITIONALLY, ALL WETLANDS SHOULD BE DEMARCATED BY "WETLAND, NO INTRUSION" SIGNAGE. CONTACT RICK WANNER (847-705-4172) FOR SIGNAGE. THE SIGNS SHALL BE RETURNED AT THE END OF THE JOB UNDAMAGED. CONSTRUCTION FENCING AND SIGNAGE SHALL BE INSTALLED AND MAINTAINED DURING CONSTRUCTION AND RUNOFF WILL BE DIVERTED OR FILTERED PRIOR TO DISCHARGE.
2. INLET AND PIPE PROTECTION SHALL BE COMPRISED OF DITCH CHECKS, TEMPORARY SEEDING AND TEMPORARY EROSION CONTROL BLANKET. STRAW BALES AND SILT FENCE SHALL NOT BE USED AS INLET AND PIPE PROTECTION.
3. CULVERT/ STORM SEWER CLEANING PLAN: THE CONTRACTOR SHALL SUBMIT TO THE RE A PLAN TO CLEAN CULVERTS AND STORM SEWERS WITHOUT DISCHARGING SEDIEMENT FROM THE SITE. THE RE SHALL ACCEPT THE PLAN IN WRITING. THE PLAN BECOMES PART OF THE EROSION AND SEDIMENT CONTROL/ SWPPP FOR THIS PROJECT, AND IS SUBJECT TO THE NPDES DEFICIENCY DEDUCTION.
4. PORTABLE TOILETS SHALL BE PLACED AWAY FROM INLETS AND WATER COURSES.
5. SILT FENCE IS NOT REQUIRED WHERE THE PERIEMETER IS HIGHER THAN THE WORK ZONE, AND SILT FENCE SHALL NOT BE INSTALLED ACROSS CONCENTRATED FLOW, OR ACROSS CONTOURS WITHOUT J-HOOKS (HIGHWAY STANDARD SHEET 280001). IN AREAS ON CONCENTRATED FLOW, TEMPORARY DITCH CHECKS AE A SUITABLE ALTERNATIVE PERIEMETER EROSION BARRIER IN PLACE OF THE SILT FENCE.

LEGEND

- STORM DRAIN PROTECTION CONSISTING OF DITCH CHECKS, TEMPORARY SEEDING, AND EROSION CONTROL BLANKETS
- PERIEMETER EROSION BARRIER
- TEMPORARY EROSION CONTROL SEEDING
- TEMPORARY DITCH CHECK
- "NO INTRUSION" SIGN
- TEMPORARY MULCH METHOD 4, 2"

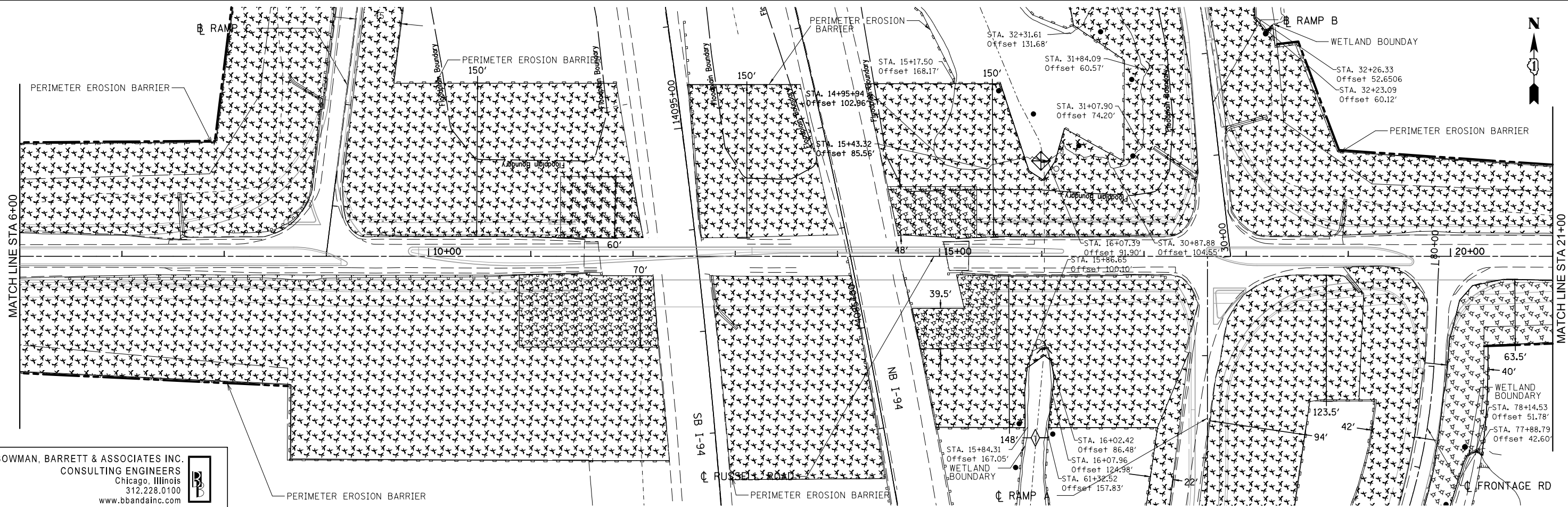
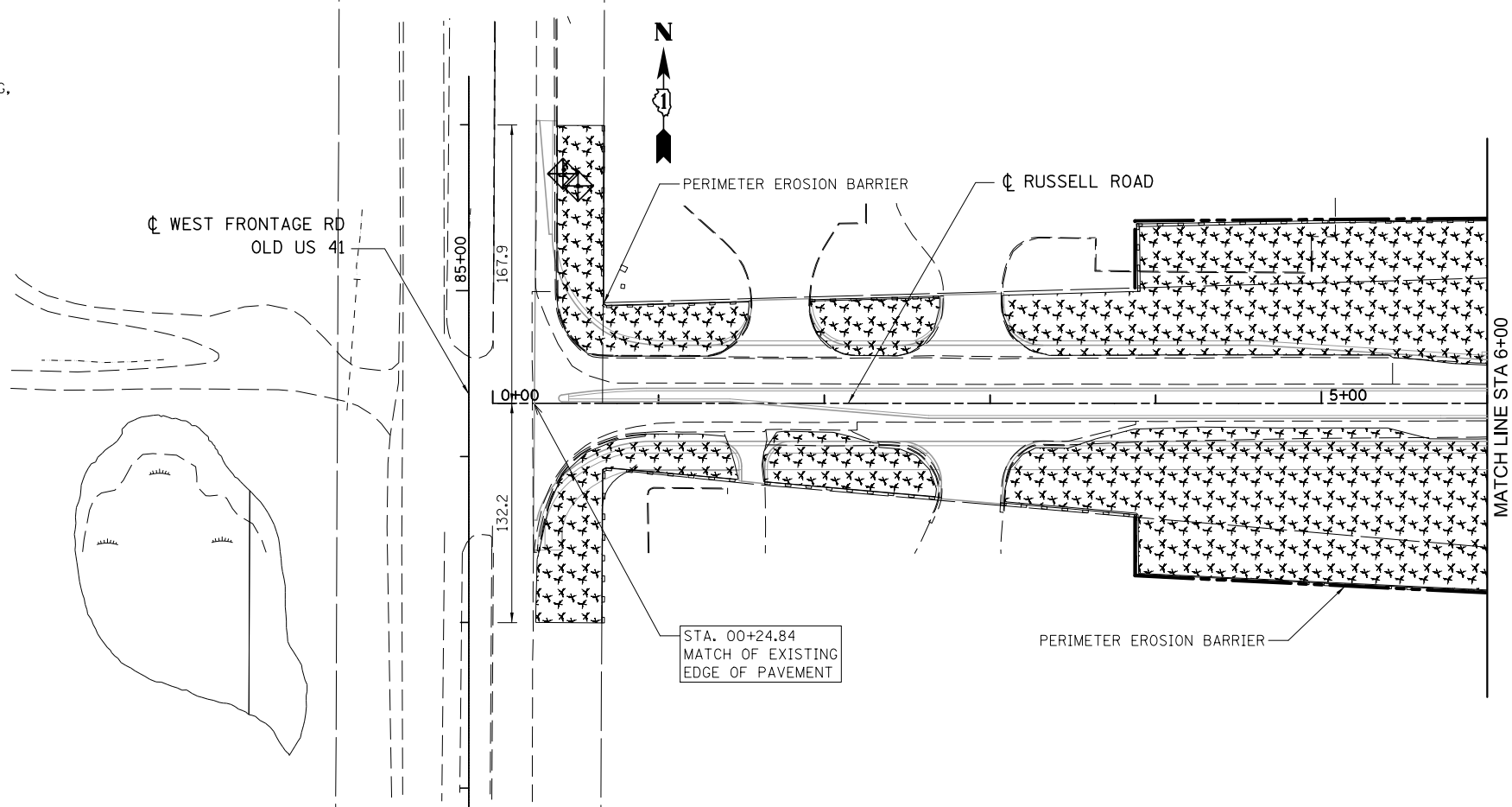

BOWMAN, BARRETT & ASSOCIATES INC.
CONSULTING ENGINEERS
Chicago, Illinois
312.228.0100
www.bbandainc.com

FILE NAME = #FILES#	USER NAME = default	DESIGNED - PTG	REVISED -
		DRAWN - PTG	REVISED -
PLOT SCALE = #SCALE#		CHECKED - RGR	REVISED -
PLOT DATE = 2/10/2012		DATE - 01/25/2012	REVISED -

STATE OF ILLINOIS
DEPARTMENT OF TRANSPORTATION

EROSION CONTROL PLAN FOR RUSSELL ROAD

SCALE: 1"=50' SHEET NO. 1 OF 4 SHEETS STA. 0+00.00 TO STA. 21+00.00

F.A. RTE.	SECTION	COUNTY	TOTAL SHEETS	SHEET NO.
94	49-1(HB & HB-1R)	LAKE	225	44
CONTRACT NO. 60L76				
ILLINOIS FED. AID PROJECT				

S:\1101\95\CADD\60L76_Russell1.dwg 1/25/12 Sheets\0160L76-sht-arcad.dgn