

3/7/2012 4:28:05 PM

S:\101\05_CADD\60L76_RussellRdwy\60L76_Sheets\0490533-60L76-011-SP.dgn

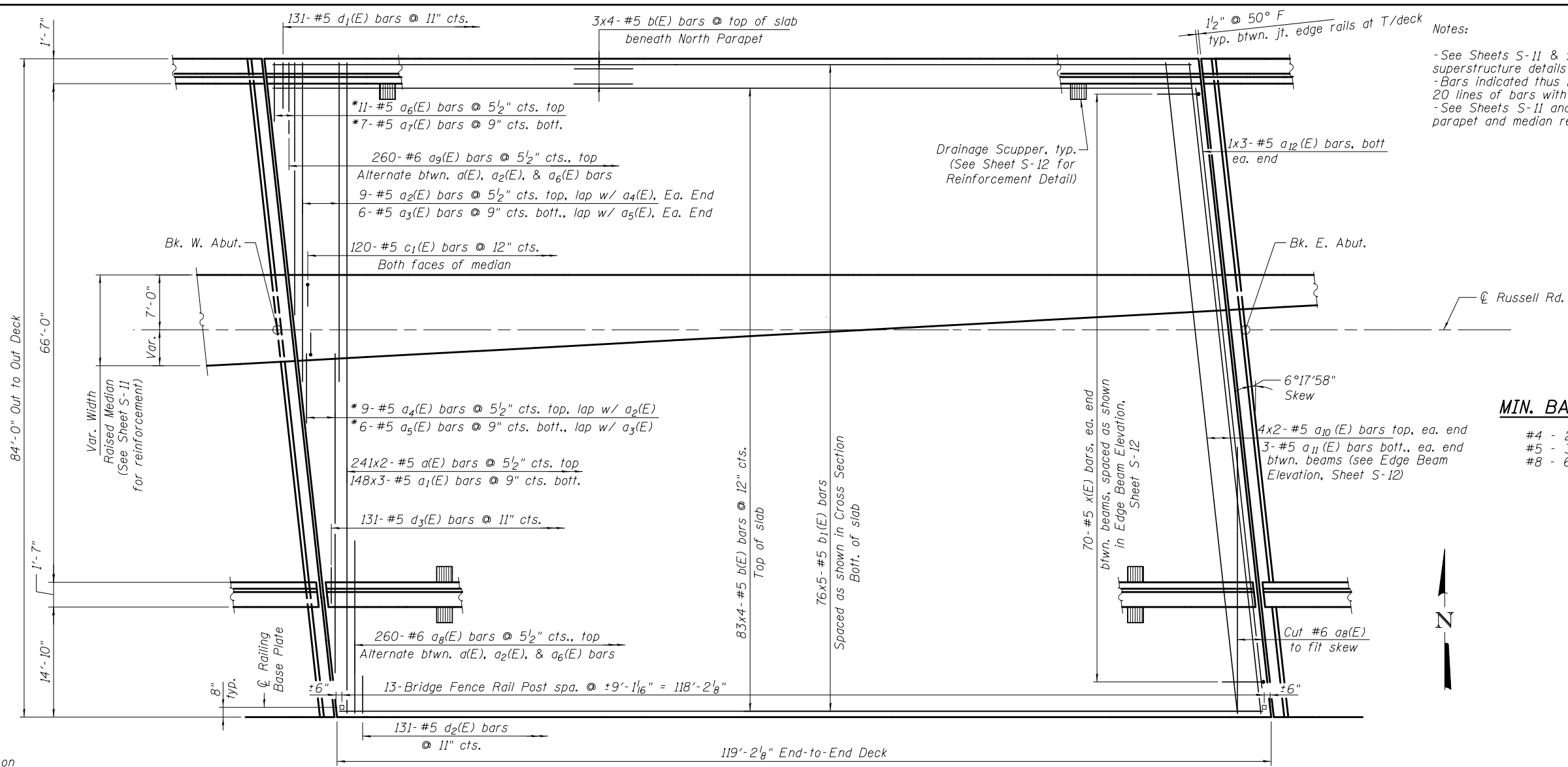

Notes:
 - See Sheets S-11 & S-12 of S-33 for superstructure details and Bill of Material.
 - Bars indicated thus 20x3-#5 etc. indicates 20 lines of bars with 3 lengths per line.
 - See Sheets S-11 and S-12 of S-33 for parapet and median reinforcement.

MIN. BAR LAP

- #4 - 2'-7"
- #5 - 3'-3"
- #8 - 6'-9"



* Cut bars according to diagrams on Sheet S-12 and use remainder at other end of deck.

DECK PLAN

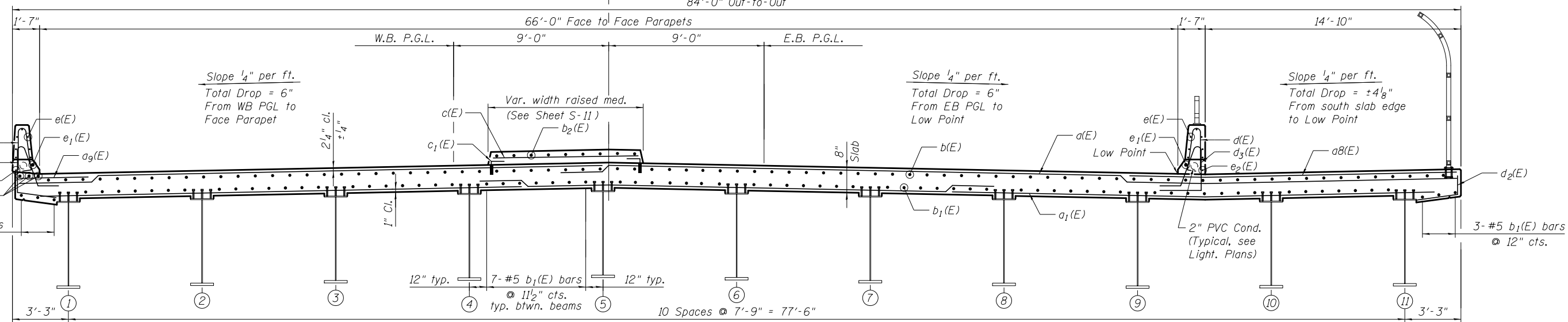

CROSS SECTION
(Looking East)

BOWMAN, BARRETT & ASSOCIATES INC.
 CONSULTING ENGINEERS
 Chicago, Illinois
 312.228.0100
 www.bbandainc.com

| | | | |
|----------------------|-------------|----------------|-----------|
| FILE NAME = | USER NAME = | DESIGNED - MRM | REVISED - |
| | | CHECKED - TL | REVISED - |
| | | DRAWN - LAM | REVISED - |
| | | CHECKED - SF | REVISED - |
| PLOT SCALE = N.T.S. | | | |
| PLOT DATE = 3/7/2012 | | | |

STATE OF ILLINOIS
 DEPARTMENT OF TRANSPORTATION

SUPERSTRUCTURE PLAN & CROSS SECTION
STRUCTURE NO. 049-0533

SHEET NO. S-10 OF S-33 SHEETS

| F.A.U. RTE. | SECTION | COUNTY | TOTAL SHEETS | SHEET NO. |
|--------------------|------------------|--------|--------------|-----------|
| 1199 | 49-1(HB & HB-1R) | LAKE | 225 | 124 |
| CONTRACT NO. 60L76 | | | | |

ILLINOIS FED. AID PROJECT