

STATE OF ILLINOIS
DEPARTMENT OF TRANSPORTATION
DIVISION OF HIGHWAYS

**PROPOSED
HIGHWAY PLANS**

F.A.P. 870 / IL ROUTE 53 (LINCOLN AVE.) OVER ST JOSEPH'S CREEK
BRIDGE REPLACEMENT
SECTION 534R-B
PROJECT NO. ACBRF-0870(014)
DuPAGE COUNTY
C-91-170-11

F.A.P. RTE.	SECTION	COUNTY	TOTAL SHEETS	SHEET NO.
870	534R-B	DuPAGE	51	1
FED ROAD DIST NO. 1 ILLINOIS			CONTRACT NO. 60M83	

D-91-170-11

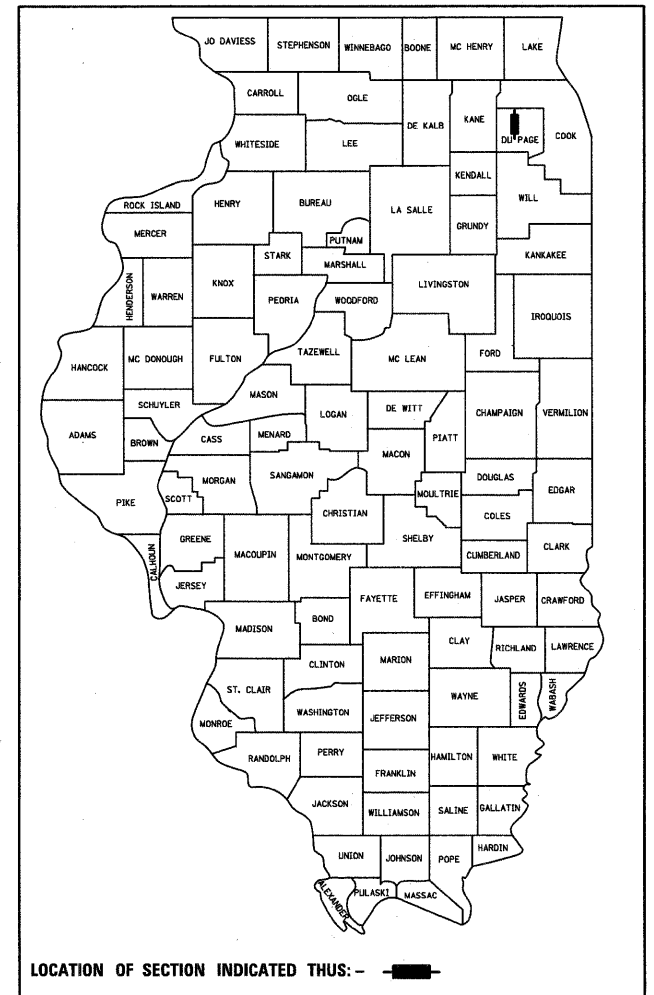

FOR INDEX OF SHEETS, SEE SHEET NO. 2

TRAFFIC DATA:

EXISTING ADT IL ROUTE 53 = 25,500 (2002)
PROPOSED ADT IL ROUTE 53: 35,505 (2021)
POSTED SPEED = 35 MPH

PROJECT IS LOCATED IN THE VILLAGE OF LISLE

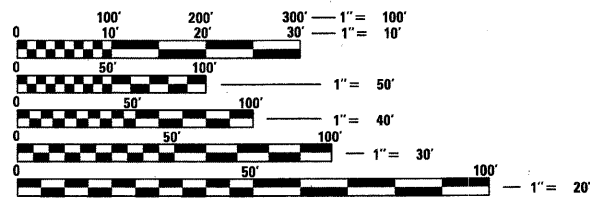

FULL SIZE PLANS HAVE BEEN PREPARED USING STANDARD ENGINEERING SCALES. REDUCED SIZED PLANS WILL NOT CONFORM TO STANDARD SCALES. IN MAKING MEASUREMENTS ON REDUCED PLANS, THE ABOVE SCALES MAY BE USED.

J.U.L.I.E.
JOINT UTILITY LOCATION INFORMATION FOR EXCAVATION
1-800-892-0123 OR 811

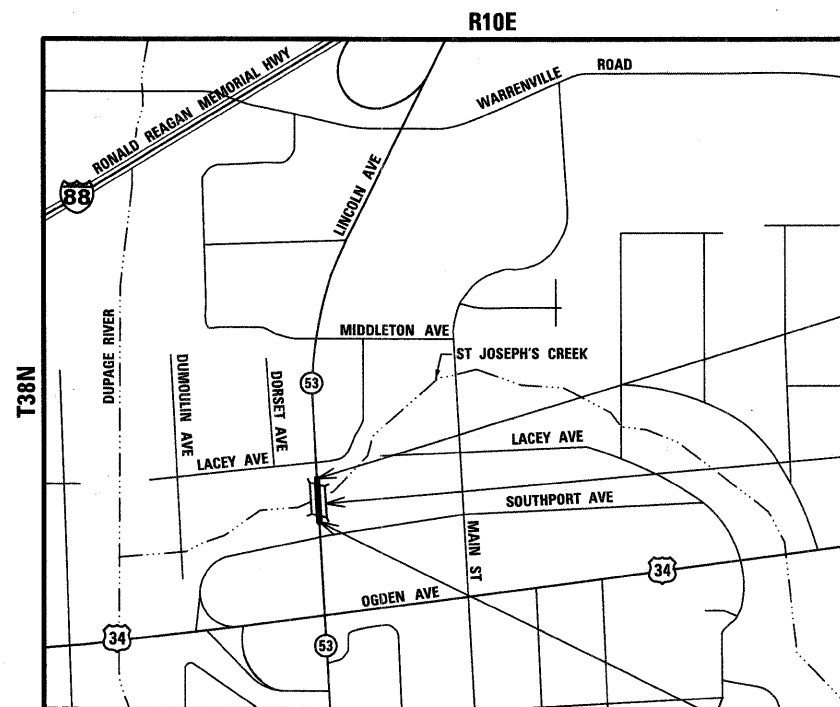

SECTION 3
LISLE TOWNSHIP
LOCATION MAP
NOT TO SCALE

PROJECT ENDS
STA. 101 + 65.00

PROJECT LOCATION:
IL ROUTE 53 (LINCOLN AVE.)
OVER ST JOSEPH'S CREEK
EXISTING SN: 022-0082
PROPOSED SN: 022-3054

PROJECT CONSISTS OF THE REMOVAL OF THE EXISTING BRIDGE (SN: 022-0082 EXISTING) AND REPLACEMENT WITH A THREE SIDED PRECAST CONCRETE STRUCTURE (SN: 022-3054 PROPOSED) AND THE REMOVAL AND REPLACEMENT OF THE EXISTING APPROACH ROADWAY OF IL ROUTE 53 (LINCOLN AVE) OVER ST. JOSEPH'S CREEK.

PROJECT BEGINS
STA. 98 + 63.00

GROSS AND LENGTH OF PROJECT = 302.0 FEET = 0.057 MILES

PROJECT MANAGER ISSAM RAYYAN, PE (847) 705-4550
PROJECT ENGINEER ROBERT T. BORO, PE (847) 705-4178
CONTRACT NO. 60M83

Primera
100 S. WACKER DRIVE SUITE 700 CHICAGO IL 60606.
P:312-606-0910 F:312-606-0415

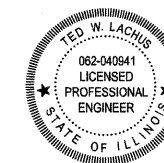

Ted W. Lachus, P.E.
EXPIRES 11-30-2011
DATE 8-26-2011

PRINTED BY THE AUTHORITY
OF THE STATE OF ILLINOIS