

DATE	
BY	
SURVEYED	
PLOTTED	
TEMPLATE	
NOTE BOOK	
AREAS CHECKED	
NO.	

DATE	
BY	
SURVEYED	
PLOTTED	
TEMPLATE	
NOTE BOOK	
AREAS CHECKED	
NO.	

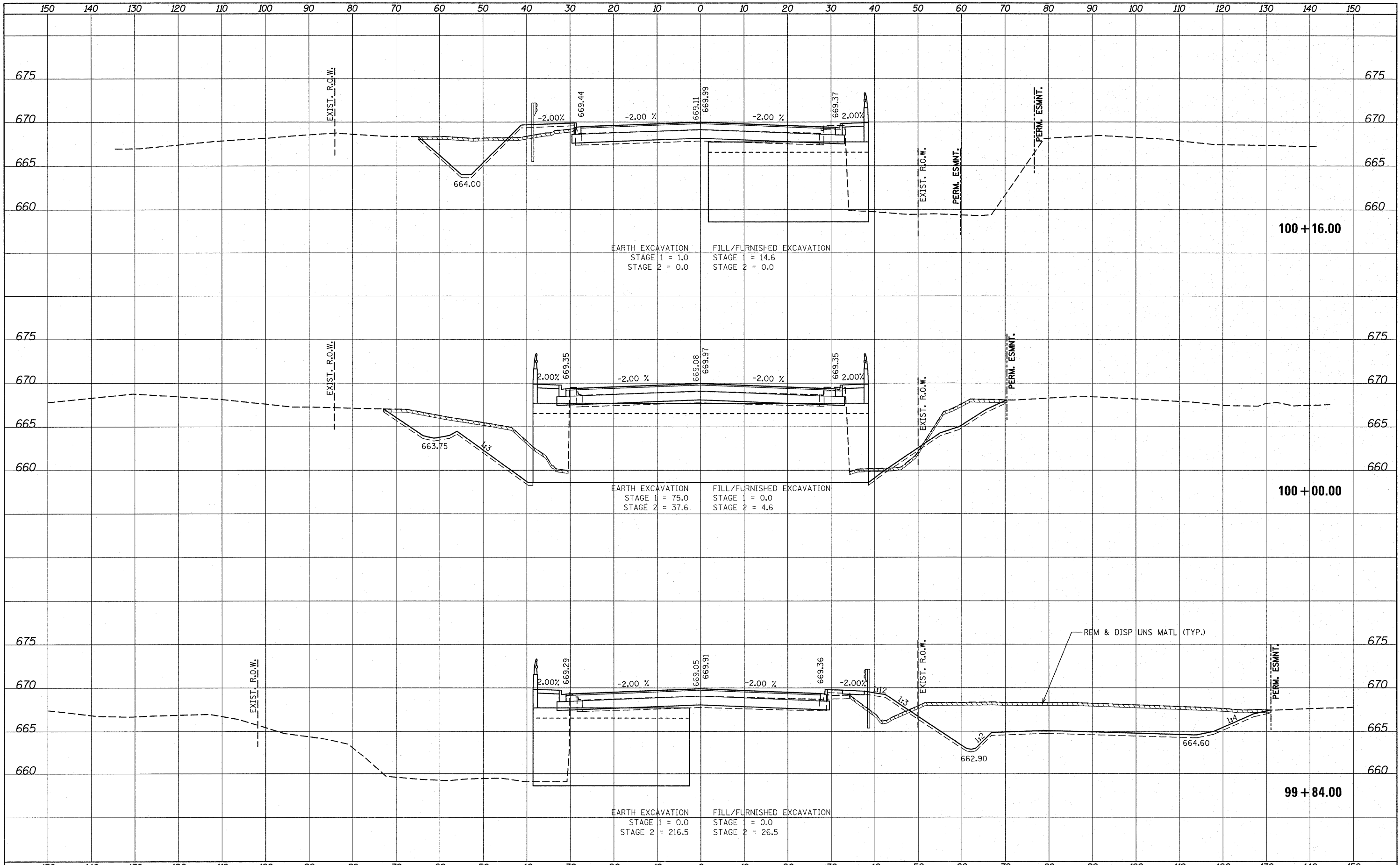

FILE NAME = ...\\D160M83-aht-xshd.dgn



DESIGNED - ADW	REVISED - 12/6/2011 N.W.S.
DRAWN - GEW	REVISED -
CHECKED - RJD	REVISED -
DATE - 12/12/2011	REVISED -

**STATE OF ILLINOIS
DEPARTMENT OF TRANSPORTATION**

**IL ROUTE 53 OVER ST. JOSEPH'S CREEK
CROSS SECTIONS**

SCALE: SHEET NO. OF SHEETS STA. 99+84.00 TO STA. 100+16.00

F.A.P. RTE. 870	SECTION 534R-B	COUNTY DuPAGE	TOTAL SHEETS 51	SHEET NO. 44
CONTRACT NO. 60M83			ILLINOIS FED. AID PROJECT	