

- LEGEND**
- PAVEMENT REMOVAL OR DRIVEWAY PAVEMENT REMOVAL OR BIT. SURFACE REMOVAL
 - COMBINATION CURB AND GUTTER REMOVAL OR CURB REMOVAL (AS NOTED)
 - SIDEWALK REMOVAL
 - * DETECTABLE WARNINGS ON CURB RAMPS

NOTE:
 1) REFER TO PLAT OF HIGHWAYS FOR PROPOSED RIGHT-OF-WAY AND TEMPORARY CONSTRUCTION EASEMENT STATION AND OFFSET LOCATION

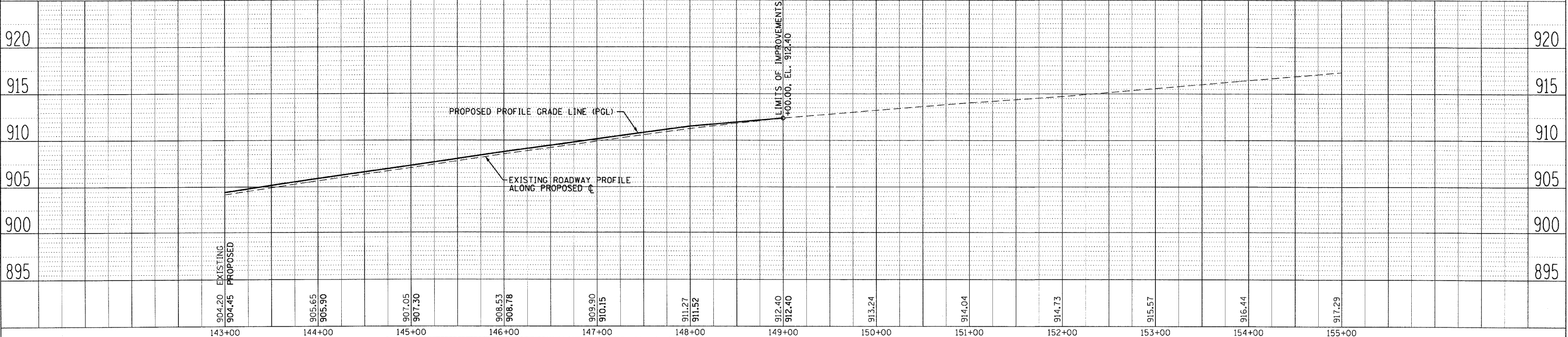
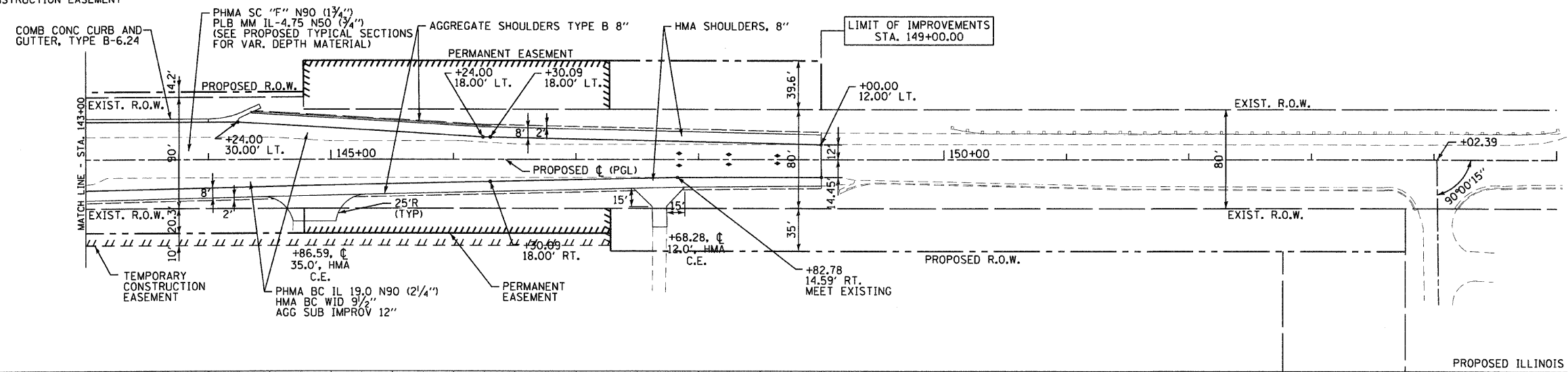

PLAN AND PROFILE IL. RTE. 31 STA. 143+00 TO STA. 155+00

DATE _____ BY _____
 PLAN
 REVISIONS
 NO. _____ DATE _____
 NO. _____ DATE _____

DATE _____ BY _____
 PROFILE
 REVISIONS
 NO. _____ DATE _____
 NO. _____ DATE _____