

NOTE: 1. ALL EXISTING PAVEMENT AND CONCRETE CURB & GUTTER WITHIN LIMITS IS TO BE REMOVED. EXISTING CONCRETE SIDEWALK IS TO BE REMOVED ONLY WHERE SHOWN ON THE PLAN.
 2. ALL UTILITY POLES SHOWN TO BE RELOCATED (M) ARE TO BE RELOCATED BY OTHERS.

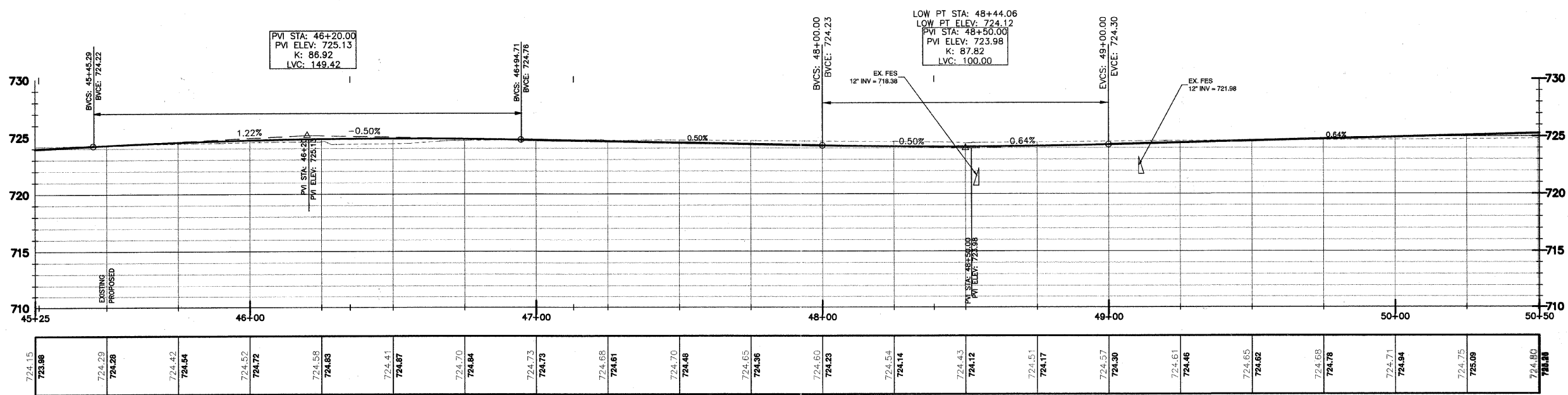

FILE NAME: xxx

GERALD L. HEINZ & ASSOCIATES, INC.
 CONSULTING ENGINEERS & LAND SURVEYORS
 206 NORTH RIVER STREET
 EAST DUNDEE, ILLINOIS 60118

USER NAME:
 DESIGNED: EBW
 DRAWN: PC
 CHECKED: JDH
 DATE: AUGUST 25, 2010

REVISED: MARCH 23, 2011
 REVISED: MAY 16, 2011
 REVISED:

STATE OF ILLINOIS
 DEPARTMENT OF TRANSPORTATION

PLAN AND PROFILE
 SCALE: 1" = 20'
 SHEET NO. 10 OF 11 SHEETS
 STA: 45+25 TO STA: 50+50
 COUNTY: KANE
 TOTAL SHEETS: 85
 SHEET NO.: 20
 CONTRACT NO. 63507
 FED. ROAD DIST. NO.: ILLINOIS
 FED. AID. PROJECT