

**MAINTENANCE OF TRAFFIC GENERAL NOTES**

1. TRAFFIC CONTROL AND PROTECTION, SHALL BE PERFORMED IN ACCORDANCE WITH THE SPECIAL PROVISIONS FOR THIS PROJECT, SECTION 701 OF THE IDOT "STANDARD SPECIFICATIONS FOR ROAD AND BRIDGE CONSTRUCTION", APPLICABLE GUIDELINES IN THE "ILLINOIS MANUAL ON UNIFORM TRAFFIC CONTROL DEVICES FOR STREETS AND HIGHWAYS", AND APPLICABLE HIGHWAY STANDARDS FOR TRAFFIC CONTROL.
2. ANY DROP-OFF GREATER THAN THREE INCHES WITHIN EIGHT FEET OF THE PAVEMENT EDGE, SHALL BE PROTECTED BY TYPE I OR II BARRICADES (OR DRUMS) EQUIPPED WITH MONO-DIRECTIONAL STEADY-BURN LIGHTS SPACES AT 50'-FOOT CENTERS. BARRICADES THAT MUST BE PLACED IN EXCAVATED AREAS SHALL HAVE LEG EXTENSIONS INSTALLED SUCH THAT THE TOP OF THE BARRICADE IS IN COMPLIANCE WITH THE HEIGHT REQUIREMENTS OF THE IDOT HIGHWAY STANDARDS.
3. ARROW BOARDS WILL BE REQUIRED WHEN IMPLEMENTING ALL LANE CLOSURES.
4. PRIOR TO THE START OF CONSTRUCTION, REQUIRED TRAFFIC CONTROL DEVICES SHALL BE IN PLACE.
5. IDOT TRAFFIC CONTROL STANDARDS LISTED BY REFERENCE ON THE TITLE SHEET SHALL BE USED AS GUIDES IN IMPLEMENTING THE TRAFFIC CONTROL, INCLUDING SIGN LOCATIONS, FOR THIS PROJECT.
6. MONO-DIRECTIONAL FLASHING LIGHTS AND ORANGE WARNING FLAGS SHALL BE MOUNTED ON ALL "ROAD CONSTRUCTION AHEAD" SIGNS.
7. THE CONTRACTOR SHALL MAINTAIN ACCESS TO ALL PROPERTIES DURING CONSTRUCTION OPERATIONS.
8. DEPICTED TRAFFIC CONTROL IS A MINIMUM REQUIREMENT, AND OTHER WORK OR SIGNING MAY BE REQUIRED AS PER THE INSTRUCTION OF THE ENGINEER IN CHARGE. THE COST INCURRED TO COMPLY WILL BE INCLUDED IN THE PAY ITEMS "TRAFFIC CONTROL AND PROTECTION, SPECIAL".
9. THE CITY OF BLUE ISLAND, AND THE ENGINEER SHALL BE NOTIFIED IN WRITING AT LEAST THREE WEEKS PRIOR TO THE DAY THE CONSTRUCTION STAGING PLAN IS TO BE IN EFFECT. THE CONTRACTOR WILL CONTACT THE APPROPRIATE LOCAL AGENCIES AND INTERESTED PARTIES.
10. THE CONTRACTOR SHALL PROVIDE THE ENGINEER WITH THE NAMES AND PHONE NUMBERS OF HIS REPRESENTATIVES ON THE CONSTRUCTION SITE AND HIS REPRESENTATIVE RESPONSIBLE FOR THE TEMPORARY CONSTRUCTION SIGNING, PRIOR TO THE START OF WORK.
11. THE CONTRACTOR SHALL BE RESPONSIBLE FOR THE FIELD LOCATION OF ALL CONSTRUCTION SIGNING. THE CONTRACTOR MAY REQUEST THE ENGINEER TO FIELD VERIFY THE POSITIONS OF ANY SIGNS.
12. ALL EXISTING SIGNING THAT IS NOT APPLICABLE WHILE THE CONSTRUCTION STAGING PLAN IS IN EFFECT SHALL BE COMPLETELY COVERED, OR REMOVED, BY THE CONTRACTOR IN A MANNER MEETING THE APPROVAL OF THE ENGINEER.
13. ADVANCED CLOSURE SIGNS (CHANGEABLE MESSAGE SIGNS) SHALL BE ERECTED AT LEAST 10 DAYS PRIOR TO ANY ROAD CLOSURES.
14. AT LEAST ONE LANE OF TRAFFIC SHALL REMAIN OPEN ON BOTH 127TH ST. AND SACRAMENTO AVE. AT ALL TIMES. AT THE END OF THE DAY BOTH ROADS MUST BE OPEN TO TRAFFIC.

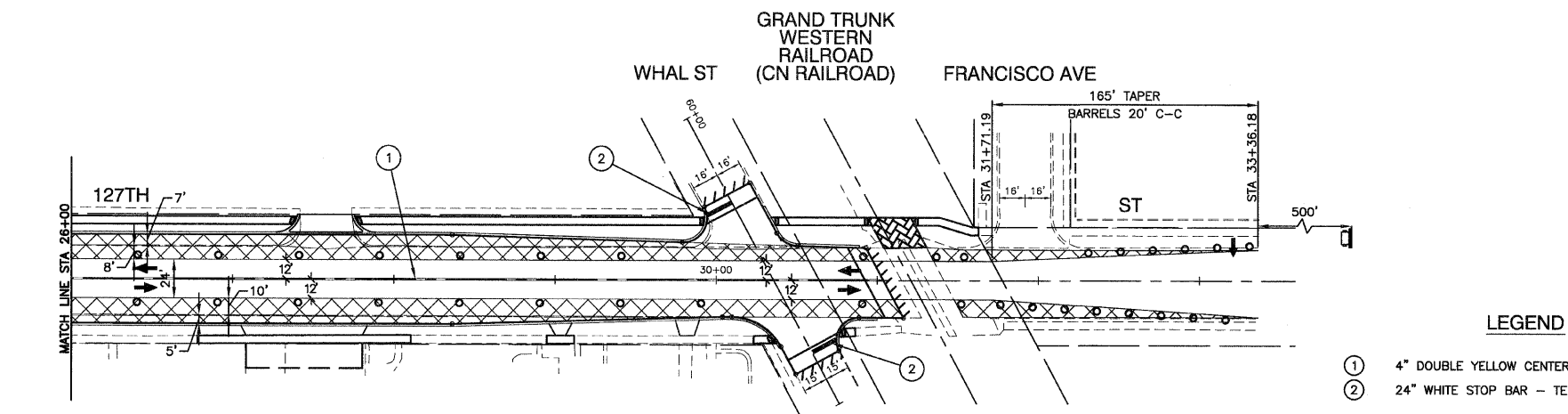
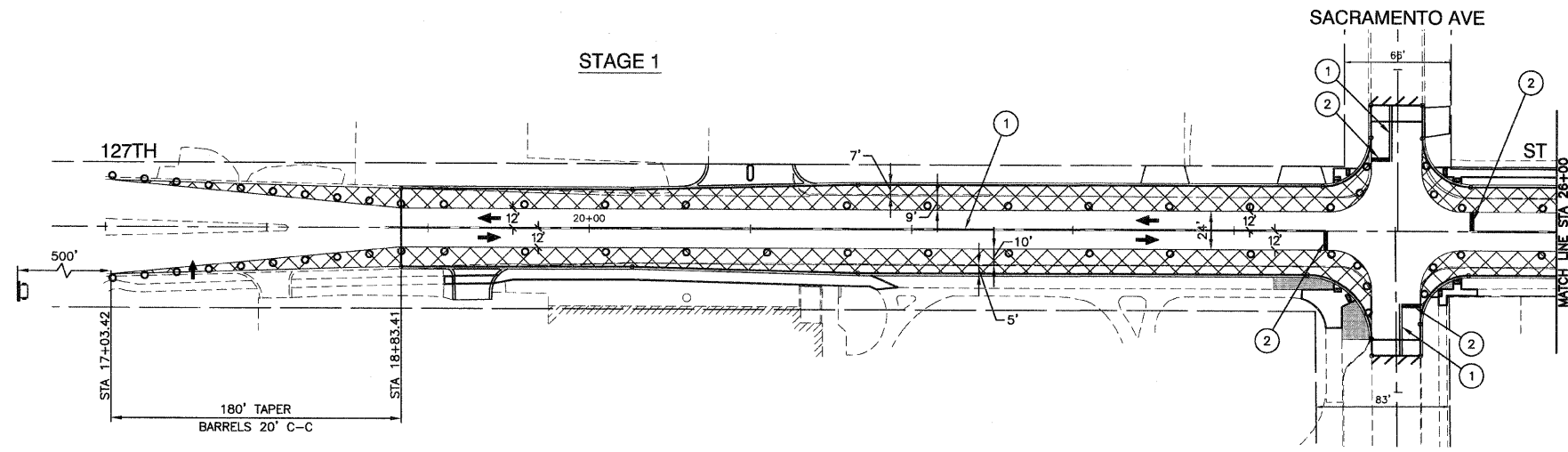

**LEGEND**

- ① 4" DOUBLE YELLOW CENTERLINE (11" C-C) - TEMPORARY PAVEMENT MARKINGS
- ② 24" WHITE STOP BAR - TEMPORARY PAVEMENT MARKINGS
- ⊗ WORK AREA
- TYPE I OR II BARRICADE OR DRUM WITH STEADY BURNING LIGHT (50' C-C) UNLESS OTHERWISE INDICATED
- ⊥ TYPE III BARRICADE WITH STEADY BURNING LIGHT
- ➔ SIGN
- ➔ TRAFFIC FLOW
- ↑ ARROW BOARD
- CHANGEABLE MESSAGE SIGN

**SUGGESTED CONSTRUCTION STAGING NOTES**

- PRE-STAGE**
- PRE-STAGE WORK TO BE DONE UNDER FLAGGER AND APPLICABLE IDOT TRAFFIC CONTROL STANDARDS FOR DAILY LANE CLOSURES.
  - WORK:
    - MILL ± 3/4" IN AREAS SHOWN ON TYPICAL CROSS SECTION.
    - INSTALL STORM SEWER.
    - PAVEMENT PATCHING.
    - TEMPORARY TRAFFIC SIGNALS.
- STAGE 1 (SEE PLAN VIEW AND TYPICAL CROSS SECTION)**
- CLOSE THE OUTSIDE EXISTING LANES.
  - WORK FOR WIDENING:
    - EXISTING CURB AND GUTTER REMOVAL.
    - EXCAVATION AND FILL.
    - AGGREGATE SUBGRADE.
    - P.C.C. BASE COURSE WIDENING.
    - BINDER COURSE.
    - CURB AND GUTTER.
    - TRAFFIC SIGNALS.
    - ROADWAY LIGHTING.
- STAGE 2**
- STAGE 2 WORK TO BE DONE UNDER FLAGGER AND APPLICABLE IDOT TRAFFIC CONTROL STANDARDS FOR DAILY LANE CLOSURES.
  - WORK:
    - LEVELING BINDER.
    - FINAL SURFACE COURSE.
    - PAVEMENT MARKINGS.
    - LANDSCAPING.

**NOTES:**

1. PRE-STAGE TO BE DONE UNDER DAILY LANE CLOSURES PER APPLICABLE IDOT STANDARDS.
2. WIDENING SHALL NOT BE LEFT EXCAVATED OVERNIGHT.
3. ADVANCE SIGNING FOR APPROACHING CONSTRUCTION TO BE IN ACCORDANCE WITH HIGHWAY STANDARDS 701606.

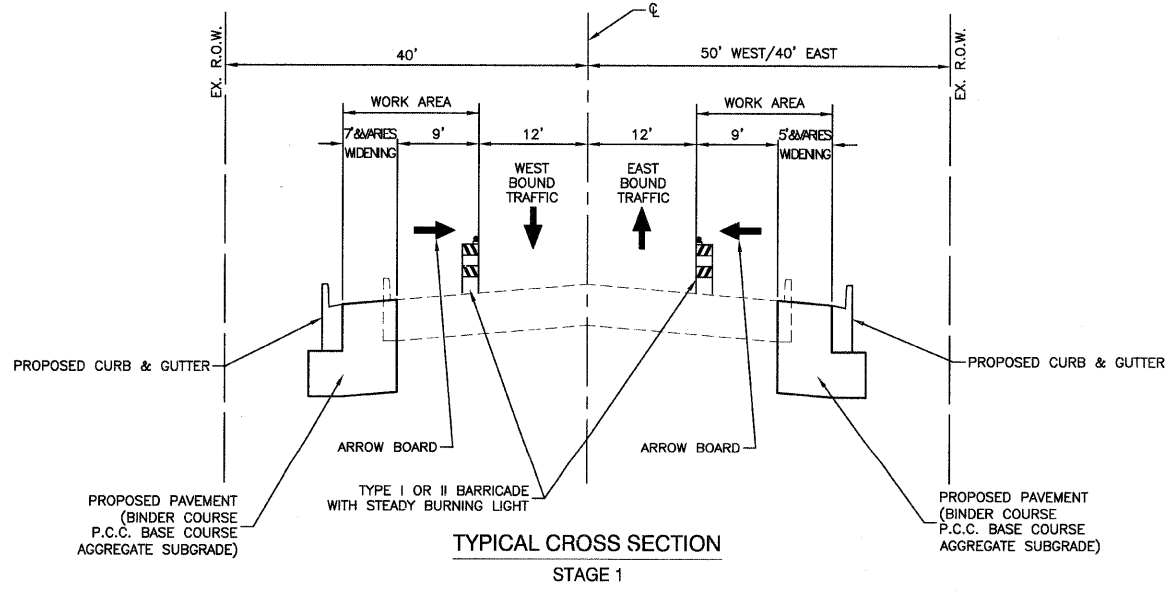

FILE NAME = 09827-TCON-01 - P01	USER NAME =	DESIGNED -- HLG	REVISED --	STATE OF ILLINOIS DEPARTMENT OF TRANSPORTATION	FAP 0344 (127TH STREET) AT SACRAMENTO AVENUE SUGGESTED CONSTRUCTION STAGING	F.A.U. RTE.	SECTION	COUNTY	TOTAL SHEETS	SHEET NO.	
		CHECKED -- HLG	REVISED --			0344	06-00175-00-TL	COOK	48	9	
	PLOT SCALE =	DRAWN -- LTL	REVISED --			CONTRACT NO. 63613					
	PLOT DATE = 02-22-12	CHECKED -- AG	REVISED --			SCALE: 1" = 50'	SHEET NO. 9 OF 48 SHEETS	STA.	TO STA.	FED. ROAD DIST. NO. 1	ILLINOIS