

SECTION 25, TOWNSHIP 37, RANGE 13  
SECTION 36, TOWNSHIP 37, RANGE 13

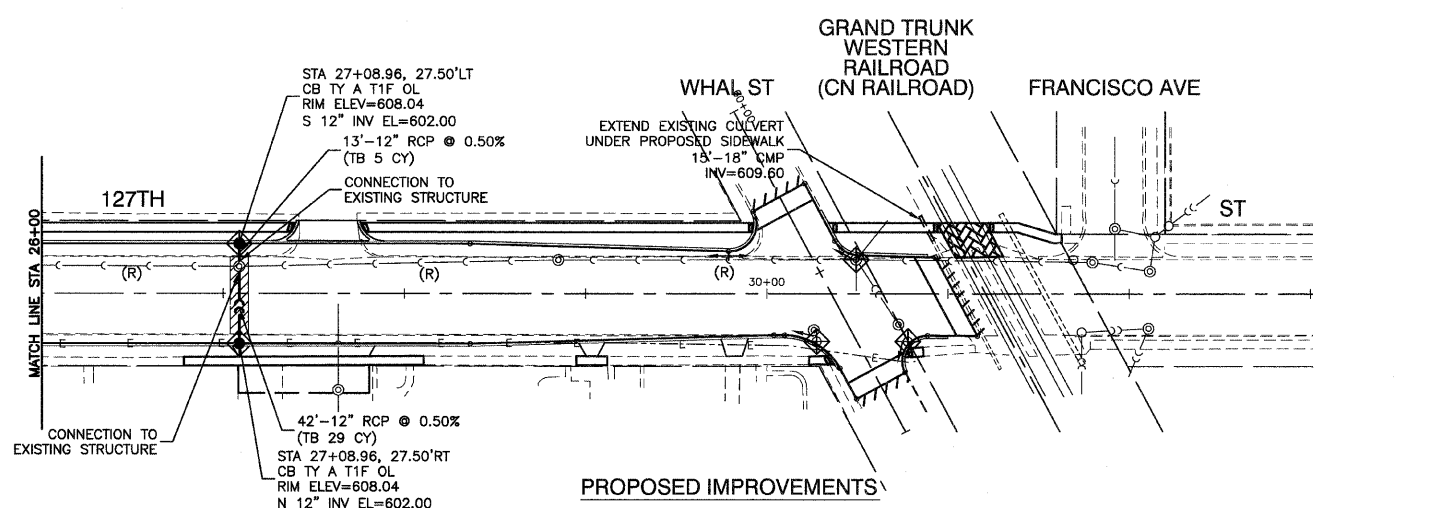
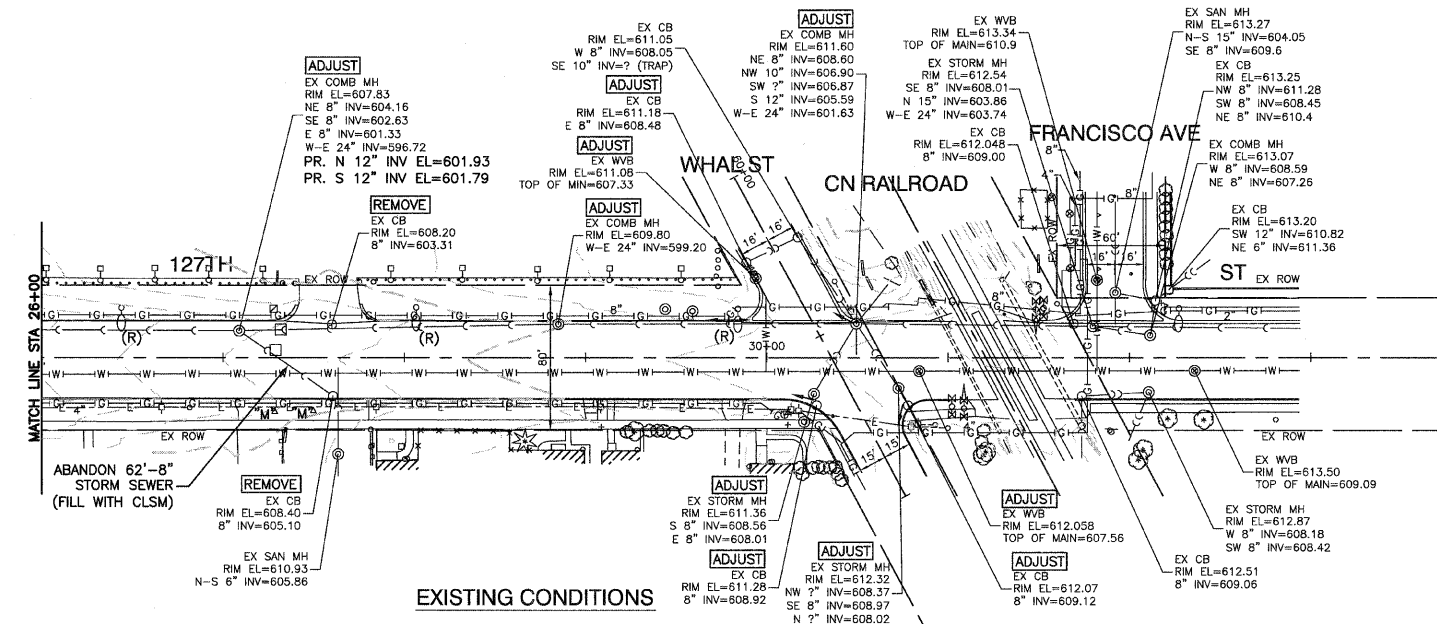
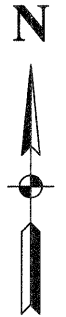

LEGEND

- INLET FILTER
- CLASS D PATCHES
- ADJUST WATER VALVE BOX
- REMOVAL OF EXISTING STREET LIGHT
- REMOVAL OF EXISTING STREET LIGHT (BY OTHERS)

NOTE:  
INLET FILTERS SHALL BE PROVIDED ON ALL EXISTING AND PROPOSED OPEN LID DRAINAGE STRUCTURES.

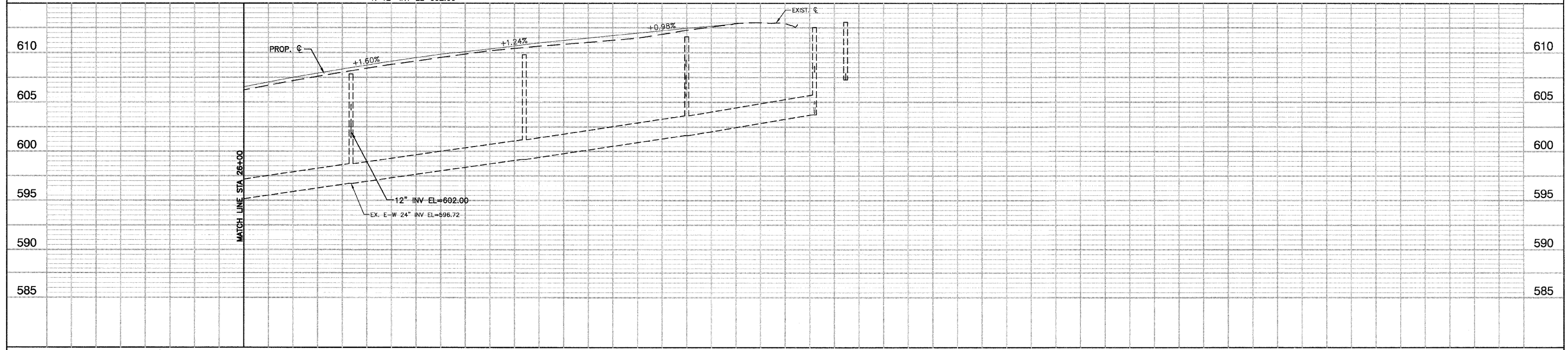

FILE NAME = 09527-STRM-01 - PLPR02	USER NAME =	DESIGNED -- HLG/TAG	REVISED --	STATE OF ILLINOIS DEPARTMENT OF TRANSPORTATION	FAP 0344 (127TH STREET) AT SACRAMENTO AVENUE DRAINAGE & UTILITIES	F.A.U. RTE.	SECTION	COUNTY	TOTAL SHEETS	SHEET NO.	
		CHECKED -- HLG	REVISED --			0344	06-00175-00-TL	COOK	48	11	
		DRAWN -- AG/LTL	REVISED --			CONTRACT NO. 63613					
		CHECKED -- AG	REVISED --			SCALE: H 1"=50' V 1"=5' SHEET NO. 11 OF 48 SHEETS STA. TO STA.					
	PLOT DATE = 02-22-12			FED. ROAD DIST. NO. 1 ILLINOIS FED. AID PROJECT F-0344 (041)							