

SCHEDULE OF QUANTITIES
GENEVA ROAD AT KENILWORTH AVENUE / CHURCHILL SCHOOL

NO.	QUANT.	UNIT
1.	4	CU YD EARTH EXCAVATION
2.	745	SQ FT PORTLAND CEMENT CONCRETE SIDEWALK 5 INCH
3.	104	SQ FT DETECTABLE WARNINGS
4.	640	SQ FT SIDEWALK REMOVAL
5.	1	EACH SERVICE INSTALLATION - POLE MOUNTED
6.	1	EACH MAINTENANCE OF EXISTING TRAFFIC SIGNAL INSTALLATION
7.	1	EACH REMOVE EXISTING TRAFFIC SIGNAL EQUIPMENT
8.	1	EACH REMOVE EXISTING SERVICE INSTALLATION

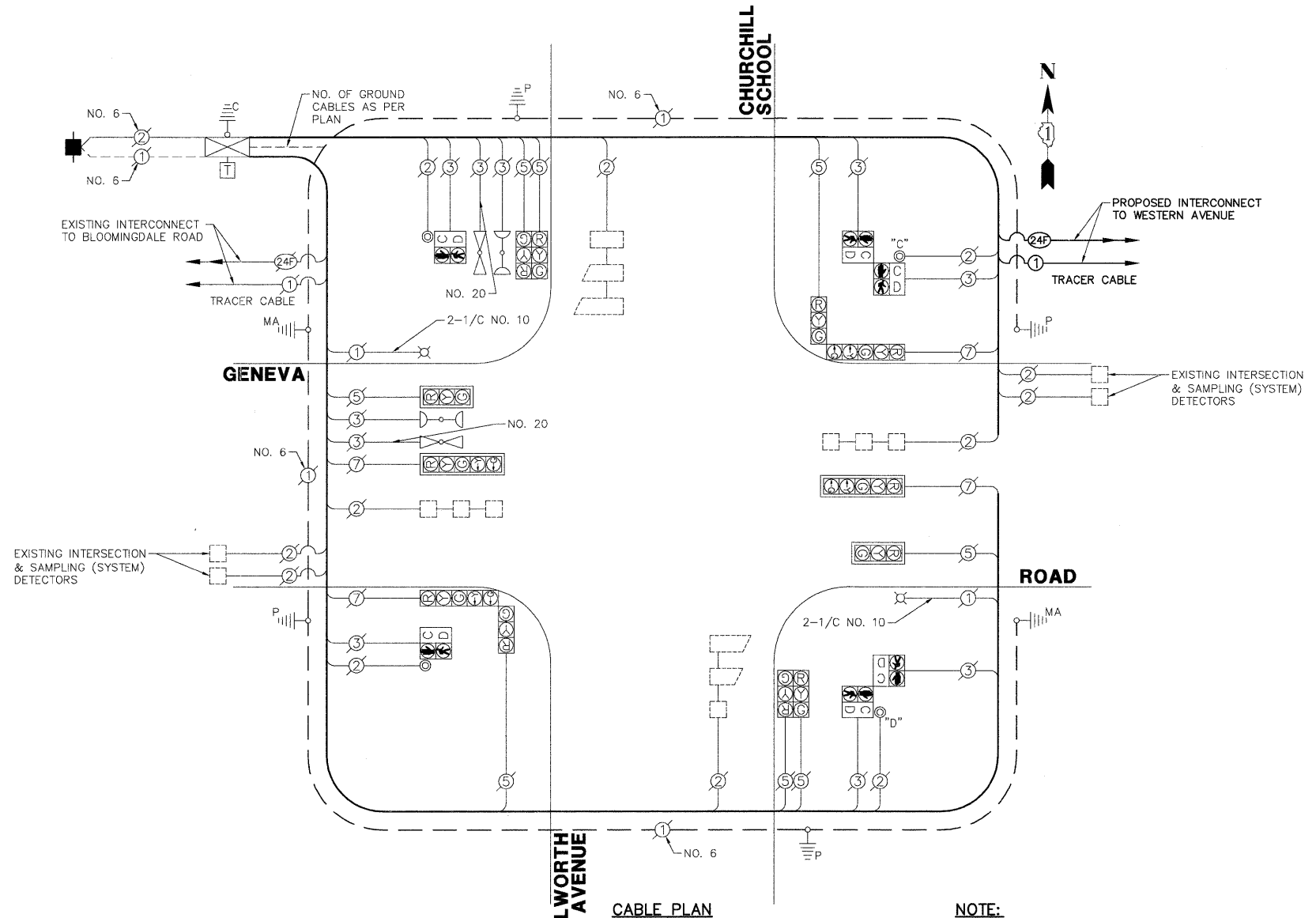

CABLE PLAN

NOTE:
PUSH BUTTON "C" SHALL PLACE A CALL IN PHASES 6 AND 8.
PUSH BUTTON "D" SHALL PLACE A CALL IN PHASES 8 AND 2.

EXISTING CONTROLLER SEQUENCE

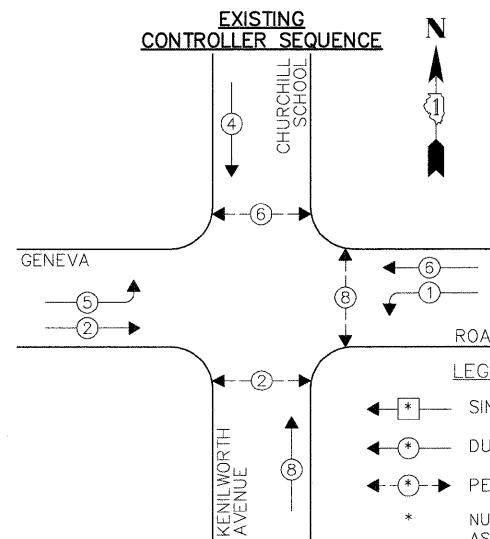

EXISTING PHASE DESIGNATION DIAGRAM

EXISTING EMERGENCY VEHICLE PREEMPTION SEQUENCE

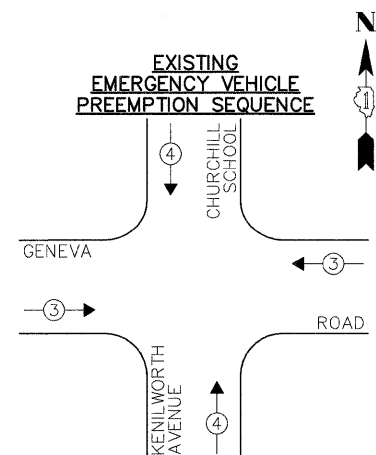

EXISTING EMERGENCY VEHICLE PREEMPTORS			
EMERGENCY VEHICLE PREEMPTOR	3	4	
MOVEMENT	←	→	↑

I.D.O.T. TRAFFIC SIGNAL INSTALLATION ELECTRICAL SERVICE REQUIREMENTS					TOTAL WATTAGE
TYPE	NO. LAMPS	WATTAGE	% OPERATION		
SIGNAL (RED)	12	135	17	0.50	102.0
SIGNAL (YELLOW)	12	135	25	0.25	75.0
SIGNAL (GREEN)	12	135	15	0.25	45.0
ARROW	8	135	12	0.10	9.6
PED. SIGNAL	6	90	25	1.00	150.0
CONTROLLER	1	-	100	1.00	100.0
LUMINAIRE	2	250	-	0.50	250.0
L.E.D. ST. NAME SIGN	-	-	64	0.50	-
VIDEO SYSTEM	-	-	150	1.00	-
BATTERY BACKUP	-	-	25	1.00	-
ILLUMINATED SIGN	-	-	25	0.05	-
TOTAL =					731.6

ENERGY COSTS - BILLED TO: VILLAGE OF GLEN ELLYN
(ADDRESS) 20 S. LAMBERT ROAD
(ADDRESS) GLEN ELLYN, IL 60137
ENERGY SUPPLY - CONTACT: MS. DEB RANKIN
PHONE: (630) 691-4379
COMPANY: COM-ED

THE TRAFFIC SIGNAL CONTROL EQUIPMENT FOR THIS PROJECT SHALL BE "ECONOLITE" TO MATCH THE EXISTING ADJACENT SYSTEM.