

PLAN	REVISIONS	DATE
NO.	BY	
1		
2		
3		
4		
5		
6		
7		
8		
9		
10		
11		
12		
13		
14		
15		
16		
17		
18		
19		
20		
21		
22		
23		
24		
25		
26		
27		
28		
29		
30		
31		
32		
33		
34		
35		
36		
37		
38		
39		
40		
41		
42		
43		
44		
45		
46		
47		
48		
49		
50		
51		
52		
53		
54		
55		
56		
57		
58		
59		
60		
61		
62		
63		
64		
65		
66		
67		
68		
69		
70		
71		
72		
73		
74		
75		
76		
77		
78		
79		
80		
81		
82		
83		
84		
85		
86		
87		
88		
89		
90		
91		
92		
93		
94		
95		
96		
97		
98		
99		
100		

PROFILE	REVISIONS	DATE
NO.	BY	
1		
2		
3		
4		
5		
6		
7		
8		
9		
10		
11		
12		
13		
14		
15		
16		
17		
18		
19		
20		
21		
22		
23		
24		
25		
26		
27		
28		
29		
30		
31		
32		
33		
34		
35		
36		
37		
38		
39		
40		
41		
42		
43		
44		
45		
46		
47		
48		
49		
50		
51		
52		
53		
54		
55		
56		
57		
58		
59		
60		
61		
62		
63		
64		
65		
66		
67		
68		
69		
70		
71		
72		
73		
74		
75		
76		
77		
78		
79		
80		
81		
82		
83		
84		
85		
86		
87		
88		
89		
90		
91		
92		
93		
94		
95		
96		
97		
98		
99		
100		

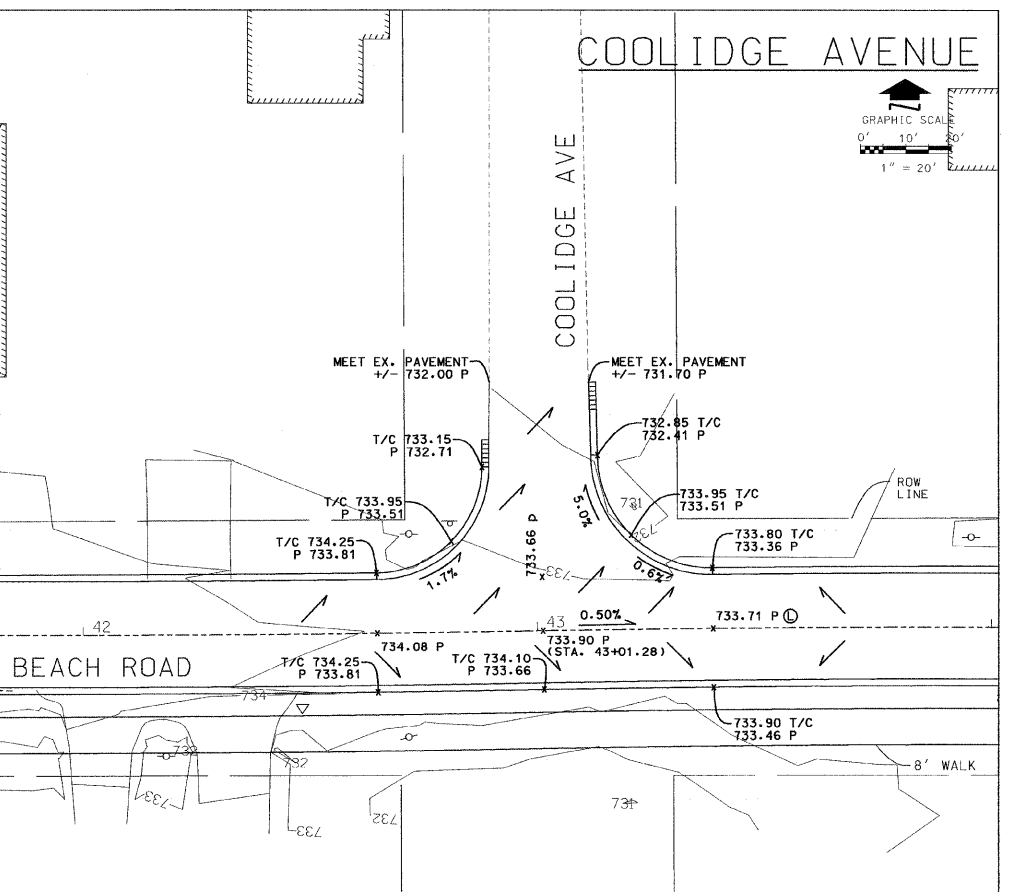
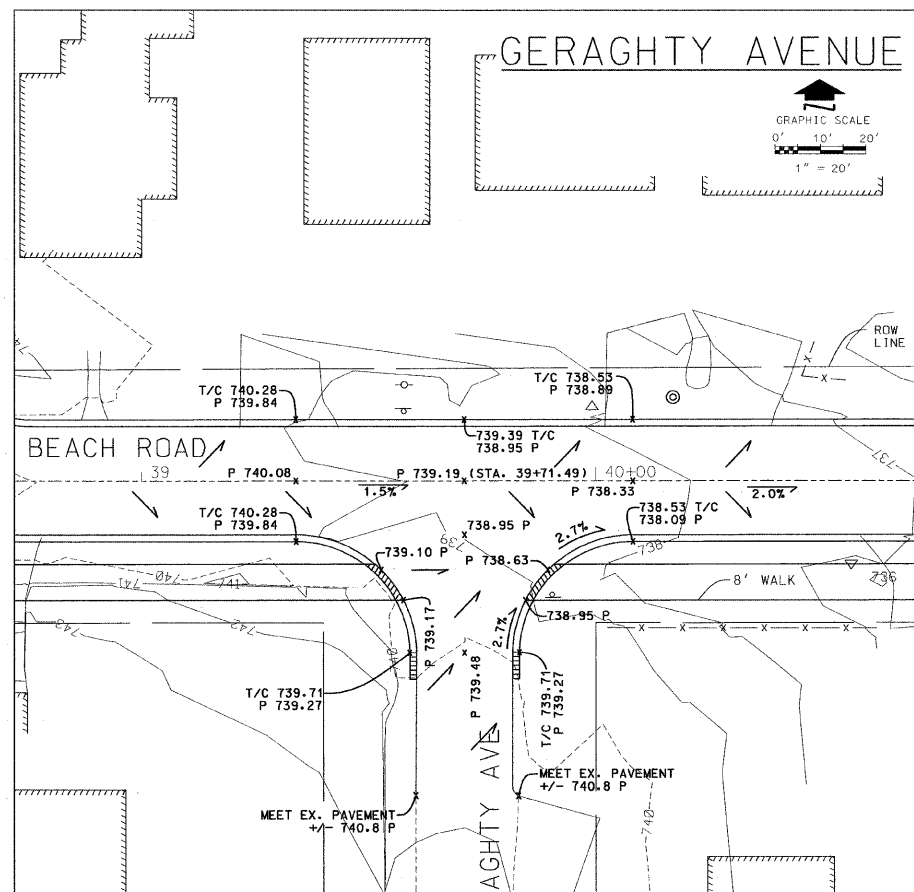
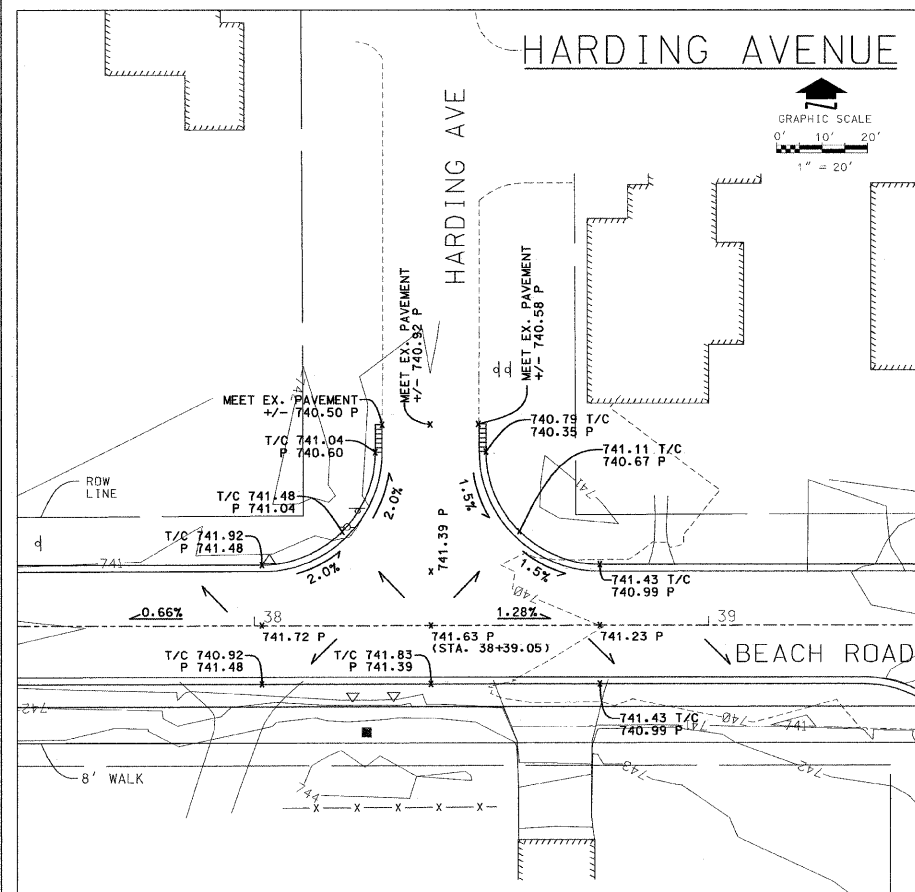
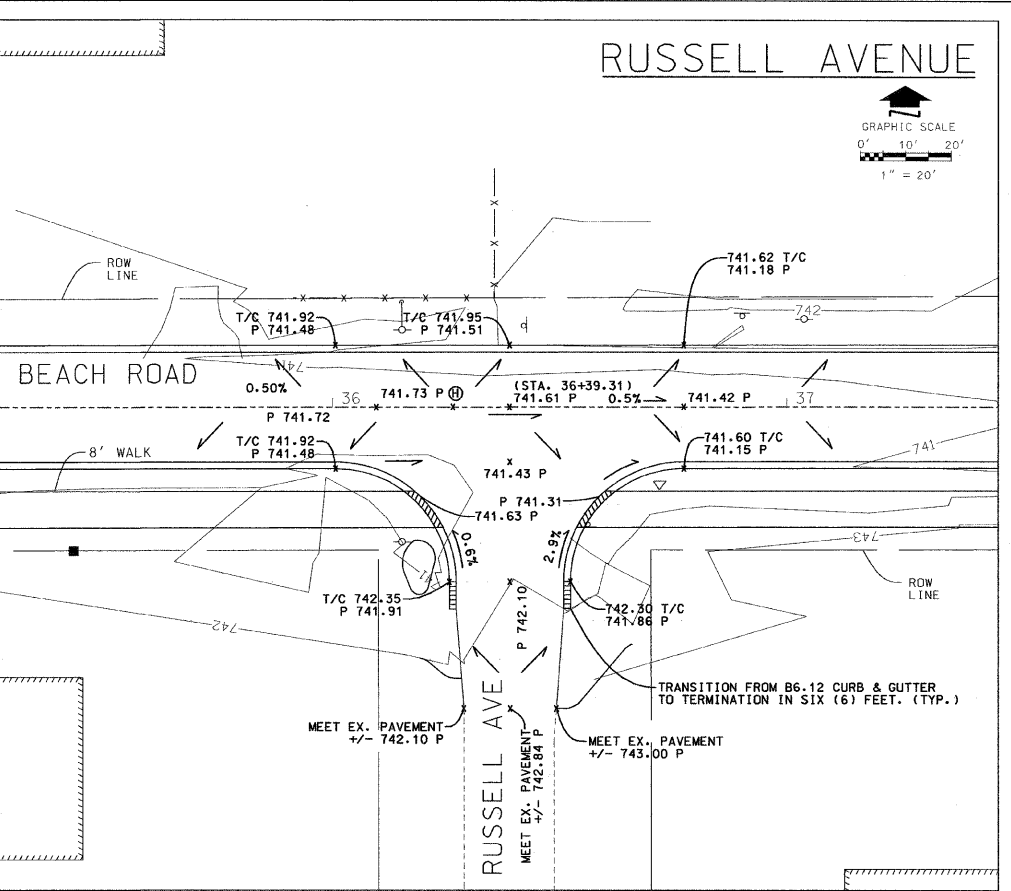
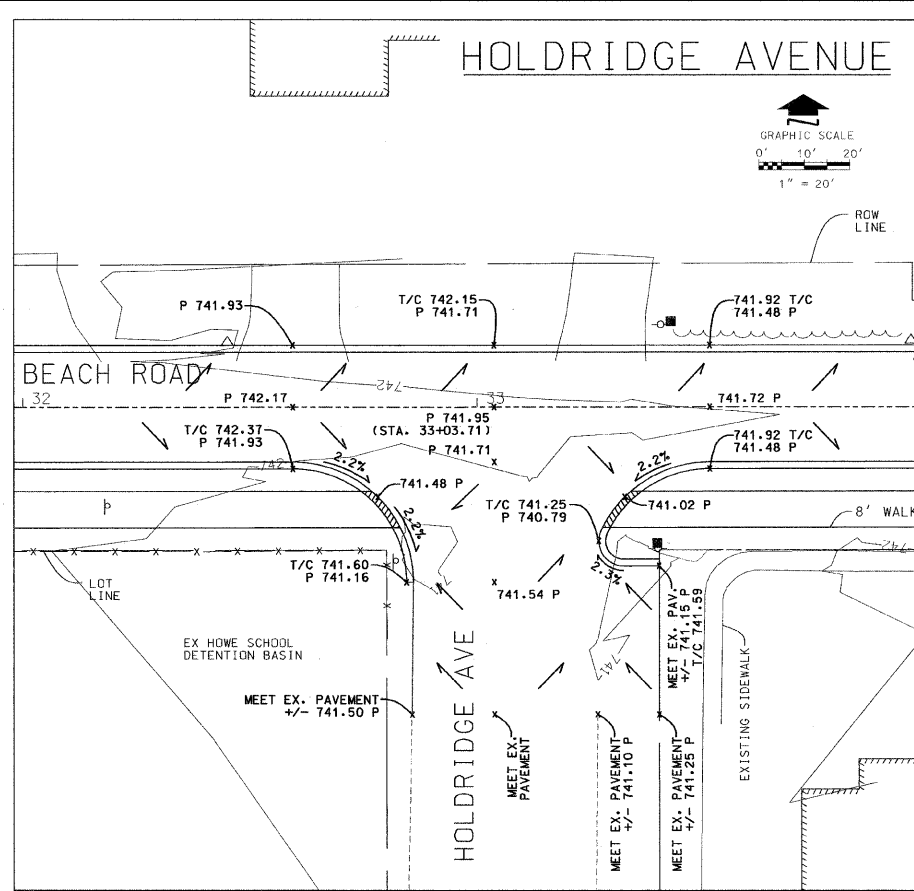
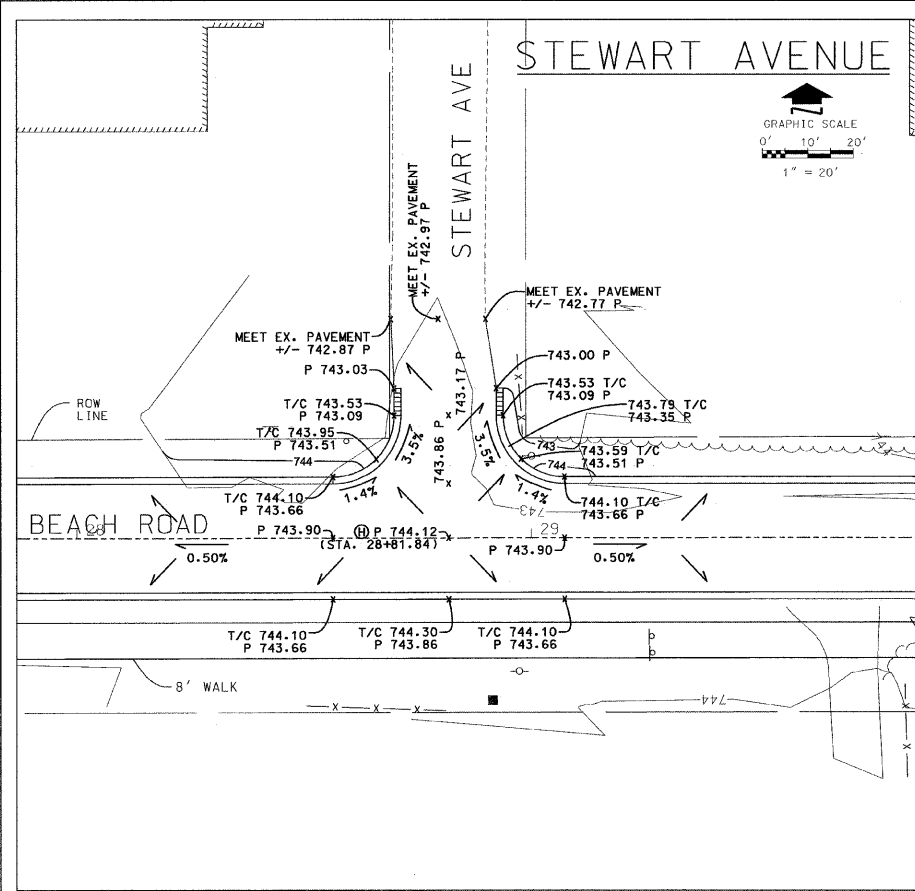

RHMG JOB NO 21108030
----------------------

DESIGNED - CMP	REVISED - 2/6/12
DRAWN - NAT	REVISED - 2/22/12
CHECKED - BWM	REVISED -
DATE - 12/7/11	REVISED -

**RHMG** REZEK, HENRY, MEISENHEIMER, and GENDE, INC.  
CONSULTING ENGINEERS  
375 CAMPUS DRIVE  
MUNDELEIN, ILLINOIS 60060  
847-362-5999

535 TOLLWAY RD. SUITE F  
ELGIN, ILLINOIS 60123  
847-742-5999

VILLAGE OF BEACH PARK  
BEACH ROAD  
BEACH PARK, ILLINOIS

INTERSECTION DETAILS

SCALE: 1" = 20' SHEET NO. 24 OF 47 SHEETS STA. TO STA.

F.A. RTE. 1210	SECTION 11-00012-00-PV	COUNTY LAKE	TOTAL SHEETS 47	SHEET NO. 24
FED. ROAD DIST. NO.		ILLINOIS FED. AID PROJECT		
CONTRACT NO. 63683				