

- 4 EX. W/M VALVE VAULT
RIM: 600.79 T/P: 595.74
ADJUST: 600.75
- 5 EX. W/M VALVE VAULT
RIM: 600.66 T/P: 595.66
ADJUST: 600.61
- 6 EX. W/M VALVE VAULT
RIM: 600.48 T/P: 596.48
ADJUST: 601.05
- 11 EX. STORM CATCHBASIN
RIM: 600.10 INV: 597.55
TO BE REMOVED
- 12 EX. STORM CATCHBASIN
RIM: 600.40 INV: 596.30
S 8" INV: 596.75
SW 4" INV: 598.35
- 13 EX. STORM CATCHBASIN
RIM: 600.56 INV: UNKWN
W 8" INV: 598.01
W 6" INV: 598.01
- 14 EX. STORM CATCHBASIN
RIM: 600.16 INV: 597.96
TO BE REMOVED
- 15 EX. STORM CATCHBASIN
RIM: 599.94 INV: 597.94
TO BE REMOVED
- 16 EX. STORM CATCHBASIN
RIM: 600.71 INV: 595.21
N 8" INV: 596.01
TO BE REMOVED
- 17 EX. STORM CATCHBASIN
RIM: 600.76 INV: 594.76
S 8" INV: 596.76
TO BE REMOVED
- 18 EX. STORM CATCHBASIN
RIM: 600.36 INV: 598.06
TO BE REMOVED

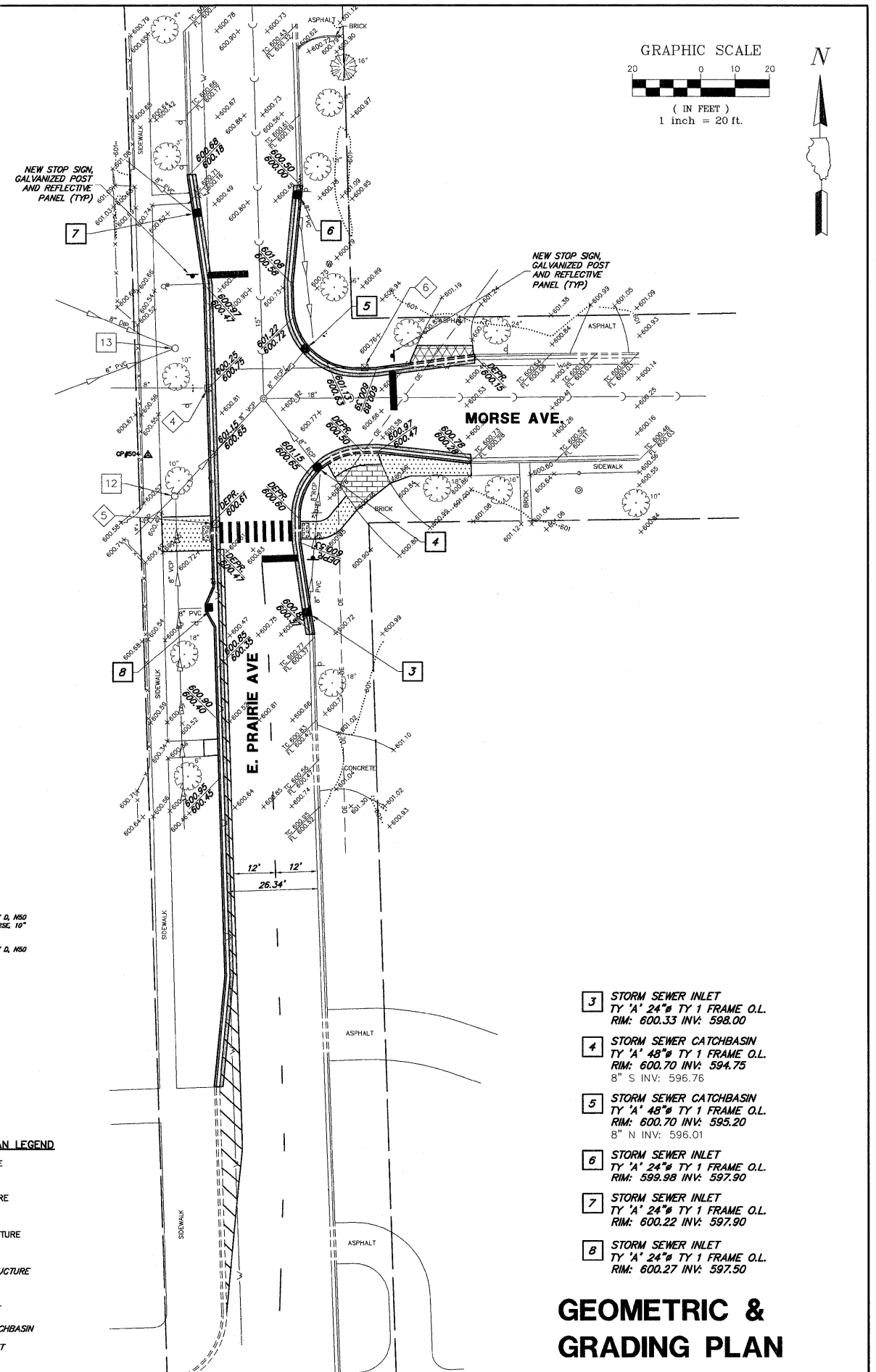

- 3 STORM SEWER INLET
TY 'A' 24" TY 1 FRAME O.L.
RIM: 600.33 INV: 598.00
- 4 STORM SEWER CATCHBASIN
TY 'A' 48" TY 1 FRAME O.L.
RIM: 600.70 INV: 594.75
8" S INV: 596.76
- 5 STORM SEWER CATCHBASIN
TY 'A' 48" TY 1 FRAME O.L.
RIM: 600.70 INV: 595.20
8" N INV: 596.01
- 6 STORM SEWER INLET
TY 'A' 24" TY 1 FRAME O.L.
RIM: 599.98 INV: 597.90
- 7 STORM SEWER INLET
TY 'A' 24" TY 1 FRAME O.L.
RIM: 600.22 INV: 597.90
- 8 STORM SEWER INLET
TY 'A' 24" TY 1 FRAME O.L.
RIM: 600.27 INV: 597.50

FILE NAME = 9232.386 PR-2 (IDOT).dwg	USER NAME = BJW	DESIGNED - BJW	REVISED - BJW - 2/2/2012	STATE OF ILLINOIS DEPARTMENT OF TRANSPORTATION	VILLAGE OF LINCOLNWOOD - SAFE ROUTE TO SCHOOLS MORSE & EAST PRAIRIE TRAFFIC CALMING			FAU RTE N/A	SECTION 10-00055-00-SP	COUNTY COOK	TOTAL SHEETS 8	SHEET NO. 6
PLOT SCALE = 1:1					SCALE: 1"=20'	SHEET NO. 6 OF 8 SHEETS	STA. N/A	TO STA. N/A	CONTRACT #:		63685	
PLOT DATE = 2/2/2012					DATE - 12/9/2011	ILLINOIS FED. AID PROJECT						