

GENERAL NOTES

Plan dimensions and details relative to existing plans are subject to nominal construction variations. The Contractor shall field verify existing dimensions and details affecting new construction and make necessary approved adjustments prior to construction or ordering of materials. Such variations shall not be cause for additional compensation for a change in scope of the work, however, the Contractor will be paid for the quantity actually furnished at the unit price bid for the work.

Reinforcement bars designated (E) shall be epoxy coated.
Prior to pouring the new concrete deck, all heavy or loose rust, loose mill scale, and other loose or potentially detrimental foreign material shall be removed from the surfaces in contact with concrete. Tightly adhered paint may remain unless otherwise noted. Removal shall be accomplished by methods that will not damage the steel and the cost will be included in the pay item covering removal of the existing concrete.

The existing structural steel coating contains lead. The Contractor shall take appropriate precautions to deal with the presence of lead on this project.

Existing reinforcement bars extending into the removal area shall be cleaned, straightened and incorporated into the new construction. Any reinforcement bars that are damaged during concrete removal shall be replaced with an approved bar splicer or anchorage system. Cost included with Concrete Removal.

Joint openings shall be adjusted according to Article 520.04 of the Standard Specifications when the deck is poured at an ambient temperature other than 50° F.

* The deck surface shall have its final finish tined according to Article 420.09(e)(1) of the Standard Specifications. Cost included with Concrete Superstructure.

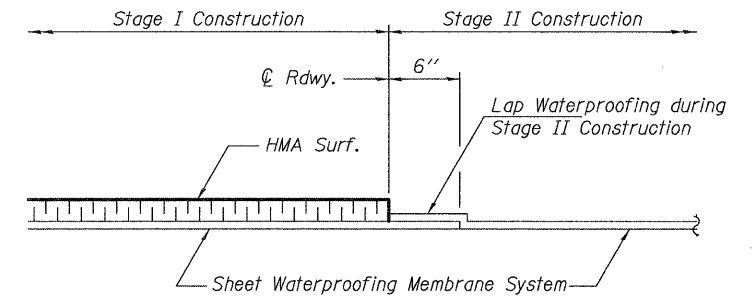

WATERPROOFING TREATMENT AT STAGE CONSTRUCTION

* Applies only to new concrete at joint locations.

** Quantities are estimates. Actual quantity, location and size to be determined by the Engineer in the field.

For pay items and quantities on approaches, see Roadway plans.

TOTAL BILL OF MATERIAL

ITEM	UNIT	QUANTITY
Concrete Removal	Cu. Yd.	66.7
Concrete Superstructure	Cu. Yd.	72.8
Prefomed Joint Strip Seal	Foot	406
Bar Splicers	Each	136
Reinforcement Bars, Epoxy Coated	Pound	12,420
Hot-Mix Asphalt Surface Course Mix "D" N70	Ton	223
Sheet Waterproofing Membrane System	Sq. Yd.	2404
Protective Shield	Sq. Yd.	1400
Protective Coat	Sq. Yd.	175
Deck Slab Repair (Partial Depth)	Sq. Yd.	300
Deck Slab Repair (Full Depth, Type I)	Sq. Yd.	100
Deck Slab Repair (Full Depth, Type II)	Sq. Yd.	20

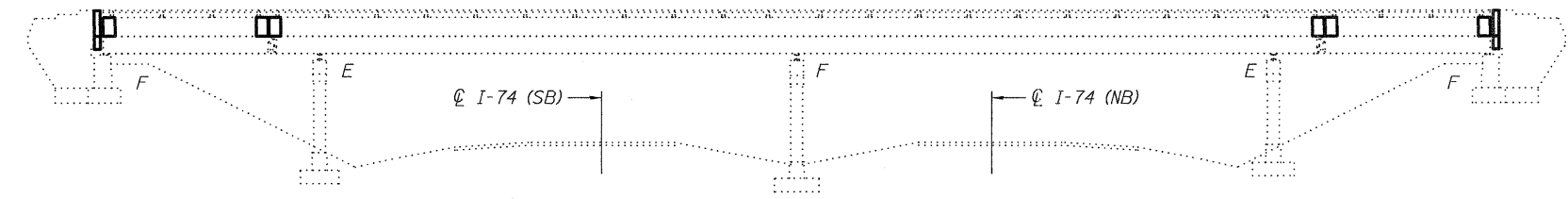

ELEVATION

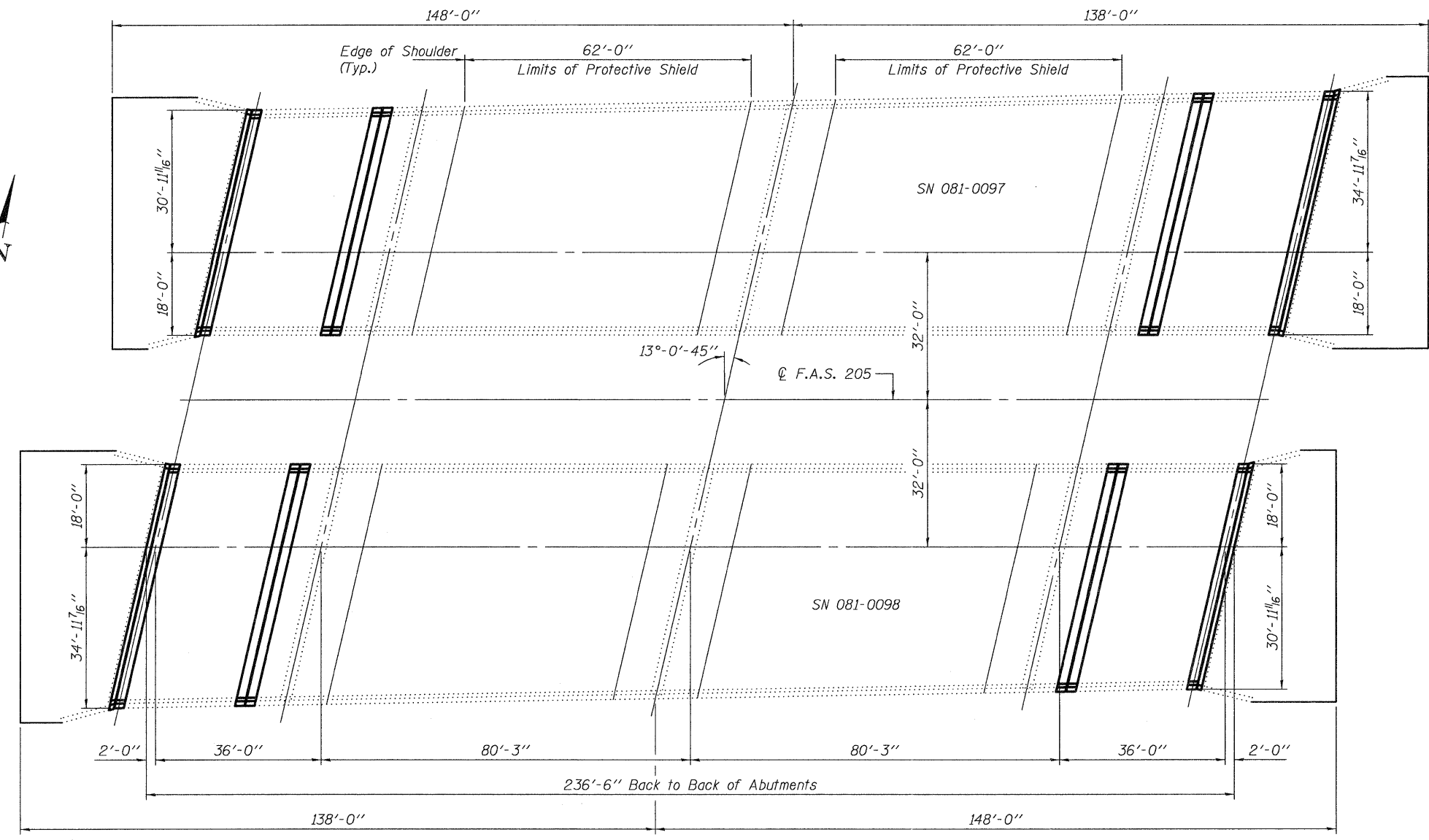

PLAN

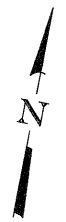

Expires: November 30, 2012

DESIGNED - <i>Jim J. [Signature]</i>	EXAMINED - <i>Jim F. [Signature]</i>	DATE - MARCH 12, 2012
CHECKED - Adrian T. Holloway	PASSED - <i>David Carl Pucey</i>	
DRAWN - Kyle M. Steffen		
CHECKED - I.J.L. ATH		

**STATE OF ILLINOIS
DEPARTMENT OF TRANSPORTATION**

**GENERAL PLAN & ELEVATION
JOHN DEERE ROAD OVER I-74
SN 081-0097 (WB) & 0098 (EB)**

SHEET NO. 1 OF 6 SHEETS

F.A.S. RTE. 205	SECTION (B1-2HB-1M)	COUNTY ROCK ISLAND	TOTAL SHEETS 29	SHEET NO. 18
CONTRACT NO. 64H71			ILLINOIS FED. AID PROJECT	