

STAGE 2 - BRIDGE TYPICAL SECTION

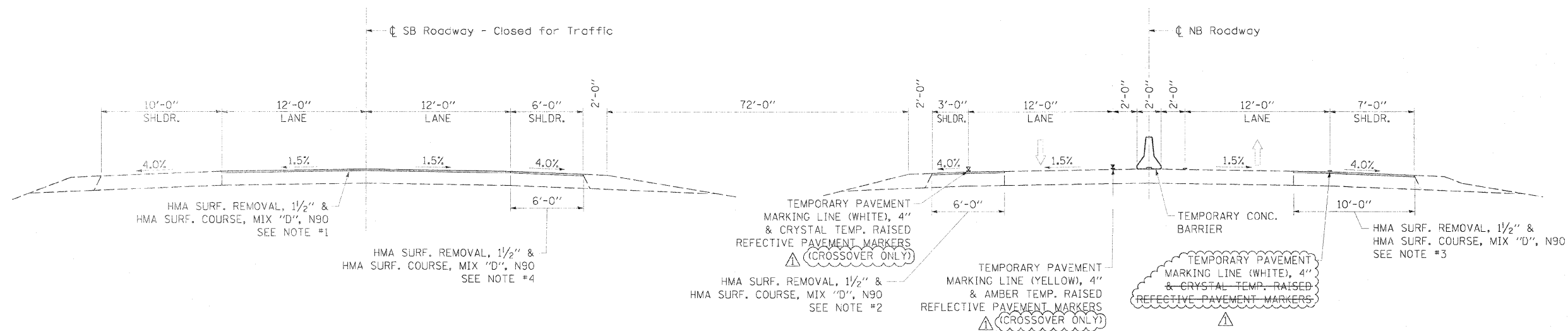

STAGE 2 - ROADWAY TYPICAL SECTION

Construction in this Stage

NOTE #1
 STA. 2418+30± TO STA. 2419+60.0
 STA. 2431+30.0 TO STA. 2431+55.0

NOTE #2
 STA. 2409+92.7 TO STA. 2418+81.0
 STA. 2430+44.0 TO STA. 2438+07.4
 STA. 2440+32.3 TO STA. 2443+00.0

NOTE #3
 STA. 2397+50.0 TO STA. 2418+81.0
 STA. 2430+44.0 TO STA. 2444+00.0

NOTE #4
 STA. 2442+00.0 TO STA. 2447+11.0

FILE NAME =	ISSR NAME = brann89249	DESIGNED - BJB	REVISED - 3/30/2012 BJB
PROJECT WORKSPACE NOT DELETE	41722-ahh-typsec12.dgn	DRAWN - BJB	REVISED -
PL OT SCALE = 5.0000 1/4" = 1'		CHECKED - JMH	REVISED -
DATE = 03/30/2012		DATE = 2/9/12	REVISED -

STATE OF ILLINOIS
 DEPARTMENT OF TRANSPORTATION

TYPICAL SECTIONS - STAGE 2 CONSTRUCTION
 I-39 OVER KISHWAUKEE RIVER

SCALE: SHEET 2 OF 2 SHEETS STA. TO STA.

F.A.I. RTE.	SECTION	COUNTY	TOTAL SHEETS	SHEET NO.
39	(201-1B)M-3	WINNEBAGO	38	7
CONTRACT NO. 64H72				
ILLINOIS FED. AID PROJECT				