

GENERAL NOTES

- THE CONTRACTOR SHALL VERIFY ALL DIMENSIONS AND CONDITIONS IN THE FIELD PRIOR TO CONSTRUCTION AND ORDERING OF MATERIALS.
- ALL AREAS DISTURBED BY THE CONTRACTOR OUTSIDE THE PROPOSED CONSTRUCTION LIMITS SHALL BE SEEDED AS DIRECTED BY THE ENGINEER, AT THE CONTRACTOR'S EXPENSE.
- IN ADDITION TO THE REQUIREMENTS OF ARTICLE 107.16, THE CONTRACTOR SHALL PROTECT THE SURFACE OF ALL BRIDGE DECKS AND BRIDGE APPROACH PAVEMENTS IN A MANNER SATISFACTORY TO THE ENGINEER BEFORE ANY EQUIPMENT IS ALLOWED TO CROSS THE STRUCTURE. PROTECTION SHALL BE PROVIDED FOR ALL EQUIPMENT, AS DEFINED IN ARTICLE 101.17, REGARDLESS IF TRACK MOUNTED OR WHEELED.
- THESE PLANS HAVE BEEN PREPARED USING STANDARD SYMBOLS AS INDICATED IN THESE PLANS, AND THEY SHALL TAKE PRECEDENCE OVER THOSE SHOWN ON STANDARD 000001 IF THERE IS A CONFLICT.
- ANY REFERENCE TO A STANDARD IN THESE PLANS SHALL BE INTERPRETED TO MEAN THE EDITION AS INDICATED BY THE COPY OF THE STANDARD INCLUDED IN THESE PLANS.
- FOR STABILIZATION, ALL TYPE III BARRICADES SHALL REQUIRE A MINIMUM OF EIGHT SAND BAGS PER BARRICADE.**
- THE ENGINEER SHALL BE THE SOLE JUDGE CONCERNING CURING TIME FOR BITUMINOUS SURFACE BEFORE TRAFFIC IS ALLOWED ON THE PAVEMENT.
- FACTORS USED FOR ESTIMATING PLAN QUANTITIES ARE AS FOLLOWS AND SHALL NOT BE USED FOR THE BASIS OF FINAL QUANTITIES:
HOT-MIX ASPHALT - 112 LBS/SQ YD-IN (2.018 TON/CU YD)
BITUMINOUS MATERIALS (PRIME COAT) - 0.00036 TON/SY (ON PAVEMENT)
- THE THICKNESS OF HOT MIX ASPHALT MIXTURE SHOWN ON THE PLANS IS THE NOMINAL THICKNESS. DEVIATIONS FROM THE NOMINAL THICKNESS WILL BE PERMITTED WHEN SUCH DEVIATIONS OCCUR DUE TO IRREGULARITIES IN THE EXISTING SURFACE OR BASE ON WHICH THE HOT MIX ASPHALT MIXTURE IS PLACED.
- PRIOR TO PLACEMENT OF THE FINAL PAVEMENT MARKINGS, THE RESIDENT ENGINEER SHOULD CONTACT THE BUREAU OF OPERATIONS AND ARRANGE FOR INSPECTION AND APPROVAL OF THE PAVEMENT MARKING LAYOUT.
- THE CONTRACTOR SHALL NOTIFY THE ENGINEER OF TRAFFIC OPERATIONS 72 HOURS PRIOR TO THE SHIFTING OF THE NORTHBOUND OR SOUTHBOUND LANES.
- THE VERTICAL PANELS SHOWN ON STANDARD 701416 WILL NOT BE REQUIRED ON THE BRIDGE PARAPET. BARRIER WALL REFLECTORS, IN BOTH DIRECTIONS, SHALL BE INSTALLED IN LIEU OF THE VERTICAL PANELS. BARRIER WALL REFLECTORS SHALL ALSO BE INSTALLED ON THE TEMPORARY CONCRETE BARRIER AS SHOWN ON THE TYPICAL SECTIONS. THE PLACEMENT INTERVAL SHALL BE 40 FEET. THESE BARRIER WALL REFLECTORS WILL NOT BE PAID FOR SEPARATELY, BUT WILL BE CONSIDERED INCLUDED WITH THE COST OF "TRAFFIC CONTROL AND PROTECTION, STANDARD 701416."
- ANY TIME THE CONCRETE BARRIER IS NOT IN THE PROPER POSITION, FLAGGERS SHALL BE IN PLACE TO CONTROL TRAFFIC.**
- THE LIMITS OF "SHOULDER RUMBLE STRIPS, 16 IN." TO BE CONSTRUCTED IN STAGE 2 SHALL BE IDENTICAL TO THOSE INDICATED FOR HOT-MIX ASPHALT SURFACE REMOVAL, 1 1/2".
- ALL BORROW/WASTE/USE SITES MUST BE APPROVED BY THE DEPARTMENT PRIOR TO REMOVING ANY MATERIAL FROM THE PROJECT OR INITIATING ANY EARTHMOVING ACTIVITIES, INCLUDING TEMPORARY STOCKPILING OUTSIDE THE LIMITS OF CONSTRUCTION.
- THE AREA TO BE PRIMED SHALL BE LIMITED TO THAT WHICH CAN BE COVERED WITH HMA ON THE NEXT DAYS PRODUCTIVITY, BUT NO MORE THAN FIVE DAYS IN ADVANCE OF THE PLACEMENT OF THE HMA, UNLESS APPROVED BY THE ENGINEER.
- INSTALL RUMBLE STRIPS IN ALL SHOULDERS IN ACCORDANCE WITH STATE STANDARD 642061. RUMBLE STRIPS SHALL BE PLACED ON SHOULDERS ON BOTH SIDES OF THE PAVEMENT.
- THIS WORK SHALL BE DONE IN ACCORDANCE WITH SECTION 704 OF THE STANDARD SPECIFICATIONS. TEMPORARY CONCRETE BARRIER WILL BE MEASURED IN FEET ALONG THE CENTERLINE OF THE BARRIER AND SHALL INCLUDE THE COST OF RENTING/OWNING THE BARRIER FOR THE TIME REQUIRED ON THE JOB PLUS HAULING TO AND FROM THE PROJECT SITE, AS WELL AS ONE PLACEMENT AND REMOVAL FROM THE ROADWAY IN ACCORDANCE WITH SECTION 704 OF THE STANDARD SPECIFICATION. THIS SHALL BE PAID FOR AT THE CONTRACT UNIT PRICE PER FOOT FOR TEMPORARY CONCRETE BARRIER.

RELOCATE TEMPORARY CONCRETE BARRIER WILL BE PAID FOR IN FEET ALONG THE CENTERLINE OF THE BARRIER, AND WILL BE PAID FOR EACH TIME THE BARRIER IS REQUIRED BY STAGING TO BE PICKED UP AND MOVED TO A DIFFERENT LOCATION ON THE PROJECT, WHETHER IT IS TO ANOTHER LOCATION ON THE ROADWAY OR TO A STORAGE/STAGING LOCATION FOR THE PROJECT. THIS SHALL BE PAID FOR AT THE CONTRACT UNIT PRICE PER FOOT FOR RELOCATE TEMPORARY CONCRETE BARRIER.
- FERTILIZER NUTRIENTS SHALL BE APPLIED AT THE RATE SPECIFIED IN SECTIONS 250 AND 252 OF THE STANDARD SPECIFICATIONS. THIS SHALL BE INCLUDED IN THE COST OF THE SEEDING OR SODDING.

GENERAL NOTES

- PREVIOUSLY PUGMILLED STOCKPILES OF "TYPE A" OLDER THAN 1 MONTH WILL NOT BE APPROVED FOR USE UNTIL A MOISTURE CHECK IS RUN TO VERIFY MOISTURE CONTENT. MATERIAL SHIPPED TO PROJECTS WITHOUT BEING TESTED WILL NOT BE ACCEPTED.
- CONNECTING BANDS FOR CORRUGATED METAL PIPES SHALL BE METAL AND SHALL BE COATED WITH THE SAME MATERIAL AS THE PIPE SECTIONS. THE CONNECTING BANDS SHALL BE A MINIMUM OF 18" WIDE.
- CONTRACTOR SHALL LOCATE AERIAL CONDUCTORS TO LIGHTING CONTROLLER AS APPROVED BY THE ENGINEER.
- THE REMOVAL OF TEMPORARY RAISED REFLECTIVE PAVEMENT MARKERS SHALL BE INCLUDED IN THE COST FOR THE PAY ITEM "TEMPORARY RAISED REFLECTIVE PAVEMENT MARKER".
- FOR WORK REQUIRED TO UPGRADE THE CROSSOVER PAVEMENT, NO LANE CLOSURES OR TRAFFIC RESTRICTIONS WILL BE ALLOWED TO OCCUR ON FRIDAYS.
- COMMITMENTS:
NONE AS OF APRIL 27, 2012

UTILITY NOTES

- THE CONTRACTOR SHALL BE RESPONSIBLE FOR PROTECTING UTILITY PROPERTY FROM CONSTRUCTION OPERATIONS AS OUTLINED IN ARTICLE 107.31 OF THE STANDARD SPECIFICATIONS. A MINIMUM OF 48 HOURS NOTICE IS REQUIRED FOR NON-EMERGENCY WORK.
- MEMBERS OF JULIE KNOWN TO BE WITHIN OR IMMEDIATELY ADJACENT TO THE LIMITS OF THE IMPROVEMENT ARE:

ELECTRIC:
COMMONWEALTH EDISON COMPANY
ATTN: DAVE SCHACHT 630-437-2129
123 ENERGY AVENUE
ROCKFORD, IL 61109

CABLE TELEVISION:
INSIGHT COMMUNICATIONS
ATTN: MIKE OWENS, DONNA ZIES, TOM YUCCAS
815-395-8977
4450 KISHWAUKEE STREET
ROCKFORD, IL 61109

NATURAL GAS:
NICOR GAS COMPANY
ATTN: CONNIE LANE 630-983-8676
1844 FERRY ROAD
NAPERVILLE, IL 60563
- NON-MEMBERS OF JULIE KNOWN TO BE WITHIN OR IMMEDIATELY ADJACENT TO THE LIMITS OF THE IMPROVEMENT ARE:

GOVERNMENT:
IDOT - DISTRICT 2
ATTN: KYLE LORENZ 815-284-5469
819 DEPOT AVENUE
DIXON, IL 61021
- ANY DAMAGE TO THE UNDERGROUND FACILITIES CAUSED BY THE CONTRACTOR SHALL BE REPAIRED TO THE SATISFACTION OF THE DEPARTMENT AT THE CONTRACTOR'S EXPENSE, INCLUDING TEMPORARY REPAIRS WHICH MAY BE REQUIRED TO KEEP THE FACILITY OPERATIONAL WHILE MATERIAL IS BEING OBTAINED TO MAKE PERMANENT REPAIRS. UTILITY ADJUSTMENTS (IF REQUIRED) SHALL BE MADE BY THE UTILITY COMPANIES UNLESS NOTED OTHERWISE.
- THE LOCATIONS OF EXISTING UTILITIES SHOWN ON THE PLANS ARE BASED ON FIELD INVESTIGATION AND THE BEST INFORMATION AVAILABLE. THE CONTRACTOR SHALL OBTAIN EXACT UTILITY LOCATIONS FROM THE UTILITY COMPANIES AND BY FIELD INSPECTION. THE FOLLOWING STANDARD UTILITY DEPTHS WERE USED IF INFORMATION WAS UNAVAILABLE:

TELEPHONE/FIBER OPTIC - 2 FEET
GAS - 2.5 FEET
CABLE TV - 1.5 FEET
ELECTRIC - 3 FEET
SANITARY SEWER - 2.5 FEET
WATER - 4 FEET
- ALL ELECTRIC LINES WILL REMAIN ENERGIZED DURING CONSTRUCTION UNLESS OTHERWISE COORDINATED WITH THE UTILITY COMPANY.

HIGHWAY STANDARDS

000001-06	STANDARD SYMBOLS, ABBREVIATIONS AND PATTERNS
001001-02	AREAS OF REINFORCEMENT BARS
001006	DECIMAL OF AN INCH AND OF A FOOT
280001-06	TEMPORARY EROSION CONTROL SYSTEMS
420001-07	PAVEMENT JOINTS
420101-04	24' JOINTED PCC PAVEMENT
420106-04	36' JOINTED PCC PAVEMENT
542511-02	INLET BOX TYPE 24 C
630001-10	STEEL PLATE BEAM GUARDRAIL
630301-05	SHOULDER WIDENING FOR TYPE 1 (SPECIAL) GUARDRAIL TERMINALS
631031-10	TRAFFIC BARRIER TERMINAL, TYPE 6
635006-03	REFLECTOR AND TERMINAL MARKER PLACEMENT
635011-02	REFLECTOR MARKER AND MOUNTING DETAILS
638001-02	GLARE SCREEN BLADES
642001-02	SHOULDER RUMBLE STRIPS, 16 IN.
701101-02	OFF-RD OPERATIONS, MULTILANE, 15' TO 24" FROM PAVEMENT EDGE
701106-02	OFF-RD OPERATIONS, MULTILANE, MORE THAN 15' AWAY
701400-05	APPROACH TO LANE CLOSURE, FREEWAY/EXPRESSWAY
701406-06	LANE CLOSURE, FREEWAY/EXPRESSWAY, DAY OPERATIONS ONLY
701411-08	LANE CLOSURE, MULTILANE, AT ENTRANCE OR EXIT RAMP, FOR SPEEDS ≥ 45 MPH
701416-07	LANE CLOSURE, FREEWAY/EXPRESSWAY, WITH CROSSOVER AND BARRIER
701426-04	LANE CLOSURE, MULTILANE, INTERMITTENT OR MOVING OPER., FOR SPEEDS ≥ 45 MPH
701901-02	TRAFFIC CONTROL DEVICES
704001-07	TEMPORARY CONCRETE BARRIER
720011-01	METAL POSTS FOR SIGNS, MARKERS & DELINEATORS
728001-01	TELESCOPING STEEL SIGN SUPPORT
729001-01	APPLICATIONS OF TYPES A & B METAL POSTS (FOR SIGNS & MARKERS)
780001-03	TYPICAL PAVEMENT MARKINGS
781001-03	TYPICAL APPLICATIONS RAISED REFLECTIVE PAVEMENT MARKERS
825001-01	LIGHTING CONTROLLER POLE MOUNTED, 240V

HOT-MIX ASPHALT MIXTURE TABLES

MIXTURE USE(S):	ROADWAY AND SHOULDER SURFACE
MIXTURE	HOT-MIX ASPHALT SURFACE COURSE, MIX "D", N90
AC/PG:	PG 64-22
RAP % (MAX.):	0
DESIGN AIR VOIDS:	4.2% @ N90
MIXTURE COMPOSITION: (GRADATION MIXTURE)	IL-9.5 OR IL-12.5
FRICTION AGGREGATE:	D
20 YEAR ESAL	N/A

MIXTURE USE(S):	BRIDGE SURFACE
MIXTURE	POLYMERIZED HOT-MIX ASPHALT SURFACE COURSE, MIX "E", N105
AC/PG:	SBS PG 70-22
RAP % (MAX.):	N/A
DESIGN AIR VOIDS:	4.0% @ N105
MIXTURE COMPOSITION: (GRADATION MIXTURE)	IL-9.5 OR IL-12.5
FRICTION AGGREGATE:	E
20 YEAR ESAL	46.2

MIXTURE USE(S):	CROSSOVER SHOULDER SURFACE
MIXTURE	HOT-MIX ASPHALT SURFACE COURSE, MIX "C", N50
AC/PG:	PG 64-22
RAP % (MAX.):	10
DESIGN AIR VOIDS:	4.0% @ N50
MIXTURE COMPOSITION: (GRADATION MIXTURE)	IL-9.5 OR IL-12.5
FRICTION AGGREGATE:	C
20 YEAR ESAL	46.2

MIXTURE USE(S):	CROSSOVER SHOULDER
MIXTURE	HOT-MIX ASPHALT SHOULDER
AC/PG:	PG 58-22
RAP % (MAX.):	50
DESIGN AIR VOIDS:	4.0% @ N30
MIXTURE COMPOSITION: (GRADATION MIXTURE)	HMA SHOULDERS
FRICTION AGGREGATE:	NONE
20 YEAR ESAL	46.2

SUMMARY OF QUANTITIES

CONSTRUCTION
CODE
90% FED
10% STATE
0014
URBAN

*SPECIALTY ITEM

CODE NO.	ITEM	UNIT	TOTAL QUANTITY
70100410	TRAFFIC CONTROL AND PROTECTION, STANDARD 701416	EACH	1
70100420	TRAFFIC CONTROL AND PROTECTION, STANDARD 701411	EACH	1
70100700	TRAFFIC CONTROL AND PROTECTION, STANDARD 701406	L SUM	1
70300220	TEMPORARY PAVEMENT MARKING - LINE 4"	FOOT	49,055
70301000	WORK ZONE PAVEMENT MARKING REMOVAL	SQ FT	16,351
70400100	TEMPORARY CONCRETE BARRIER	FOOT	4,525.0
70400200	RELOCATE TEMPORARY CONCRETE BARRIER	FOOT	4,525.0
70500100	TEMPORARY STEEL PLATE BEAM GUARDRAIL, TYPE A	FOOT	250
70500665	TEMPORARY TRAFFIC BARRIER TERMINAL, TYPE 6	EACH	1
*72400200	REMOVE SIGN PANEL ASSEMBLY - TYPE B	EACH	1
*72400600	RELOCATE SIGN PANEL ASSEMBLY - TYPE B	EACH	1
*78005110	EPOXY PAVEMENT MARKING - LINE 4"	FOOT	18,091
*78005130	EPOXY PAVEMENT MARKING - LINE 6"	FOOT	1,120
*78005140	EPOXY PAVEMENT MARKING - LINE 8"	FOOT	234

SUMMARY OF QUANTITIES

CONSTRUCTION
CODE
90% FED
10% STATE
0014
URBAN

*SPECIALTY ITEM

CODE NO.	ITEM	UNIT	TOTAL QUANTITY
78100100	RAISED REFLECTIVE PAVEMENT MARKER	EACH	29
78100105	RAISED REFLECTIVE PAVEMENT MARKER (BRIDGE)	EACH	60
78100200	TEMPORARY RAISED REFLECTIVE PAVEMENT MARKER	EACH	336
78200410	GUARDRAIL MARKERS, TYPE A	EACH	7
78201000	TERMINAL MARKER - DIRECT APPLIED	EACH	1
78300100	PAVEMENT MARKING REMOVAL	SQ FT	5,626
78300200	RAISED REFLECTIVE PAVEMENT MARKER REMOVAL	EACH	58
X0322392	BEVELED PIPE AND GUARD	EACH	2
*X0325712	RELOCATE EXISTING ELECTRICAL SYSTEM	L SUM	1
X5810100	WATERPROOFING MEMBRANE SYSTEM (SPECIAL)	SQ YD	9,692
*X6330075	RELOCATE TRAFFIC BARRIER TERMINAL, (TEMPORARY)	EACH	2
X6380205	TEMPORARY MODULAR GLARE SCREEN	FOOT	450
*X7050169	TEMPORARY TRAFFIC BARRIER TERMINAL, TYPE 1, SPECIAL (FLARED)	EACH	1
*X8410102	TEMPORARY LIGHTING SYSTEM	L SUM	1

Rev. 4-12-12

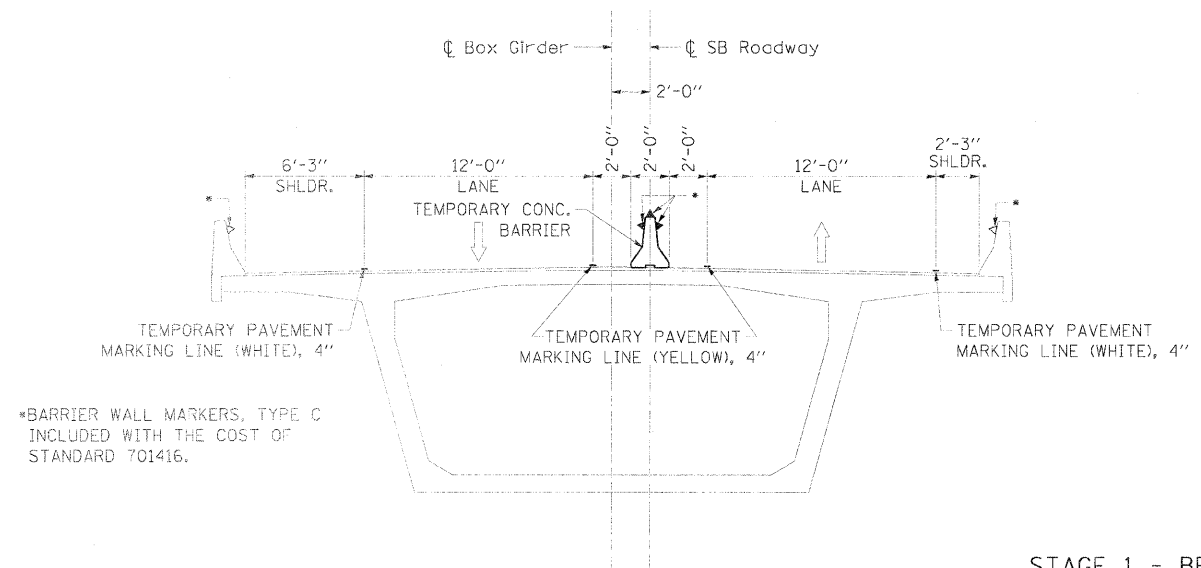

*BARRIER WALL MARKERS, TYPE C INCLUDED WITH THE COST OF STANDARD 701416.

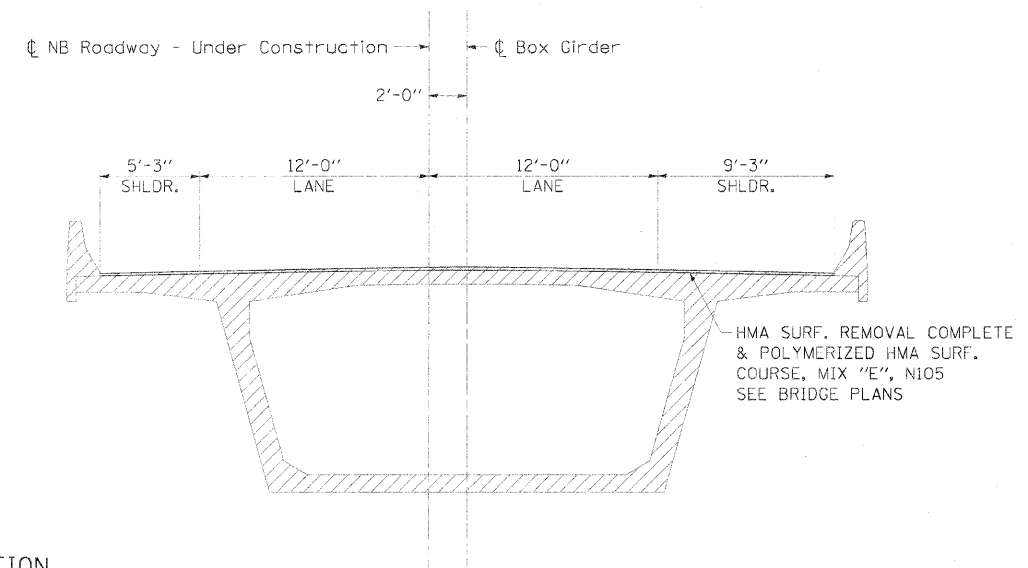

STAGE 1 - BRIDGE TYPICAL SECTION

Construction in this Stage

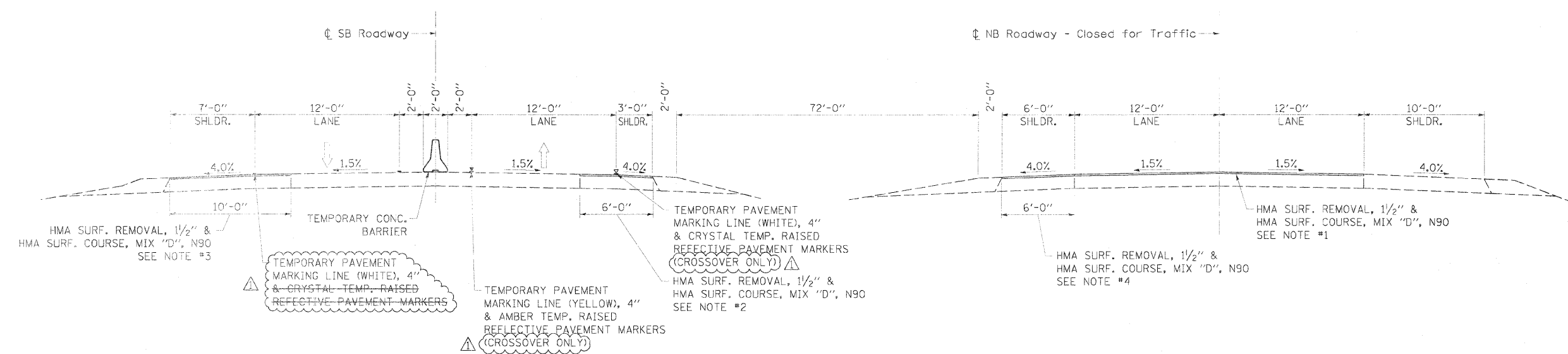

STAGE 1 - ROADWAY TYPICAL SECTION

NOTE:

SEE CROSSOVER PAVING PLAN SHEET FOR WIDENING DETAILS THRU THE CROSSOVERS. STA. 2405+33.9 TO STA. 2409+92.7

NOTE #1
STA. 2430+44.0 TO STA. 2430+69.0

NOTE #2
STA. 2409+92.7 TO STA. 2419+60.0
STA. 2431+30.0 TO STA. 2438+07.4
STA. 2440+32.3 TO STA. 2442+00.0

NOTE #3
STA. 2405+00.0 TO STA. 2419+60.0
STA. 2431+30.0 TO STA. 2449+00.0

NOTE #4
STA. 2443+00.0 TO STA. 2447+11.0

FILE NAME =	USER NAME = brenn0214	DESIGNED - BJB	REVISED - 3/30/2012 BJB
c:\pwise\work\do_not_delete\ans59294\324-72-shu-typical01.dgn		DRAWN - BJB	REVISED -
		CHECKED - JMH	REVISED -
		DATE - 2/9/12	REVISED -

**STATE OF ILLINOIS
DEPARTMENT OF TRANSPORTATION**

**TYPICAL SECTIONS - STAGE 1 CONSTRUCTION
I-39 OVER KISHWAUKEE RIVER**

SCALE: SHEET 1 OF 2 SHEETS STA. TO STA.

F.A.I. RTE.	SECTION	COUNTY	TOTAL SHEETS	SHEET NO.
39	(201-1B/M-3	WINNEBAGO	38	6
CONTRACT NO. 64H72				
ILLINOIS FED. AID PROJECT				

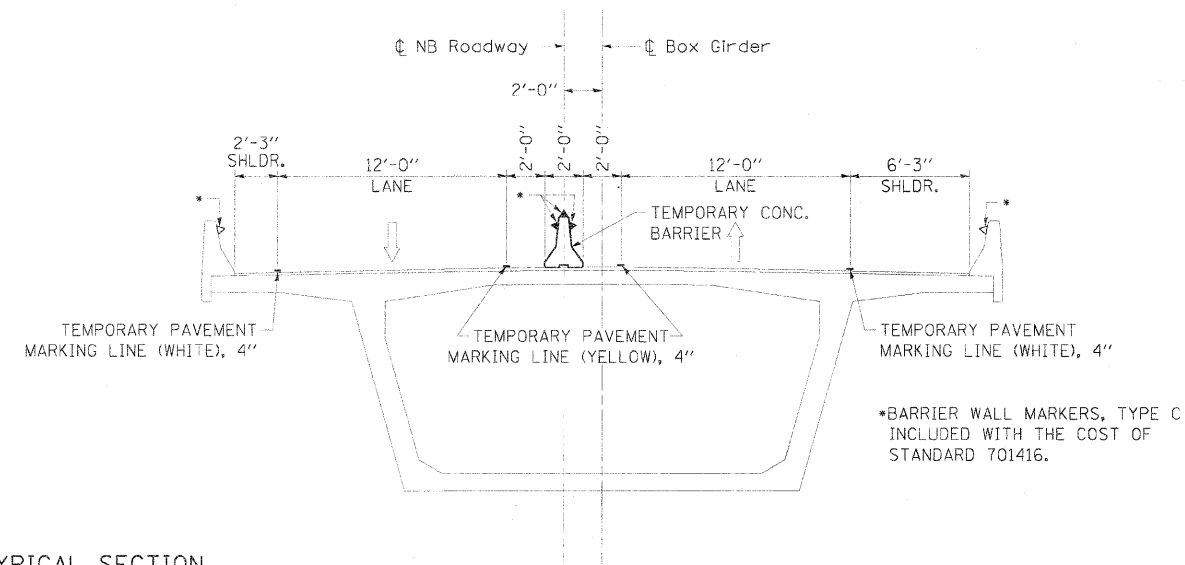
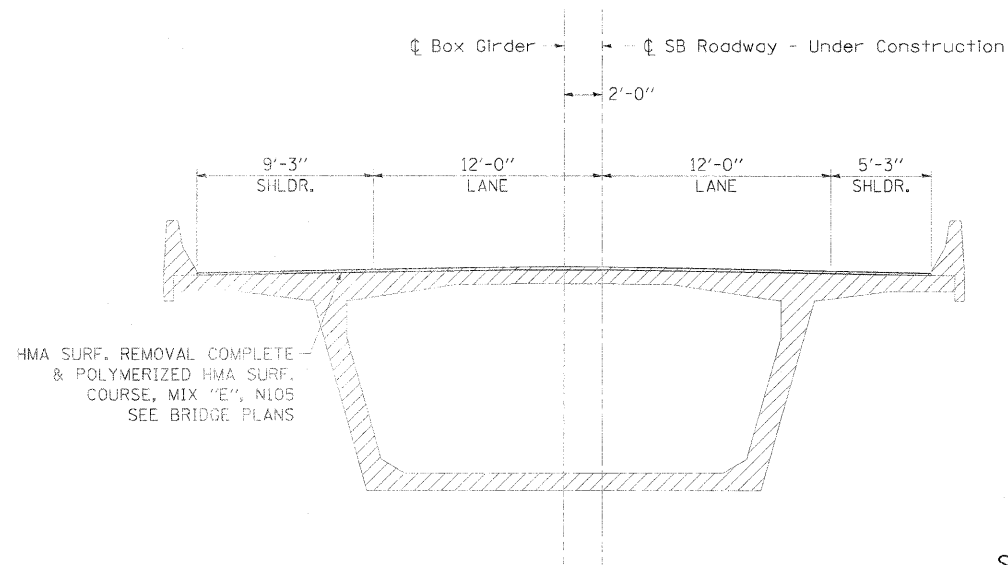

STAGE 2 - BRIDGE TYPICAL SECTION

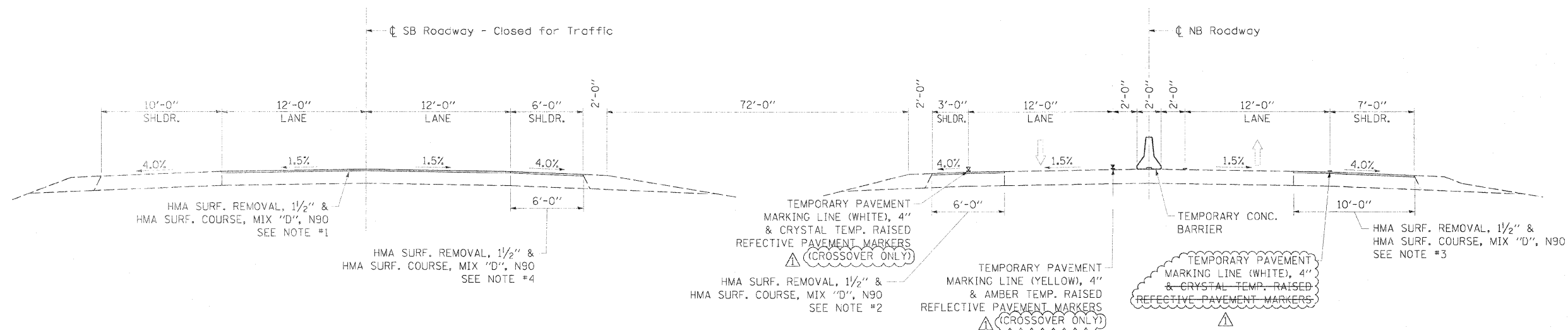

STAGE 2 - ROADWAY TYPICAL SECTION

Construction in this Stage

NOTE #1
 STA. 2418+30± TO STA. 2419+60.0
 STA. 2431+30.0 TO STA. 2431+55.0

NOTE #2
 STA. 2409+92.7 TO STA. 2418+81.0
 STA. 2430+44.0 TO STA. 2438+07.4
 STA. 2440+32.3 TO STA. 2443+00.0

NOTE #3
 STA. 2397+50.0 TO STA. 2418+81.0
 STA. 2430+44.0 TO STA. 2444+00.0

NOTE #4
 STA. 2442+00.0 TO STA. 2447+11.0

FILE NAME =	ISSR NAME = brann89249	DESIGNED - BJB	REVISED - 3/30/2012 BJB
PROJECT WORKSPACE NOT DELETE	41722-ahh-typsect1.dgn	DRAWN - BJB	REVISED -
PL OT SCALE = 5.0000 1/4" = 1'		CHECKED - JMH	REVISED -
DATE = 03/30/2012		DATE 2/9/12	REVISED -

STATE OF ILLINOIS
 DEPARTMENT OF TRANSPORTATION

TYPICAL SECTIONS - STAGE 2 CONSTRUCTION
 I-39 OVER KISHWAUKEE RIVER

SCALE: SHEET 2 OF 2 SHEETS STA. TO STA.

F.A.I. RTE.	SECTION	COUNTY	TOTAL SHEETS	SHEET NO.
39	(201-1B)M-3	WINNEBAGO	38	7
CONTRACT NO. 64H72				
ILLINOIS FED. AID PROJECT				

PAVEMENT MARKING SCHEDULE														
LOCATION		70300220	70301000	78005110	78005130	78005140	78100100	78100105	78100200	78300100	78300200	COLOR	NOTE	LOCATION
		TEMPORARY PAVEMENT MARKING - LINE 4"	WORK ZONE PAVEMENT MARKING REMOVAL	EPOXY PAVEMENT MARKING - LINE 4"	EPOXY PAVEMENT MARKING - LINE 6"	EPOXY PAVEMENT MARKING - LINE 8"	RAISED REFLECTIVE PAVEMENT MARKER	RAISED REFLECTIVE PAVEMENT MARKER (BRIDGE)	TEMPORARY RAISED REFLECTIVE PAVEMENT MARKER	PAVEMENT MARKING REMOVAL	RAISED REFLECTIVE PAVEMENT MARKER REMOVAL			
BEGIN STATION	END STATION	FOOT	SQ FT	FOOT	FOOT	FOOT	EACH	EACH	EACH	SQ FT	EACH			
STAGE 1														
2381+00.00	2381+00.00	2000	667									White	Solid edge line	NB lane on RT
16+43.50	20+37.70	394	131									Yellow	Solid edge line	Baxter Rd on-ramp, LT
16+43.50	24+87.60	844	281									White	Solid edge line	Baxter Rd on-ramp, RT
2385+50.00	2444+87.00	5954	1985									White	Solid edge line	NB lane on RT thru crossover
2401+00.00	2447+00.00	4615	1538									Yellow	Solid edge line	NB lane on LT thru crossover
2405+35.00	2448+62.50	4328	1443									White	Solid edge line	SB lane on RT
2407+00.00	2473+50.00	6661	2220									Yellow	Solid edge line	SB lane on LT
2361+00.00	2371+00.00									83				NB center skip
2377+06.00	2378+23.00									78				NB gore
16+43.50	17+60.20									78				On ramp gore
2401+00.00	2404+00.00									100				NB edge LT
2443+00.00	2447+00.00									133				NB edge LT
2405+35.00	2448+62.50									1443				SB edge RT
2405+00.00	2442+00.00									1233				SB edge LT
2463+50.00	2473+50.00									83				SB center skip
2361+00.00	2371+00.00										13			NB center skip
2418+81.00	2430+69.00										15			NB bridge & approach
2463+50.00	2473+50.00										13			SB center skip
2361+00.00	2380+00.00									48				NB RT
2380+00.00	2381+00.00									3				NB RT
2385+50.00	2401+00.00									39				NB RT
16+43.50	19+37.20									7				Ent-Ramp-Lt
16+43.50	19+37.20									7				Ent-Ramp-Rt
19+37.20	20+38.00									3				Ent-Ramp-Lt
19+37.20	24+88.00									14				Ent-Ramp-Rt
2401+00.00	2409+00.00	2409+38.20								40	42			NB LT
2401+00.00	2409+38.20									42				NB RT
2409+38.20	2410+00.00									2				NB RT
2405+35.00	2410+00.00									12				SB RT
2410+00.00	2416+54.40									16				NB RT
2410+00.00	2417+77.20									19				SB RT
2433+05.50	2438+64.99									14				NB RT
2433+35.20	2440+00.00									17				SB RT
2438+61.90	2440+00.00									7				NB LT
2438+61.90	2440+00.00									7				NB RT
2440+00.00	2470+00.00									75				SB LT
2440+00.00	2448+62.50									22				SB RT
2440+00.00	2447+00.00									35				NB LT
2440+00.00	2444+87.00	2447+00.00								24	35			NB RT
SUBTOTAL		24796	8265	0	0	0	0	0	0	444	168			



PAVEMENT MARKING SCHEDULE													
LOCATION	70300220	70301000	78005110	78005130	78005140	78100100	78100105	78100200	78300100	78300200	COLOR	NOTE	LOCATION
	TEMPORARY PAVEMENT MARKING - LINE 4"	WORK ZONE PAVEMENT MARKING REMOVAL	EPOXY PAVEMENT MARKING - LINE 4"	EPOXY PAVEMENT MARKING - LINE 6"	EPOXY PAVEMENT MARKING - LINE 8"	RAISED REFLECTIVE PAVEMENT MARKER	RAISED REFLECTIVE PAVEMENT MARKER (BRIDGE)	TEMPORARY RAISED REFLECTIVE PAVEMENT MARKER	PAVEMENT MARKING	RAISED REFLECTIVE PAVEMENT MARKER REMOVAL			
	FOOT	SQ FT	FOOT	FOOT	FOOT	EACH	EACH	EACH	SQ FT	EACH			
STAGE 2													
2361+00.00	2441+12.50	8013	2671								Yellow	Solid edge line	NB lane on LT
2398+00.00	2443+62.50	4563	1521								White	Solid edge line	NB lane on RT
2401+00.00	2447+00.00	4615	1538								Yellow	Solid edge line	SB lane on LT thru crossover
2403+13.00	2473+50.00	7068	2356								White	Solid edge line	SB lane on RT thru crossover
2398+00.00	2443+62.50			4563							White		NB outside edge
2401+00.00	2447+00.00			4600							Yellow		NB inside edge
2405+35.00	2448+62.50			4328							White		SB outside edge
2401+00.00	2447+00.00			4600							Yellow		SB inside edge
2361+00.00	2371+00.00				250						White		NB center skip
2419+11.00	2430+70.00				290						White		NB center skip
2418+30.00	2431+55.00				330						White		SB center skip
2463+50.00	2473+50.00				250						White		SB center skip
2377+06.00	2378+23.00					117					White		NB gore edge
16+43.50	17+60.20					117					White		Baster Ramp gore edge
2361+00.00	2371+00.00						13						NB lanes
2430+44.00	2430+69.00						1						NB lanes
2418+30.00	2419+60.00						2						SB lanes
2463+50.00	2473+50.00						13						SB lanes
2418+81.00	2430+44.00							30					NB Bridge
2419+60.00	2431+30.00							30					SB Bridge
2398+00.00	2419+11.00								704				NB edge RT
2430+01.00	2443+62.50								454				NB edge RT
2404+00.00	2419+11.00								504				NB edge LT
2430+01.00	2443+00.00								433				NB edge LT
2401+00.00	2405+00.00								133				SB edge LT
2442+00.00	2447+00.00								167				SB edge LT
2418+30.00	2431+55.00									17			SB bridge & approach
2361+00.00	2380+00.00								48				NB LT
2380+00.00	2410+00.00								76				NB LT
2398+00.00	2410+00.00								30				NB RT
2401+00.00	2409+38.20								42				SB LT
2403+13.00	2409+38.20								34	42			SB RT
2409+38.20	2410+00.00								2				SB RT
2410+00.00	2415+97.70								15				NB RT
2410+00.00	2419+81.00								22				SB RT
2430+44.00	2440+00.00								24				NB RT
2433+37.20	2438+61.90								13				SB RT
2439+00.00	2440+00.00								5				SB LT
2438+61.90	2440+00.00								7	7			SB LT
2438+61.90	2440+00.00								7				SB RT
2440+00.00	2443+62.50								9				NB RT
2440+00.00	2447+00.00								35				SB LT
2440+00.00	2447+00.00								35				SB RT
2447+00.00	2470+00.00								58				SB RT
2470+00.00	2473+50.00								9				SB RT
	SUBTOTAL	24259	8086	18091	1120	234	29	60	418 168	2395	17		
	TOTALS	49055	16351	18091	1120	234	29	60	820 336	5626	58		



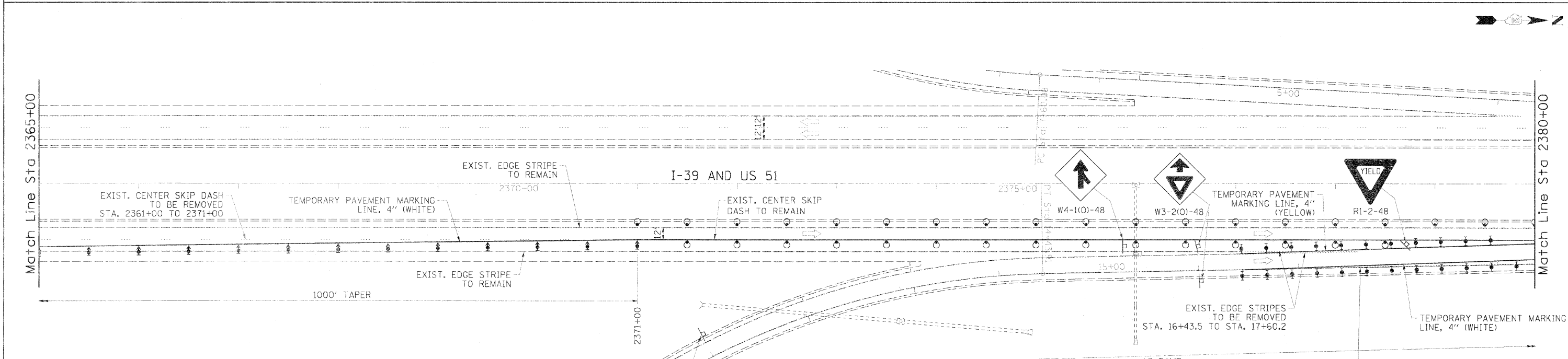
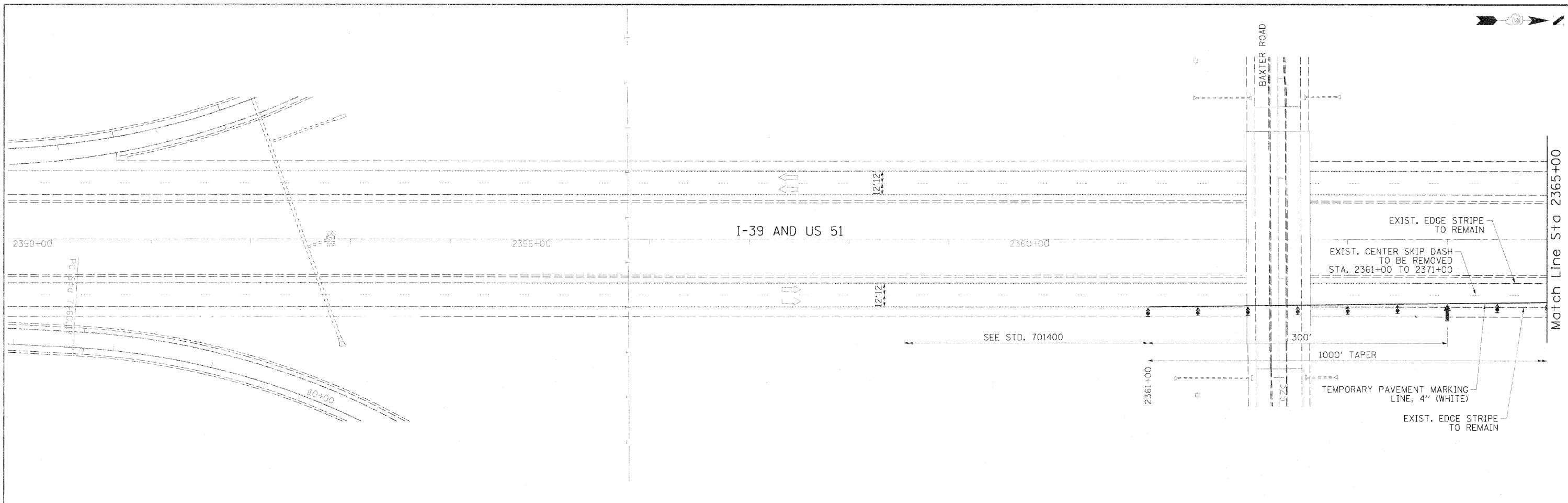

- LEGEND**
- ARROW BOARD
 - WORK AREA
 - SIGN
 - DIRECTION INDICATOR BARRICADE WITH STEADY BURN MONODIRECTIONAL LIGHT
 - TYPE II BARRICADE WITH STEADY BURN MONODIRECTIONAL LIGHT
 - DRUM WITH STEADY BURN MONODIRECTIONAL LIGHT
 - VERTICAL PANEL (BACK TO BACK)
 - TYPE III BARRICADE WITH FLASHING LIGHTS
 - TEMPORARY CONCRETE BARRIER



NOTE:
REFER TO STANDARDS 701400, 701411 &
701416 FOR ADDITIONAL REQUIREMENTS.

TEMP. RAISED REFLECTIVE PAVEMENT MARKERS
40' INTERVAL:
NB RT. STA. 2361+00.0 TO STA. 2380+00.0
ENT. RAMP LT. STA. 16+43.5 TO STA. 19+37.2
ENT. RAMP RT. STA. 16+43.5 TO STA. 19+37.2

FILE NAME -	USER NAME -	DESIGNED - BJB	REVISED - 3/30/2012 BJB	STATE OF ILLINOIS DEPARTMENT OF TRANSPORTATION	TRAFFIC CONTROL PLAN - STAGE 1 I-39 OVER KISHWAUKEE RIVER	F.A.I. RTE. 39	SECTION (201-1B)M-3	COUNTY WINNBAGO	TOTAL SHEETS 38	SHEET NO. 12
CONTRACT NO. 64H72	CONTRACT NO. 64H72	CONTRACT NO. 64H72	CONTRACT NO. 64H72			ILLINOIS FED. AID PROJECT				
SCALE: 1" = 50'	SHEET 1 OF 5 SHEETS	STA. 2350+00 TO STA. 2380+00								

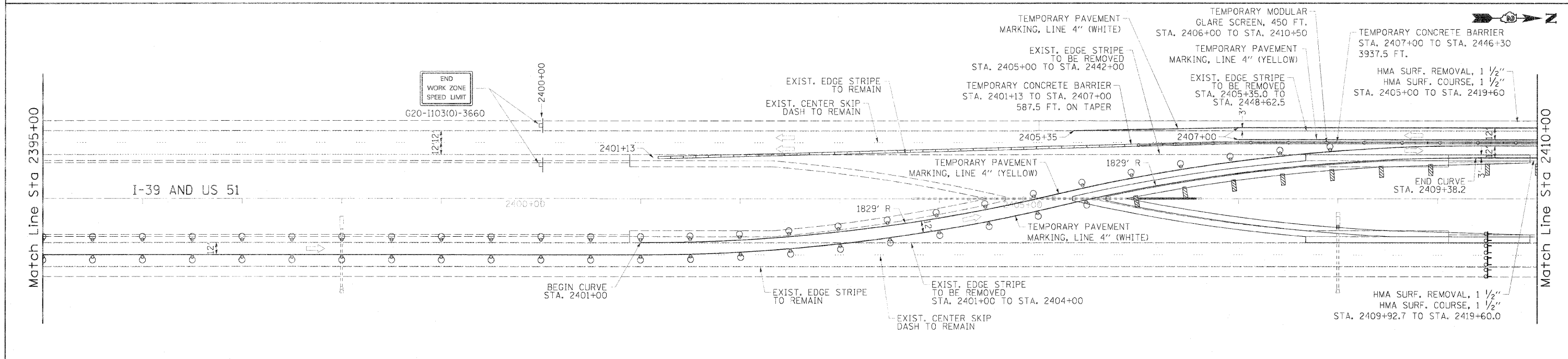
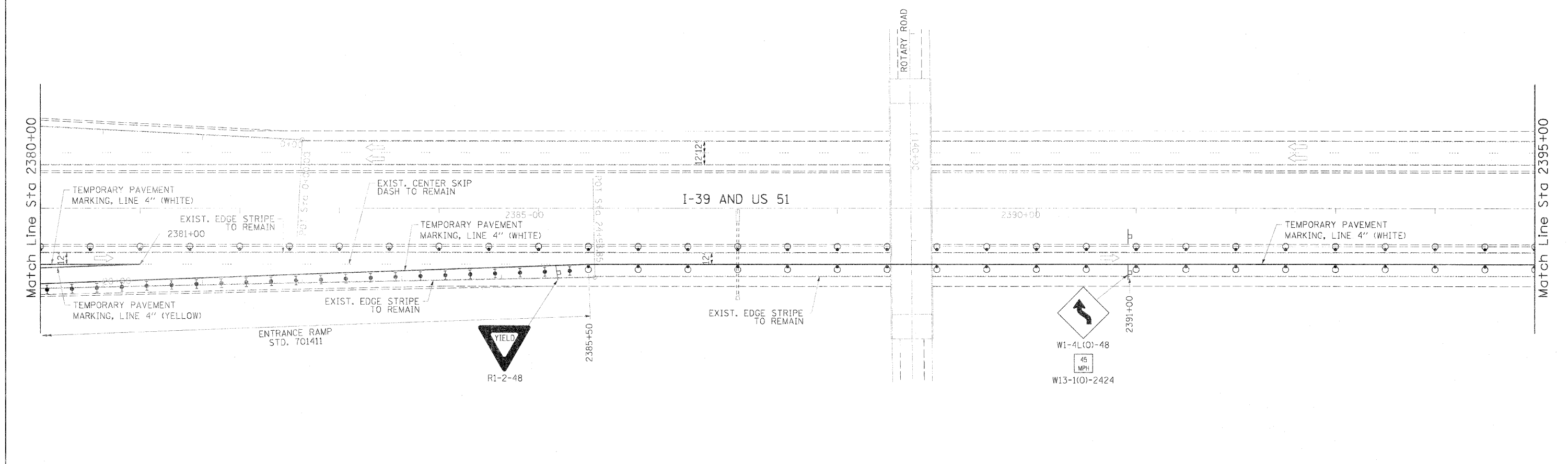
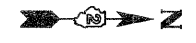

LEGEND

- ARROW BOARD
- WORK AREA
- SIGN
- DIRECTION INDICATOR BARRICADE WITH STEADY BURN MONODIRECTIONAL LIGHT
- TYPE II BARRICADE WITH STEADY BURN MONODIRECTIONAL LIGHT
- DRUM WITH STEADY BURN MONODIRECTIONAL LIGHT
- VERTICAL PANEL (BACK TO BACK)
- TYPE III BARRICADE WITH FLASHING LIGHTS
- TEMPORARY CONCRETE BARRIER
- TEMPORARY MODULAR GLARE SCREEN

NOTE:
 1. REFER TO STANDARDS 701400, 701411 & 701416 FOR ADDITIONAL REQUIREMENTS.
 2. SEE CROSSOVER PAVING PLAN SHEET FOR PAVEMENT WIDENING, PAVED SHOULDER REMOVAL & PAVEMENT REMOVAL.

TEMP. RAISED REFLECTIVE PAVEMENT MARKERS

40' INTERVAL:
 NB RT: STA. 2380+00.0 TO STA. 2381+00.0
 NB RT: STA. 2385+50.0 TO STA. 2401+00.0
 NB RT: STA. 2409+38.2 TO STA. 2410+00.0
 SB RT: STA. 2405+35.0 TO STA. 2410+00.0
 ENT. RAMP LT: STA. 19+37.2 TO STA. 20+38.0
 ENT. RAMP RT: STA. 19+37.2 TO STA. 24+88.0

20' INTERVAL:
 NB LT: STA. 2401+00.0 TO STA. 2409+38.2
 NB RT: STA. 2401+00.0 TO STA. 2409+38.2



FILE NAME =	USER NAME = brann00248	DESIGNED - BJB	REVISED - 3/30/2012 BJB
c:\pwise\work\do_not_delete\vdms99254\12254R12-shrns\tagmgp2.dgn		DRAWN - BJB	REVISED -
PLOT SCALE = 50.0000 1/2 in.		CHECKED - JMH	REVISED -
PLOT DATE = 03/30/2012		DATE 2/9/12	REVISED -

**STATE OF ILLINOIS
DEPARTMENT OF TRANSPORTATION**

**TRAFFIC CONTROL PLAN - STAGE 1
I-39 OVER KISHWAUKEE RIVER**

SCALE: 1" = 50' SHEET 2 OF 5 SHEETS STA. 2380+00 TO STA. 2410+00

F.A.I. RTE. 39	SECTION (201-18)M-3	COUNTY WINNEBAGO	TOTAL SHEET NO. 38
			NO. 13
			CONTRACT NO. 64H72
ILLINOIS FED. AID PROJECT			

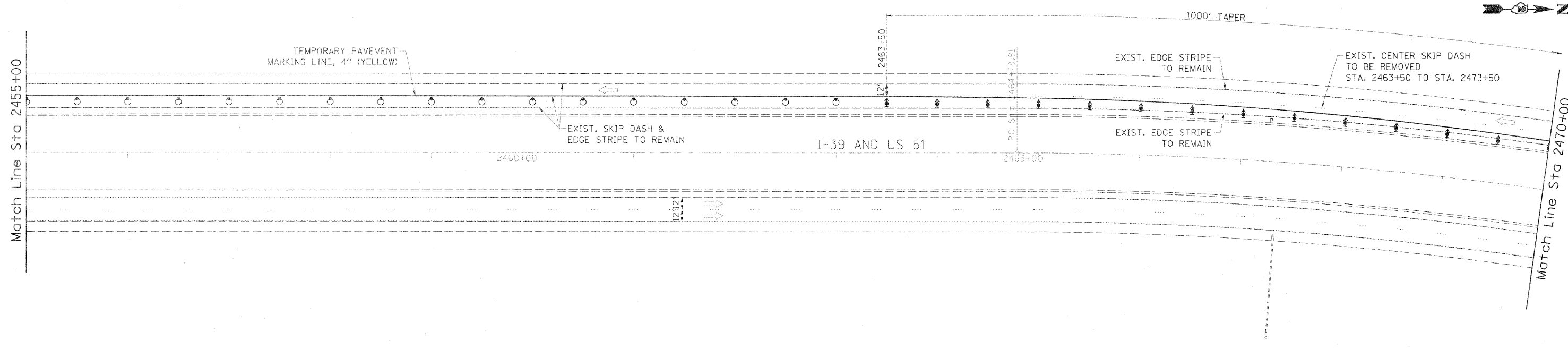
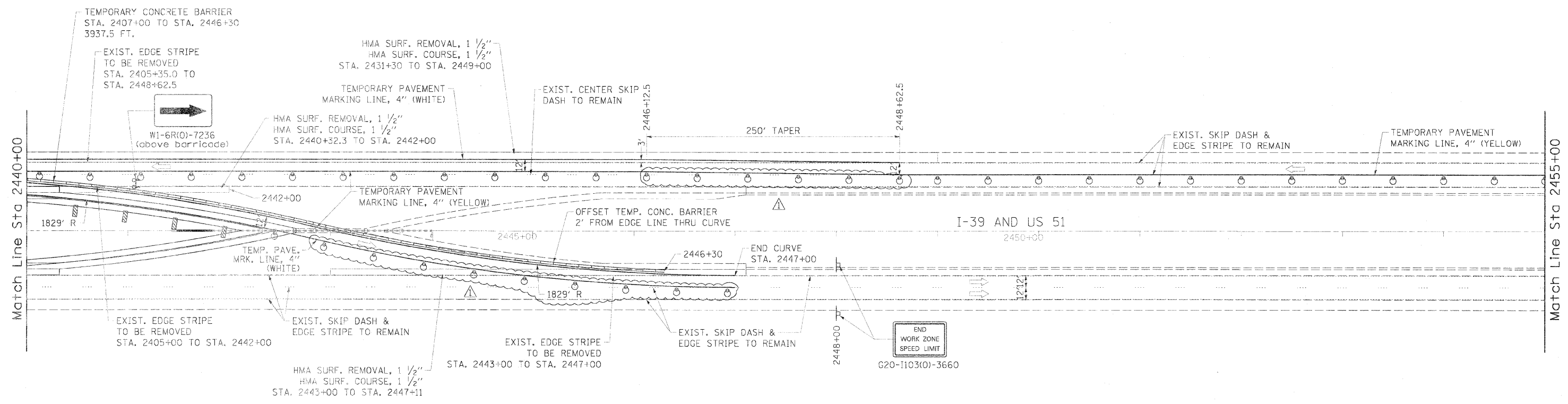

LEGEND

- ARROW BOARD
- WORK AREA
- SIGN
- DIRECTION INDICATOR BARRICADE WITH STEADY BURN MONODIRECTIONAL LIGHT
- TYPE II BARRICADE WITH STEADY BURN MONODIRECTIONAL LIGHT
- DRUM WITH STEADY BURN MONODIRECTIONAL LIGHT
- VERTICAL PANEL (BACK TO BACK)
- TYPE III BARRICADE WITH FLASHING LIGHTS
- TEMPORARY CONCRETE BARRIER

NOTE:
 1. REFER TO STANDARDS 701400, 701411 & 701416 FOR ADDITIONAL REQUIREMENTS.
 2. SEE CROSSOVER PAVING PLAN SHEET FOR PAVEMENT WIDENING, PAVED SHOULDER REMOVAL & PAVEMENT REMOVAL.

TEMP. RAISED REFLECTIVE PAVEMENT MARKERS
 40' INTERVAL:
 SB LT: STA. 2440+00.0 TO STA. 2470+00.0
 SB RT: STA. 2440+00.0 TO STA. 2448+62.5
 20' INTERVAL:
 NB LT: STA. 2400+00.0 TO STA. 2447+00.0
 NB RT: STA. 2440+00.0 TO STA. 2444+87.0
 2447+00.0

FILE NAME: c:\pwworkspace\pk\work\mtd\delete\tdms59264\02... USER NAME: brenn@249 4/17/12 PLOT SCALE: 50.0000 1" = 50' PLOT DATE: 03/30/2012	DESIGNED - BJB DRAWN - BJB CHECKED - JMH DATE - 2/9/12	REVISED - 3/30/2012 BJB REVISED - REVISED - REVISED -	STATE OF ILLINOIS DEPARTMENT OF TRANSPORTATION	TRAFFIC CONTROL PLAN - STAGE 1 I-39 OVER KISHWAUKEE RIVER SCALE: 1" = 50' SHEET 4 OF 5 SHEETS STA. 2440+00 TO STA. 2470+00	F.A.I. RTE. 39 SECTION (201-18)M-3 COUNTY WINNEBAGO TOTAL SHEET NO. 38 SHEETS NO. 15 CONTRACT NO. 64H72 ILLINOIS FED. AID PROJECT
--	---	---	--	---	---

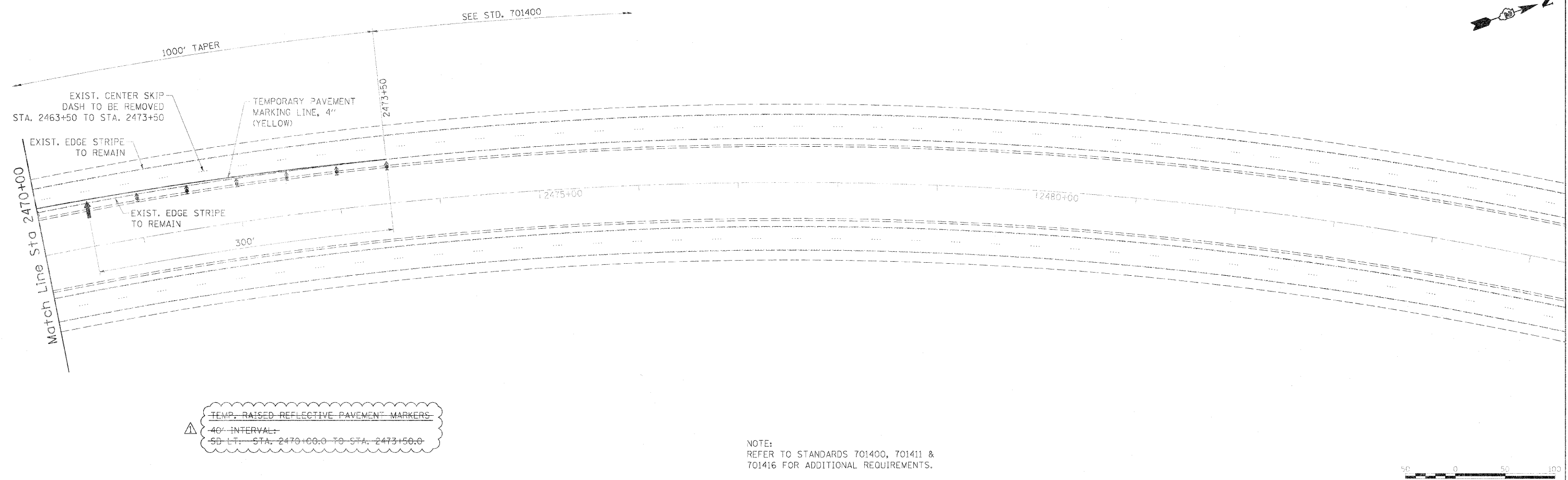

ROAD CONSTRUCTION AHEAD, HIT A WORKER AND THE PORTABLE CHANGEABLE MESSAGE SHOWN ON STANDARD 701400. MODIFY "ROAD CONSTRUCTION AHEAD" SIGN BY ADDING I-39 SOUTH SHIELD.

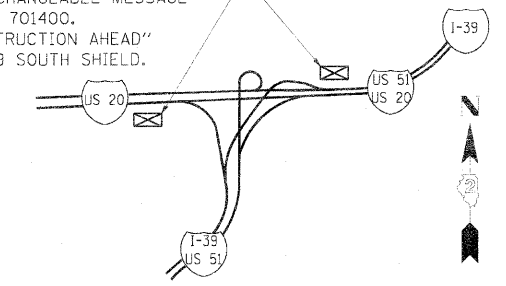

CONSTRUCTION AHEAD SIGNAGE PLAN
Not to Scale

LEGEND

- ➔ ARROW BOARD
- ▨ WORK AREA
- ⊥ SIGN
- ➔ DIRECTION INDICATOR BARRICADE WITH STEADY BURN MONODIRECTIONAL LIGHT
- ⊥ TYPE II BARRICADE WITH STEADY BURN MONODIRECTIONAL LIGHT
- ⊙ DRUM WITH STEADY BURN MONODIRECTIONAL LIGHT
- ▨ VERTICAL PANEL (BACK TO BACK)
- ⊥ TYPE III BARRICADE WITH FLASHING LIGHTS
- ▬ TEMPORARY CONCRETE BARRIER

FILE NAME =	USER NAME = brent8024	DESIGNED = BJB	REVISED = 3/30/2012 BJB	STATE OF ILLINOIS DEPARTMENT OF TRANSPORTATION	TRAFFIC CONTROL PLAN - STAGE 1 I-39 OVER KISHWAUKEE RIVER	F.A.I. RTE. 39	SECTION (201-18)M-3	COUNTY WINNEBAGO	TOTAL SHEETS 38	SHEET NO. 16		
cr:\pwise\work\coi\dot\delete\dm59254\024472-shit-staging\4a.dgn	PLOT SCALE = 50.0000 1" = 50'	DRAWN = BJB	REVISIONS			SCALE: 1" = 50'	SHEET 5 OF 5 SHEETS	STA. 2470+00 TO STA. 2485+00	CONTRACT NO. 64H72			
	PLOT DATE = 03/30/2012	CHECKED = JMH	REVISIONS			ILLINOIS FED. AID PROJECT						
		DATE = 2/9/12	REVISIONS									

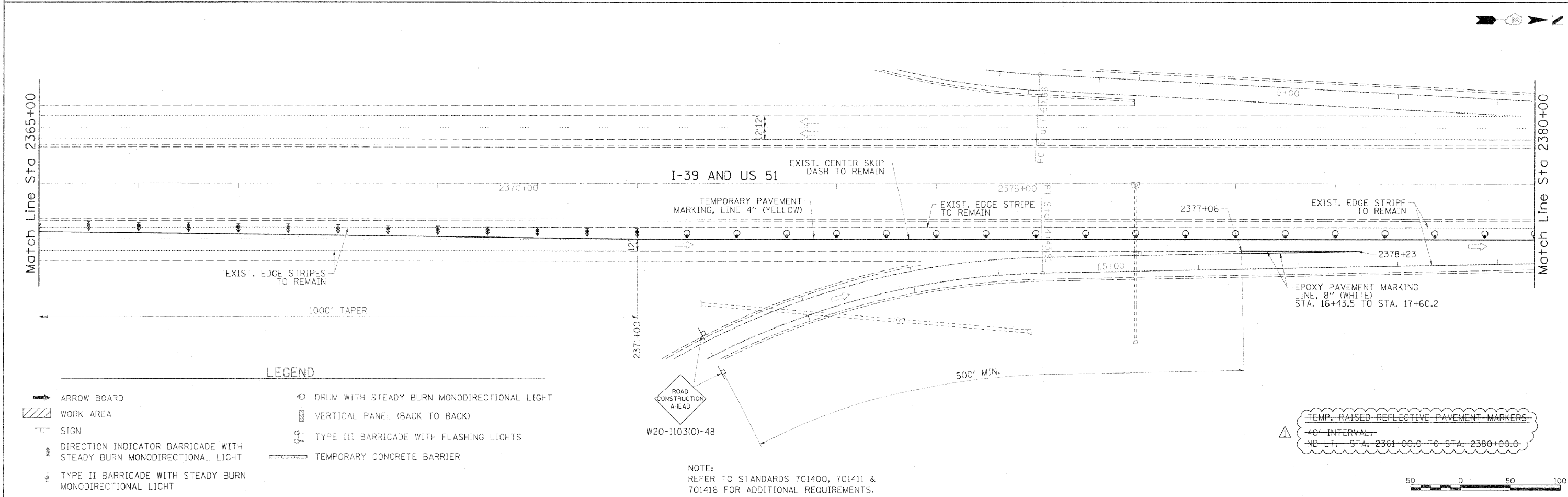
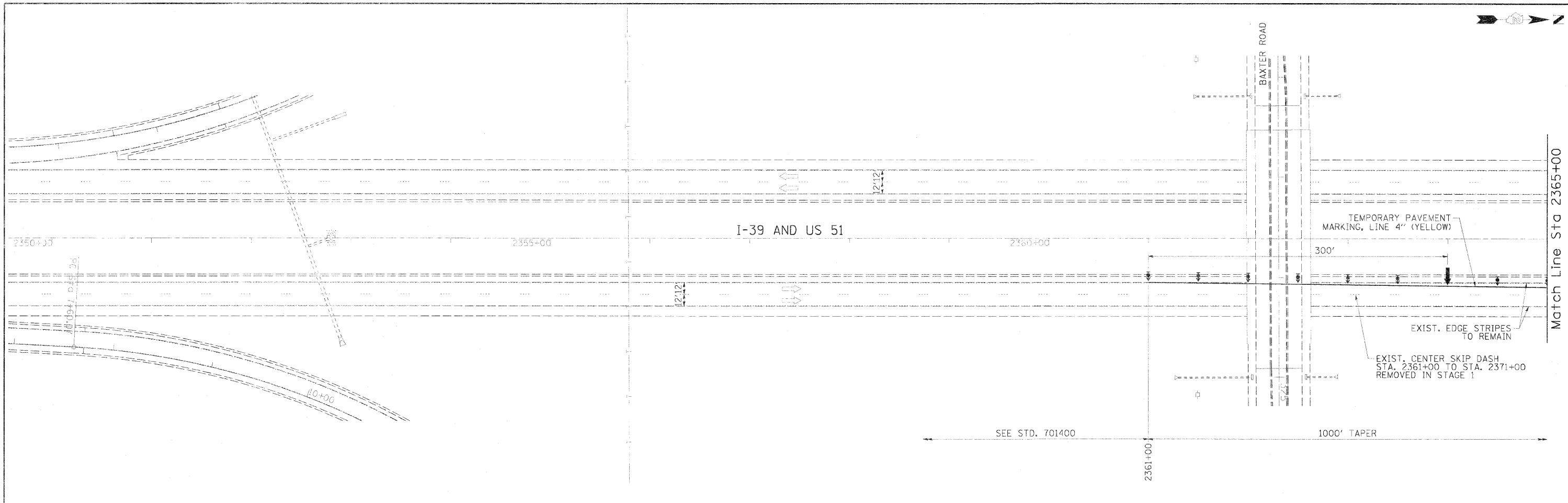

LEGEND

- ARROW BOARD
- WORK AREA
- SIGN
- DIRECTION INDICATOR BARRICADE WITH STEADY BURN MONODIRECTIONAL LIGHT
- TYPE II BARRICADE WITH STEADY BURN MONODIRECTIONAL LIGHT
- DRUM WITH STEADY BURN MONODIRECTIONAL LIGHT
- VERTICAL PANEL (BACK TO BACK)
- TYPE III BARRICADE WITH FLASHING LIGHTS
- TEMPORARY CONCRETE BARRIER



NOTE:
REFER TO STANDARDS 701400, 701411 &
701416 FOR ADDITIONAL REQUIREMENTS.

TEMP. RAISED REFLECTIVE PAVEMENT MARKERS
40' INTERVAL
NB LT. STA. 2361+00.0 TO STA. 2380+00.0



FILE NAME =	USER NAME = bren-00246	DESIGNED - BJB	REVISED 3/30/2012 BJB	STATE OF ILLINOIS DEPARTMENT OF TRANSPORTATION	TRAFFIC CONTROL PLAN - STAGE 2 I-39 OVER KISHWAUKEE RIVER	F.A.I. RTE. 39	SECTION (201-18/M-3)	COUNTY WINNBAGO	TOTAL SHEETS 38	SHEET NO. 17	
CONTRACT NO. 64H72	ILLINOIS FED. AID PROJECT	SCALE: 1" = 50'	SHEET 1 OF 5 SHEETS			STA. 2350+00 TO STA. 2380+00					
<p>PLANTING: 16+43.5 TO 17+60.2</p> <p>PC: 2371+00, PT: 2375+00, PVI: 2373+00, PS: 2377+00, POB: 2378+23</p>											
<p>PLANTING: 16+43.5 TO 17+60.2</p> <p>PC: 2371+00, PT: 2375+00, PVI: 2373+00, PS: 2377+00, POB: 2378+23</p>											

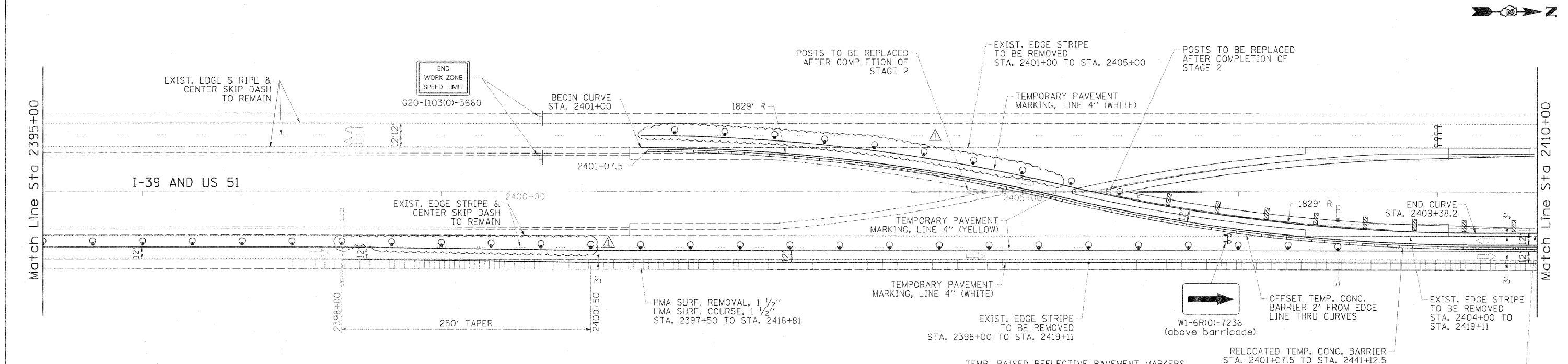
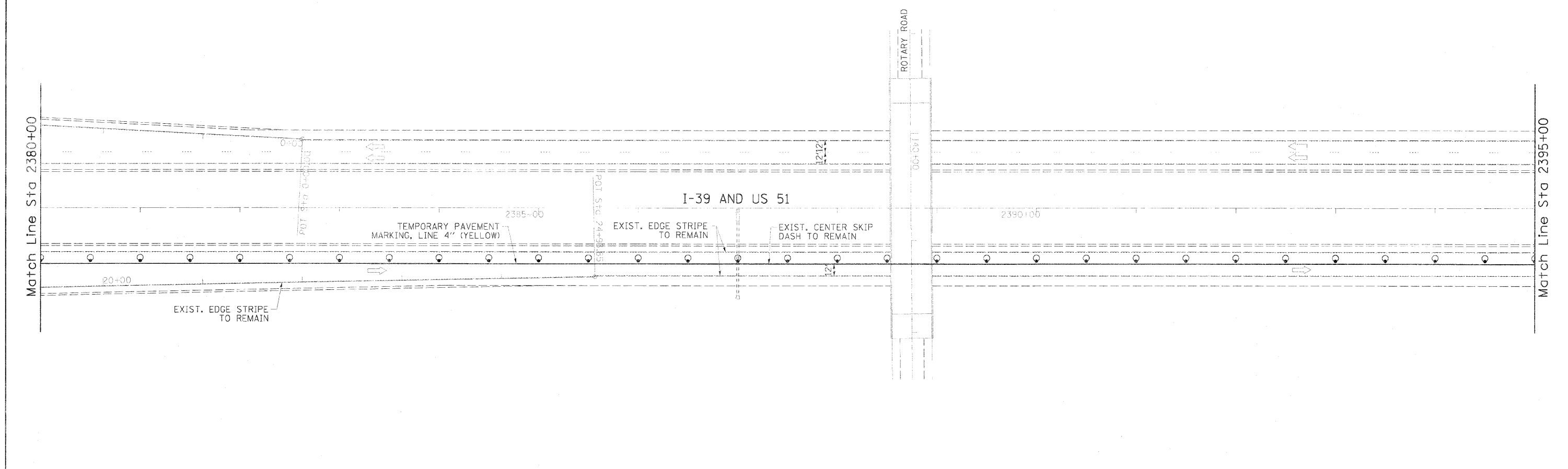

LEGEND

ARROW BOARD	DRUM WITH STEADY BURN MONODIRECTIONAL LIGHT
WORK AREA	VERTICAL PANEL (BACK TO BACK)
SIGN	TYPE III BARRICADE WITH FLASHING LIGHTS
DIRECTION INDICATOR BARRICADE WITH STEADY BURN MONODIRECTIONAL LIGHT	TEMPORARY CONCRETE BARRIER
TYPE II BARRICADE WITH STEADY BURN MONODIRECTIONAL LIGHT	

NOTE:
 1. REFER TO STANDARDS 701400, 701411 & 701416 FOR ADDITIONAL REQUIREMENTS.
 2. SEE CROSSOVER PAVING PLAN SHEET FOR PAVEMENT WIDENING, PAVED SHOULDER REMOVAL & PAVEMENT REMOVAL.

TEMP. RAISED REFLECTIVE PAVEMENT MARKERS

40' INTERVAL:
 NB LT: STA. 2380+00.0 TO STA. 2410+00.0
 NB RT: STA. 2398+00.0 TO STA. 2410+00.0
 SB RT: STA. 2409+38.2 TO STA. 2410+00.0

20' INTERVAL:
 SB LT: STA. 2401+00.0 TO STA. 2409+38.2
 SB RT: STA. 2403+13.0 TO STA. 2409+38.2

RELOCATED TEMP. CONC. BARRIER STA. 2401+07.5 TO STA. 2441+12.5 4012.5 FT.

HMA SURF. REMOVAL, 1 1/2" HMA SURF. COURSE, 1 1/2" STA. 2409+92.7 TO STA. 2418+81.0

FILE NAME =	USER NAME = brenn00248	DESIGNED - BJB	REVISED - 3/30/2012 BJB
c:\pwise\work\do_not_delete\dms\9254\324\4H72-shit-staging@S.dgn	4H72-shit-staging@S.dgn	DRAWN - BJB	REVISED -
	PLOT SCALE = 50,0000 "/ in.	CHECKED - JMH	REVISED -
	PLOT DATE = 03/30/2012	DATE - 2/9/12	REVISED -

**STATE OF ILLINOIS
DEPARTMENT OF TRANSPORTATION**

**TRAFFIC CONTROL PLAN - STAGE 2
I-39 OVER KISHWAUKEE RIVER**

SCALE: 1" = 50' SHEET 2 OF 5 SHEETS STA. 2380+00 TO STA. 2410+00

F.A.I. RTE. 39	SECTION (201-1B/M-3)	COUNTY WINNEBAGO	TOTAL SHEETS 38	SHEET NO. 18
ILLINOIS FED. AID PROJECT				CONTRACT NO. 64H72

KISHWAUKEE RIVER



Match Line Sta 2410+00

Match Line Sta 2425+00

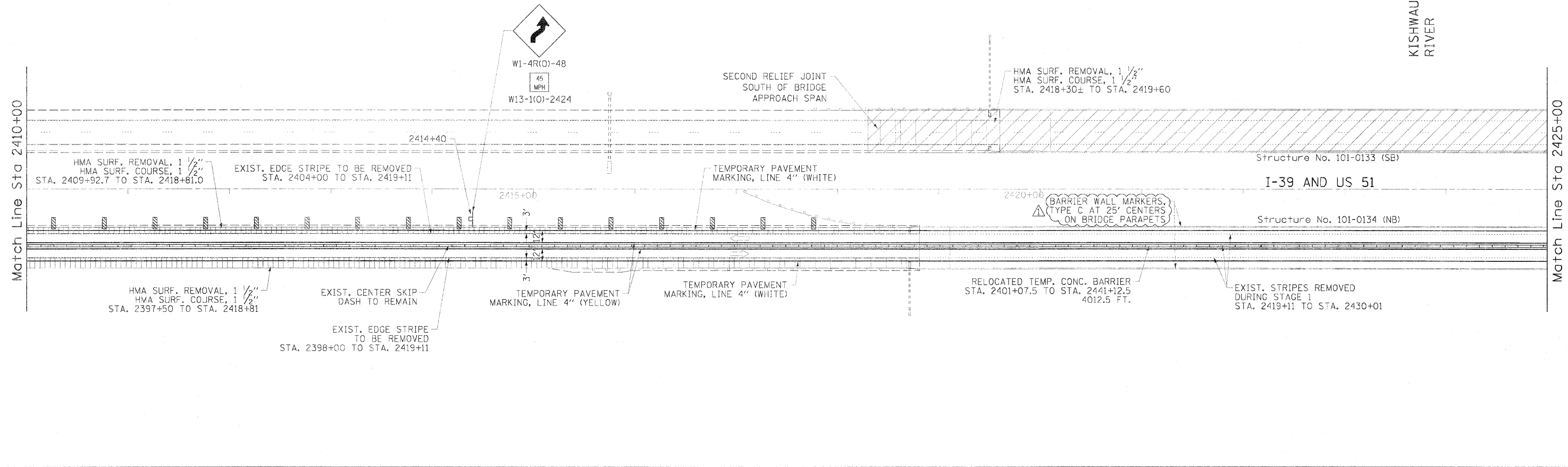

Match Line Sta 2425+00

Match Line Sta 2440+00

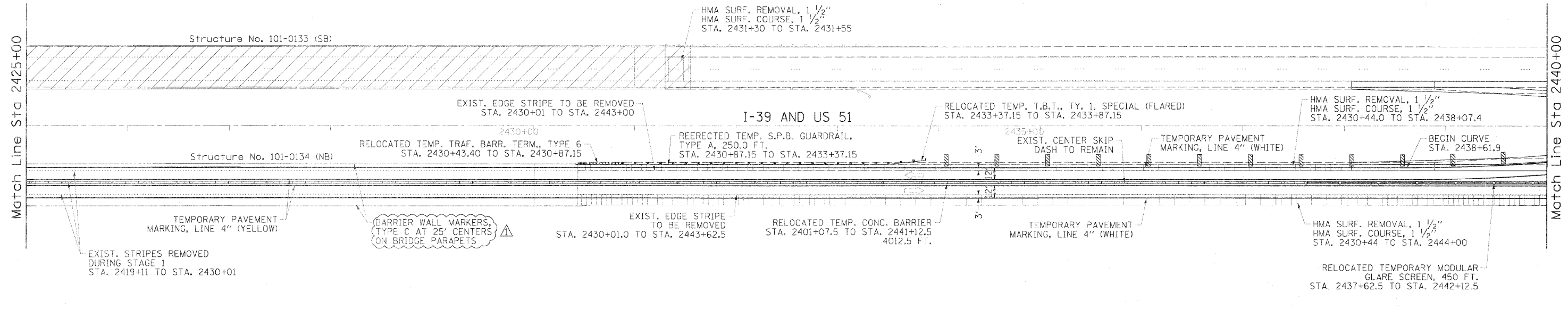

LEGEND

- ARROW BOARD
- WORK AREA
- SIGN
- DIRECTION INDICATOR BARRICADE WITH STEADY BURN MONODIRECTIONAL LIGHT
- TYPE II BARRICADE WITH STEADY BURN MONODIRECTIONAL LIGHT
- DRUM WITH STEADY BURN MONODIRECTIONAL LIGHT
- VERTICAL PANEL (BACK TO BACK)
- TYPE III BARRICADE WITH FLASHING LIGHTS
- TEMPORARY CONCRETE BARRIER
- TEMPORARY MODULAR GLARE SCREEN

NOTE:
 1. REFER TO STANDARDS 701400, 701411 & 701416 FOR ADDITIONAL REQUIREMENTS.
 2. SEE CROSSOVER PAVING PLAN SHEET FOR PAVEMENT WIDENING, PAVED SHOULDER REMOVAL & PAVEMENT REMOVAL.

TEMP. RAISED REFLECTIVE PAVEMENT MARKERS

- 40' INTERVAL:
- NB RT: STA. 2410+00.0 TO STA. 2415+97.7
 - NB RT: STA. 2430+44.0 TO STA. 2440+00.0
 - SB RT: STA. 2410+00.0 TO STA. 2418+81.0
 - SB RT: STA. 2433+37.2 TO STA. 2438+61.9
- 20' INTERVAL:
- SB LT: STA. 2438+61.9 TO STA. 2440+00.0
 - SB RT: STA. 2438+61.9 TO STA. 2440+00.0

FILE NAME =	USER NAME = hram80248	DESIGNED - BJB	REVISED - 3/30/2012 BJB
PROJECT WORK\pnt_delete\dm59254\2410-2440-172-sht-staging07.dgn		DRAWN - BJB	REVISED -
PLT SCALE = 50.0000 1/2 in.		CHECKED - JMH	REVISED -
PLT DATE = 03/30/2012		DATE = 2/9/12	REVISED -

**STATE OF ILLINOIS
DEPARTMENT OF TRANSPORTATION**

**TRAFFIC CONTROL PLAN - STAGE 2
I-39 OVER KISHWAUKEE RIVER**

SCALE: 1" = 50' SHEET 3 OF 5 SHEETS STA. 2410+00 TO STA. 2440+00

F.A.I. RTE.	SECTION	COUNTY	TOTAL SHEET NO.
39	(201-18)M-3	WINNEBAGO	38 19
CONTRACT NO. 64H72			
ILLINOIS FED. AID PROJECT			

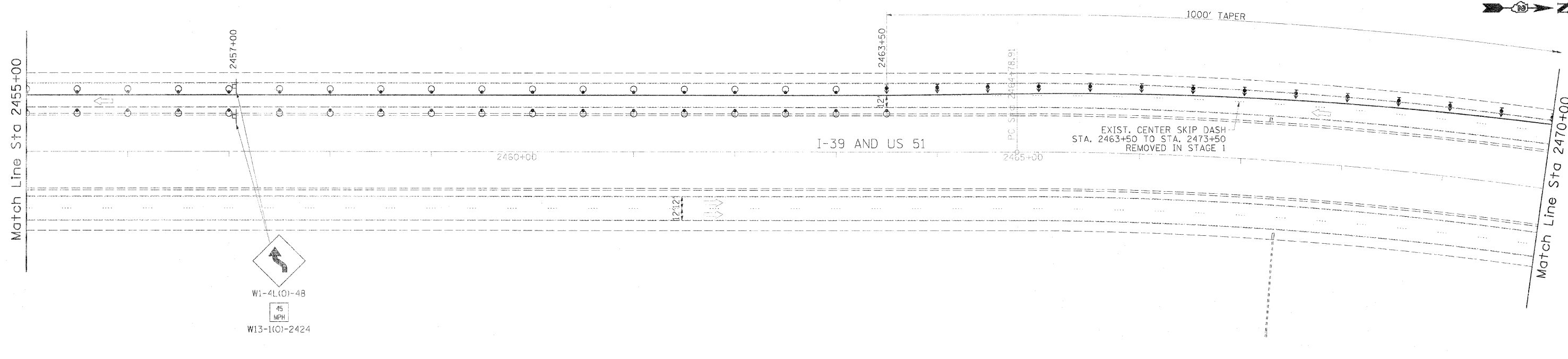
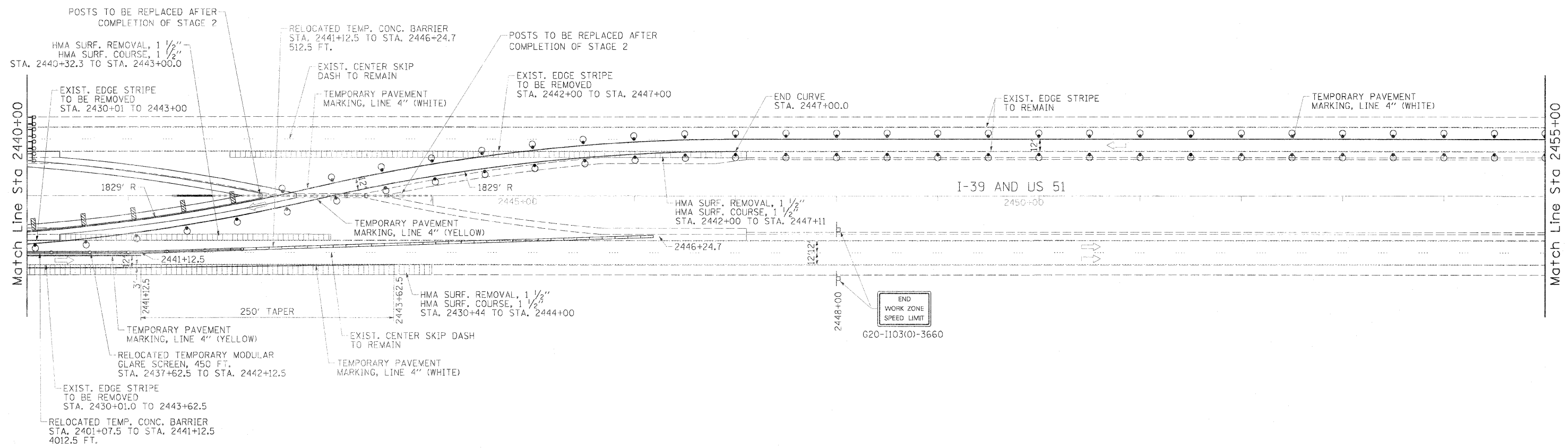
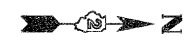

LEGEND

- ➔ ARROW BOARD
- ▨ WORK AREA
- ⊠ SIGN
- ➔ DIRECTION INDICATOR BARRICADE WITH STEADY BURN MONODIRECTIONAL LIGHT
- ⊠ TYPE II BARRICADE WITH STEADY BURN MONODIRECTIONAL LIGHT
- ⊙ DRUM WITH STEADY BURN MONODIRECTIONAL LIGHT
- ▨ VERTICAL PANEL (BACK TO BACK)
- ⊠ TYPE III BARRICADE WITH FLASHING LIGHTS
- ▬ TEMPORARY CONCRETE BARRIER
- ▬ TEMPORARY MODULAR GLARE SCREEN

NOTE:

- REFER TO STANDARDS 701400, 701411 & 701416 FOR ADDITIONAL REQUIREMENTS.
- SEE CROSSOVER PAVING PLAN SHEET FOR PAVEMENT WIDENING, PAVED SHOULDER REMOVAL & PAVEMENT REMOVAL.

TEMP. RAISED REFLECTIVE PAVEMENT MARKERS

40' INTERVAL:
 NB RT: STA. 2440+00.0 TO STA. 2443+62.5
 SB RT: STA. 2447+00.0 TO STA. 2470+00.0

20' INTERVAL:
 SB LT: STA. 2440+00.0 TO STA. 2447+00.0
 SB RT: STA. 2440+00.0 TO STA. 2447+00.0



FILE NAME: \\p100se\work\do_net\delete\oms59234102	USER NAME: brenn00248	DESIGNED: BJB	REVISED: 3/30/2012 BJB	STATE OF ILLINOIS DEPARTMENT OF TRANSPORTATION	TRAFFIC CONTROL PLAN - STAGE 2 I-39 OVER KISHWAUKEE RIVER			F.A.I. RTE. 39	SECTION (201-18)M-3	COUNTY WINNEBAGO	TOTAL SHEETS 38	SHEET NO. 20
PLOT SCALE: 50.0000' / 1"	DATE: 2/9/12	DRAWN: BJB	CHECKED: JMH		SCALE: 1" = 50'	SHEET 4 OF 5 SHEETS	STA. 2440+00 TO STA. 2470+00	CONTRACT NO. 64H72				
PLOT DATE: 03/30/2012	DATE: 2/9/12	CHECKED: JMH	DATE: 2/9/12		ILLINOIS FED. AID PROJECT							

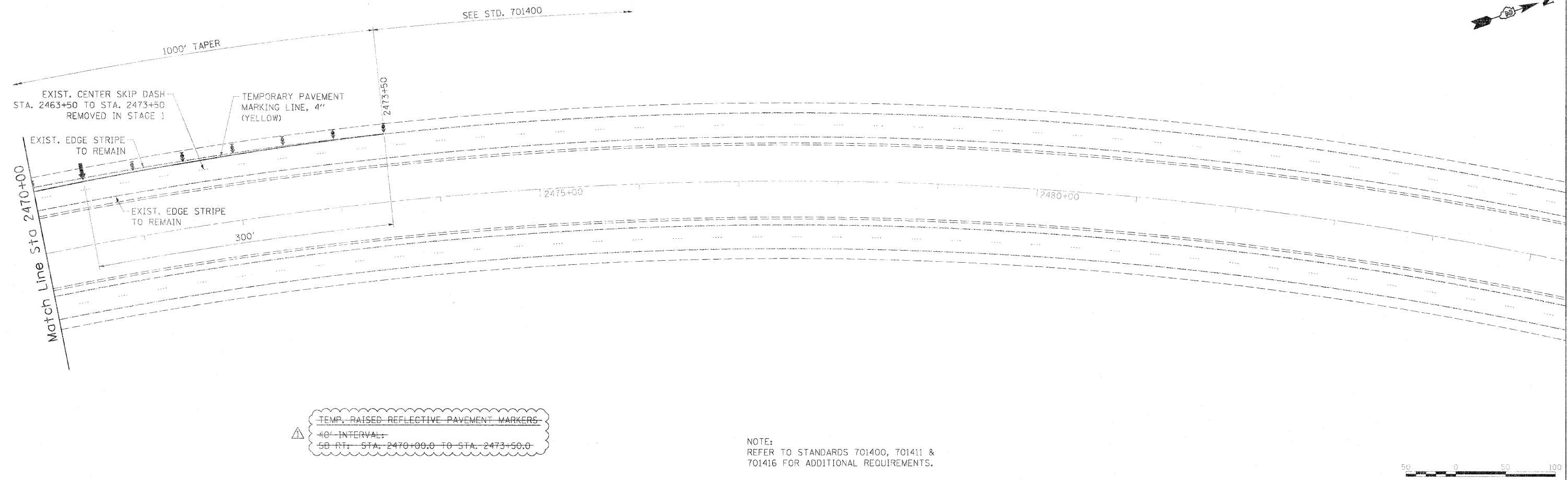

ROAD CONSTRUCTION AHEAD, HIT A WORKER AND THE PORTABLE CHANGEABLE MESSAGE SHOWN ON STANDARD 701400. MODIFY "ROAD CONSTRUCTION AHEAD" SIGN BY ADDING I-39 SOUTH SHIELD.

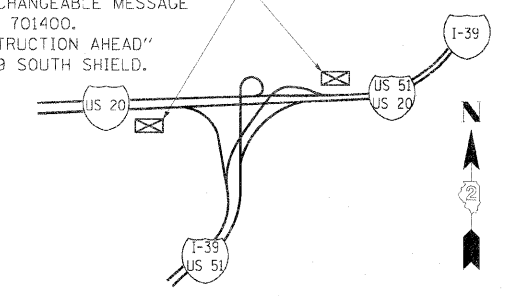

CONSTRUCTION AHEAD SIGNAGE PLAN
Not to Scale

LEGEND

- ARROW BOARD
- WORK AREA
- SIGN
- DIRECTION INDICATOR BARRICADE WITH STEADY BURN MONODIRECTIONAL LIGHT
- TYPE II BARRICADE WITH STEADY BURN MONODIRECTIONAL LIGHT
- DRUM WITH STEADY BURN MONODIRECTIONAL LIGHT
- VERTICAL PANEL (BACK TO BACK)
- TYPE III BARRICADE WITH FLASHING LIGHTS
- TEMPORARY CONCRETE BARRIER

FILE NAME =	USER NAME = brenn02240	DESIGNED - BJB	REVISED - 3/30/2012 BJB	STATE OF ILLINOIS DEPARTMENT OF TRANSPORTATION	TRAFFIC CONTROL PLAN - STAGE 2	P.A.I. RTE. 39	SECTION (201-18M-3)	COUNTY WINNEBAGO	TOTAL SHEETS 38	SHEET NO. 21
ci:\pwise\work\do_not_delete\vars09294\02240\22-ah-traffic08.scdgn	PROJECT SCALE = 50.0000' / 1" =	DRAWN - BJB	REVISIONS		I-39 OVER KISHWAUKEE RIVER	SCALE: 1" = 50' SHEET 5 OF 5 SHEETS STA. 2470+00 TO STA. 2485+00		CONTRACT NO. 64H72		ILLINOIS FED. AID PROJECT
	PLT DATE = 03/30/2012	CHECKED - JMH	REVISIONS							
		DATE 2/9/12	REVISIONS							