

NOTES:

INSTALL TBT TY 1 SP TAN @ 50:1 TAPER TO KEEP END PIECE OFF THE EDGE OF SIDEWALK.

INSTALL NEW GUARDRAIL REFLECTORS, TY A, 25 FOOT ON CENTER TO SPBGR TY A, 6 FOOT POST. DON'T PLACE REFLECTORS ON TRAFFIC BARRIER TERMINALS.

REMOVE AND REPLACE ALL GUARDRAIL REFLECTORS, TY A, 25 FOOT ON CENTER ON EXISTING GUARDRAIL ON SOUTH SIDE OF ROAD.

146 FOOT STEEL RAILING REMOVAL, STA 491+02.5 - 492+47.5, NORTH SIDE OF ROAD. EXISTING STEEL RAILING NOT SHOWN FOR CLARITY.

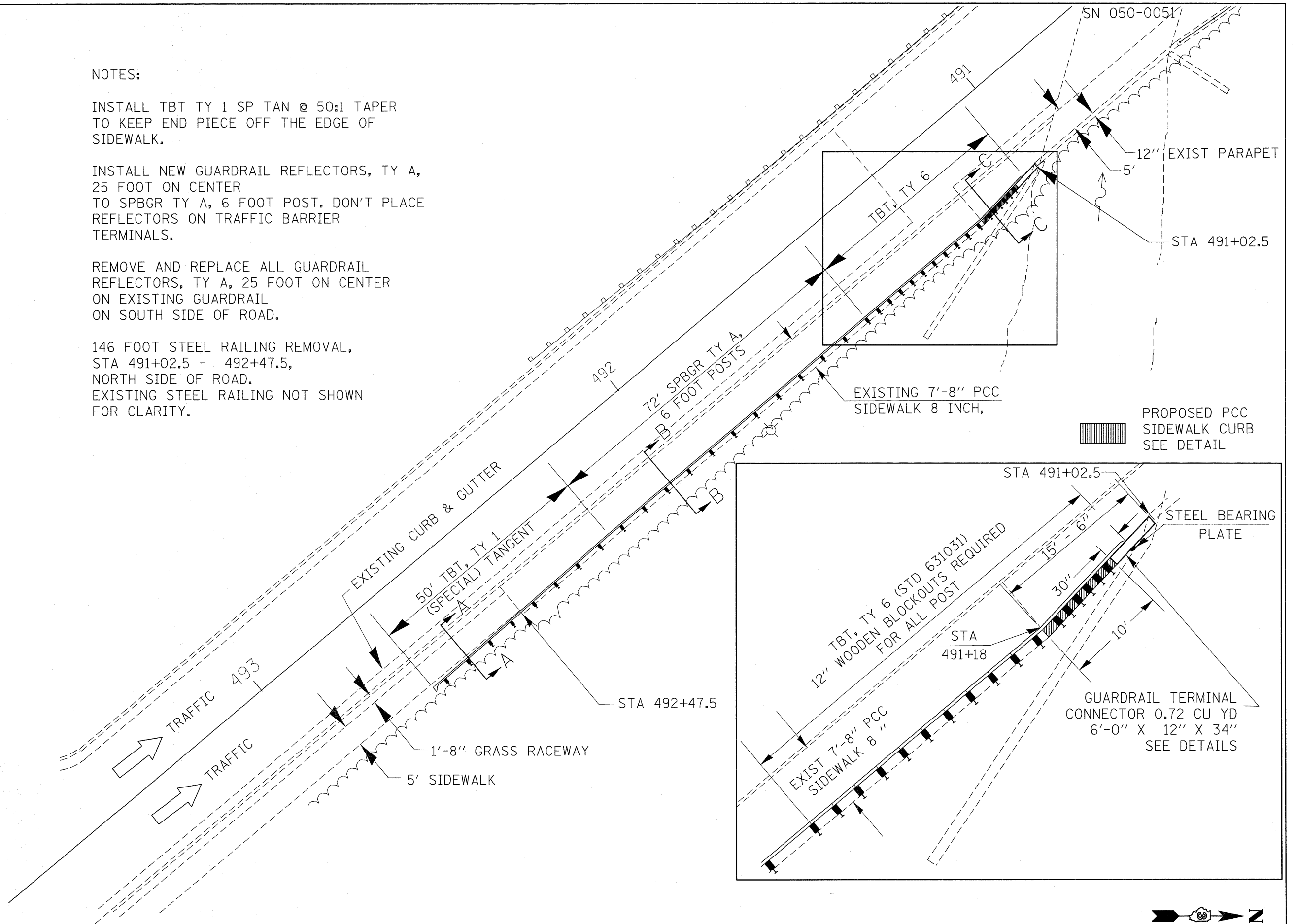

FILE NAME =	USER NAME = administrator	DESIGNED -	REVISD -	STATE OF ILLINOIS DEPARTMENT OF TRANSPORTATION	GUARDRAIL LAYOUT PLAN			F.A.P. RTE. 68	SECTION (52)I	COUNTY LASALLE	TOTAL SHEETS 8	SHEET NO. 3
ct\pw_work\pwidot\qsgleym\024999\0368808-sht-details.DGN	PLOT SCALE = 10.0000' / 1in.	DRAWN -	REVISD -		SCALE:	SHEET	OF SHEETS	STA.	TO STA.	CONTRACT NO. 66B08		
	PLOT DATE = 2/8/2012	CHECKED -	REVISD -		ILLINOIS FED. AID PROJECT							
		DATE -	REVISD -									