

F.A.I. RTE.	SECTION	COUNTY	TOTAL SHEETS	SHEET NO.
VAR	D3 OVD MESSAGE SG - 2012	VAR	50	1
		ILLINOIS	CONTRACT NO. 66B28	

5091=51

STATE OF ILLINOIS
DEPARTMENT OF TRANSPORTATION
DIVISION OF HIGHWAYS
PROPOSED
HIGHWAY PLANS
VARIOUS ROUTES
SECTION D3 OVD MESSAGE SG-2012

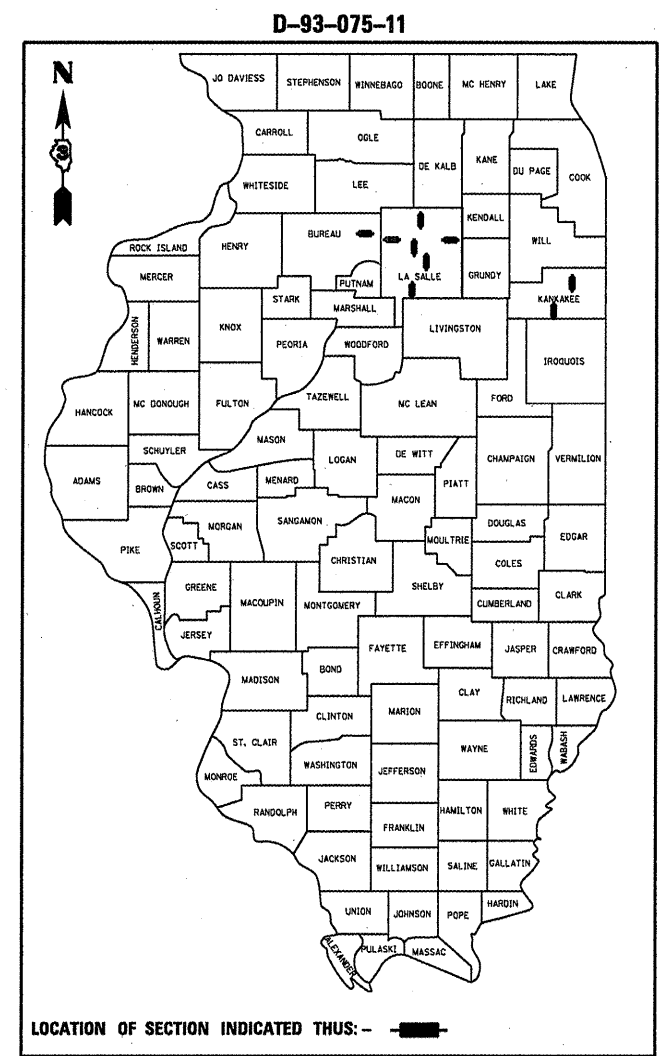

FUNCTIONAL CLASSIFICATION
RURAL - INTERSTATE

FAI ROUTE 80	FAI ROUTE 39	FAI ROUTE 57
2011 ADT = 38500	2011 ADT = 18200	2011 ADT = 18100
P.V. = 75.71%	P.V. = 68.13%	P.V. = 77.66%
M.U. = 18.18%	M.U. = 26.92%	M.U. = 17.26%
S.U. = 6.10%	S.U. = 4.95%	S.U. = 5.08%

STATE OF ILLINOIS
 DEPARTMENT OF TRANSPORTATION
 DIVISION OF HIGHWAYS

SUBMITTED 2-24 20 12
 PASSED Eric S. Therkildsen
 ENGINEER OF OPERATIONS

March 23 20 12
John D. Baranzelli, PE, BC
 acting ENGINEER OF DESIGN AND ENVIRONMENT

APPROVED March 23 20 12
William R. Frazer, Jr.
 acting DIRECTOR DIVISION OF HIGHWAYS

PRINTED BY THE AUTHORITY
OF THE STATE OF ILLINOIS

Rev.

INDEX OF SHEETS

1. COVER SHEET
2. GENERAL NOTES
3. SUMMARY OF QUANTITIES
4. TYPICAL SECTIONS
5. LOCATION MAP
- 6-12. ELECTRIC SERVICE AND CAMERA DETAILS
13. IDOT DISTRICT 3 HEADQUARTERS WORK
- 14-28. OVERHEAD SIGN STRUCTURE - SPAN
- 29-40A. OVERHEAD SIGN STRUCTURE - BUTTERFLY
41. LOCATION 1: SITE INSTALLATION DETAIL
42. LOCATION 2: SITE INSTALLATION DETAIL
43. LOCATION 3: SITE INSTALLATION DETAIL
44. LOCATION 4: SITE INSTALLATION DETAIL
45. LOCATION 5: SITE INSTALLATION DETAIL
46. LOCATION 6: SITE INSTALLATION DETAIL
47. LOCATION 7: SITE INSTALLATION DETAIL
48. LOCATION 8: SITE INSTALLATION DETAIL
49. LOCATION 9: SITE INSTALLATION DETAIL

50. TERMINAL MARKER AND REFLECTOR MARKER DETAILS
STANDARDS

- 000001-06 STANDARD SYMBOLS, ABBREVIATIONS AND PATTERNS
- 001001-02 AREAS OF REINFORCEMENT BARS
- 001006 DECIMAL OF AN INCH AND OF A FOOT
- 630001-10 STEEL PLATE BEAM GUARDRAIL
- 631011-08 TRAFFIC BARRIER TERMINAL, TYPE 2
- 701101-02 OFF-ROAD OPERATIONS MULTILANE, 15' (4.5 m) TO 24" (600 mm) FROM PAVEMENT EDGE
- 701106-02 OFF-ROAD OPERATIONS, MULTILANE, MORE THAN 15' (4.5 m) AWAY
- 701901-02 TRAFFIC CONTROL DEVICES

FURNISH AND ERECT BUTTERFLY AND OVERHEAD MESSAGE BOARD
SIGN TRUSSES
BUREAU, LASALLE AND KANKAKEE COUNTY
C-93-093-11

LOCATION 1 - FAI ROUTE 80

OVERHEAD SIGN STRUCTURE
 S.N.# 3S0501080996.0
 I-80 WB
 (PROPOSED STA. 785+00 WBL)
 3 MI. EAST OF IL 71

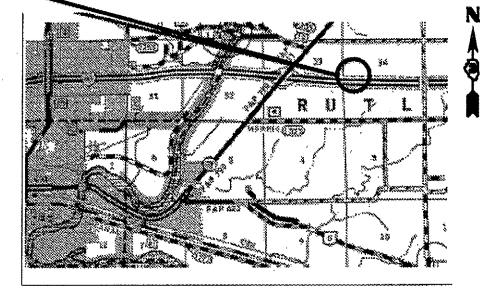

LOCATION 2 - FAI ROUTE 80

OVERHEAD SIGN STRUCTURE
 S.N.# 3S00610808072.5
 I-80 EB
 (PROPOSED STA. 437+50 EBL)
 3 MI. WEST OF IL 251

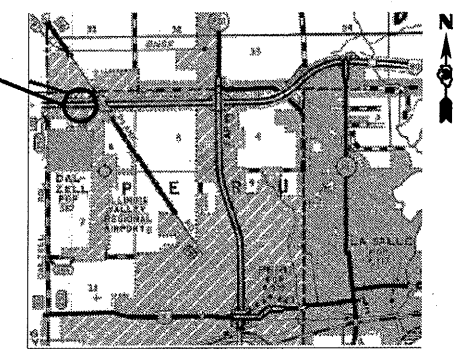

LOCATION 4 - FAI ROUTE 39

OVERHEAD SIGN STRUCTURE - BUTTERFLY
 S.N.# 3F0501039R52.6
 I-39 NB
 (PROPOSED STA. 701+50 NBL)
 JUST SOUTH OF OGLESBY SPUR
 AND WALNUT ST. INTERCHANGE

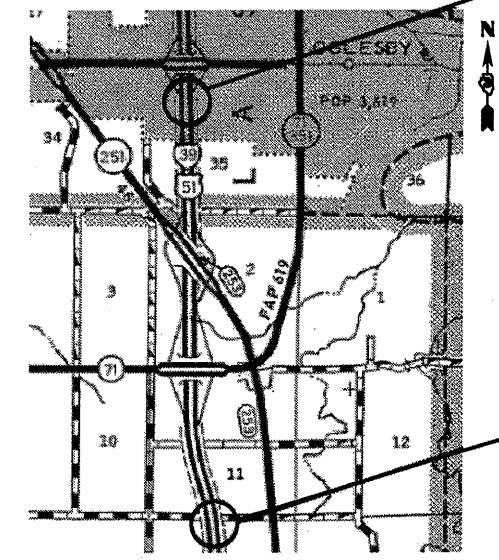

LOCATION 3 - FAI ROUTE 39

OVERHEAD SIGN STRUCTURE
 S.N.# 3S0501039R049.0
 I-39 NB
 (PROPOSED STA. 190+00 NBL)
 3 MI. SOUTH OF IL 71

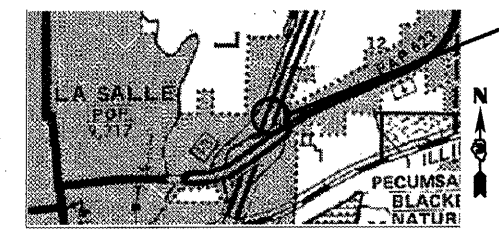

LOCATION 6 - FAI ROUTE 39

OVERHEAD SIGN STRUCTURE - BUTTERFLY
 S.N.# 3F0501039L057.6
 I-39 SB
 (PROPOSED STA. 965+00 SBL)
 JUST NORTH OF RT 6 I-39 INTERCHANGE.



LOCATION 5 - FAI ROUTE 39

OVERHEAD SIGN STRUCTURE
 S.N.# 3S0501039R068.5
 I-39 SB
 (PROPOSED STA. 540+00 SBL)
 3 MI. NORTH OF IL 52

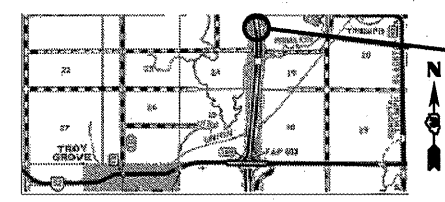

LOCATION 8 - FAI ROUTE 57

OVERHEAD SIGN STRUCTURE
 S.N.# 3S0461057L319.9
 I-57 SB
 (PROPOSED STA. 547+30 SBL)
 1.37 MI. NORTH OF EAST 6000 NORTH RD.

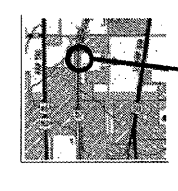

LOCATION 7 - FAI ROUTE 57

OVERHEAD SIGN STRUCTURE
 S.N.# 3S0461057R305.0
 I-57 NB
 (PROPOSED STA. 555+00 SBL)
 2 MI SOUTH OF IL452 I-57 INTERCHG.

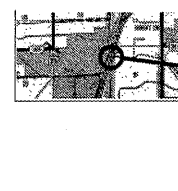

LOCATION 9 - FAI ROUTE 80

OVERHEAD SIGN STRUCTURE - BUTTERFLY
 S.N.# 3F0501080L084.0 - 350501080L0836
 I-80 WB
 (PROPOSED STA. 150+00 WBL)
 2 MI EAST OF IL 170
 0.86 MI E. OF E. 10th RD.

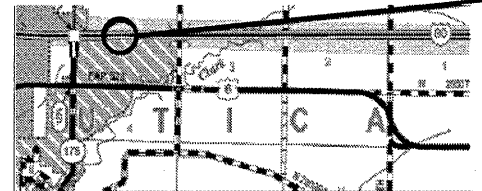

J.U.L.I.E.
 JOINT UTILITY LOCATION INFORMATION FOR EXCAVATION
 1-800-892-0123
 OR 811

DISTRICT 3 NO. (815) 434-6131
 PROJECT ENGINEER: JOE KANNEL, P.E.
 UNIT CHIEF: RON WOODSHANK
CONTRACT NO. 66B28