

INDEX OF SHEETS

04-27-12 LETTING ITEM 087

- 1 COVER SHEET
- 2-7 COMMITMENTS, GENERAL NOTES
- 8-10 SUMMARY OF QUANTITIES
- 11-16 TYPICAL SECTIONS
- 17-25 SCHEDULE OF QUANTITIES
- 26 LINE DIAGRAM
- 27-29 TRAFFIC SIGNALS
- 30-33 CADD STANDARDS

HIGHWAY STANDARDS

- 442201-03 857001-01
- 701501-06 880006-01
- 701502-04 886001-01
- 701701-08 886006-01
- 701901-02 701801-05
- 780001-03
- 781001-03

CADD STANDARDS

- 406101
- 440001
- 780001

DESCRIPTION OF PROJECT

THIS PROJECT CONSISTS OF FULL DEPTH PATCHING, COLD MILLING, RESURFACING, AND OTHER COLLATERAL WORK ON IL9 /IL78 IN SIDE THE CITY LIMITS OF CANTON.

- 2009 ADT = 10750
- MU = 125
- SU = 450

J.U.L.I.E.
JOINT UTILITY LOCATION INFORMATION FOR EXCAVATION
1-800-892-0123
OR 811

PROJECT ENGINEER Rich Dotson 309-671-3455
DESIGN ENGINEER J.J. Appenzeller 309-671-3481

CONTRACT NO. 68978 CATALOG NO. 034448-00D

STATE OF ILLINOIS
DEPARTMENT OF TRANSPORTATION
DIVISION OF HIGHWAYS
**PROPOSED
HIGHWAY PLANS**

FAP 22 ROUTE IL 78
SECTION 135[(Z)RS-2,(X)RS-1]
TYPE of IMPROVEMENT 3P
FULTON COUNTY
C-94-098-10
PROJECT F-0022(080)
R4E

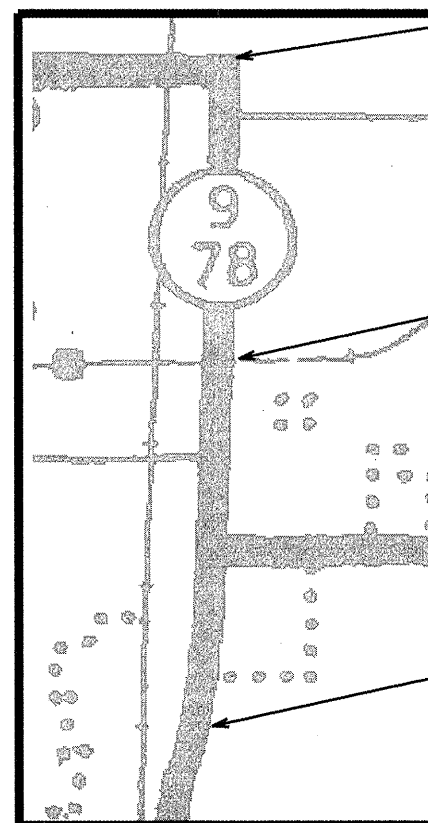

BEGIN IMPROVEMENT STA. 25+52

RAILROAD OMISSION FROM STA. 52+74 TO 53+01

END IMPROVEMENT STA. 96+54

GROSS LENGTH = 7102 FT. = 1.34 MILE
NET LENGTH = 7075 FT. = 1.34 MILE

F.A.P. RTE.	SECTION	COUNTY	TOTAL SHEETS	SHEET NO.
22	135[(Z)RS-2,(X)RS-1]	FULTON	33	1
		ILLINOIS	CONTRACT NO. 68978	

D-94-043-10

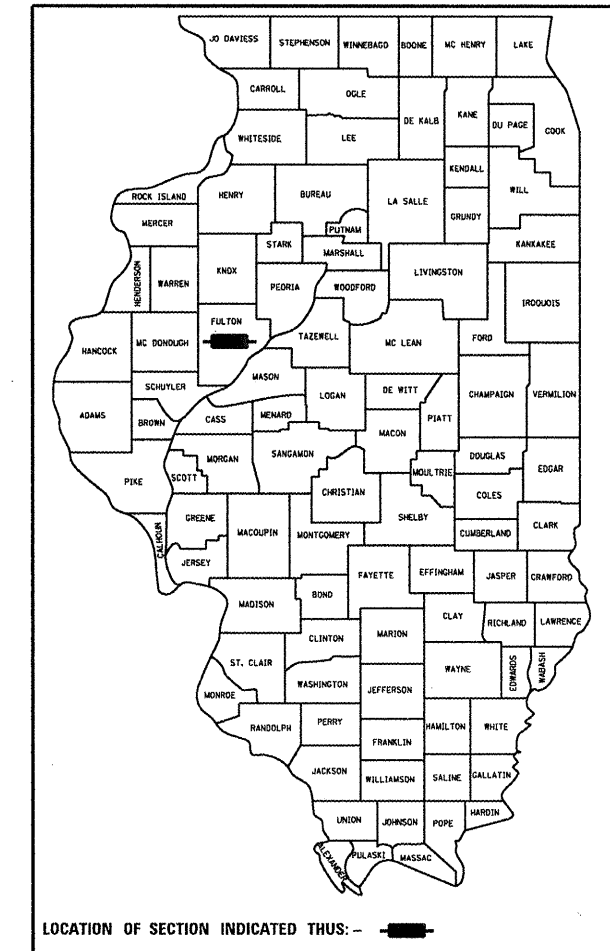

STATE OF ILLINOIS
DEPARTMENT OF TRANSPORTATION
DIVISION OF HIGHWAYS

SUBMITTED 2-1-2012
Joseph E. Crowe MD
DEPUTY DIRECTOR OF HIGHWAYS, REGION ENGINEER

March 23, 2012
John D. Baranzelli, P.E.
actng ENGINEER OF DESIGN AND ENVIRONMENT

March 23, 2012
William R. Freyer Jr.
actng DIRECTOR OF HIGHWAYS, CHIEF ENGINEER

**PRINTED BY THE AUTHORITY
OF THE STATE OF ILLINOIS**

COMMITMENTS

There are no commitments made for this project.

PROPERTY OWNER ACCESS REQUIREMENTS

Access must be maintained to all existing properties during construction per Article 107.09 unless arrangements are made in writing by the Contractor with the property owners with a copy to the Engineer for short-term closures.

CONSECUTIVE SIDE STREET (ROAD) CLOSURE – PROHIBITED

- 1. No two consecutive side streets (roads) may be closed at the same time during construction. The Contractor must alternate streets (roads).**

- 2. Adjacent side roads will not be closed simultaneously. BLR Standard 21 shall be used for all local road closures without any entrances within the closed area. BLR Standard 22 can be used where it is necessary to allow local traffic access.**

FILE NAME = 68978.dgn	USER NAME = oppenzeller.jj	DESIGNED - _____	REVISED - _____	STATE OF ILLINOIS DEPARTMENT OF TRANSPORTATION	COMMITMENTS, GENERAL NOTES, JOB SPECIFIC NOTES	F.A.P. RTE.	SECTION	COUNTY	TOTAL SHEETS	SHEET NO.	
		DRAWN - _____	REVISED - _____			22	135C(ZIRS-2,(X)RS-1]	FULTON	33	2	
		CHECKED - _____	REVISED - _____			CONTRACT NO. 68978					
		DATE - _____	REVISED - _____			ILLINOIS FED. AID PROJECT					
		PLOT SCALE = 1/8" = 1' / in.			SCALE: _____	SHEET NO. _____ OF _____ SHEETS		STA. _____ TO STA. _____			
		PLOT DATE = 12/29/2011									

WINTER SHUTDOWN RESTRICTIONS ON COLD MILLED PROJECTS

Prior to winter shutdown the following steps shall be taken:

- * All cold milled surfaces shall be overlaid.**

- * All lanes shall be reopened to traffic.**

- * Manholes, where applicable, shall be adjusted to the elevation of the binder course/leveling binder to ease in plowing snow, and re-adjusted to finished grade in the Spring. The initial manhole adjustment will be paid for at the contract unit price and any re-adjustment, as directed by the Engineer, will be paid for in accordance with Article 109.04.**

- * Temporary or permanent pavement marking shall be placed as applicable.**

FILE NAME = 68978.dgn	USER NAME = eppenzeller.jj	DESIGNED - _____	REVISED - _____	STATE OF ILLINOIS DEPARTMENT OF TRANSPORTATION	COMMITMENTS, GENERAL NOTES, JOB SPECIFIC NOTES	F.A.P. RTE. 22	SECTION 135(ZRS-2, XRS-1)	COUNTY FULTON	TOTAL SHEETS 33	SHEET NO. 3
PLOT SCALE = 1/8" = 1' / in.	DRAWN - _____	CHECKED - _____	REVISED - _____	SCALE: _____ SHEET NO. _____ OF _____ SHEETS STA. _____ TO STA. _____		CONTRACT NO. 68978 ILLINOIS FED. AID PROJECT				
PLOT DATE = 12/28/2011	DATE - _____	REVISED - _____	REVISED - _____							

ENVIRONMENTAL REVIEWS

Prior to the use of any proposed borrow areas, use areas (temporary access roads, detours, run-arounds, etc.) and/or waste areas, the Contractor shall file the required environmental resource request surveys according to Section 107.22 of the Standard Specifications. These surveys are required in order for the Department to conduct cultural and biological resource surveys for the proposed site.

Prior to any waste materials being removed from the construction site the required environmental resource surveys will need to be obtained and filed by the Contractor. Excess waste products removed from the construction site shall be disposed of as required in Section 202.03 of the Standard Specifications.

Any protruding metal bars shall be removed prior to the disposal of broken concrete at approved disposal sites.

The required environmental resource documentation shall include the following:

- * BDE Form 2289 (Environmental Survey Request)
- * A location map showing the size limits and location of the use area
- * Signed property owner agreement form-D4 PI0100
- * Color photographs depicting the use area
- * Borrow Area Entry Agreement form-D4 PI0101

Please note that a minimum of two weeks shall be allowed for the District to obtain the required environmental clearances.

USER NAME = oppenzeller JJ	DESIGNED - _____	REVISED - _____	STATE OF ILLINOIS DEPARTMENT OF TRANSPORTATION	COMMITMENTS, GENERAL NOTES, JOB SPECIFIC NOTES	F.A.P. RTE.	SECTION	COUNTY	TOTAL SHEETS	SHEET NO.	
PLOT SCALE = 1/8" = 1' / in.	DRAWN - _____	REVISED - _____			22	135(IJRS-2, IJRS-1)	FULTON	33	4	
PLOT DATE = 12/28/2011	CHECKED - _____	REVISED - _____			CONTRACT NO. 68978					
	DATE - _____	REVISED - _____			SCALE: _____	SHEET NO. _____ OF _____ SHEETS	STA. _____ TO STA. _____	ILLINOIS FED. AID PROJECT		

PAVEMENT STATIONING NUMBERS & PLACEMENT

The Contractor shall provide labor and materials required to imprint pavement station numbers in the finished surface of the pavement and/or overlay. The numbers shall be approximately 3/4 inch (20mm) wide, 5 inches (125 mm) high and 5/8 inch (15 mm) deep.

The pavement station numbers shall be installed as specified herein:

Interval – 200 feet (English stationing) or 100 meters (metric stationing)

Bottom of Numbers – 6 inches (150 mm) from the inside edge of the pavement marking

Location:

- * 2,3, & 5 Lane Pavements – right edge of pavement in direction of increasing stations
- * Multi-Lane Divided Roadways – outside edge of pavement in both directions
- * Ramps – along baseline edge of pavement

Position – stations shall be placed so they can be read from the adjacent shoulder

Format – English (Metric) pavement stations shall use this format “XXX (XX + X00)” where X represents the pavement station

This work will not be paid for separately, but will be considered included in the cost of the associated pavement and/or overlay pay items.

FILE NAME = 68978.dgn	USER NAME = oppenzellerJJ	DESIGNED - _____	REVISED - _____	STATE OF ILLINOIS DEPARTMENT OF TRANSPORTATION	COMMITMENTS, GENERAL NOTES, JOB SPECIFIC NOTES	F.A.P. RTE. 22	SECTION 135C(ZIRS-2,(XIRS-1)	COUNTY FULTON	TOTAL SHEETS 33	SHEET NO. 5
PLOT SCALE = 1:8778 / in.	CHECKED - _____	REVISED - _____	SCALE: _____ SHEET NO. _____ OF _____ SHEETS STA. _____ TO STA. _____			CONTRACT NO. 68978				
PLOT DATE = 12/29/2011	DATE - _____	REVISED - _____	<small>ILLINOIS FED. AID PROJECT</small>							

BUTT JOINT CUTTING TIME RESTRICTION

Butt joints shall not be milled more than three (3) days prior to placement of the HMA surface course.

PAVING SURFACE COURSE

Continuous paving operations on the main roadway shall be maintained at all times during the construction of the hot-mix asphalt surface. No interruptions for side roads, entrances, turn lanes, etc. will be allowed.

ENGINEERS FIELD OFFICE

**Add the following sentence to the end of paragraph 670.02 (i) and 670.04 (e):
All of the telephone lines provided shall have unpublished numbers.**

FILE NAME = 68978.dgn	USER NAME = eppenzeller,jj	DESIGNED - _____	REVISED - _____	STATE OF ILLINOIS DEPARTMENT OF TRANSPORTATION	COMMITMENTS, GENERAL NOTES, JOB SPECIFIC NOTES	F.A.P. RTE.	SECTION	COUNTY	TOTAL SHEETS	SHEET NO.
	PLOT SCALE = 1/8" = 1' / in.	DRAWN - _____	REVISED - _____			22	135((ZRS-2,(XRS-1)	FULTON	33	6
	PLOT DATE = 12/28/2011	CHECKED - _____	REVISED - _____			CONTRACT NO. 68978				
						SCALE: _____	SHEET NO. _____ OF _____ SHEETS	STA. _____	TO STA. _____	
ILLINOIS FED. AID PROJECT										

BITUMINOUS MIXTURE REQUIREMENTS

2/9/2010

Contract 68978

Description IL 78 from Locust St. to SCL of Canton

The following mixture requirements are applicable for this project:

Mixture Use(s):	Polymer Surface Course	Incidental Surface Course	CI D Patches				
AC/PG:	SBS or SBR 70-22	PG 64-22	PG 64-22				
RAP% (Max): **	10%	15%	25%				
Design Air Voids:	4.0% @ N=50	4.0% @ N=50	4.0% @ N=50				
Mixture Composition:	IL 9.5 or IL12.5	IL 9.5 or IL12.5	IL 19.0				
Friction Aggregate:	Mixture E	Mixture C	N.A.				

Note: Individual lift thickness of each mix type will be no less than 3 times nominal maximum aggregate size and no more than 6 times nominal maximum aggregate size.

Designer JJ Appenzeller
esals xxx

Designer Notes Polymer N50 E used due to urban environment in Canton

POLYMERIZED BITUMINOUS MATERIALS (PRIME COAT) RATES

Surface Type	Estimated Truck Application Rate	Residual Rate
Milled (HMA or PCC)	0.08 gal/sy (0.00034 ton/sy)	0.04 gal/sy
Existing Pavement	0.05 gal/sy (0.00022 ton/sy)	0.025 gal/sy
Fog Coat (between lifts)	0.05 gal/sy (0.00022 ton/sy)	0.025 gal/sy

Note: Estimated truck application rate is used for estimating quantities.

USER NAME = appenzellerjj	DESIGNED - _____	REVISED - _____	STATE OF ILLINOIS DEPARTMENT OF TRANSPORTATION	COMMITMENTS, GENERAL NOTES, JOB SPECIFIC NOTES	F.A.P. RATE:	SECTION	COUNTY	TOTAL SHEETS	SHEET NO.	
PLOT SCALE = 1/8" = 1' / 1"	DRAWN - _____	REVISED - _____			22	135(I2RS-2, I2RS-1)	FULTON	33	7	
PLOT DATE = 12/20/2011	CHECKED - _____	REVISED - _____			SCALE: _____ SHEET NO. _____ OF _____ SHEETS STA. _____ TO STA. _____		CONTRACT NO. 68978			
	DATE - _____	REVISED - _____			ILLINOIS FED. AID PROJECT					

SUMMARY OF QUANTITIES

	CODE NO.	ITEM	UNIT	TOT. QTY	CONSTRUCTION TYPE CODE	
					IL 78 FULTON	NO. 0021
					NO. 0005	SIGNALS
					80% FED	80% FED
					20% STATE	10% STATE
		10% CITY				
	40600215	POLMERIZED BITUMINOUS MATERIALS (PRIME COAT)	TON	13	13	
	40600300	AGGREGATE (PRIME COAT)	TON	78	78	
	40600895	CONSTRUCTING TEST STRIP	EACH	1	1	
	40600982	HOT-MIX ASPHALT SURFACE REMOVAL-BUTT JOINT	SQ YD	4525	4525	
	40600990	TEMPORARY RAMP	SQ YD	526	526	
	40603560	POLMERIZED HOT-MIX ASPHALT SURFACE COURSE, MIX "E", N50	TON	3836	3836	
	40800050	INCIDENTAL HOT-MIX ASPHALT SURFACING	TON	540	540	
	42400100	PORTLAND CEMENT CONCRETE SIDEWALK 4 INCH	SQ FT	75		75
	44000157	HOT-MIX ASPHALT SURFACE REMOVAL, 2"	SQ YD	34677	34677	
	44000600	SIDEWALK REMOVAL	SQ FT	75		75
	44201815	CLASS D PATCHES, TYPE II, 14 INCH	SQ YD	196	196	
	44201819	CLASS D PATCHES, TYPE III, 14 INCH	SQ YD	132	132	
	44201821	CLASS D PATCHES, TYPE IV, 14 INCH	SQ YD	52	52	
	44300200	STRIP REFLECTIVE CRACK CONTROL TREATMENT	FOOT	6072	6072	
	67100100	MOBILIZATION	L SUM	1	1	
	70102620	TRAFFIC CONTROL AND PROTECTION, STANDARD 701501	L SUM	1	1	
	70102622	TRAFFIC CONTROL AND PROTECTION, STANDARD 701502	L SUM	1	1	
	70102635	TRAFFIC CONTROL AND PROTECTION, STANDARD 701701	L SUM	1	1	

USER NAME = appenzeller-ji	DESIGNED - _____	REVISED - _____	STATE OF ILLINOIS DEPARTMENT OF TRANSPORTATION	SUMMARY OF QUANTITIES	F.A.P. RTE. 22	SECTION 135RS-7	COUNTY FULTON	TOTAL SHEETS 33	SHEET NO. 8
PLOT SCALE = 1/1144" = 1' in.	CHECKED - _____	REVISED - _____		SCALE: _____	SHEET NO. ___ OF ___ SHEETS		CONTRACT NO. 68978		
PLOT DATE = 2/1/2012	DATE - _____	REVISED - _____			STA. _____ TO STA. _____		ILLINOIS FED. AID PROJECT		

SUMMARY OF QUANTITIES

					CONSTRUCTION TYPE CODE	
					IL 78 FULTON	NO. 0021
					NO. 0005	SIGNALS
					80% FED	80% FED
					20% STATE	10% STATE
	CODE NO.	ITEM	UNIT	TOT. QTY		
	70300100	SHORT-TERM PAVEMENT MARKING	FOOT	11705	11705	
	70300210	TEMPORARY PAVEMENT MARKING-LETTERS AND SYMBOLS	SQ FT	499	499	
	70300220	TEMPORARY PAVEMENT MARKING-LINE 4"	FOOT	17845	17845	
	70300240	TEMPORARY PAVEMENT MARKING-LINE 6"	FOOT	4794	4794	
	70300250	TEMPORARY PAVEMENT MARKING-LINE 8"	FOOT	930	930	
	70300260	TEMPORARY PAVEMENT MARKING-LINE 12"	FOOT	586	586	
	70300280	TEMPORARY PAVEMENT MARKING-LINE 24"	FOOT	550	550	
	70301000	WORK ZONE PAVEMENT MARKING REMOVAL	SQ FT	965	965	
X	72000100	SIGN PANEL-TYPE 1	SQ FT	20		20
X	78009000	MODIFIED URETHANE PAVEMENT MARKING-LETTERS AND SYMBOLS	SQ FT	499	499	
X	78009004	MODIFIED URETHANE PAVEMENT MARKING-LINE 4"	FOOT	17845	17845	
X	78009006	MODIFIED URETHANE PAVEMENT MARKING-LINE 6"	FOOT	4794	4794	
X	78009008	MODIFIED URETHANE PAVEMENT MARKING-LINE 8"	FOOT	930	930	
X	78009012	MODIFIED URETHANE PAVEMENT MARKING-LINE 12"	FOOT	586	586	
X	78009024	MODIFIED URETHANE PAVEMENT MARKING-LINE 24"	FOOT	550	550	
X	78100100	RAISED REFLECTIVE PAVEMENT MARKER	EACH	283	283	
	78300100	PAVEMENT MARKING REMOVAL	SQ FT	10528	10528	
X	78300200	RAISED REFLECTIVE PAVEMENT MARKER REMOVAL	EACH	283	283	

X SPECIALTY ITEM

USER NAME = appenzeller,jj PLOT SCALE = 1/8" = 1' / in. PLOT DATE = 2/1/2012	DESIGNED - _____ DRAWN - _____ CHECKED - _____ DATE - _____	REVISED - _____ REVISED - _____ REVISED - _____ REVISED - _____	STATE OF ILLINOIS DEPARTMENT OF TRANSPORTATION	SUMMARY OF QUANTITIES SCALE: _____ SHEET NO. ____ OF ____ SHEETS STA. _____ TO STA. _____	<table border="1" style="width: 100%; border-collapse: collapse;"> <tr> <th style="font-size: small;">F.A.P. RTE.</th> <th style="font-size: small;">SECTION</th> <th style="font-size: small;">COUNTY</th> <th style="font-size: small;">TOTAL SHEETS</th> <th style="font-size: small;">SHEET NO.</th> </tr> <tr> <td style="text-align: center;">22</td> <td style="text-align: center;">135RS-7</td> <td style="text-align: center;">FULTON</td> <td style="text-align: center;">33</td> <td style="text-align: center;">9</td> </tr> <tr> <td colspan="5" style="text-align: center; font-size: x-small;">CONTRACT NO. 68978</td> </tr> <tr> <td colspan="5" style="text-align: center; font-size: x-small;">ILLINOIS FED. AID PROJECT</td> </tr> </table>	F.A.P. RTE.	SECTION	COUNTY	TOTAL SHEETS	SHEET NO.	22	135RS-7	FULTON	33	9	CONTRACT NO. 68978					ILLINOIS FED. AID PROJECT				
F.A.P. RTE.	SECTION	COUNTY	TOTAL SHEETS	SHEET NO.																					
22	135RS-7	FULTON	33	9																					
CONTRACT NO. 68978																									
ILLINOIS FED. AID PROJECT																									

SUMMARY OF QUANTITIES

					CONSTRUCTION TYPE CODE	
					IL 78 FULTON	NO. 0021
					NO. 0005	SIGNALS
					80% FED	80% FED
					20% STATE	10% STATE
	CODE NO.	ITEM	UNIT	TOT. QTY		10% CITY
X	81028340	UNDERGROUND CONDUIT,PVC,1 1/2" DIA.	FOOT	40		40
X	87301245	ELECTRIC CABLE IN CONDUIT,SIGNAL NO.14 5C	FOOT	1189		1189
X	87301515	ELECTRIC CABLE IN CONDUIT,LEAD-IN,NO. 18 3 PAIR	FOOT	472		472
X	87900200	DRILL EXISTING HANDHOLE	EACH	4		4
X	88030050	SIGNAL HEAD,LED, 1-FACE, 3-SECTION,BRACKET MOUNTED	EACH	3		3
X	88102740	PEDESTRIAN SIGNAL HEAD,LED, 2-FACE,BRACKET MOUNTED	EACH	4		4
X	88500100	INDUCTIVE LOOP DETECTOR	EACH	9		9
X	88600100	DETECTOR LOOP,TYPE I	FOOT	1689		1689
X	88800100	PEDESTRIAN PUSH-BUTTON	EACH	8		8
X	89502105	REBUILD EXISTING SIGNAL HEAD,LED	EACH	8		8
X	89502210	MODIFY EXISTING CONTROLLER CABINET	EACH	1		1
X	89502375	REMOVE EXISTING TRAFFIC SIGNAL EQUIPMENT	EACH	1		1
	X2020110	GRADING AND SHAPING SHOULDERS	UNIT	24	24	
X	Z0033002	LED SIGNAL FACE RETROFIT,RED BALL	EACH	5		5
X	Z0033004	LED SIGNAL FACE RETROFIT,GREEN BALL	EACH	5		5
X	Z0033008	LED SIGNAL FACE RETROFIT,YELLOW BALL	EACH	5		5
	Z0034105	MATERIAL TRANSFER DEVICE	TON	3836	3836	
	Z0048665	RAILROAD PROTECTIVE LIABILITY INSURANCE	L SUM	1	1	

X SPECIALTY
ITEM

USER NAME = appenzeller,jj PLOT SCALE = 1/8" = 1' / in. PLOT DATE = 2/1/2012	DESIGNED - _____ DRAWN - _____ CHECKED - _____ DATE - _____	REVISED - _____ REVISED - _____ REVISED - _____ REVISED - _____	STATE OF ILLINOIS DEPARTMENT OF TRANSPORTATION	SUMMARY OF QUANTITIES SCALE: _____ SHEET NO. ____ OF ____ SHEETS STA. _____ TO STA. _____	<table border="1" style="width: 100%; border-collapse: collapse;"> <tr> <td style="font-size: small;">F.A.P. RTE.</td> <td style="font-size: small;">SECTION</td> <td style="font-size: small;">COUNTY</td> <td style="font-size: small;">TOTAL SHEETS</td> <td style="font-size: small;">SHEET NO.</td> </tr> <tr> <td style="text-align: center;">22</td> <td style="text-align: center;">135RS-7</td> <td style="text-align: center;">FULTON</td> <td style="text-align: center;">33</td> <td style="text-align: center;">10</td> </tr> <tr> <td colspan="5" style="text-align: center; font-size: x-small;">CONTRACT NO.68978</td> </tr> <tr> <td colspan="5" style="text-align: center; font-size: x-small;">ILLINOIS FED. AID PROJECT</td> </tr> </table>	F.A.P. RTE.	SECTION	COUNTY	TOTAL SHEETS	SHEET NO.	22	135RS-7	FULTON	33	10	CONTRACT NO.68978					ILLINOIS FED. AID PROJECT				
F.A.P. RTE.	SECTION	COUNTY	TOTAL SHEETS	SHEET NO.																					
22	135RS-7	FULTON	33	10																					
CONTRACT NO.68978																									
ILLINOIS FED. AID PROJECT																									

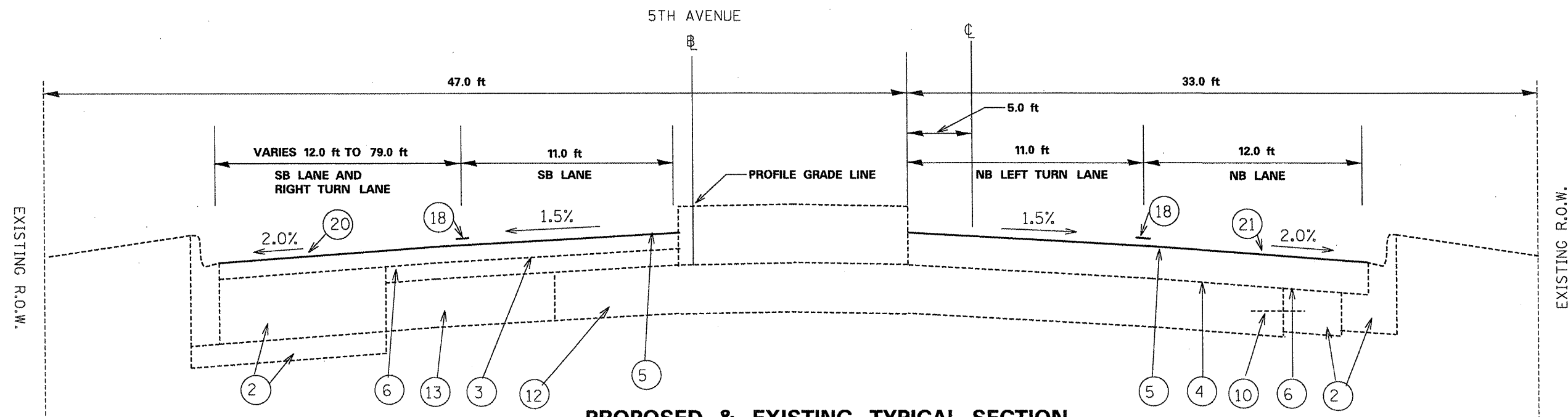

PROPOSED & EXISTING TYPICAL SECTION

Fifth Ave. and Locust St.

STA. 26+18 TO STA. 33+24

LEGEND

- ① EXIST. BIT. CONC. BASE COURSE WIDENING, 7.8 in AND
EXIST. AGG. BASE COURSE, TYPE B, 6 in AND
EXIST. GEOTECHNICAL FABRIC FOR GROUND STABILIZATION
- ② EXIST. P.C.C. BASE COURSE, WIDENING, 7.8 in AND
EXIST. AGG. BASE COURSE, TYPE B, 6 in AND
EXIST. GEOTECHNICAL FABRIC FOR GROUND STABILIZATION
- ③ EXIST. BIT. CONC. BINDER COURSE > 1.5 in
- ④ EXIST. POLYMERIZED LEVELING BINDER (MM), SUPERPAVE, 1 in
- ⑤ EXIST. POLYMERIZED BIT. CONC. SURFACE COURSE, SUPERPAVE, 1.5 in
- ⑥ EXIST. STRIP REFLECTIVE CRACK CONTROL TREATMENT, SYSTEM A
- ⑦ EXIST. BIT. SHOULDERS
- ⑧ EXIST. BIT. CONC. BINDER COURSE, SUPERPAVE, 1.5 in
- ⑨ EXIST. POLYMERIZED LEVELING BINDER, VARIABLE DEPTH
- ⑩ EXIST. #6 TIE BARS
- ⑪ EXIST. BIT. BASE COURSE, 7.8 in AND
EXIST. AGG. BASE COURSE, TYPE, B 6 in AND
EXIST. GEOTECHNICAL FABRIC FOR GROUND STABILIZATION
- ⑫ EXIST. P.C.C. PAVEMENT 8 in
- ⑬ EXIST. 8" BIT. BASE COURSE
- ⑭ EXIST. BIT. SURFACE COURSE 1.5 in
- ⑮ EXIST. BIT. BINDER COURSE, 1.5 in
- ⑯ EXIST. BIT. CONCRETE BASE COURSE 9"
- ⑰ EXIST. AGG. SHOULDERS, TY. B 6"

LEGEND

- ⑱ PROP. URETHANE PAVEMENT MRAKING
- ⑲ PROP. GRADING AND SHAPING EXISTING SHOULDER
- ⑳ PROP. POLY. HOT - MIX ASPHALT SURFACE COURSE, MIX "E", N50
- ㉑ PROP. HOT - MIX ASPHALT SURFACE REMOVAL, 2.0"

NOTE

TYPICAL SECTION IS FACING NORTH

FILE NAME = 68978.dgn	USER NAME = oppenzeller_jj	DESIGNED -	REVISIONS -	STATE OF ILLINOIS DEPARTMENT OF TRANSPORTATION	EXISTING AND PROPOSED TYPICAL SECTION	F.A.P. RTE. 22	SECTION 135(2)RS-2,(X)RS-11	COUNTY FULTON	TOTAL SHEETS 33	SHEET NO. 11		
	PLOT SCALE = 1/8" = 1' / in.	DRAWN -	REVISIONS -			SCALE: _____	SHEET NO. _____ OF _____ SHEETS	STA. _____ TO STA. _____	CONTRACT NO. 68978			
	PLOT DATE = 1/25/2012	CHECKED -	REVISIONS -			ILLINOIS FED. AID PROJECT						
		DATE -	REVISIONS -									

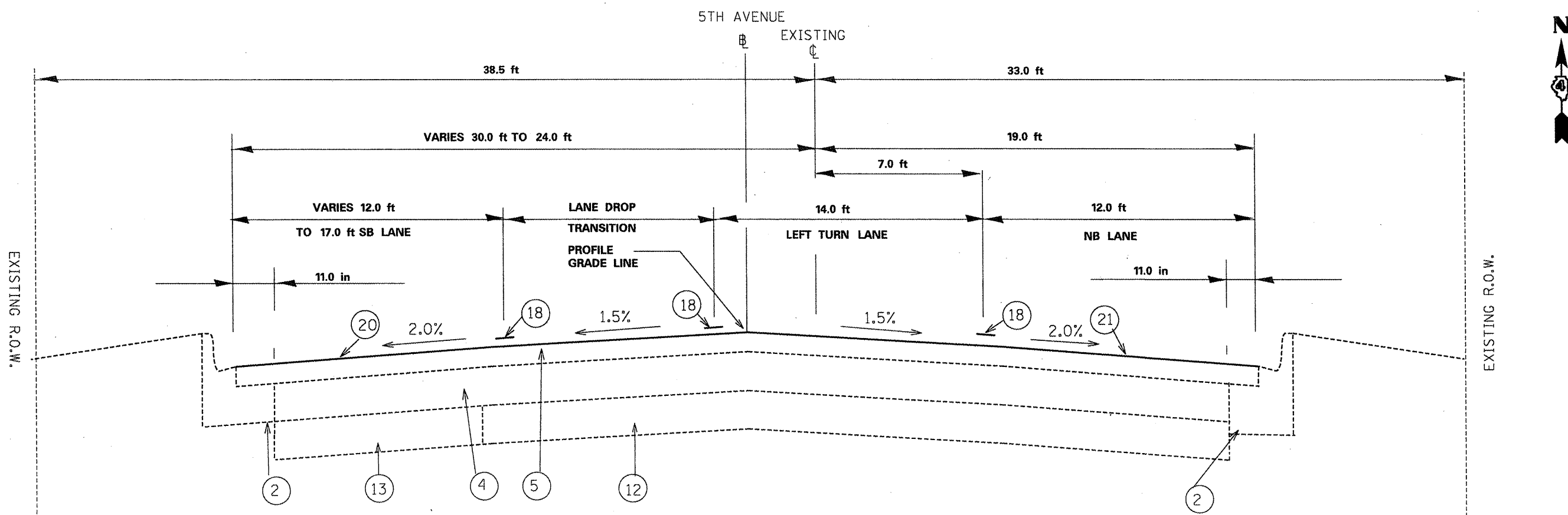

PROPOSED & EXISTING TYPICAL SECTION

IL78/IL9

STA. 33+24 TO STA. 34+68

LEGEND

- ① EXIST. BIT. CONC. BASE COURSE WIDENING, 7.8 in AND EXIST. AGG. BASE COURSE, TYPE B, 6 in AND EXIST. GEOTECHNICAL FABRIC FOR GROUND STABILIZATION
- ② EXIST. P.C.C. BASE COURSE, WIDENING, 7.8 in AND EXIST. AGG. BASE COURSE, TYPE B, 6 in AND EXIST. GEOTECHNICAL FABRIC FOR GROUND STABILIZATION
- ③ EXIST. BIT. CONC. BINDER COURSE > 1.5 in
- ④ EXIST. POLYMERIZED LEVELING BINDER (MM), SUPERPAVE, 1 in
- ⑤ EXIST. POLYMERIZED BIT. CONC. SURFACE COURSE, SUPERPAVE, 1.5 in
- ⑥ EXIST. STRIP REFLECTIVE CRACK CONTROL TREATMENT, SYSTEM A
- ⑦ EXIST. BIT. SHOULDERS
- ⑧ EXIST. BIT. CONC. BINDER COURSE, SUPERPAVE, 1.5 in
- ⑨ EXIST. POLYMERIZED LEVELING BINDER, VARIABLE DEPTH
- ⑩ EXIST. #6 TIE BARS

LEGEND

- ⑪ EXIST. BIT. BASE COURSE, 7.8 in AND EXIST. AGG. BASE COURSE, TYPE, B 6 in AND EXIST. GEOTECHNICAL FABRIC FOR GROUND STABILIZATION
- ⑫ EXIST. P.C.C. PAVEMENT 8 in
- ⑬ EXIST. 8" BIT. BASE COURSE
- ⑭ EXIST. BIT. SURFACE COURSE 1.5 in
- ⑮ EXIST. BIT. BINDER COURSE, 1.5 in
- ⑯ EXIST. BIT. CONCRETE BASE COURSE 9"
- ⑰ EXIST. AGG. SHOULDERS, TY. B 6"
- ⑱ PROP. URETHANE PAVEMENT MRAKING
- ⑲ PROP. GRADING AND SHAPING EXISTING SHOULDER
- ⑳ PROP. POLY. HOT - MIX ASPHALT SURFACE COURSE, MIX "E", N50
- ㉑ PROP. HOT - MIX ASPHALT SURFACE REMOVAL, 2.0"

NOTE

TYPICAL SECTION IS FACING NORTH

FILE NAME = 68978.dgn	USER NAME = apenzeller.jj	DESIGNED - DRAWN -	REVISED - REVISED -
	PLOT SCALE = 1/8" = 1' / in.	CHECKED -	REVISED -
	PLOT DATE = 1/25/2012	DATE -	REVISED -

**STATE OF ILLINOIS
DEPARTMENT OF TRANSPORTATION**

EXISTING AND PROPOSED TYPICAL SECTION

SCALE: _____ SHEET NO. _____ OF _____ SHEETS STA. _____ TO STA. _____

F.A.P. RTE.	SECTION	COUNTY	TOTAL SHEETS	SHEET NO.
22	135(12)RS-2, (13)RS-1	FULTON	33	12
CONTRACT NO. 68978 ILLINOIS FED. AID PROJECT				

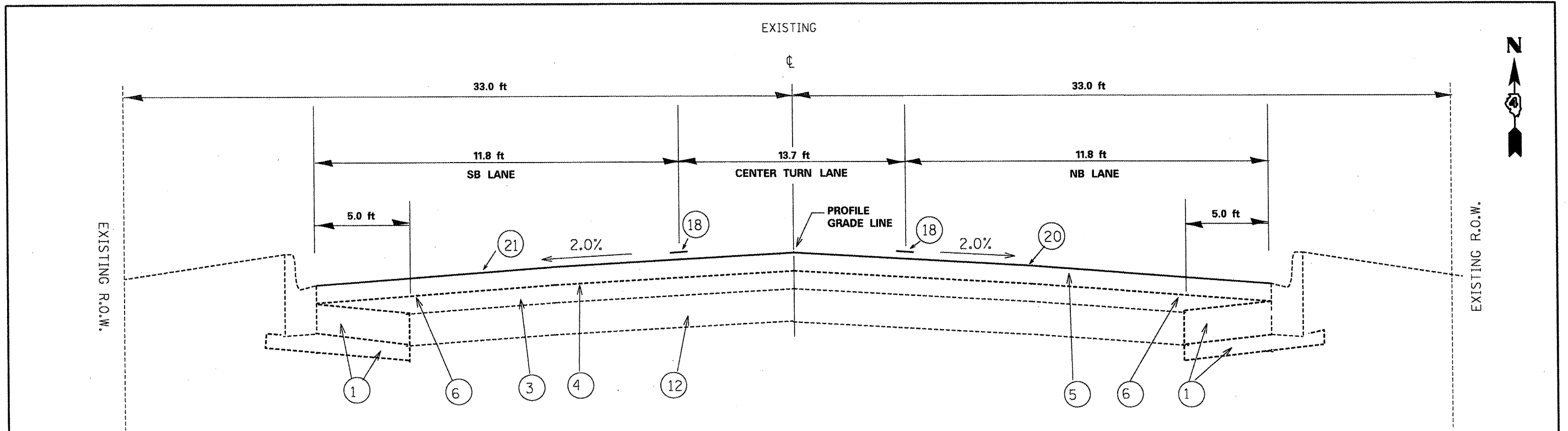

PROPOSED & EXISTING TYPICAL SECTION

IL78/IL9

STA. 34+68 TO STA. 67+78

LEGEND

- ① EXIST. BIT. CONC. BASE COURSE WIDENING, 7.8 in AND EXIST. AGG. BASE COURSE, TYPE B, 6 in AND EXIST. GEOTECHNICAL FABRIC FOR GROUND STABILIZATION
- ② EXIST. P.C.C. BASE COURSE, WIDENING, 7.8 in AND EXIST. AGG. BASE COURSE, TYPE B, 6 in AND EXIST. GEOTECHNICAL FABRIC FOR GROUND STABILIZATION
- ③ EXIST. BIT. CONC. BINDER COURSE > 1.5 in
- ④ EXIST. POLYMERIZED LEVELING BINDER (MM), SUPERPAVE, 1 in
- ⑤ EXIST. POLYMERIZED BIT. CONC. SURFACE COURSE, SUPERPAVE, 1.5 in
- ⑥ EXIST. STRIP REFLECTIVE CRACK CONTROL TREATMENT, SYSTEM A
- ⑦ EXIST. BIT. SHOULDERS
- ⑧ EXIST. BIT. CONC. BINDER COURSE, SUPERPAVE, 1.5 in
- ⑨ EXIST. POLYMERIZED LEVELING BINDER, VARIABLE DEPTH
- ⑩ EXIST. #6 TIE BARS
- ⑪ EXIST. BIT. BASE COURSE, 7.8 in AND EXIST. AGG. BASE COURSE, TYPE, B 6 in AND EXIST. GEOTECHNICAL FABRIC FOR GROUND STABILIZATION
- ⑫ EXIST. P.C.C. PAVEMENT 8 in
- ⑬ EXIST. 8" BIT. BASE COURSE
- ⑭ EXIST. BIT. SURFACE COURSE 1.5 in
- ⑮ EXIST. BIT. BINDER COURSE, 1.5 in
- ⑯ EXIST. BIT. CONCRETE BASE COURSE 9"
- ⑰ EXIST. AGG. SHOULDERS, TY. B 6"

LEGEND

- ⑱ PROP. URETHANE PAVEMENT MAKING
- ⑲ PROP. GRADING AND SHAPING EXISTING SHOULDER
- ⑳ PROP. POLY. HOT - MIX ASPHALT SURFACE COURSE, MIX "E", N50
- ㉑ PROP. HOT - MIX ASPHALT SURFACE REMOVAL, 2.0"

NOTE

TYPICAL SECTION IS FACING NORTH

FILE NAME = 68978.dgn	USER NAME = appenzellerJJ	DESIGNED -	REVISED -	STATE OF ILLINOIS DEPARTMENT OF TRANSPORTATION	EXISTING AND PROPOSED TYPICAL SECTION	F.A.P. RTE. 22	SECTION 135((Z)RS-2,(X)RS-11)	COUNTY FULTON	TOTAL SHEETS 33	SHEET NO. 13
	PLT SCALE = 1/8" = 1' / in.	CHECKED -	REVISED -			CONTRACT NO. 68978				
	PLT DATE = 1/25/2012	DATE -	REVISED -			ILLINOIS FED. AID PROJECT				

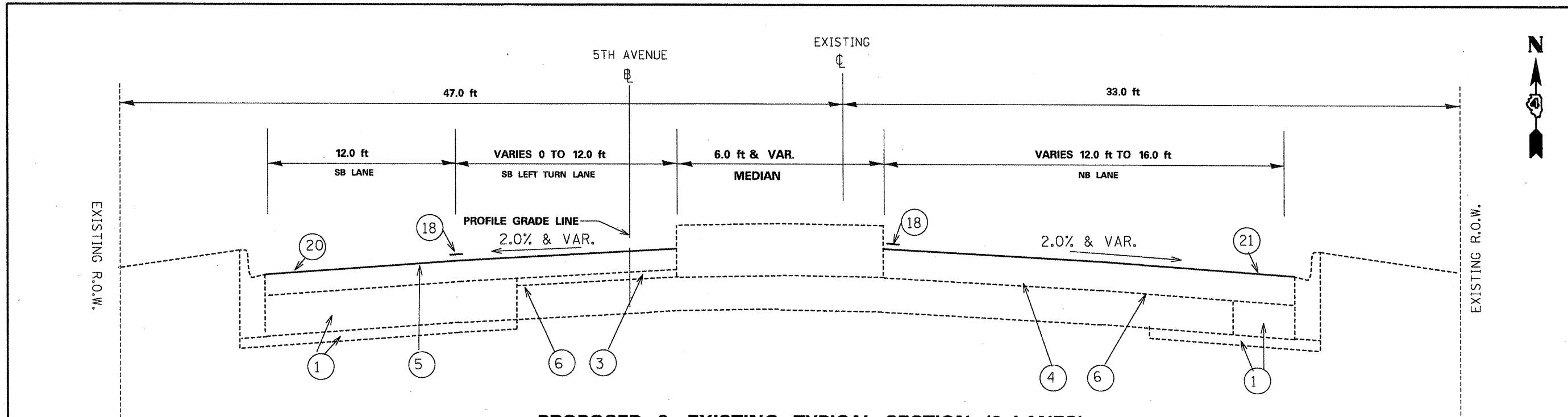

PROPOSED & EXISTING TYPICAL SECTION (3 LANES)

Fifth Ave. and Linn St.

STA. 67+78 TO STA. 74+02

LEGEND

- ① EXIST. BIT. CONC. BASE COURSE WIDENING, 7.8 in AND
EXIST. AGG. BASE COURSE, TYPE B, 6 in AND
EXIST. GEOTECHNICAL FABRIC FOR GROUND STABILIZATION
- ② EXIST. P.C.C. BASE COURSE, WIDENING, 7.8 in AND
EXIST. AGG. BASE COURSE, TYPE B, 6 in AND
EXIST. GEOTECHNICAL FABRIC FOR GROUND STABILIZATION
- ③ EXIST. BIT. CONC. BINDER COURSE > 1.5 in
- ④ EXIST. POLYMERIZED LEVELING BINDER (MM), SUPERPAVE, 1 in
- ⑤ EXIST. POLYMERIZED BIT. CONC. SURFACE COURSE, SUPERPAVE, 1.5 in
- ⑥ EXIST. STRIP REFLECTIVE CRACK CONTROL TREATMENT, SYSTEM A
- ⑦ EXIST. BIT. SHOULDERS
- ⑧ EXIST. BIT. CONC. BINDER COURSE, SUPERPAVE, 1.5 in
- ⑨ EXIST. POLYMERIZED LEVELING BINDER, VARIABLE DEPTH
- ⑩ EXIST. #6 TIE BARS
- ⑪ EXIST. BIT. BASE COURSE, 7.8 in AND
EXIST. AGG. BASE COURSE, TYPE, B 6 in AND
EXIST. GEOTECHNICAL FABRIC FOR GROUND STABILIZATION
- ⑫ EXIST. P.C.C. PAVEMENT 8 in
- ⑬ EXIST. 8" BIT. BASE COURSE
- ⑭ EXIST. BIT. SURFACE COURSE 1.5 in
- ⑮ EXIST. BIT. BINDER COURSE, 1.5 in
- ⑯ EXIST. BIT. CONCRETE BASE COURSE 9"
- ⑰ EXIST. AGG. SHOULDERS, TY. B 6"

LEGEND

- ⑱ PROP. URETHANE PAVEMENT MAKING
- ⑲ PROP. GRADING AND SHAPING EXISTING SHOULDER
- ⑳ PROP. POLY. HOT - MIX ASPHALT SURFACE COURSE, MIX "E", N50
- ㉑ PROP. HOT - MIX ASPHALT SURFACE REMOVAL, 2.0"

NOTE

TYPICAL SECTION IS FACING NORTH

FILE NAME = 68978.dgn	USER NAME = appenzeller, JJ	DESIGNED -	REVISED -	STATE OF ILLINOIS DEPARTMENT OF TRANSPORTATION	EXISTING AND PROPOSED TYPICAL SECTION	F.A.P. RTE. 22	SECTION 135(Z)RS-2,(X)RS-13	COUNTY FULTON	TOTAL SHEETS 33	SHEET NO. 14		
PLOT SCALE = 1:1144' / 1/4"	CHECKED -	REVISED -	SCALE: _____ SHEET NO. _____ OF _____ SHEETS STA. _____ TO STA. _____			ILLINOIS FED. AID PROJECT CONTRACT NO. 68978						
PLOT DATE = 1/25/2012	DATE -	REVISED -										

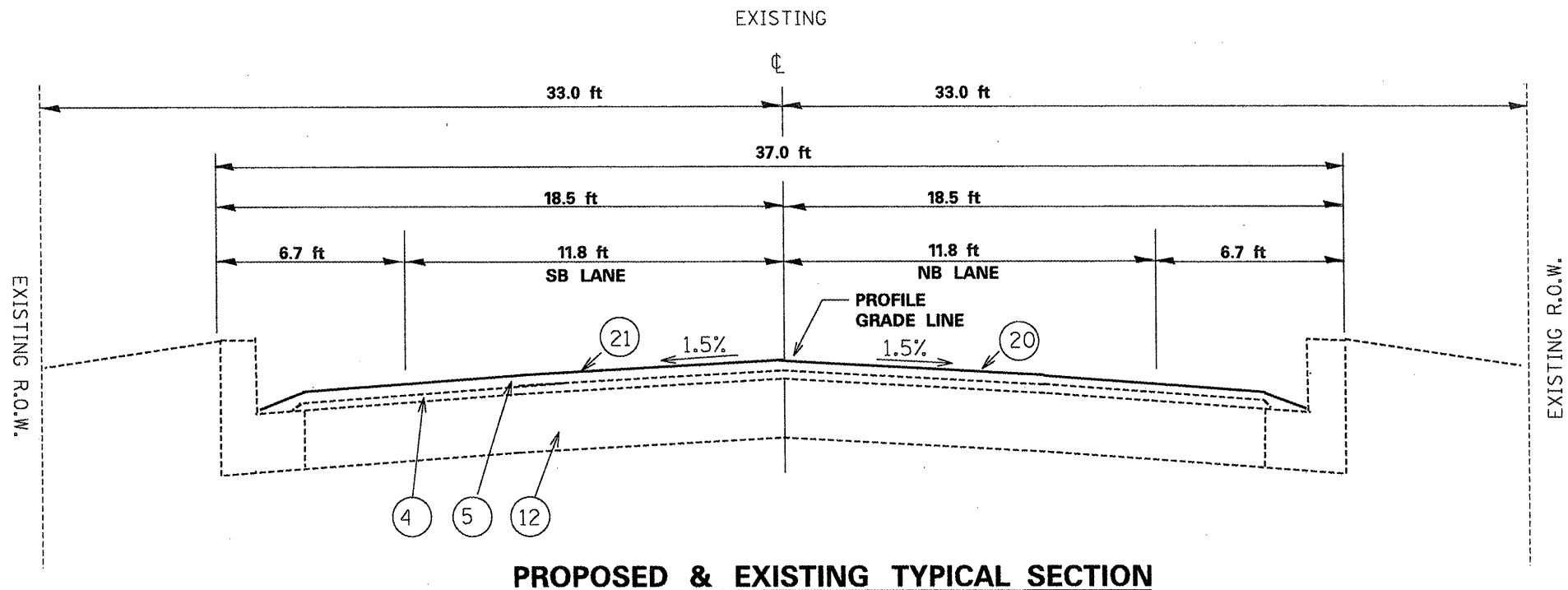

PROPOSED & EXISTING TYPICAL SECTION

LEGEND

- ① EXIST. BIT. CONC. BASE COURSE WIDENING, 7.8 in AND
EXIST. AGG. BASE COURSE, TYPE B, 6 in AND
EXIST. GEOTECHNICAL FABRIC FOR GROUND STABILIZATION
- ② EXIST. P.C.C. BASE COURSE, WIDENING, 7.8 in AND
EXIST. AGG. BASE COURSE, TYPE B, 6 in AND
EXIST. GEOTECHNICAL FABRIC FOR GROUND STABILIZATION
- ③ EXIST. BIT. CONC. BINDER COURSE > 1.5 in
- ④ EXIST. POLYMERIZED LEVELING BINDER (MM), SUPERPAVE, 1 in
- ⑤ EXIST. POLYMERIZED BIT. CONC. SURFACE COURSE, SUPERPAVE, 1.5 in
- ⑥ EXIST. STRIP REFLECTIVE CRACK CONTROL TREATMENT, SYSTEM A
- ⑦ EXIST. BIT. SHOULDERS
- ⑧ EXIST. BIT. CONC. BINDER COURSE, SUPERPAVE, 1.5 in
- ⑨ EXIST. POLYMERIZED LEVELING BINDER, VARIABLE DEPTH
- ⑩ EXIST. #6 TIE BARS
- ⑪ EXIST. BIT. BASE COURSE, 7.8 in AND
EXIST. AGG. BASE COURSE, TYPE B, 6 in AND
EXIST. GEOTECHNICAL FABRIC FOR GROUND STABILIZATION
- ⑫ EXIST. P.C.C. PAVEMENT 8 in
- ⑬ EXIST. 8" BIT. BASE COURSE
- ⑭ EXIST. BIT. SURFACE COURSE 1.5 in
- ⑮ EXIST. BIT. BINDER COURSE, 1.5 in
- ⑯ EXIST. BIT. CONCRETE BASE COURSE 9"
- ⑰ EXIST. AGG. SHOULDERS, TY. B 6"

IL78/IL9

STA. 74+02 TO STA. 87+00

LEGEND

- ⑱ PROP. URETHANE PAVEMENT MRAKING
- ⑲ PROP. GRADING AND SHAPING EXISTING SHOULDER
- ⑳ PROP. POLY. HOT - MIX ASPHALT SURFACE COURSE, MIX "E", N50
- ㉑ PROP. HOT - MIX ASPHALT SURFACE REMOVAL, 2.0"

NOTE

TYPICAL SECTION IS FACING NORTH

FILE NAME = 68978.dgn	USER NAME = apenzeller.jj	DESIGNED - _____	REVISED - _____	STATE OF ILLINOIS DEPARTMENT OF TRANSPORTATION	EXISTING AND PROPOSED TYPICAL SECTION	F.A.P. RTE. 22	SECTION 135(ZIRS-2, XIRS-1)	COUNTY FULTON	TOTAL SHEETS 33	SHEET NO. 15
PLOT SCALE = 1/8" = 1'-0"		DRAWN - _____	REVISED - _____	SCALE: _____ SHEET NO. _____ OF _____ SHEETS STA. _____ TO STA. _____		CONTRACT NO. 68978		ILLINOIS FED. AID PROJECT		
PLOT DATE = 1/25/2012		CHECKED - _____	REVISED - _____							
		DATE - _____	REVISED - _____							

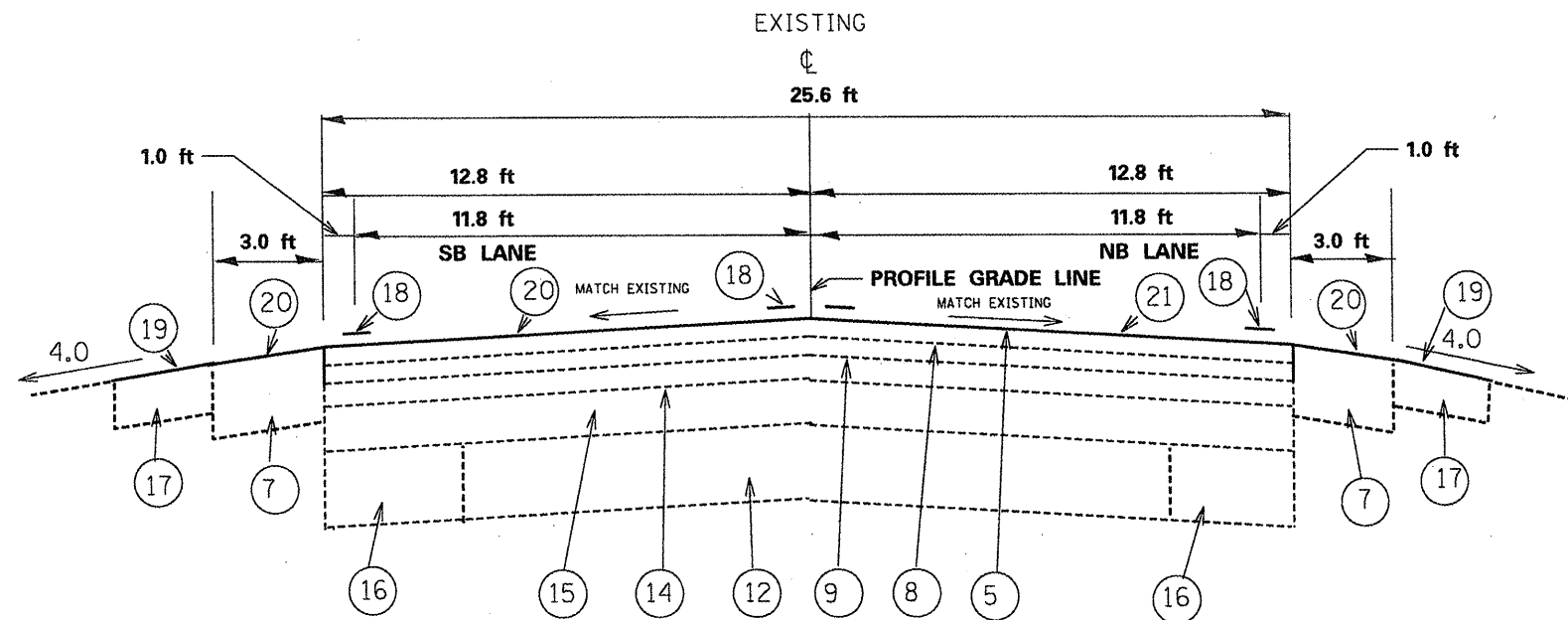

PROPOSED & EXISTING TYPICAL SECTION

STA. 87+00 TO STA. 96+54

LEGEND

- ① EXIST. BIT. CONC. BASE COURSE WIDENING, 7.8 in AND
EXIST. AGG. BASE COURSE, TYPE B, 6 in AND
EXIST. GEOTECHNICAL FABRIC FOR GROUND STABILIZATION
- ② EXIST. P.C.C. BASE COURSE, WIDENING, 7.8 in AND
EXIST. AGG. BASE COURSE, TYPE B, 6 in AND
EXIST. GEOTECHNICAL FABRIC FOR GROUND STABILIZATION
- ③ EXIST. BIT. CONC. BINDER COURSE > 1.5 in
- ④ EXIST. POLYMERIZED LEVELING BINDER (MM), SUPERPAVE, 1 in
- ⑤ EXIST. POLYMERIZED BIT. CONC. SURFACE COURSE, SUPERPAVE, 1.5 in
- ⑥ EXIST. STRIP REFLECTIVE CRACK CONTROL TREATMENT, SYSTEM A
- ⑦ EXIST. BIT. SHOULDERS
- ⑧ EXIST. BIT. CONC. BINDER COURSE, SUPERPAVE, 1.5 in
- ⑨ EXIST. POLYMERIZED LEVELING BINDER, VARIABLE DEPTH
- ⑩ EXIST. #6 TIE BARS
- ⑪ EXIST. BIT. BASE COURSE, 7.8 in AND
EXIST. AGG. BASE COURSE, TYPE B 6 in AND
EXIST. GEOTECHNICAL FABRIC FOR GROUND STABILIZATION
- ⑫ EXIST. P.C.C. PAVEMENT 8 in
- ⑬ EXIST. 8" BIT. BASE COURSE
- ⑭ EXIST. BIT. SURFACE COURSE 1.5 in
- ⑮ EXIST. BIT. BINDER COURSE, 1.5 in
- ⑯ EXIST. BIT. CONCRETE BASE COURSE 9"
- ⑰ EXIST. AGG. SHOULDERS, TY. B 6"

LEGEND

- ⑱ PROP. URETHANE PAVEMENT MRAKING
- ⑲ PROP. EXCAVATING AND GRADING EXISTING SHOULDER
- ⑳ PROP. POLY. HOT - MIX ASPHALT SURFACE COURSE, MIX "E", N50
- ㉑ PROP. HOT - MIX ASPHALT SURFACE REMOVAL, 2.0"

NOTE

TYPICAL SECTION IS FACING NORTH

FILE NAME = 68978.dgn	USER NAME = appenzeller,jj	DESIGNED -	REVISED -	STATE OF ILLINOIS DEPARTMENT OF TRANSPORTATION	EXISTING AND PROPOSED TYPICAL SECTION	F.A.P. RTE.	SECTION	COUNTY	TOTAL SHEETS	SHEET NO.
	PLOT SCALE = 1/8778" = 1/8"	DRAWN -	REVISED -			22	135(I/RS-2, I/RS-1)	FULTON	33	16
PLOT DATE = 1/25/2012	CHECKED -	REVISED -	DATE -	SCALE: _____	SHEET NO. _____ OF _____ SHEETS	STA. _____ TO STA. _____	CONTRACT NO. 68978 ILLINOIS FED. AID PROJECT			

TABULATION OF RESURFACING QUANTITIES													
LOCATION	TOTAL ROADWAY WIDTH	LENGTH	AREA	BITUMINOUS SURFACE REMOVAL BUTT JOINT	TEMPORARY RAMP	BITUMINOUS SURFACE REMOVAL 2"	BITUMINOUS MATERIALS PRIME COAT	AGGREGATE MATERIALS PRIME COAT	INCIDENTAL SURF CSE MIX C N50	POLY HMA SURF CSE MIX E N50	MATERIAL TRANSFER DEVICE		
	FT	FT	SQ YD	SQ YD	SQ YD	SQ YD	TON	TON	TON	TON	TON	TON	TON
Locust Main Line (IL 78)													
STA. 24 + 56 TO 24 + 78	38.00	22.00	92.80	92.80	15.55		0.03	0.18			10.40	10.40	
STA. 24 + 78 TO 26 + 06	38.00	128.00	540.44			540.44	0.18	1.08			60.43	60.43	
STA. 26 + 48 TO 26 + 60	46.50	12.00	62.00			62.00	0.02	0.12	7.00				
STA. 26 + 60 TO 26 + 98	33.00	38.00	139.33	139.33	18.33		0.04	0.27	15.60				
Locust Main Line (IL 78)													
Right Turn Lane													
STA. 0 + 00 TO 0 + 22	11.00	22.00	26.80	26.80	6.11		0.01	0.05			3.00	3.00	
STA. 0 + 22 TO 0 + 96	15.75	74.00	129.00			129.00	0.04	0.25			14.44	14.44	
STA. 0 + 96 TO 1 + 76	22.00	80.00	195.00			195.00	0.06	0.39			21.84	21.84	
STA. 1 + 76 TO 2 + 25	19.50	49.00	106.00			106.00	0.03	0.21			11.87	11.87	
5th Ave Main Line (IL 78)													
STA. 25 + 52 TO 25 + 82	47.00	30.00	156.66	156.66	18.88		0.05	0.31	17.54				
STA. 25 + 82 TO 26 + 42	42.00	60.00	280.00			280.00	0.10	0.56			31.36	31.36	
STA. 26 + 42 TO 27 + 39	12.00	97.00	129.33			129.33	0.04	0.25			14.48	14.48	
STA. 26 + 42 TO 27 + 39	23.00	97.00	247.88			247.88	0.08	0.49			27.76	27.76	
STA. 27 + 39 TO 30 + 82	58.00	343.00	2210.44			2210.44	0.75	4.42			247.57	247.57	
STA. 30 + 82 TO 34 + 82	52.00	400.00	2311.11			2311.11	0.78	4.62			258.84	258.84	
STA. 34 + 82 TO 39 + 82	40.50	500.00	2250.00			2250.00	0.76	4.50			252.00	252.00	
STA. 39 + 82 TO 67 + 82	43.00	2800.00	13377.77			13377.77	4.54	26.75			1498.31	1498.31	
STA. 67 + 82 TO 69 + 82	16.00	200.00	355.55			355.55	0.12	0.71			39.82	39.82	
STA. 67 + 82 TO 69 + 82	26.00	200.00	577.77			577.77	0.20	1.15			64.71	64.71	
STA. 69 + 82 TO 70 + 21	7.00	39.00	30.33			30.33	0.01	0.06			3.40	3.40	
STA. 70 + 21 TO 74 + 21	43.50	400.00	1933.33			1933.33	0.65	3.86			216.53	216.53	
STA. 74 + 21 TO 87 + 21	31.00	1300.00	4477.77			4477.77	1.52	8.95			501.51	501.51	
STA. 87 + 21 TO 96 + 21	24.00	900.00	2400.00			2400.00	0.81	4.80			268.80	268.80	
STA. 96 + 21 TO 96 + 54	24.00	33.00	88.00	88.00	13.33		0.03	0.17			9.85	9.85	
Shoulder													
STA. 87 + 21 TO 96 + 21	8.00	900.00	800.00			800.00	0.27	1.60			89.60	89.60	
STA. 96 + 21 TO 96 + 54	8.00	33.00	29.33	29.33	4.44		0.01	0.05			3.28	3.28	
East Linn Street (IL9)													
	38.00	252.00	1064.00			1064.00	0.36	2.12			119.16	119.16	
			10.55			10.55	0.00	0.02			1.21	1.21	
East Linn Street (IL9)													
	38.00	30.00	126.66	126.66	21.11		0.04	0.25			14.18	14.18	
East Linn Street (IL9) RT TURN LN													
STA. 0 + 00 TO 0 + 96			6.00			6.00	0.00	0.01			0.67	0.67	
STA. 0 + 96 TO 1 + 59	12.50	63.00	87.50			87.50	0.03	0.17			9.80	9.80	
STA. 1 + 59 TO 2 + 05	19.00	46.00	97.11			97.11	0.03	0.19			10.87	10.87	
STA. 2 + 05 TO 2 + 57	40.00	52.00	231.11			231.11	0.07	0.46			25.88	25.88	
East Linn St. Median Rt. Turn Ln.													
STA. 0 + 00 TO 0 + 24			2.27			2.27	0.00	0.00			0.25	0.25	
STA. 0 + 24 TO 0 + 41	3.00	17.00	5.66			5.66	0.00	0.01			0.63	0.63	
STA. 0 + 41 TO 0 + 67	5.00	26.00	14.44			14.44	0.00	0.02			1.61	1.61	
STA. 0 + 67 TO 0 + 81	14.00	14.00	21.77			21.77	0.01	0.04			2.43	2.43	
STA. 0 + 00 TO 0 + 00													
STA. 0 + 00 TO 0 + 00													
STA. 0 + 00 TO 0 + 00													
STA. 0 + 00 TO 0 + 00													
STA. 0 + 00 TO 0 + 00													
STA. 0 + 00 TO 0 + 00													
STA. 0 + 00 TO 0 + 00													
STA. 0 + 00 TO 0 + 00													
STA. 0 + 00 TO 0 + 00													
STA. 0 + 00 TO 0 + 00													
GRAND-TOTAL				780	98	33,954	11.7	69.1	40	3,836	3,836		

USER NAME = appenzellerjj	DESIGNED -	REVISED -
PLOT SCALE = 1/8" = 1' in.	DRAWN -	REVISED -
PLOT DATE = 1/25/2012	CHECKED -	REVISED -
	DATE -	REVISED -

STATE OF ILLINOIS
DEPARTMENT OF TRANSPORTATION

SCHEDULE OF QUANTITIES		
SCALE: _____	SHEET NO. _____ OF _____ SHEETS	STA. _____ TO STA. _____

F.A.P. RTE. 22	SECTION 135E(ZRS-2, X)RS-1J	COUNTY FULTON	TOTAL SHEETS 33	SHEET NO. 17
ILLINOIS FED. AID PROJECT				
CONTRACT NO. 68978				

MOBILIZATION

LOCATION	
JOBSITE	1 LSUM
TOTAL	1 LSUM

CONSTRUCTING TEST STRIP

LOCATION	
JOBSITE	1 EACH
TOTAL	1 EACH

USER NAME = oppenzeller JJ	DESIGNED - _____	REVISED - _____
	DRAWN - _____	REVISED - _____
PLOT SCALE = 1/8" = 1' / in.	CHECKED - _____	REVISED - _____
PLOT DATE = 12/9/2011	DATE - _____	REVISED - _____

STATE OF ILLINOIS
DEPARTMENT OF TRANSPORTATION

SCHEDULE OF QUANTITIES

SCALE: _____ SHEET NO. _____ OF _____ SHEETS STA. _____ TO STA. _____

F.A.P. RTE.	SECTION	COUNTY	TOTAL SHEETS	SHEET NO.
22	135(2)RS-2, (ORS-1)	FULTON	33	19
CONTRACT NO. 68978				
ILLINOIS FED. AID PROJECT				

**TRAFFIC CONTROL AND PROTECTION STANDARD
701501**

LOCATION	
JOBSITE	1 LSUM
TOTAL	1 LSUM

**TRAFFIC CONTROL AND PROTECTION STANDARD
701502**

LOCATION	
JOBSITE	1 LSUM
TOTAL	1 LSUM

**TRAFFIC CONTROL AND PROTECTION STANDARD
701701**

LOCATION	
JOBSITE	1 LSUM
TOTAL	1 LSUM

STRIP REFLECTIVE CRACK CONTROL

LOCATON	FOOT
STA. 66+18 TO 96+54	
LT. WIDENING JOINT	3036 FT.
RT. WIDENING JOINT	3036 FT.
TOTAL	6072 FT.

USER NAME = appenzeller.jj
PLOT SCALE = 1/8" = 1' / in.
PLOT DATE = 2/1/2012

DESIGNED -	REVISED -
DRAWN -	REVISED -
CHECKED -	REVISED -
DATE -	REVISED -

**STATE OF ILLINOIS
DEPARTMENT OF TRANSPORTATION**

SCHEDULE OF QUANTITIES

SCALE: _____ SHEET NO. ___ OF ___ SHEETS STA. _____ TO STA. _____

F.A.P. RTE.	SECTION	COUNTY	TOTAL SHEETS	SHEET NO.
22	135C(ZIRS-2, XIRS-1)	FULTON	33	20
CONTRACT NO. 68978				
ILLINOIS FED. AID PROJECT				

CLASS D PATCHING 14"			
LOCATION	TY II	TY III	TY IV
UNIT 1	196 SQYD	132 SQYD	52 SQYD
TOTAL	196 SQYD	132 SQYD	52 SQYD
TOTAL	380 SQYD		

GRADING AND SHAPING SHOULDERS	
LOCATION	
Sta. 86+54 to 96+54	24 UNITS
TOTAL	24 UNITS

RAILROAD PROTECTIVE LIABILITY INSURANCE	
LOCATION	
JOB SITE	1 LSUM
TOTAL	1 LSUM

MODIFIED URETHANE PAVEMENT MARKING												
LOCATION	WHITE LINE 4"	WHITE LINE 6"	WHITE LINE 8"	WHITE LINE 12"	WHITE LINE 24"	YELLOW LINE 4"	YELLOW LINE 12"	YELLOW SKIP DASH 4"	LETTERS & SYMBOLS	RPMS ONE WAY	RPMS TWO WAY	RPMS REMOVAL
IL 78 (LOCUST ST.)												
STA. 24+56 TO STA. 26+13					12 FT.	628 FT.	104 FT.				8	8
STA. 26+48 TO STA. 26+98					12 FT.	200 FT.						
TURN LANE AND MEDIAN		48 FT.	302 FT.	98 FT.					15.6 FT.	4		4
IL 78 (5TH AVE)												
STA. 25+52 TO STA. 25+82					12 FT.	120 FT.						
STA. 26+42 TO STA. 30+21	60 FT.	182 FT.	319 FT.		61 FT.	1128 FT.	151 FT.		31.2 FT.	12	14	26
STA. 31+17 TO STA. 35+36	40 FT.	120 FT.	200 FT.		24 FT.	970 FT.		111.3 FT.	62.4 FT.	7	22	29
STA. 36+02 TO STA. 39+32						792 FT.		220 FT.	31.2 FT.		18	18
STA. 39+98 TO STA. 44+12						938 FT.		276 FT.	62.4 FT.		22	22
STA. 44+67 TO STA. 47+61						720 FT.		196 FT.	31.2 FT.		16	16
STA. 48+27 TO STA. 51+06						690 FT.		186 FT.	31.2 FT.		14	14
STA. 51+72 TO STA. 54+28						512 FT.		170.6 FT.	170 FT.		16	16
STA. 54+94 TO STA. 58+00						612 FT.		204 FT.	31.2 FT.		16	16
STA. 58+47 TO STA. 62+20						746 FT.		248.6 FT.	62.4 FT.		18	18
STA. 62+73 TO STA. 66+34						722 FT.		240.6 FT.	31.2 FT.		16	16
STA. 66+93 TO STA. 70+69		98 FT.	200 FT.		26 FT.	1292 FT.	65 FT.	70.6 FT.	62.4 FT.	4	16	20
STA. 71+39 TO STA. 74+47		174 FT.			12 FT.	1232 FT.	65 FT.				16	16
STA. 74+85 TO STA. 78+07		152 FT.						107.3 FT.			4	4
STA. 78+49 TO STA. 81+11		152 FT.						87.3 FT.			3	3
STA. 81+51 TO STA. 84+14		38 FT.						87.6 FT.			3	3
STA. 84+42 TO STA. 96+54	2424 FT.							404 FT.			16	16
SIDE STREETS												
CHESTNUT STREET		544 FT.			24 FT.	76 FT.						
ELM STREET		368 FT.			24 FT.	30 FT.						
PINE STREET		198 FT.			24 FT.	40 FT.						
WALNUT STREET		272 FT.			24 FT.	40 FT.						
MAPLE STREET		280 FT.			24 FT.	60 FT.						
ANDERSON STREET		142 FT.			12 FT.	80 FT.						
GRANT STREET		126 FT.			12 FT.							
OAK STREET		262 FT.			24 FT.							
HICKORY STREET		294 FT.			24 FT.	60 FT.						
CHERRY STREET		266 FT.			24 FT.	64 FT.						
LINN STREET (IL 9)		264 FT.	109 FT.	38 FT.	67 FT.	840 FT.	65 FT.	120 FT.	78 FT.	4	14	18
HOLLY STREET		256 FT.			24 FT.							
LEWIS STREET		270 FT.			24 FT.							
HANLON STREET		288 FT.			24 FT.							
SAM SCOTT STREET					36 FT.							
TOTAL	2524 FT.	4794 FT.	930 FT.	136 FT.	550 FT.	12592 FT.	450 FT.	2729 FT.	638 FT.	31 EA.	252 EA.	283 EA.

USER NAME = eppenzeller,jj	DESIGNED - _____	REVISED - _____
	DRAWN - _____	REVISED - _____
PLOT SCALE = 1/8" = 1' / in.	CHECKED - _____	REVISED - _____
PLOT DATE = 2/1/2012	DATE - _____	REVISED - _____

STATE OF ILLINOIS
DEPARTMENT OF TRANSPORTATION

SCHEDULE OF QUANTITIES

SCALE: _____ SHEET NO. _____ OF _____ SHEETS STA. _____ TO STA. _____

F.A.P. RTE.	SECTION	COUNTY	TOTAL SHEETS	SHEET NO.
22	135((Z)RS-2,(X)RS-1)	FULTON	33	22
CONTRACT NO. 68978			ILLINOIS FED. AID PROJECT	

TEMPORARY PAVEMENT MARKINGS									
LOCATION	WHITE LINE 4"	WHITE LINE 6"	WHITE LINE 8"	WHITE LINE 12"	WHITE LINE 24"	YELLOW LINE 4"	YELLOW LINE 12"	YELLOW SKIP DASH 4"	LETTERS & SYMBOLS
IL 78 (LOCUST ST.)									
STA. 24+56 TO STA. 26+13					12 FT.	628 FT.	104 FT.		
STA. 26+48 TO STA. 26+98					12 FT.	200 FT.			
TURN LANE AND MEDIAN		48 FT.	302 FT.	98 FT.					15.6 FT.
IL 78 (5TH AVE)									
STA. 25+52 TO STA. 25+82					12 FT.	120 FT.			
STA. 26+42 TO STA. 30+21	60 FT.	182 FT.	319 FT.		61 FT.	1128 FT.	151 FT.		31.2 FT.
STA. 31+17 TO STA. 35+36	40 FT.	120 FT.	200 FT.		24 FT.	970 FT.		111.3 FT.	62.4 FT.
STA. 36+02 TO STA. 39+32						792 FT.		220 FT.	31.2 FT.
STA. 39+98 TO STA. 44+12						938 FT.		276 FT.	62.4 FT.
STA. 44+67 TO STA. 47+61						720 FT.		196 FT.	31.2 FT.
STA. 48+27 TO STA. 51+06						690 FT.		186 FT.	31.2 FT.
STA. 51+72 TO STA. 54+28						512 FT.		170.6 FT.	170 FT.
STA. 54+94 TO STA. 58+00						612 FT.		204 FT.	31.2 FT.
STA. 58+47 TO STA. 62+20						746 FT.		248.6 FT.	62.4 FT.
STA. 62+73 TO STA. 66+34						722 FT.		240.6 FT.	31.2 FT.
STA. 66+93 TO STA. 70+69		98 FT.	200 FT.		26 FT.	1292 FT.	65 FT.	70.6 FT.	62.4 FT.
STA. 71+39 TO STA. 74+47		174 FT.			12 FT.	1232 FT.	65 FT.		
STA. 74+85 TO STA. 78+07		152 FT.						107.3 FT.	
STA. 78+49 TO STA. 81+11		152 FT.						87.3 FT.	
STA. 81+51 TO STA. 84+14		38 FT.						87.6 FT.	
STA. 84+42 TO STA. 96+54	2424 FT.							404 FT.	
SIDE STREETS									
CHESTNUT STREET		544 FT.			24 FT.	76 FT.			
ELM STREET		368 FT.			24 FT.	30 FT.			
PINE STREET		198 FT.			24 FT.	40 FT.			
WALNUT STREET		272 FT.			24 FT.	40 FT.			
MAPLE STREET		280 FT.			24 FT.	60 FT.			
ANDERSON STREET		142 FT.			12 FT.	80 FT.			
GRANT STREET		126 FT.			12 FT.				
OAK STREET		262 FT.			24 FT.				
HICKORY STREET		294 FT.			24 FT.	60 FT.			
CHERRY STREET		266 FT.			24 FT.	64 FT.			
LINN STREET (IL 9)		264 FT.	109 FT.	38 FT.	67 FT.	840 FT.	65 FT.	120 FT.	78 FT.
HOLLY STREET		256 FT.			24 FT.				
LEWIS STREET		270 FT.			24 FT.				
HANLON STREET		288 FT.			24 FT.				
SAM SCOTT STREET					36 FT.				
TOTAL	2524 FT.	4794 FT.	930 FT.	136 FT.	550 FT.	12592 FT.	450 FT.	2729 FT.	638 FT.

USER NAME = appanzeller.jj	DESIGNED -	REVISED -
	DRAWN -	REVISED -
PLOT SCALE = 1:1144' / in.	CHECKED -	REVISED -
PLOT DATE = 2/1/2012	DATE -	REVISED -

STATE OF ILLINOIS
DEPARTMENT OF TRANSPORTATION

SCHEDULE OF QUANTITIES

SCALE: SHEET NO. OF SHEETS STA. TO STA.

F.A.P. RTE.	SECTION	COUNTY	TOTAL SHEETS	SHEET NO.
22	135(IJRS-2, IJRS-1)	FULTON	33	23
CONTRACT NO. 68978				
ILLINOIS FED. AID PROJECT				

SHORT TERM PAVEMENT MARKING			
LOCATION	DESCRIPTION	4"YELLOW SKIP DASH	WHITE LINE 24"
IL 78 (LOCUST ST.)			
STA. 24+56 TO STA. 26+13	4 APPLICATIONS	251 FT.	48 FT.
STA. 26+48 TO STA. 26+98	4 APPLICATIONS	80 FT.	48 FT.
IL 78 (5TH AVE)			
STA. 25+52 TO STA. 25+82	4 APPLICATIONS	48 FT.	48 FT.
STA. 26+42 TO STA. 30+21	4 APPLICATIONS	606 FT.	244 FT.
STA. 31+17 TO STA. 35+36	4 APPLICATIONS	670 FT.	96 FT.
STA. 36+02 TO STA. 39+32	4 APPLICATIONS	528 FT.	
STA. 39+98 TO STA. 44+12	4 APPLICATIONS	662 FT.	
STA. 44+67 TO STA. 47+61	4 APPLICATIONS	470 FT.	
STA. 48+27 TO STA. 51+06	4 APPLICATIONS	446 FT.	
STA. 51+72 TO STA. 54+28	4 APPLICATIONS	409 FT.	96 FT.
STA. 54+94 TO STA. 58+00	4 APPLICATIONS	489 FT.	
STA. 58+47 TO STA. 62+20	4 APPLICATIONS	596 FT.	
STA. 62+73 TO STA. 66+34	4 APPLICATIONS	577 FT.	
STA. 66+93 TO STA. 70+69	4 APPLICATIONS	601 FT.	104 FT.
STA. 71+39 TO STA. 74+47	4 APPLICATIONS	246 FT.	48 FT.
STA. 74+85 TO STA. 78+07	4 APPLICATIONS	257 FT.	
STA. 78+49 TO STA. 81+11	4 APPLICATIONS	209 FT.	
STA. 81+51 TO STA. 84+14	4 APPLICATIONS	210 FT.	
STA. 84+42 TO STA. 96+54	4 APPLICATIONS	969 FT.	
SIDE STREETS			
CHESTNUT STREET	4 APPLICATIONS	100 FT.	96 FT.
ELM STREET	4 APPLICATIONS	44 FT.	96 FT.
PINE STREET	4 APPLICATIONS	43 FT.	96 FT.
WALNUT STREET	4 APPLICATIONS	37 FT.	96 FT.
MAPLE STREET	4 APPLICATIONS	54 FT.	96 FT.
ANDERSON STREET	4 APPLICATIONS	42 FT.	48 FT.
GRANT STREET	4 APPLICATIONS	20 FT.	48 FT.
OAK STREET	4 APPLICATIONS	48 FT.	96 FT.
HICKORY STREET	4 APPLICATIONS	48 FT.	96 FT.
CHERRY STREET	4 APPLICATIONS	49 FT.	96 FT.
LINN STREET (IL 9)	4 APPLICATIONS	451 FT.	268 FT.
HOLLY STREET	4 APPLICATIONS	32 FT.	96 FT.
LEWIS STREET	4 APPLICATIONS	40 FT.	96 FT.
HANLON STREET	4 APPLICATIONS	38 FT.	96 FT.
SAM SCOTT STREET	4 APPLICATIONS	39 FT.	144 FT.
TOTAL		9409 FT.	2296 FT.
GRAND TOTAL		11,705 FT.	

USER NAME = eppencollar,jj	DESIGNED - _____	REVISED - _____
	DRAWN - _____	REVISED - _____
PLOT SCALE = 1/8" = 1' / in.	CHECKED - _____	REVISED - _____
PLOT DATE = 12/9/2011	DATE - _____	REVISED - _____

STATE OF ILLINOIS
DEPARTMENT OF TRANSPORTATION

SCHEDULE OF QUANTITIES

SCALE: _____ SHEET NO. ____ OF ____ SHEETS STA. _____ TO STA. _____

F.A.P. RTE.	SECTION	COUNTY	TOTAL SHEETS	SHEET NO.
22	135(2)RS-2, (X)RS-11	FULTON	33	24
CONTRACT NO. 68978				
(ILLINOIS) FED. AID PROJECT				

PAVEMENT MARKING REMOVAL

LOCATION	SQUARE FEET
IL 78 5TH AVE.	10528 SQ FT
TOTAL	10528 SQ FT

WORK ZONE PAVEMENT MARKING REMOVAL

LOCATION	SQUARE FEET
IL 78 5TH AVE.	965 SQ FT
TOTAL	965 SQ FT

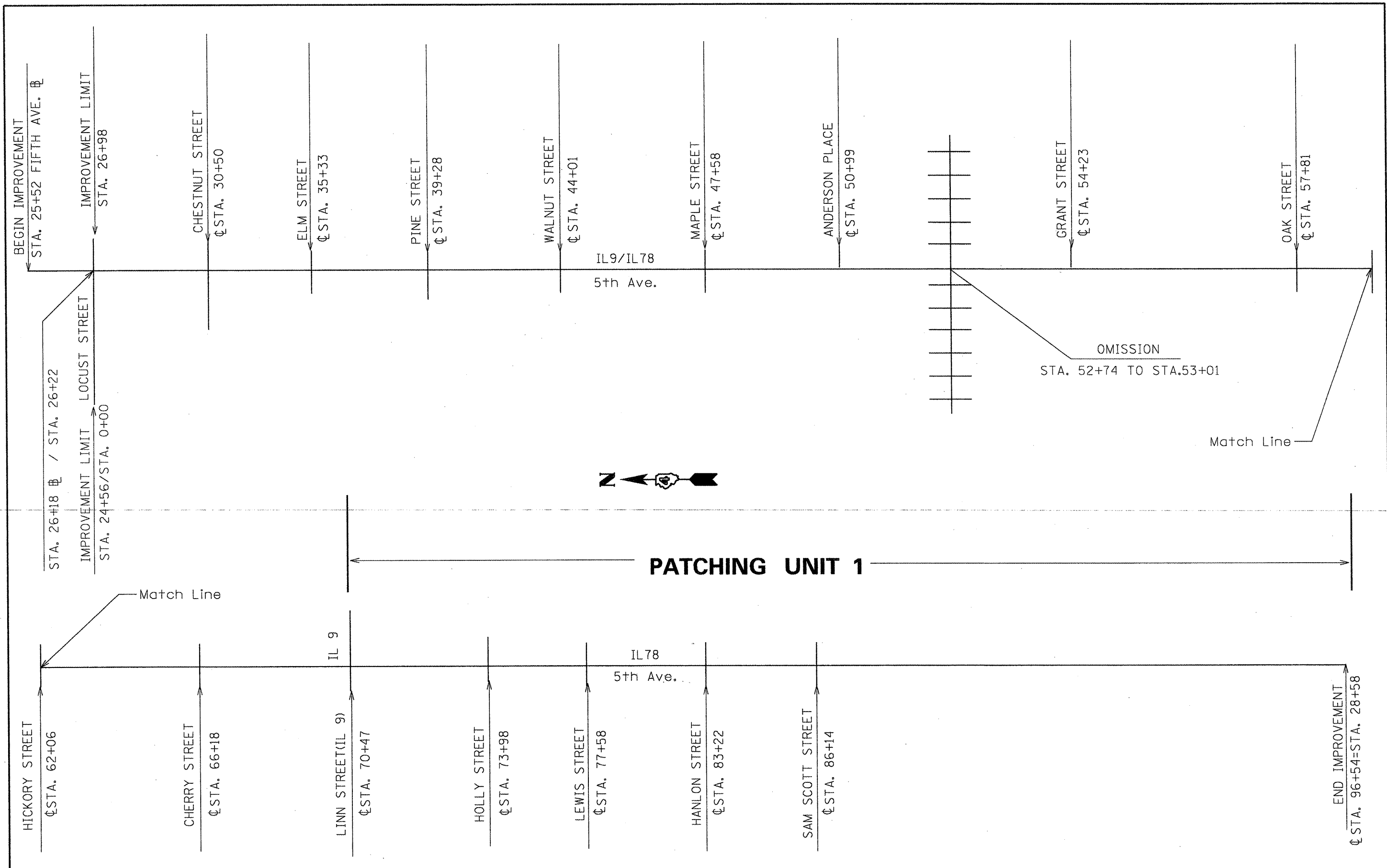

PATCHING UNIT 1

FILE NAME = 68978.dgn	USER NAME = appenzellerjj	DESIGNED -	REVISED -
		DRAWN -	REVISED -
		CHECKED -	REVISED -
		DATE -	REVISED -
PLOT SCALE = 1/8642' / 1" =		PLOT DATE = 1/25/2012	

**STATE OF ILLINOIS
DEPARTMENT OF TRANSPORTATION**

LINE DIAGRAM

SCALE: _____ SHEET NO. ____ OF ____ SHEETS STA. _____ TO STA. _____

F.A.P. RTE.	SECTION	COUNTY	TOTAL SHEETS	SHEET NO.
22	135(2)RS-2, (X)RS-1)	FULTON	33	26
CONTRACT NO. 68978				
ILLINOIS FED. AID PROJECT				

SCHEDULE OF QUANTITIES - IL 9 (FIFTH AVE.) & CHESTNUT ST.		
ITEM DESCRIPTION	UNIT	TOTAL QTY.
PORTLAND CEMENT CONCRETE SIDEWALK 4 INCH	SQ FT	75
SIDEWALK REMOVAL	SQ FT	75
SIGN PANEL - TYPE 1	SQ FT	20
UNDERGROUND CONDUIT, PVC, 1 1/2" DIA.	FOOT	40
ELECTRIC CABLE IN CONDUIT, SIGNAL, NO. 14 5C	FOOT	1188.5
ELECTRIC CABLE IN CONDUIT, LEAD-IN, NO. 18 3 PAIR	FOOT	472
DRILL EXISTING HANDHOLE	EACH	4
SIGNAL HEAD, LED, 1-FACE, 3-SECTION, BRACKET MOUNTED	EACH	3
PEDESTRIAN SIGNAL HEAD, LED, 2-FACE, BRACKET MOUNTED	EACH	4
INDUCTIVE LOOP DETECTOR	EACH	9
DETECTOR LOOP, TYPE I	FOOT	1689
PEDESTRIAN PUSH-BUTTON	EACH	8
REBUILD EXISTING SIGNAL HEAD, LED	EACH	8
MODIFY EXISTING CONTROLLER CABINET	EACH	1
REMOVE EXISTING TRAFFIC SIGNAL EQUIPMENT	EACH	1
LED SIGNAL FACE RETROFIT, RED BALL	EACH	5
LED SIGNAL FACE RETROFIT, GREEN BALL	EACH	5
LED SIGNAL FACE RETROFIT, YELLOW BALL	EACH	5

CONSTRUCTION NOTES	
1.	ANY MAINTENANCE OF EXISTING TRAFFIC SIGNALS WILL BE CONSIDERED EXTRA WORK IN ACCORDANCE WITH ARTICLE 109.04 OF THE STANDARD SPECIFICATIONS.
2.	THE LOCATION OF ALL UTILITIES AND PRIVATELY OWNED FACILITIES SHALL BE FIELD VERIFIED BY THE CONTRACTOR PRIOR TO THE INSTALLATION OF ANY COMPONENTS.
3.	THE CONTRACTOR SHALL BE RESPONSIBLE FOR LOCATING EXISTING IDOT ELECTRICAL FACILITIES AT HIS/HER OWN EXPENSE IF REQUIRED. THE CONTRACTOR SHALL ALSO BE LIABLE FOR ANY DAMAGE TO IDOT FACILITIES RESULTING FROM INACCURATE LOCATING.
4.	ELECTRICAL WORK SHALL CONFORM WITH NATIONAL, STATE, AND LOCAL CODES.
5.	ALL DETECTOR LOOPS SHALL BE INSTALLED IN THE CENTER OF THEIR RESPECTIVE TRAVEL LANES. THE CONTRACTOR SHALL NOTIFY RANDY LANINGA AT (309) 671-4477 TO OBTAIN VERIFICATION OF DETECTOR LOOP LAYOUT PRIOR TO INSTALLATION.
6.	THE PROPOSED DETECTOR LOOPS SHALL BE CUT IN THE MILLED SURFACE OR LEVELING BINDER COURSE BEFORE THE FINAL OVERLAY.
7.	THE COST OF DRILLING THE CURB SHALL BE INCLUDED IN THE UNIT BID PRICE FOR DRILL EXISTING HANDHOLE.
8.	THE PROPOSED DETECTOR LOOPS SHALL BE INSTALLED AND FULLY OPERATIONAL PRIOR TO THE REMOVAL OF THE VIDEO DETECTION SYSTEM.
9.	ALL LOOP RISERS SHALL BE REFLECTED THROUGH THE NEW SURFACE AND ALL LOOP RISERS SHALL BE CHIPPED OUT AND FILLED WITH EPOXY. THIS WORK SHALL BE INCLUDED IN THE BID PRICE FOR THE PAY ITEM "DETECTOR LOOP, TYPE I".
10.	ALL TRAFFIC SIGNAL SECTIONS SHALL HAVE 12" SINGLE LED LENSES.
11.	THE RED SECTIONS OF THE SIGNAL HEADS SHARING THE SAME MAST ARM SHALL BE LEVEL WITH ONE ANOTHER AND MAINTAIN A 16 FT. MINIMUM CLEARANCE FROM THE HIGHEST POINT OF THE ROADWAY.
12.	ALL TRAFFIC SIGNAL HEAD BRACKETS ARE TO BE ALUMINUM WITH A NATURAL FINISH.
13.	THE EXISTING TRAFFIC SIGNALS SHALL REMAIN IN OPERATION DURING THE CONSTRUCTION OF THE PROPOSED TRAFFIC SIGNALS.
14.	THE CONTRACTOR SHALL PROVIDE ELECTRICAL CABLE SLACK IN ACCORDANCE WITH ARTICLE 873.03.
15.	ELECTRICAL CABLE WILL BE MEASURED FOR PAYMENT IN ACCORDANCE WITH ARTICLE 873.04.
16.	ALL SURPLUS MATERIALS SHALL BE DISPOSED OF IN ACCORDANCE WITH ARTICLE 202.03 OF THE STANDARD SPECIFICATIONS.
17.	THE #18 3-PAIR TWISTED/SHIELDED CABLE SHALL HAVE THE SAME SLACK AS OTHER SIGNAL CABLE AND WILL BE MEASURED FOR PAYMENT.
18.	ALL DETECTOR LOOPS SHALL UTILIZE A SEPARATE PAIR OF LEAD-INS AND A TYPE II SPLICE SHALL BE USED FOR ALL DETECTOR LEAD-INS.
19.	NO ADDITIONAL COMPENSATION WILL BE ALLOWED FOR PLACING CONDUIT AT GREATER THAN 2 FT. MINIMUM DEPTH TO AVOID OBSTACLES SUCH AS UNDERGROUND UTILITIES.
20.	THE CONTRACTOR IS RESPONSIBLE FOR THE COST OF UNCOVERING OR HAND DIGGING AROUND UTILITIES AS NECESSARY. THIS COST OF THIS WORK SHALL BE INCLUDED IN THE UNIT PRICES FOR THE CONDUITS.

FILE NAME = 68978 - IL 9 (Fifth Chestnut) Canton (Ful) 1-27-12.dgn	USER NAME = appenzellerj	DESIGNED - _____	REVISED - _____	STATE OF ILLINOIS DEPARTMENT OF TRANSPORTATION	IL 9 (FIFTH AVE.) & CHESTNUT ST. TRAFFIC SIGNAL SCHEDULE OF QUANTITIES AND CONSTRUCTION NOTES	F.A.P. RTE. 22	SECTION 135(2)RS-2,(X)RS-11	COUNTY FULTON	TOTAL SHEETS 33	SHEET NO. 27
PLOT SCALE = 53.0382' / in.	CHECKED - _____	REVISED - _____	SCALE: _____ SHEET NO. ____ OF ____ SHEETS STA. _____ TO STA. _____			CONTRACT NO. 68978				
PLOT DATE = 2/1/2012	DATE - _____	REVISED - _____	ILLINOIS FED. AID PROJECT							

DETECTOR LOOP AND DETECTOR ASSIGNMENT SCHEDULE					
DETECTOR LOOP	TYPE	DETECTOR LOOP QTY.	DETECTOR LEAD-IN	ASSIGNED PHASE	CHANNELS REQUIRED
D-1	6' X 50' QUAD	162	31	1	1
D-2	6' X 40' QUAD	132	21	2	1
D-3	6' X 50' QUAD	162	45	3	1
D-4	6' X 50' QUAD	162	25	4	1
D-5	6' X 50' QUAD	162	33	5	1
D-6A	6' X 40' QUAD	132	42	6	1
D-6B	6' X 40' QUAD	132	54	6	1
D-7	6' X 50' QUAD	162	37	7	1
D-8	6' X 50' QUAD	162	33	8	1
TOTAL:		1368	321		9

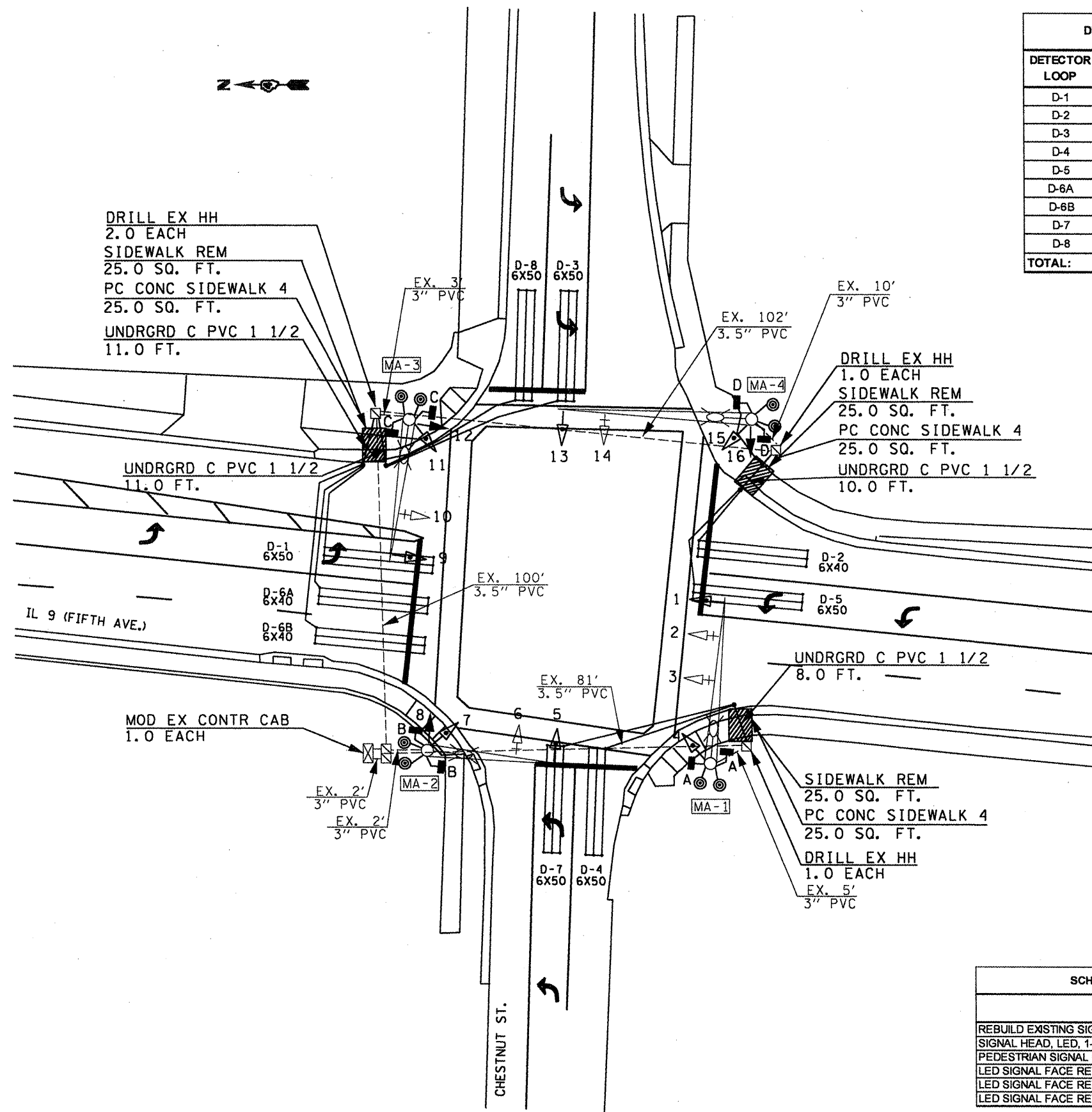

TRAFFIC SIGNAL LEGEND

- EX. HANDHOLE
- EX. CONDUIT
- ⊗ EX. TRAFFIC SIGNAL CONTROLLER
- ◁ EX. TRAFFIC SIGNAL HEAD
- ▷ EX. SIGNAL HEAD (REBUILT)
- ▲ PROP. SIGNAL HEAD
- ▨ PROP. DETECTOR LOOP (QUAD)

SCHEDULE OF TRAFFIC SIGNAL HEADS AND LED RETROFITS		
PAY ITEM	QUANTITY	LOCATIONS
REBUILD EXISTING SIGNAL HEAD, LED	8.0 EACH	1,4,5,7,9,11,13,15
SIGNAL HEAD, LED, 1-FACE, 3-SECTION, BRACKET MOUNTED	3.0 EACH	8,12,16
PEDESTRIAN SIGNAL HEAD, LED, 2-FACE, BRACKET MOUNTED	4.0 EACH	A,B,C,D
LED SIGNAL FACE RETROFIT, RED BALL	5.0 EACH	2,3,6,10,14
LED SIGNAL FACE RETROFIT, GREEN BALL	5.0 EACH	2,3,6,10,14
LED SIGNAL FACE RETROFIT, YELLOW BALL	5.0 EACH	2,3,6,10,14

FILE NAME = 88978 - IL 9 (Fifth Chestnut) Canton (Final 1-27-12).dgn	USER NAME = appenzeller.jj	DESIGNED -	REVISED -
PLOT SCALE = 52.1415' / 1" IN.		DRAWN -	REVISED -
PLOT DATE = 1/27/2012		CHECKED -	REVISED -
		DATE -	REVISED -

STATE OF ILLINOIS
DEPARTMENT OF TRANSPORTATION

IL 9 (FIFTH AVE.) & CHESTNUT ST.
PROPOSED TRAFFIC SIGNAL PLAN

F.A.P. RTE. 22	SECTION 135(ZIRS-2,(X)RS-1)	COUNTY FULTON	TOTAL SHEETS 33	SHEET NO. 28
SCALE: _____ SHEET NO. ____ OF ____ SHEETS STA. _____ TO STA. _____			CONTRACT NO. 68978	
ILLINOIS FED. AID PROJECT				

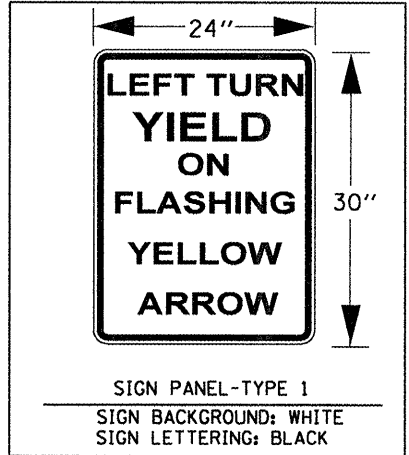
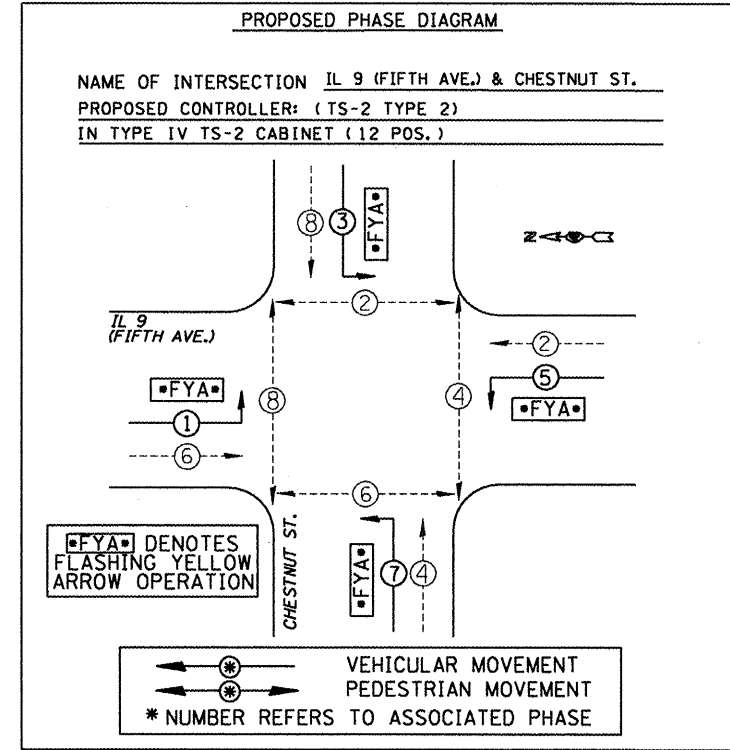
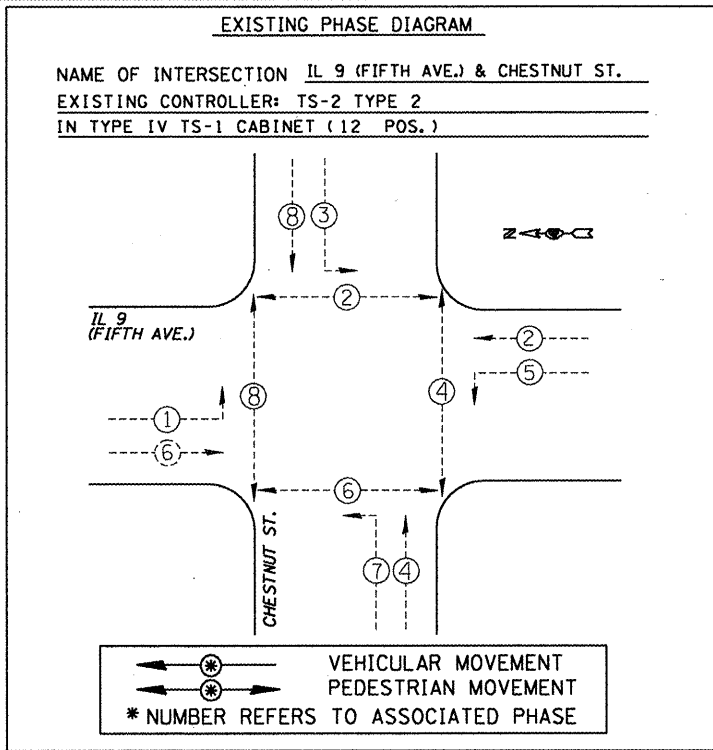
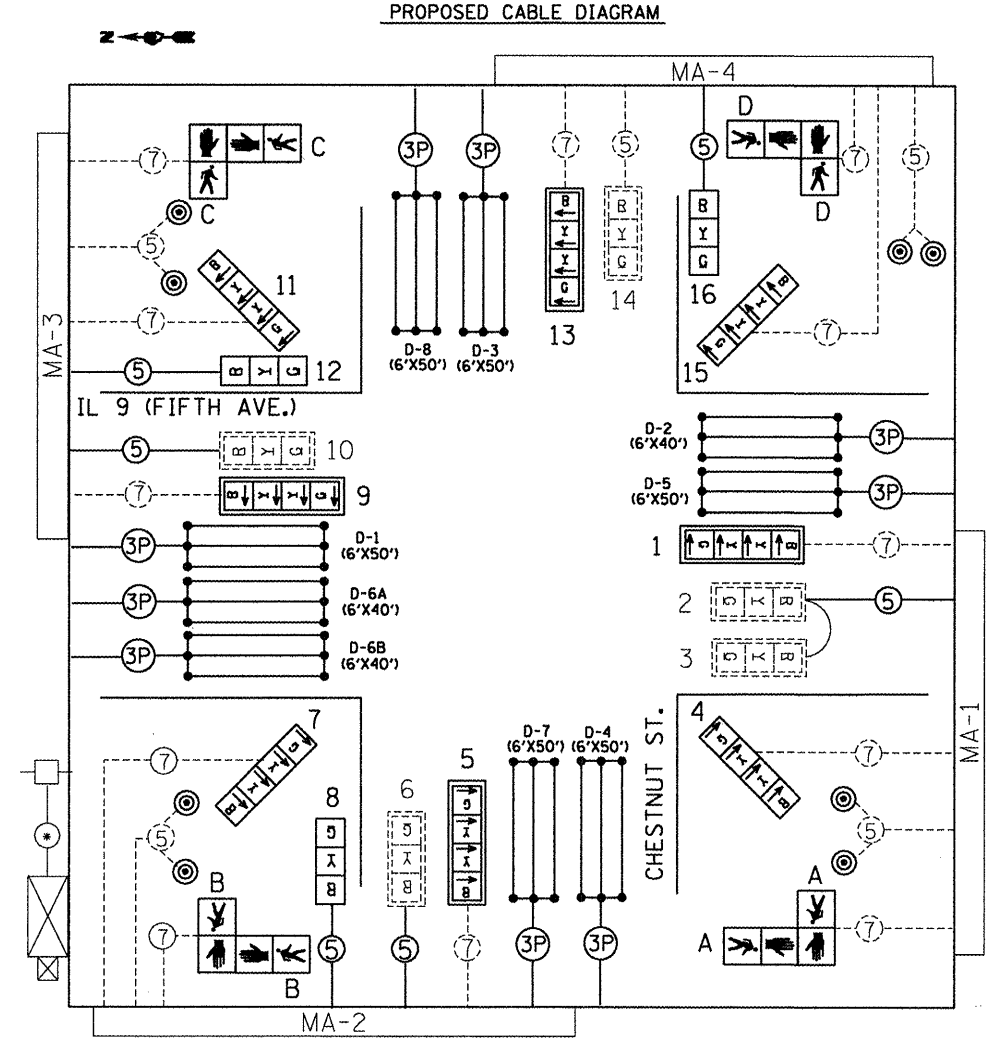
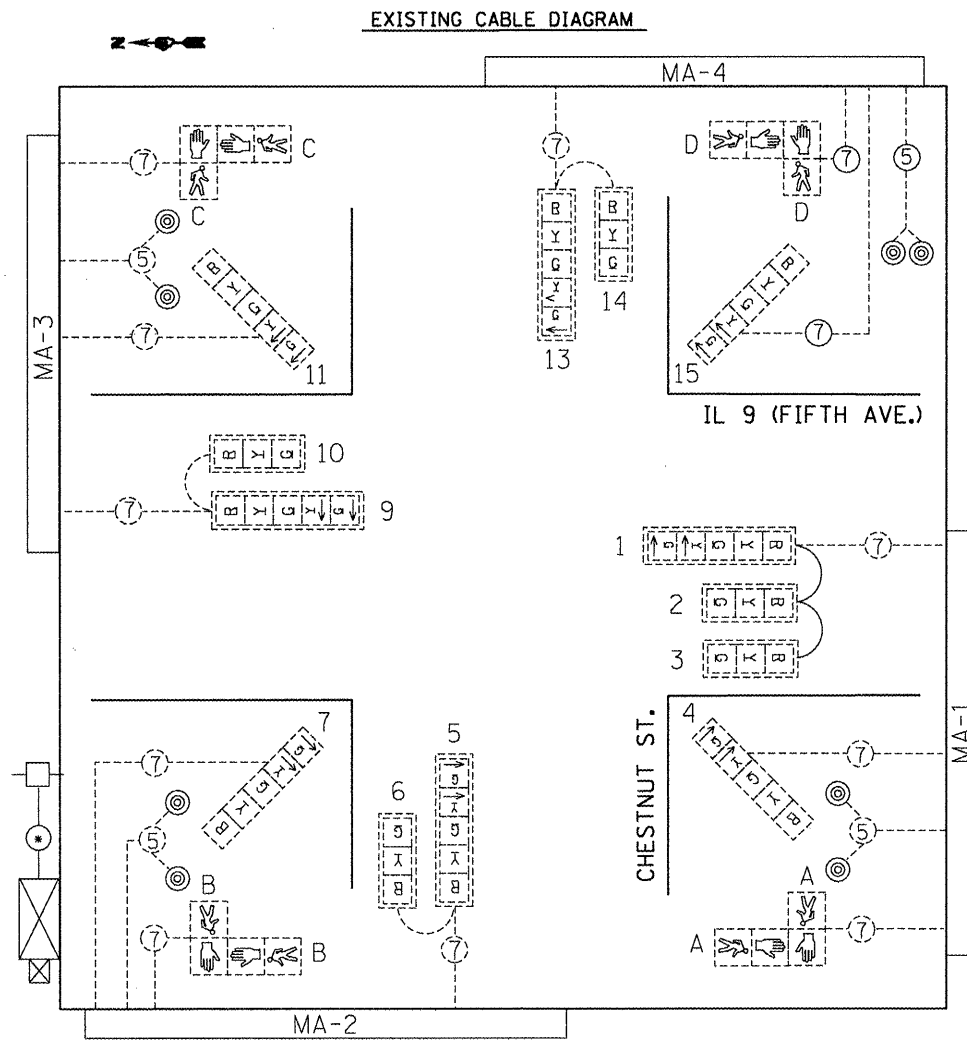

- TRAFFIC SIGNALS LEGEND
- EX. 3 SEC. SIGNAL HEAD W/BACKPLATE
 - EX. 3 SEC. SIGNAL HEAD
 - EX. 5/C NO. 14 SIGNAL CABLE
 - EX. 7/C NO. 14 SIGNAL CABLE
 - EX. CONTROLLER (SIGNAL)
 - EX. CONTROLLER (LIGHTING)
 - EX. SERVICE INSTALLATION
 - PROP. 3 SEC. SIGNAL HEAD
 - PROP. DETECTOR LOOP (QUAD)
 - PROP. 5/C NO. 14 SIGNAL CABLE
 - PROP. #18 3-PR DETECTOR LOOP CABLE
 - PROP. PEDESTRIAN PUSHBUTTON

FILE NAME = 68978 - IL 9 (Fifth Chestnut) Canton (Final 1-27-12).dgn	USER NAME = eppenzeller,jj	DESIGNED -	REVISED -
PLOT SCALE = 52.7331' / in.	DATE = 1/30/2012	DRAWN -	REVISED -
		CHECKED -	REVISED -
		DATE -	REVISED -

STATE OF ILLINOIS
DEPARTMENT OF TRANSPORTATION

IL 9 (FIFTH AVE.) & CHESTNUT ST. TRAFFIC SIGNALS
EXISTING AND PROPOSED PHASE AND CABLE DIAGRAMS
SCALE: _____ SHEET NO. ____ OF ____ SHEETS STA. _____ TO STA. _____

F.A.P. RTE.	SECTION	COUNTY	TOTAL SHEETS	SHEET NO.
22	135(ZIRS-2, XIRS-1)	FULTON	33	29
CONTRACT NO. 68978				
ILLINOIS FED. AID PROJECT				

DESIGNER NOTES:
 1. Include District Special Provision for Butt Joints & for Hot Mix Asphalt Removal (Cold Milling).
 2. The butt joints pay item includes the saw cut & temporary ramp. Payment for the Butt Joint applies whether or not the project features Hot Mix Asphalt Removal (Cold Milling).

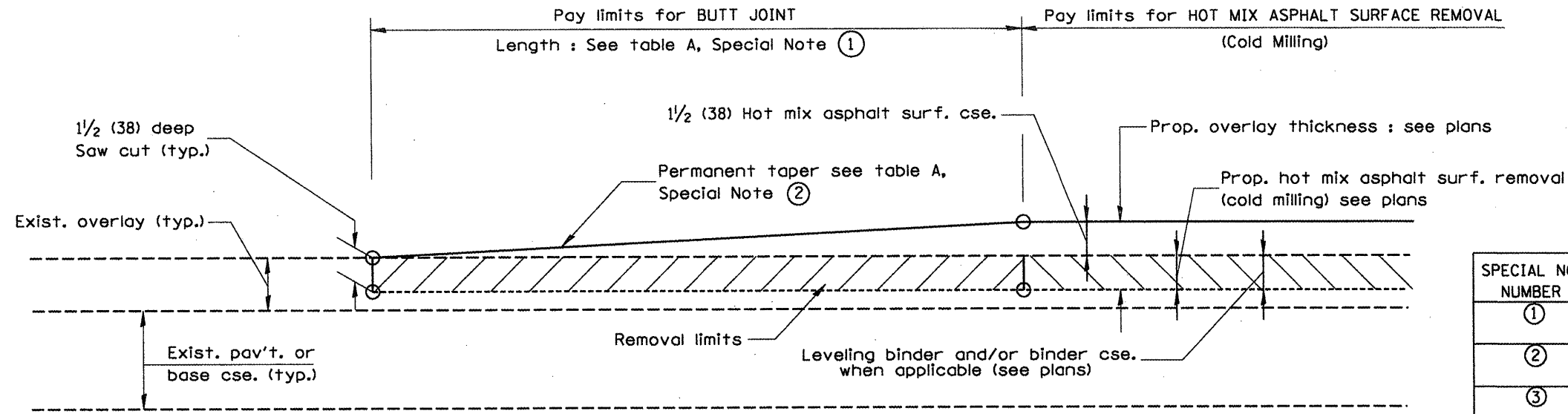

CASE 1 : WITH HOT MIX ASPHALT SURFACE REMOVAL (COLD MILLING)

TABLE A
(LENGTHS AND TAPER RATES)

SPECIAL NOTE NUMBER	ELEMENT	MAINLINE INTERSTATES & 4-LANE EXPRESSWAYS	ALL OTHERS
①	LENGTH OF BUTT JOINT	60'(18.0 m)	30'(9.0 m)
②	PERMANENT TAPER RATE	1:480	1:240
③	TEMPORARY RAMP TAPER RATE	1:80	1:40
④	TEMPORARY RAMP LENGTH	10'(3.0 m)	5'(1.5 m)
⑤	LENGTH OF BUTT JOINT	10'(3.0 m)	10'(3.0 m)

GENERAL NOTES

- The work shall be done in accordance with Article 406.08 and the Special Provision for Butt Joints.
- The pavement surface to be removed may be either bituminous or P.C. concrete. The work shall be performed in accordance with Article 440.04 and the Special Provisions for Butt Joints.
- The saw cut joints shall be primed just prior to the placing of bituminous material. The work will be in accordance with the applicable portions of Article 406.05.

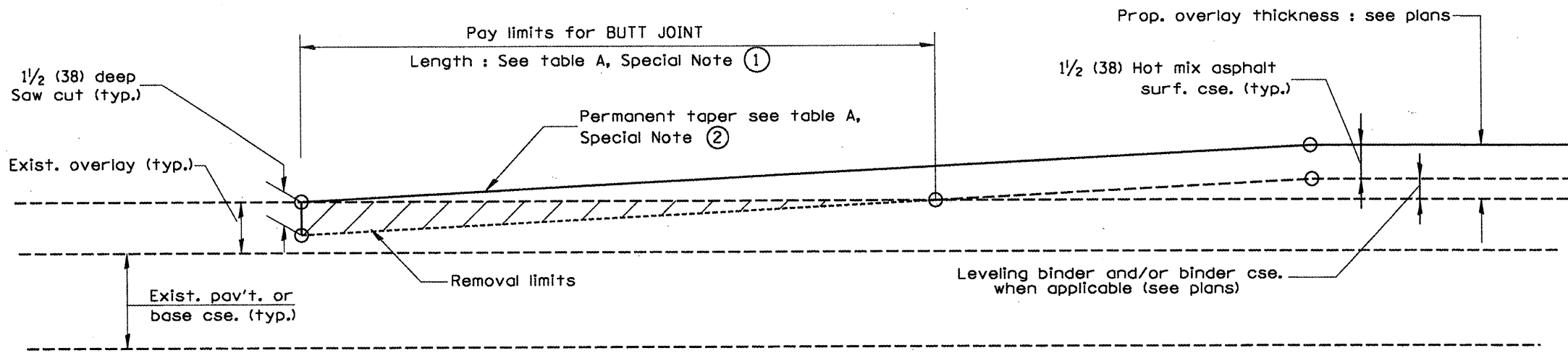

CASE 2 : NO HOT MIX ASPHALT SURFACE REMOVAL (COLD MILLING)

All dimensions are in inches (millimeters) unless otherwise noted.

01-01-97	BENJUM_C-23.01_NEW_REVISION_BOX	J.P.												
04-01-97	COBCECTION_TO_DEPTH	J.A.												
09-15-05	REVISED_DESIGNER_NOTE	M.M.A.												
10-16-06	REVISED_TO_2007_SPEC.	M.A.												

STATE OF ILLINOIS
DEPARTMENT OF TRANSPORTATION

BUTT JOINTS

NOT TO SCALE

S&I, J. DE 3
CA00_SIO_406101-04

F.A.P. RTE.	SECTION	COUNTY	TOTAL SHEETS	SHEET NO.
22	135RS-7	FULTON	33	30
CONTRACT NO. 68978			FED. ROAD DIST. NO. ILLINOIS/FED. AID PROJECT	

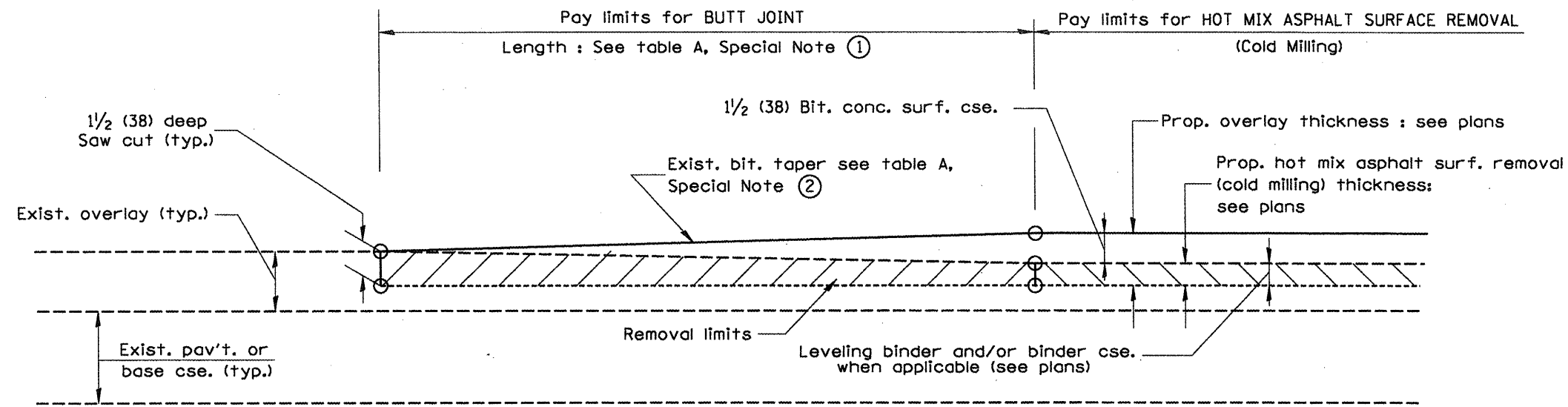

**CASE 3 : WITH HOT MIX ASPHALT SURFACE REMOVAL (COLD MILLING)
TIE-IN TO EXISTING BITUMINOUS TAPER**

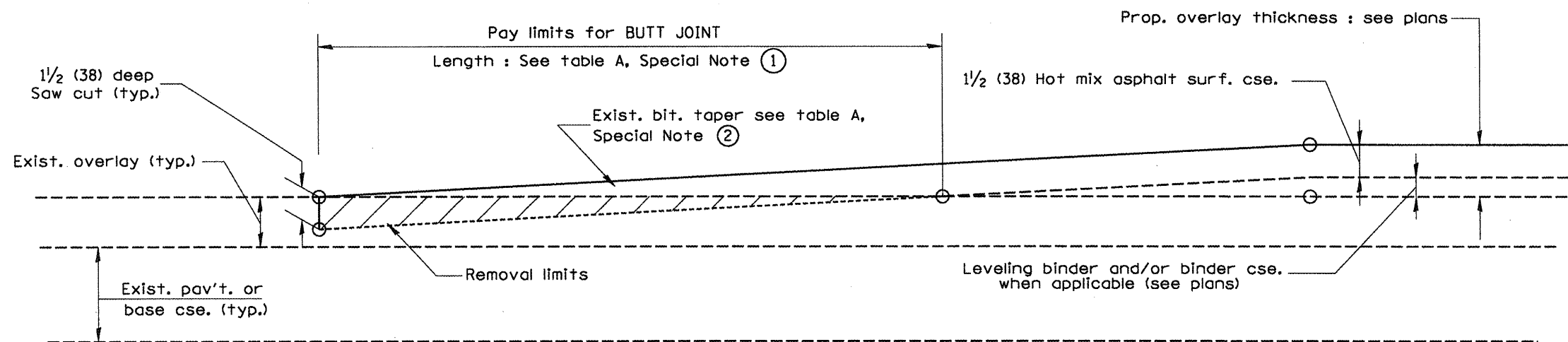

**CASE 4 : NO HOT MIX ASPHALT SURFACE REMOVAL (COLD MILLING)
TIE-IN TO EXISTING BITUMINOUS TAPER**

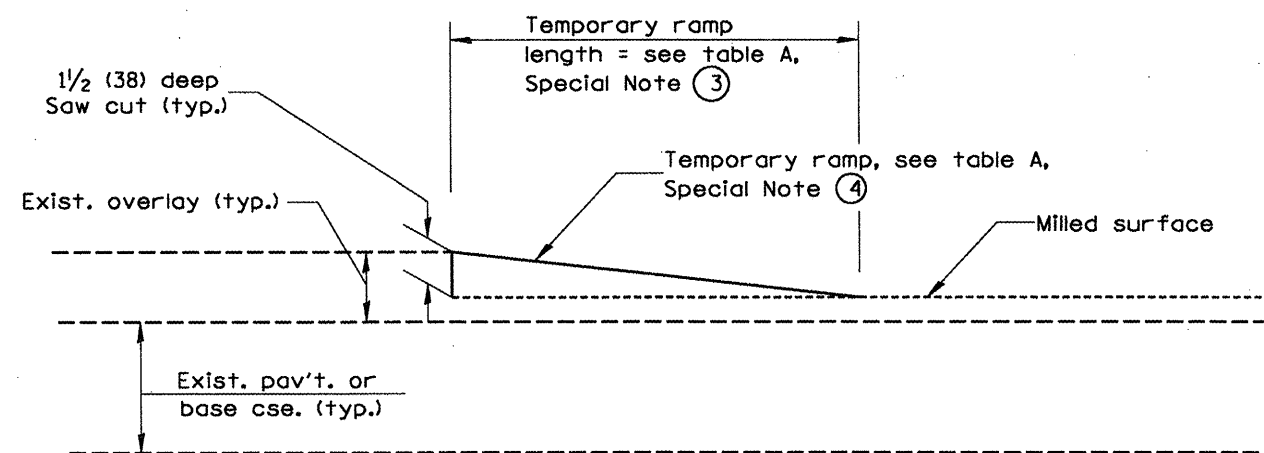

DETAIL TEMPORARY RAMP

All dimensions are in Inches (millimeters) unless otherwise noted.

--	--	--	--	--	--	--	--	--	--

STATE OF ILLINOIS
DEPARTMENT OF TRANSPORTATION

BUTT JOINTS

NOT TO SCALE

SHI. 2 OF 3
CADD STD. 406101-04

F.A.P. RTE.	SECTION	COUNTY	TOTAL SHEETS	SHEET NO.
22	135RS-7	FULTON	33	31
CONTRACT NO. 68978			FED. ROAD DIST. NO. - ILLINOIS FED. AID PROJECT	

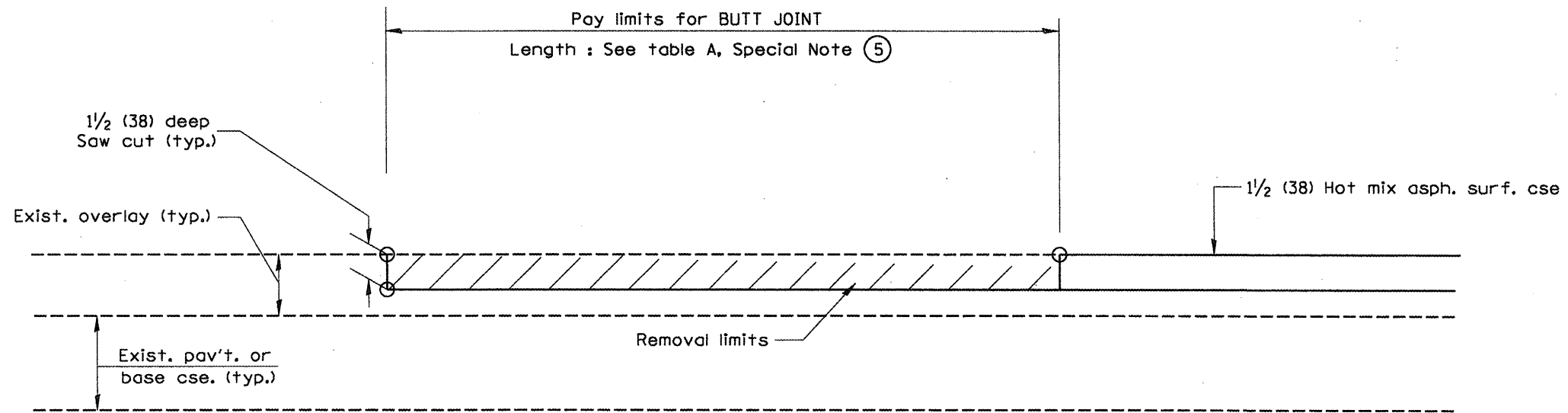

CASE 5 : WITH HOT MIX ASPHALT SURFACE REMOVAL (COLD MILLING)
TIE-IN TO EXISTING BITUMINOUS TAPER

All dimensions are in inches (millimeters)
unless otherwise noted.

STATE OF ILLINOIS
DEPARTMENT OF TRANSPORTATION

NOT TO SCALE

BUTT JOINTS

SHI_3_DE_3
CADD_SIO_406101:04

F.A.P. RTE.	SECTION	COUNTY	TOTAL SHEETS	SHEET NO.
22	135RS-7	FULTON	33	32
CONTRACT NO.			60978	
FED. ROAD DIST. NO. ILLINOIS FED. AID PROJECT				

DESIGNER NOTES:
1. INCLUDE DISTRICT SPECIAL PROVISION, IF APPLICABLE.

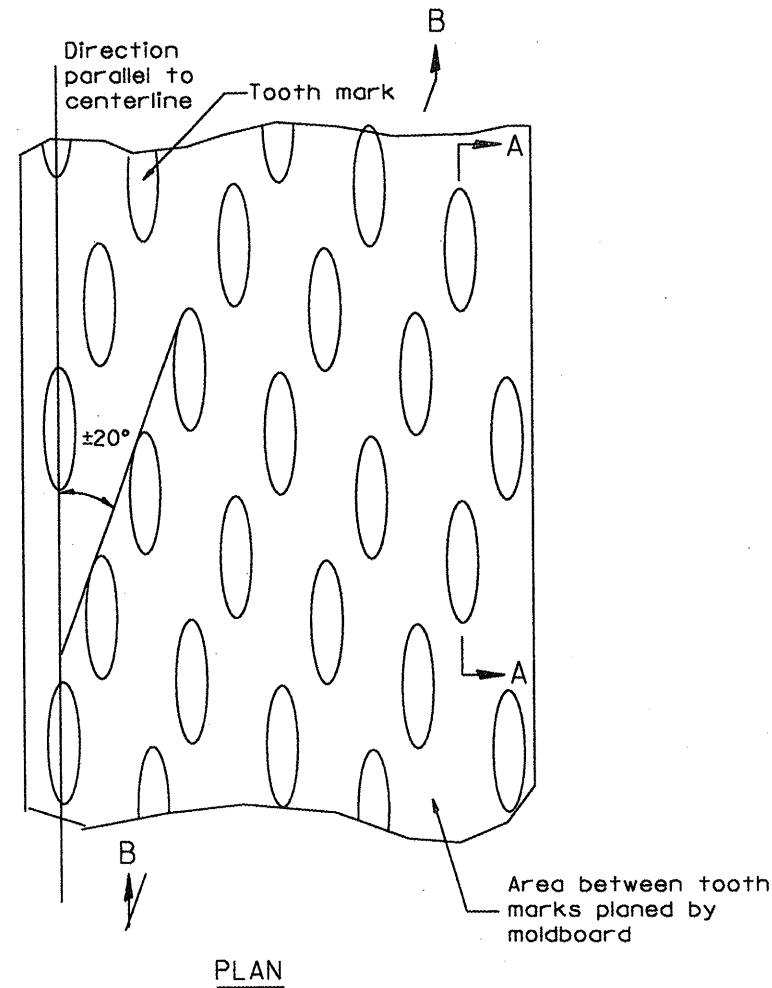

General notes:

1. Coldmilling shall consist of two processes: Cutting with carbide teeth mounted on a rotating drum, and planing with a moldboard mounted immediately behind the cutting drum.
2. Other similar patterns will be acceptable if they consist of a smooth, flat, planed surface interspersed with a pattern of discontinuous longitudinal striations.

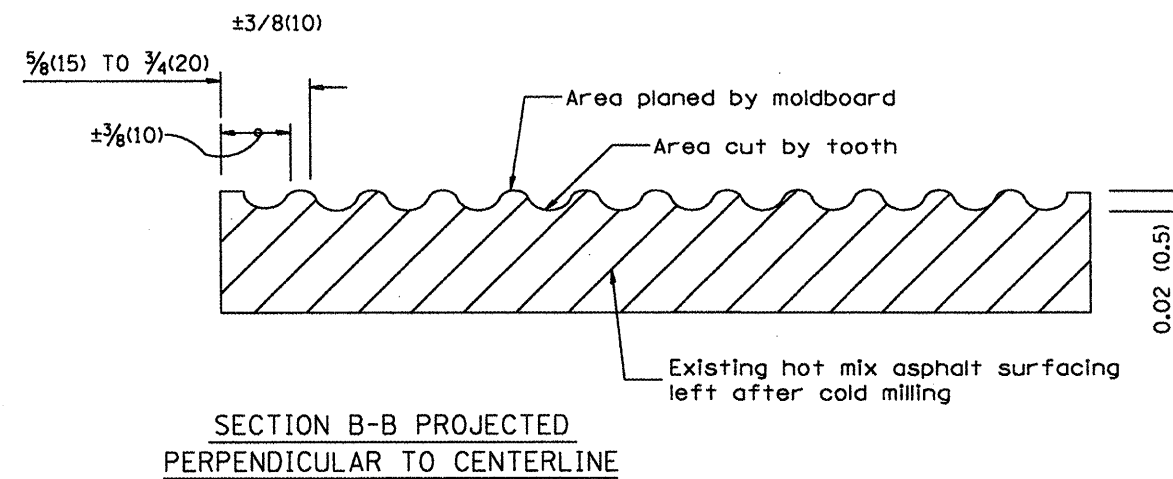
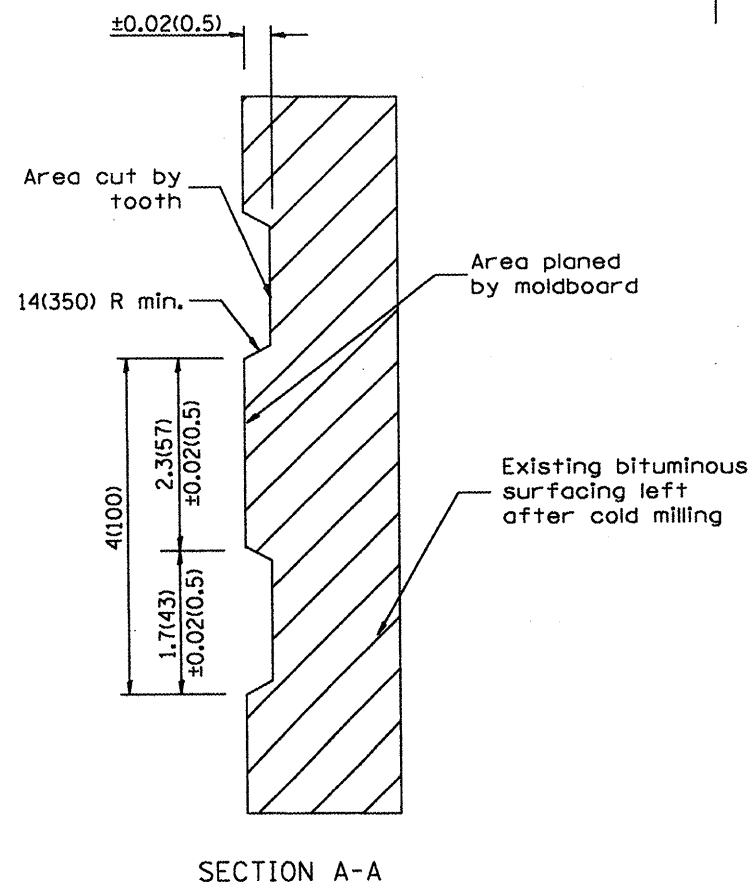

All dimensions are in inches (millimeters) unless otherwise noted.

01-01-97	BENJUM_C-104.01_NEW_REVISION_BOX	J.P.
04-20-98	REMOVED MILLING DETAIL FROM STANDARD	J.A.
09-08-98	CORRECT NOTE LEADER PLACEMENT	B.W.
10-16-06	REVISED TO 2007 SPEC.	M.A.

STATE OF ILLINOIS
DEPARTMENT OF TRANSPORTATION

HOT MIX ASPHALT SURFACE REMOVAL (COLD MILLING)

NOT TO SCALE

CADD STD. 440001:04

F.A.P. RTE.	SECTION	COUNTY	TOTAL SHEETS	SHEET NO.
22	135RS-7	FULTON	33	33
CONTRACT NO. 68978			FED. ROAD DIST. NO. - ILLINOIS FED. AID PROJECT	